

F.A.I.	SECTION	COUNTY	TOTAL SHEETS	SHEET NO.
94/90 *		COOK	598	377
STA. 1584+00	TO STA. 1596+00			
FED. ROAD DIST. NO.	ILLINOIS	FED. AID PROJECT		

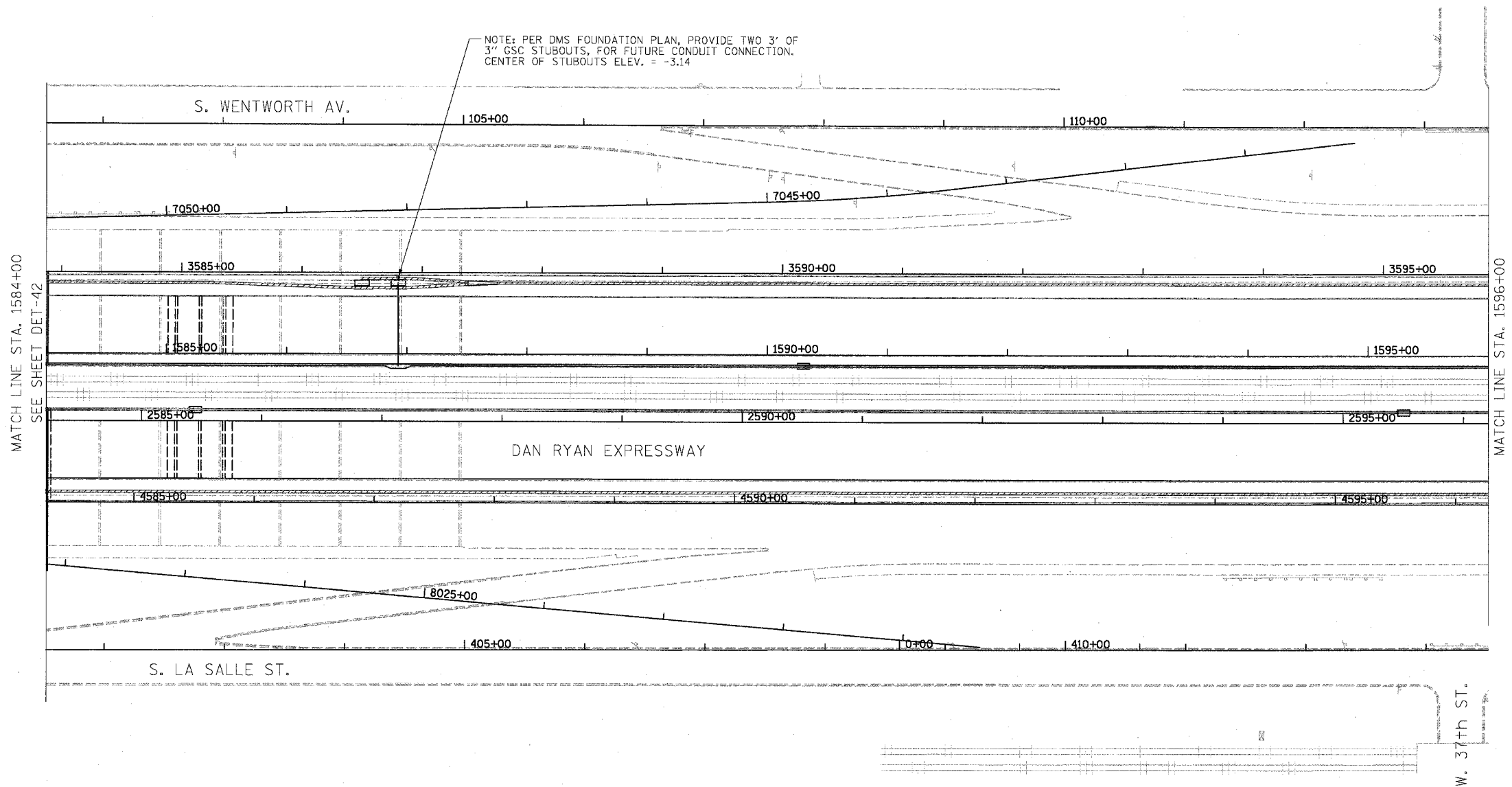

MATCH LINE STA. 1584+00
SEE SHEET DET-42

MATCH LINE STA. 1596+00
SEE SHEET DET-44

NOTES:

1. SEE DRAWING EI-100 AND EI-101 FOR ELECTRICAL SYSTEMS AND ABBREVIATIONS.
2. UNLESS OTHERWISE STATED, ALL NOTED CABLE TO BE FURNISHED AND INSTALLED UNDER ANOTHER CONTRACT.
3. TRENCHED CONDUITS INSTALLED IN PARALLEL ARE TO BE INSTALLED IN COMMON TRENCH.
4. THIS SHEET ONLY DEPICTS INSTALLATION OF DETECTION/RAMP METER ELEMENTS. REFER TO SHEETS FOR OTHER SUBSYSTEMS FOR ADDITIONAL ELEMENTS IN THE AREA SHOWN.
5. DETECTOR LOOPS INSTALLED BY OTHERS.
6. REFER TO HANDHOLE DETAILS. SEE DRAWING DT-29.

BOWMAN, BARRETT & ASSOCIATES INC.
CONSULTING ENGINEERS
Chicago, Illinois
312.228.0100
www.bbansi.com

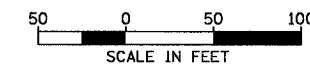

EI-43

REVISIONS	
NAME	DATE

ILLINOIS DEPARTMENT OF TRANSPORTATION
F.A.I. 94/90 (DAN RYAN EXPRESSWAY)
31ST STREET TO 71ST STREET
SB EXPRESS LANE RECONSTRUCTION
ELECTRICAL INFRASTRUCTURE PLAN
SOUTHBOUND STA. 1584+00 TO STA. 1596+00

SCALE: 1"=50'
DATE: 07/07/05

DRAWN BY: TER
CHECKED BY: JDC

6/27/2005 6:44:00 PM