

F.A.I.	SECTION	COUNTY	TOTAL SHEETS	SHEET NO.
94/90	2003-02BF	COOK	419	16
STA.		TO STA.		
FED. ROAD DIST. NO.		ILLINOIS FED. AID PROJECT		
62580				

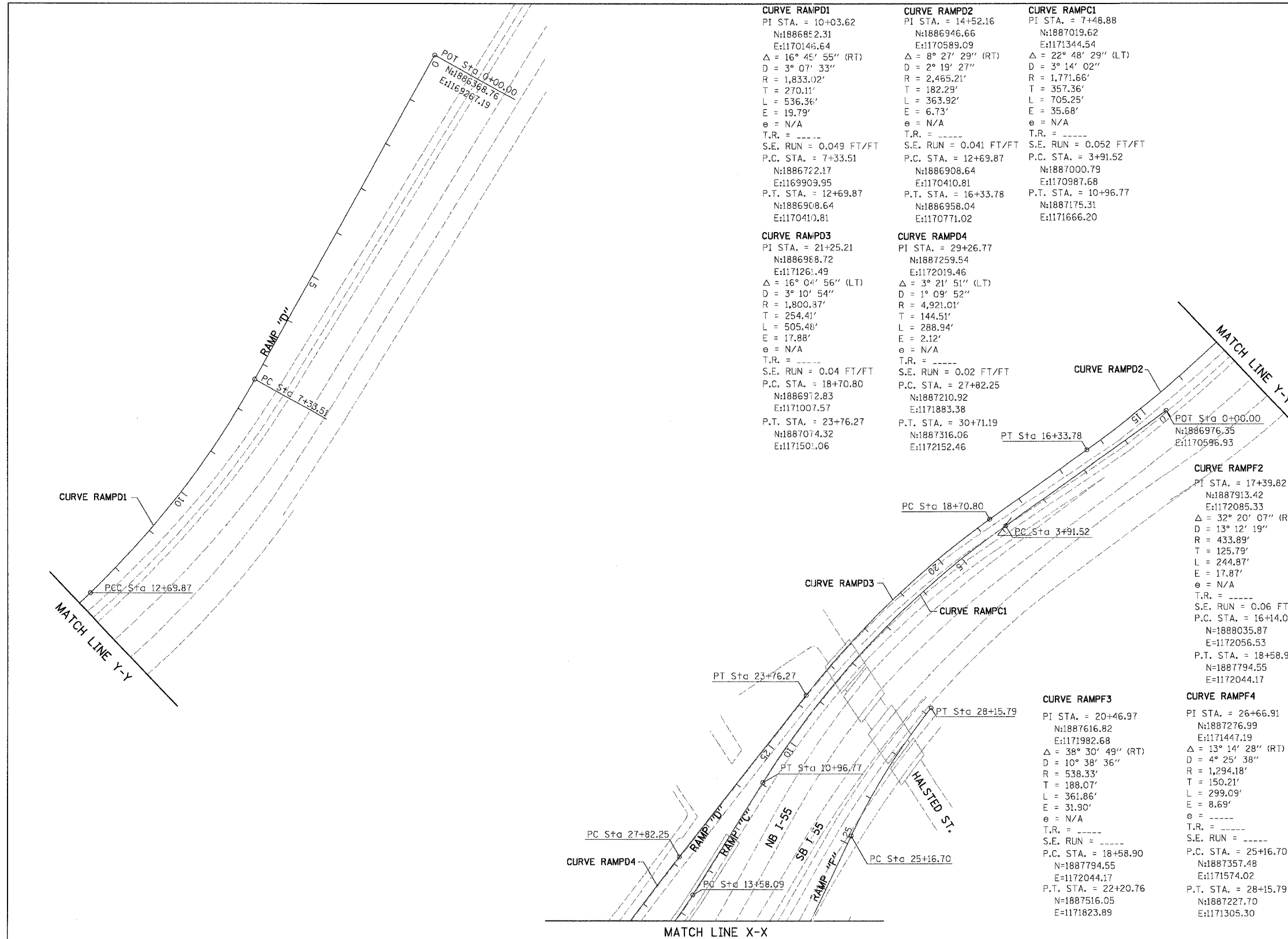

**CURVE RAMPD1**  
PI STA. = 10+03.62  
N:188682.31  
E:1170146.64  
Δ = 16° 45' 55" (RT)  
D = 3° 07' 33"  
R = 1,833.02'  
T = 270.11'  
L = 536.36'  
E = 19.79'  
e = N/A  
T.R. = -----  
S.E. RUN = 0.049 FT/FT  
P.C. STA. = 7+33.51  
N:1886722.17  
E:1169909.95  
P.T. STA. = 12+69.87  
N:1886908.64  
E:1170410.81

**CURVE RAMPD2**  
PI STA. = 14+52.16  
N:1886946.66  
E:1170589.09  
Δ = 8° 27' 29" (RT)  
D = 2° 19' 27"  
R = 2,465.21'  
T = 182.29'  
L = 363.92'  
E = 6.73'  
e = N/A  
T.R. = -----  
S.E. RUN = 0.041 FT/FT  
P.C. STA. = 12+69.87  
N:1886908.64  
E:1170410.81  
P.T. STA. = 16+33.78  
N:1886956.04  
E:1170771.02

**CURVE RAMPD3**  
PI STA. = 21+25.21  
N:1886988.72  
E:1171261.49  
Δ = 16° 04' 56" (LT)  
D = 3° 10' 54"  
R = 1,800.37'  
T = 254.41'  
L = 505.48'  
E = 17.88'  
e = N/A  
T.R. = -----  
S.E. RUN = 0.04 FT/FT  
P.C. STA. = 18+70.80  
N:1886972.83  
E:1171007.57  
P.T. STA. = 23+76.27  
N:1887074.32  
E:1171501.06

**CURVE RAMPD4**  
PI STA. = 29+26.77  
N:1887259.54  
E:1172019.46  
Δ = 3° 21' 51" (LT)  
D = 1° 09' 52"  
R = 4,921.01'  
T = 144.51'  
L = 288.94'  
E = 2.12'  
e = N/A  
T.R. = -----  
S.E. RUN = 0.02 FT/FT  
P.C. STA. = 27+82.25  
N:1887210.92  
E:1171883.38  
P.T. STA. = 30+71.19  
N:1887316.06  
E:1172152.46

**CURVE RAMPF1**  
PI STA. = 7+48.88  
N:1887019.62  
E:1171344.54  
Δ = 22° 48' 29" (LT)  
D = 3° 14' 02"  
R = 1,771.66'  
T = 357.36'  
L = 705.25'  
E = 35.68'  
e = N/A  
T.R. = -----  
S.E. RUN = 0.052 FT/FT  
P.C. STA. = 3+91.52  
N:1887000.79  
E:1170987.68  
P.T. STA. = 10+96.77  
N:1887175.31  
E:1171666.20

**CURVE RAMPF2**  
PI STA. = 17+39.82  
N:1887913.42  
E:1172085.33  
Δ = 32° 20' 07" (RT)  
D = 13° 12' 19"  
R = 433.89'  
T = 125.79'  
L = 244.87'  
E = 17.87'  
e = N/A  
T.R. = -----  
S.E. RUN = 0.06 FT/FT  
P.C. STA. = 16+14.03  
N:1888035.87  
E:1172056.53  
P.T. STA. = 18+58.90  
N:1887794.55  
E:1172044.17

**CURVE RAMPF3**  
PI STA. = 20+46.97  
N:1887616.82  
E:1171982.68  
Δ = 38° 30' 49" (RT)  
D = 10° 38' 36"  
R = 538.33'  
T = 188.07'  
L = 361.86'  
E = 31.90'  
e = N/A  
T.R. = -----  
S.E. RUN = -----  
P.C. STA. = 18+58.90  
N:1887794.55  
E:1172044.17  
P.T. STA. = 22+20.76  
N:1887516.05  
E:1171823.89

**CURVE RAMPF4**  
PI STA. = 26+66.91  
N:1887276.99  
E:1171447.19  
Δ = 13° 14' 28" (RT)  
D = 4° 25' 38"  
R = 1,294.18'  
T = 150.21'  
L = 299.09'  
E = 8.69'  
e = -----  
T.R. = -----  
S.E. RUN = -----  
P.C. STA. = 25+16.70  
N:1887357.48  
E:1171574.02  
P.T. STA. = 28+15.79  
N:1887227.70  
E:1171305.30

BOWMAN, BARRETT & ASSOCIATES INC.  
CONSULTING ENGINEERS  
Chicago, Illinois  
312.228.0100  
www.bbainc.com

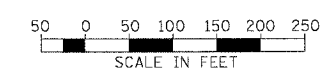

REVISIONS	
NAME	DATE

ILLINOIS DEPARTMENT OF TRANSPORTATION  
F.A.I. 94/90 (DAN RYAN EXPRESSWAY)  
NB DAN RYAN ELEVATED BRIDGE  
REPAIR FROM 15TH TO 28TH STREETS  
ALIGNMENT PLAN  
STA. 99+94 TO STA. 125+39

SCALE: 1"=100'  
DATE: 7/22/2005

DRAWN BY: RA  
CHECKED BY: RS

CAL04  
7/21/2005 11:26:33 AM