

F.A.I.	SECTION	COUNTY	TOTAL SHEETS	SHEET NO.
94/90 *		COOK	419	85
STA. 1578+00		TO STA. 1602+00		
FED. ROAD DIST. NO.		ILLINOIS	FED. AID PROJECT	
62580 - (1818, ETC, 2324.6-1PR-9				

FOR INFORMATION ONLY

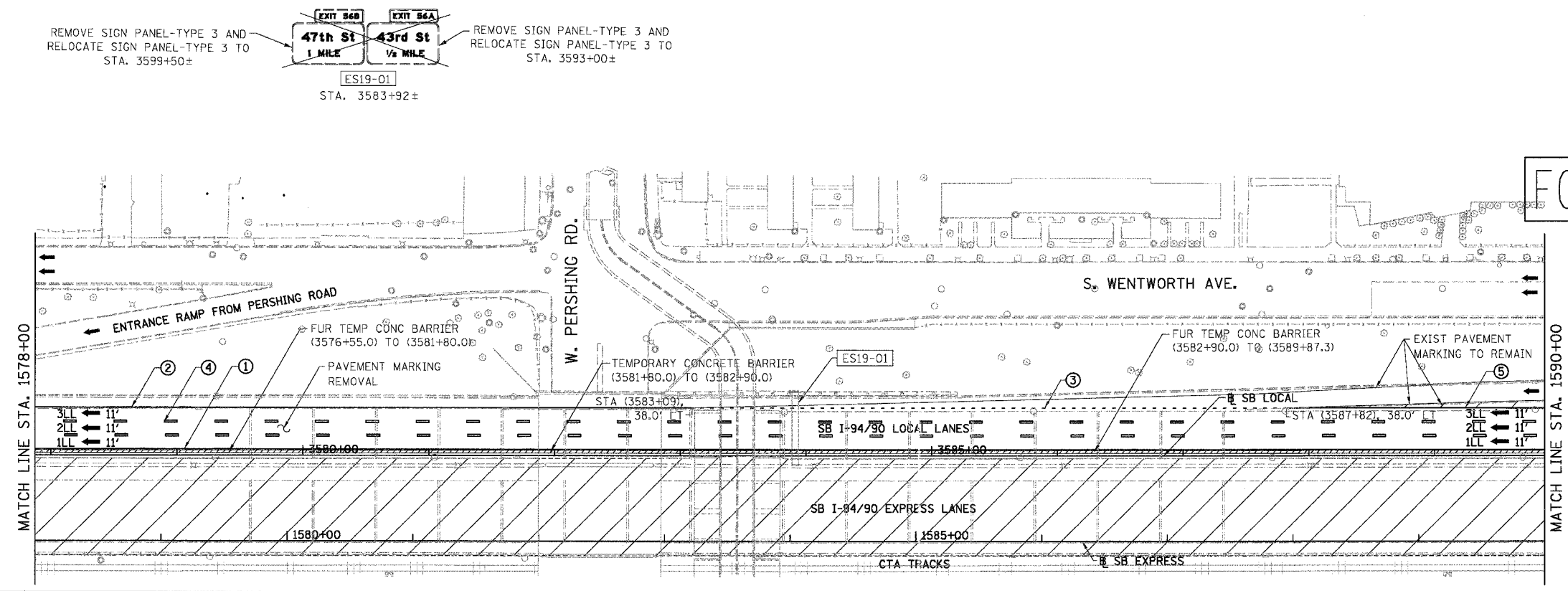

- LEGEND**
- WORK ZONE
 - TEMPORARY PAVEMENT
 - 1LL TRAFFIC LANE & DIRECTION OF TRAFFIC
 - DRUM OR BARRICADE TYPE II WITH STEADY BURN LIGHT
 - IMPACT ATTENUATORS, TEMPORARY (NON-REDIRECTIVE), TEST LEVEL 3
 - BARRICADE TYPE III
 - TEMPORARY CONCRETE BARRIER
 - ① LINE 4" (YELLOW EDGE LINE)
 - ② LINE 4" (WHITE EDGE LINE)
 - ③ LINE 4" (SKIP DASH, 6' SKIP - 2' DASH, WHITE)
 - ④ LINE 5" (SKIP DASH, 30' SKIP - 10' DASH, WHITE)
 - ⑤ LINE 8" (WHITE GORE LINE)
 - ⑥ LINE 8" (SKIP DASH, 12' SKIP - 3' DASH, WHITE)
 - ⑦ LINE 12" (DIAGONAL, 30' C-C)
 - ⑧ LINE 12" (DIAGONAL, 500' C-C)
 - ⑨ LETTERS AND SYMBOLS
 - ESx-xx EXISTING SIGNS
 - TSx-xx TEMPORARY SIGNS

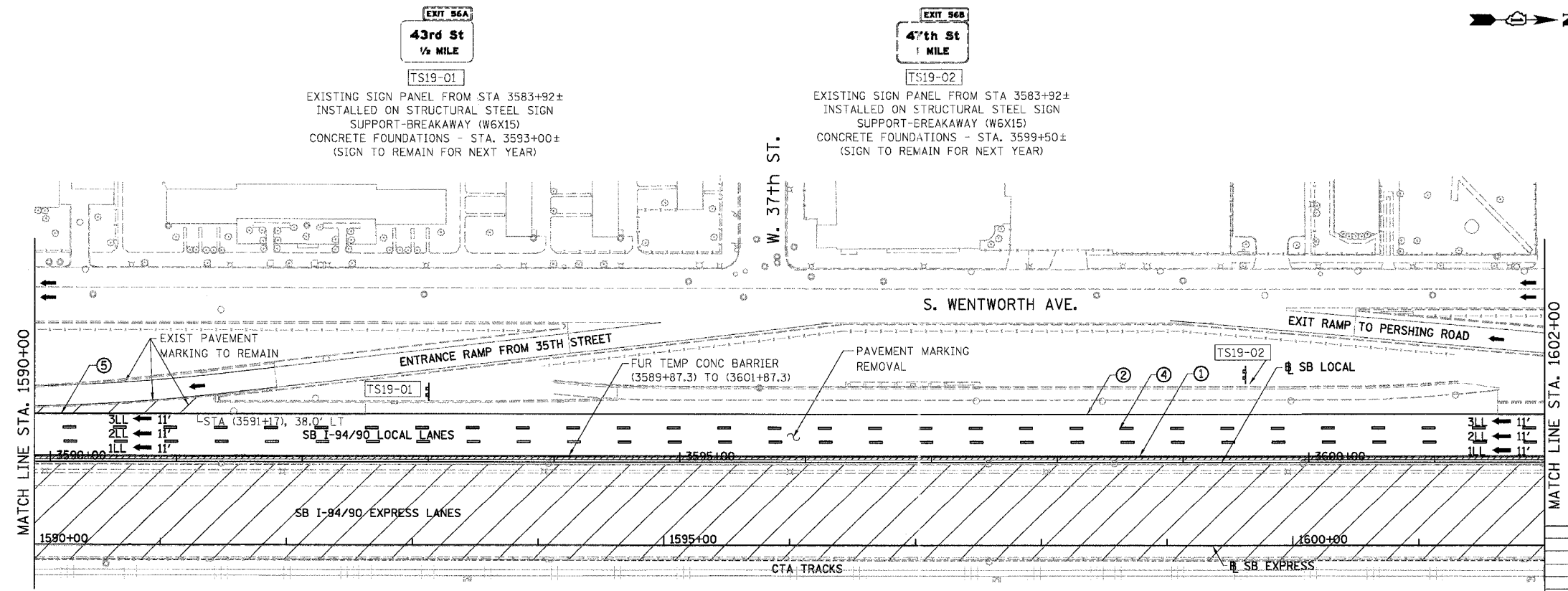

EXIT 56A
43rd St
 1/2 MILE
 TS19-01
 EXISTING SIGN PANEL FROM STA 3583+92±
 INSTALLED ON STRUCTURAL STEEL SIGN
 SUPPORT-BREAKAWAY (W6X15)
 CONCRETE FOUNDATIONS - STA. 3593+00±
 (SIGN TO REMAIN FOR NEXT YEAR)

EXIT 56B
47th St
 1 MILE
 TS19-02
 EXISTING SIGN PANEL FROM STA 3583+92±
 INSTALLED ON STRUCTURAL STEEL SIGN
 SUPPORT-BREAKAWAY (W6X15)
 CONCRETE FOUNDATIONS - STA. 3599+50±
 (SIGN TO REMAIN FOR NEXT YEAR)

STATIONING

+++## STATION PROVIDED FROM THE I-90/94 EXPRESS LANES
 (+++##) STATION PROVIDED FROM THE I-90/94 LOCAL LANES
 [+##.##] STATION PROVIDED FROM THE SLIP RAMP

NOTE:
 ALL PAVEMENT MARKINGS ON THIS SHEET WILL BE PAVEMENT MARKING TAPE, TYPE III, UNLESS OTHERWISE NOTED.

REVISIONS	NAME	DATE

ILLINOIS DEPARTMENT OF TRANSPORTATION
F.A.I. 94/90 (DAN RYAN EXPRESSWAY)
 31ST STREET TO 71ST STREET
 SB EXPRESS LANE RECONSTRUCTION
 MAINTENANCE OF TRAFFIC PLAN STAGE 1
 SOUTHBOUND STA. 1578+00 TO STA. 1602+00
 SCALE: 1"=50'
 DATE: 7/22/2005
 DRAWN BY: RA
 CHECKED BY: RS

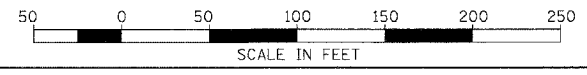

BOWMAN, BARRETT & ASSOCIATES INC.
 CONSULTING ENGINEERS
 Chicago, Illinois
 312.228.0100
 www.bbadainc.com

7/19/2005 2:11:25 PM MOT-18