

F.A.I.	SECTION	COUNTY	TOTAL SHEETS	SHEET NO.
94/90	*	COOK	419	88
STA.	TO STA.			
FED. ROAD DIST. NO.	ILLINOIS	FED. AID PROJECT		
62580	*(1818, ETC, 2324.6-1P)R-9			

FOR INFORMATION ONLY

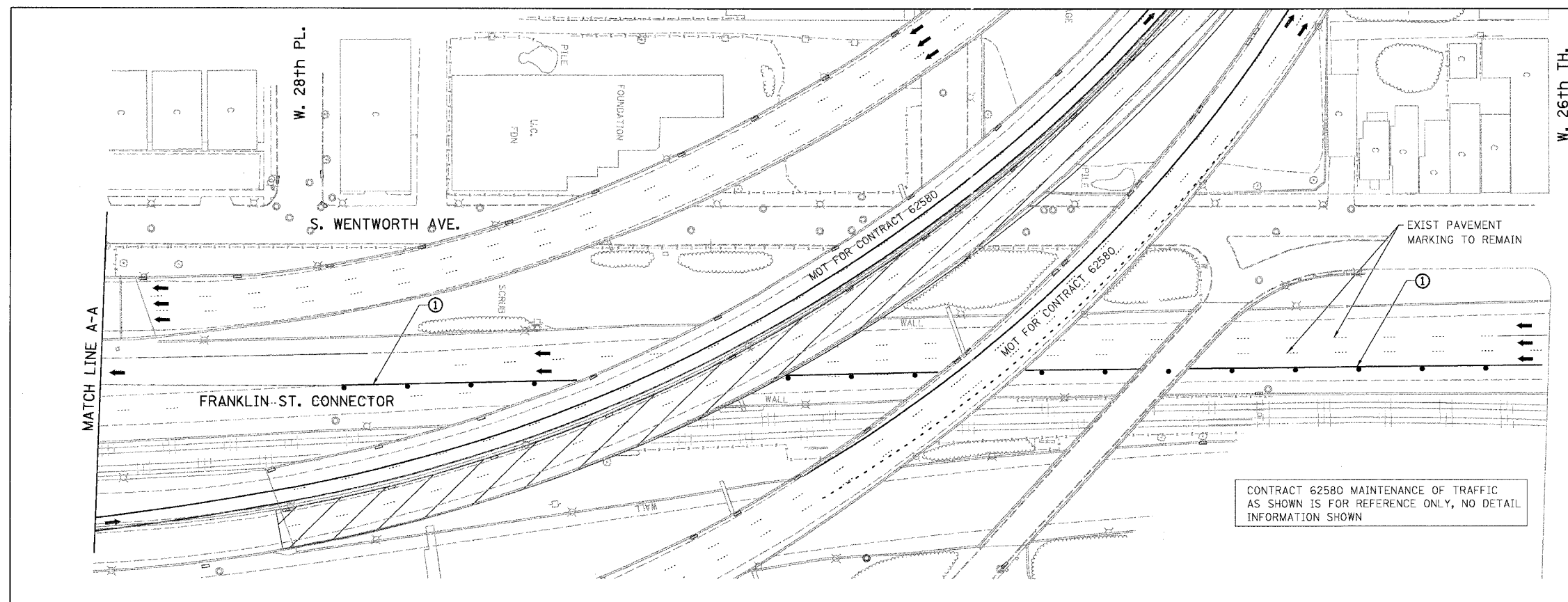

CONTRACT 62580 MAINTENANCE OF TRAFFIC AS SHOWN IS FOR REFERENCE ONLY, NO DETAIL INFORMATION SHOWN

MATCH LINE B-B

- LEGEND**
- WORK ZONE
 - TEMPORARY PAVEMENT
 - ILL TRAFFIC LANE & DIRECTION OF TRAFFIC
 - DRUM OR BARRICADE TYPE II WITH STEADY BURN LIGHT
 - IMPACT ATTENUATORS, TEMPORARY (NON-REDIRECTIVE), TEST LEVEL 3
 - BARRICADE TYPE III
 - TEMPORARY CONCRETE BARRIER
 - LINE 4" (YELLOW EDGE LINE)
 - LINE 4" (WHITE EDGE LINE)
 - LINE 4" (SKIP DASH, 6' SKIP - 2' DASH, WHITE)
 - LINE 5" (SKIP DASH, 30' SKIP - 10' DASH, WHITE)
 - LINE 8" (WHITE GORE LINE)
 - LINE 8" (SKIP DASH, 12' SKIP - 3' DASH, WHITE)
 - LINE 12" (DIAGONAL, 30' C-C)
 - LINE 12" (DIAGONAL, 500' C-C)
 - LETTERS AND SYMBOLS
 - EXISTING SIGNS
 - TEMPORARY SIGNS

- STATIONING**
- +++.** STATION PROVIDED FROM THE I-90/94 EXPRESS LANES
 - (+++.***) STATION PROVIDED FROM THE I-90/94 LOCAL LANES
 - [+++.**] STATION PROVIDED FROM THE SLIP RAMP

NOTE:
ALL PAVEMENT MARKINGS ON THIS SHEET WILL BE PAVEMENT MARKING TAPE, TYPE III, UNLESS OTHERWISE NOTED.

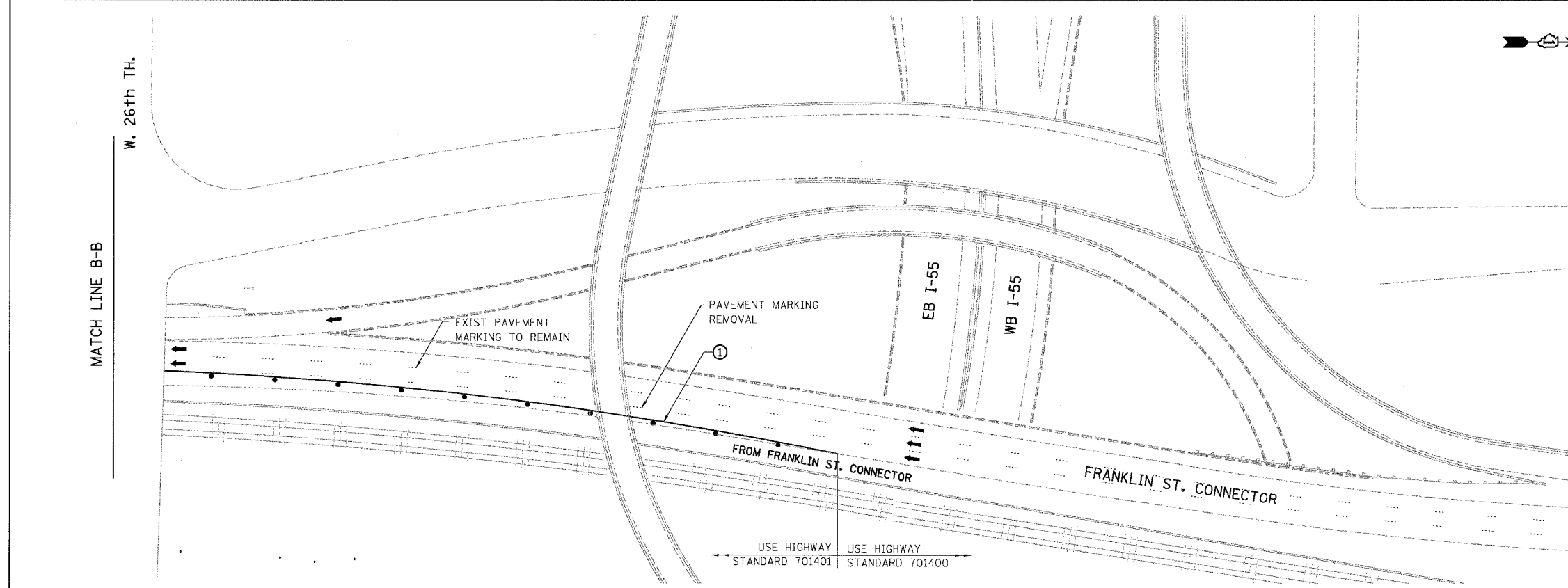

USE HIGHWAY STANDARD 701401 USE HIGHWAY STANDARD 701400

REVISIONS	
NAME	DATE

ILLINOIS DEPARTMENT OF TRANSPORTATION
F.A.I. 94/90 (DAN RYAN EXPRESSWAY)
31ST STREET TO 71ST STREET
SB EXPRESS LANE RECONSTRUCTION
MAINTENANCE OF TRAFFIC PLAN STAGE 1
SOUTHBOUND STA. TO STA.
SCALE: 1"=50'
DATE: 1/22/2005
DRAWN BY: RA
CHECKED BY: RS

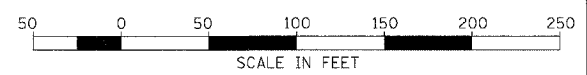

BOWMAN, BARRETT & ASSOCIATES INC.
CONSULTING ENGINEERS
Chicago, Illinois
312.228.0100
www.bbadainc.com

7/15/2005 2:42Z PM