

RAMP "E" CLOSED

(SB I-55 EXIT TO WB I-94/90)

F.A.I.	SECTION	COUNTY	TOTAL SHEETS	SHEET NO.
94/90	2003-028F	COOK	419	91
STA.	TO STA.			
FED. ROAD DIST. NO.	ILLINOIS	FED. AID PROJECT		

62680

M6-2 (24x12)		
M6-3 (24x12)		
M3-4 (24x12)	WEST	
M4-8 (30x15)	DETOUR	
M3-3 (24x12)	SOUTH	
M1-1 (24x24)	90 94	
	55	
(36x24)	TRUCKS USE PULASKI AVE	
(36x12)	NO TRUCKS	
M4-4 (24x12)	TRUCKS	

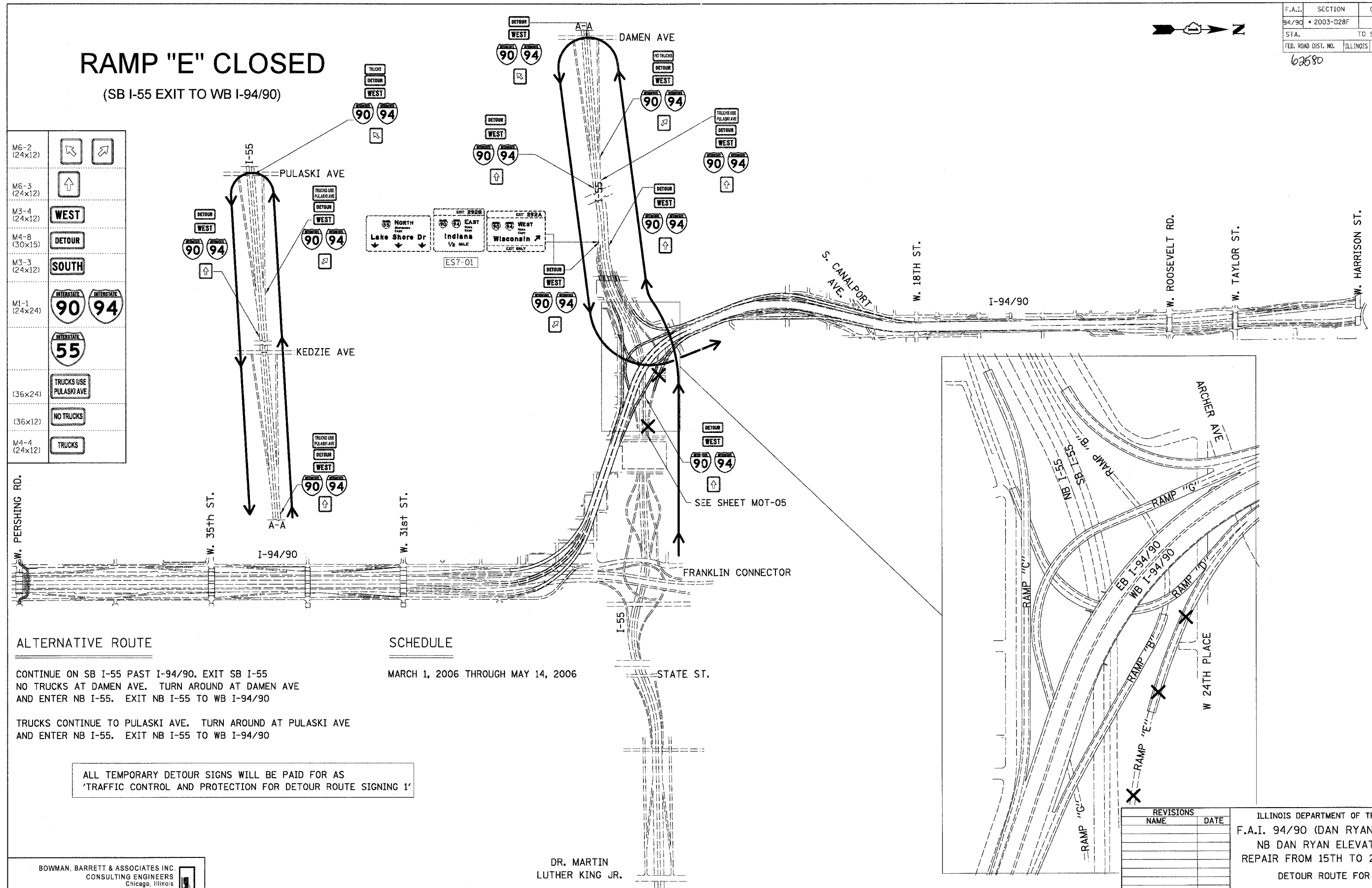

ALTERNATIVE ROUTE

CONTINUE ON SB I-55 PAST I-94/90. EXIT SB I-55
NO TRUCKS AT DAMEN AVE. TURN AROUND AT DAMEN AVE
AND ENTER NB I-55. EXIT NB I-55 TO WB I-94/90

TRUCKS CONTINUE TO PULASKI AVE. TURN AROUND AT PULASKI AVE
AND ENTER NB I-55. EXIT NB I-55 TO WB I-94/90

ALL TEMPORARY DETOUR SIGNS WILL BE PAID FOR AS
'TRAFFIC CONTROL AND PROTECTION FOR DETOUR ROUTE SIGNING 1'

SCHEDULE

MARCH 1, 2006 THROUGH MAY 14, 2006

BOWMAN, BARRETT & ASSOCIATES INC
CONSULTING ENGINEERS
Chicago, Illinois
312.228.0100
www.bbainc.com

DR. MARTIN
LUTHER KING JR.

REVISIONS	
NAME	DATE

ILLINOIS DEPARTMENT OF TRANSPORTATION
F.A.I. 94/90 (DAN RYAN EXPRESSWAY)
NB DAN RYAN ELEVATED BRIDGE
REPAIR FROM 15TH TO 28TH STREETS
DETOUR ROUTE FOR RAMP E

SCALE: =NTS
DATE: 8/12/2005

DRAWN BY: RA
CHECKED BY: RS

DTR-01
8/11/2005