

F.A.I.	SECTION	COUNTY	TOTAL SHEETS	SHEET NO.
94/90	2003-02BF	COOK	419	151
STA.	TO STA.			
FED. ROAD DIST. NO.	ILLINOIS	FED. AID PROJECT		

62580

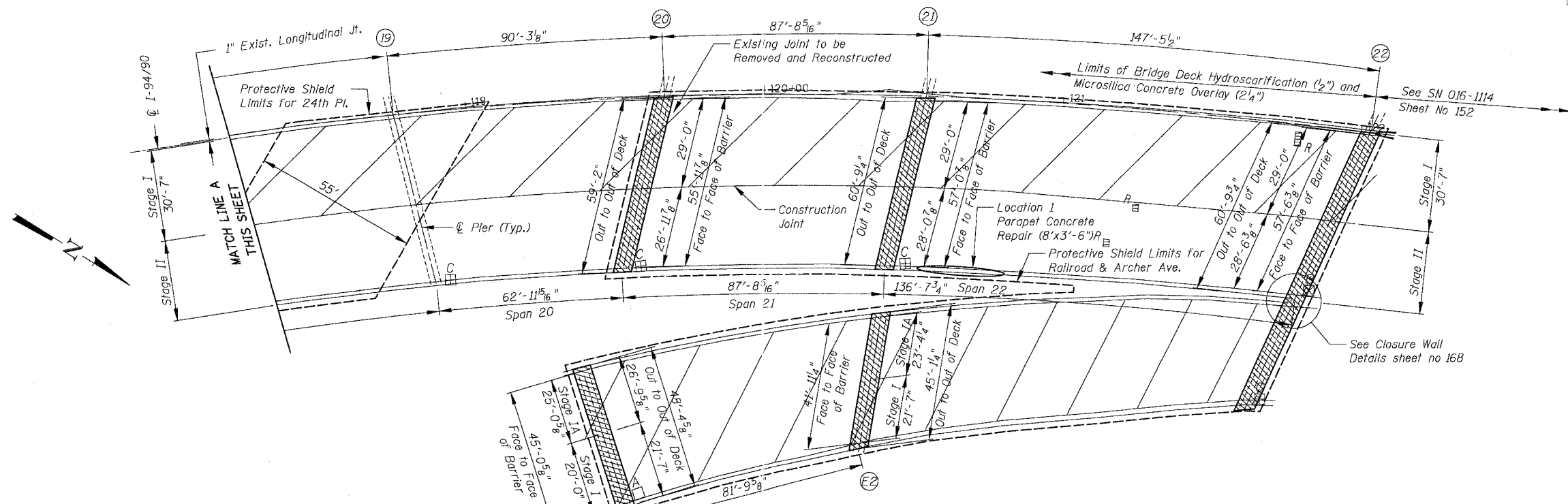

SN 016-1115 PARTIAL DECK PLAN

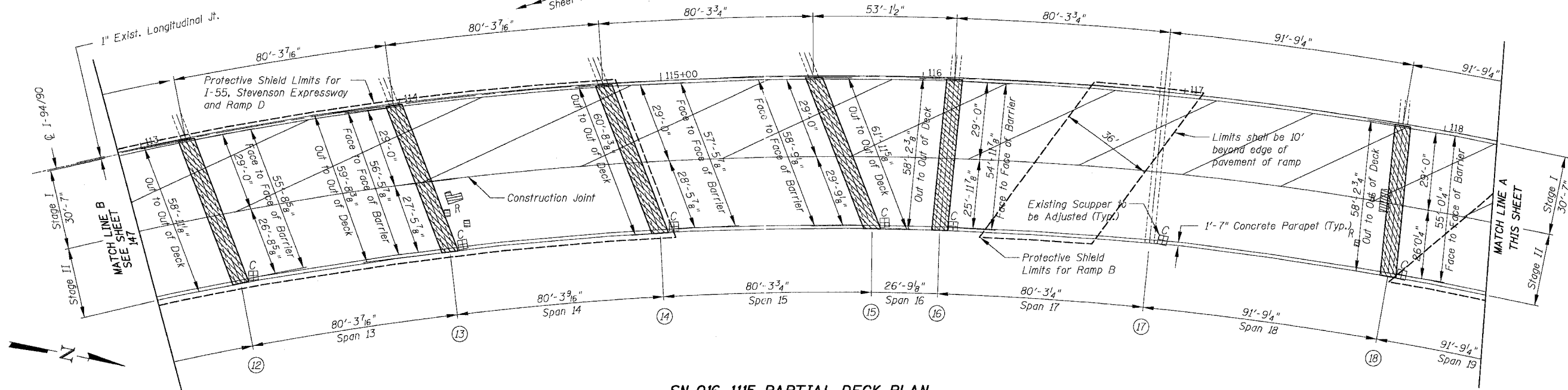

SN 016-1115 PARTIAL DECK PLAN

BOWMAN, BARRETT & ASSOCIATES INC.  
 CONSULTING ENGINEERS  
 Chicago, Illinois  
 312.228.0100  
 www.bbainc.com

Notes:  
 For parapet concrete repair see sheet 170A  
 For Additional Notes and Legend See Sheet 143

REVISIONS	NAME	DATE

ILLINOIS DEPARTMENT OF TRANSPORTATION  
 F.A.I. 94/90 (DAN RYAN EXPRESSWAY)  
 NB DAN RYAN ELEVATED BRIDGE  
 REPAIR FROM 15TH TO 28TH STREETS  
 PARTIAL DECK PLAN  
 SN 016-1115

SCALE: 1"=20'  
 DATE: 8/12/2005

DRAWN BY: BDC  
 CHECKED BY: BLU

10/25/2005 8/11/2005