

F.A.I.	SECTION	COUNTY	TOTAL SHEETS	SHEET NO.
94/90	2003-028F	COOK	419	238
STA.	TO STA.			
FED. ROAD DIST. NO.	ILLINOIS	FED. AID PROJECT		
62580				

ELEMENT IDENTIFICATION

Elements on the Northbound Structure are identified 1N, 2N, 3N etc. starting from the centerline of I-90/94. Numbers within () refer to as-built beam designations.

- ① = Pier No.
- = Location of bearing replacement
- ⬡ = Location of Structural Steel Repair

* Considered part of adjacent Structure Number 016-1113.

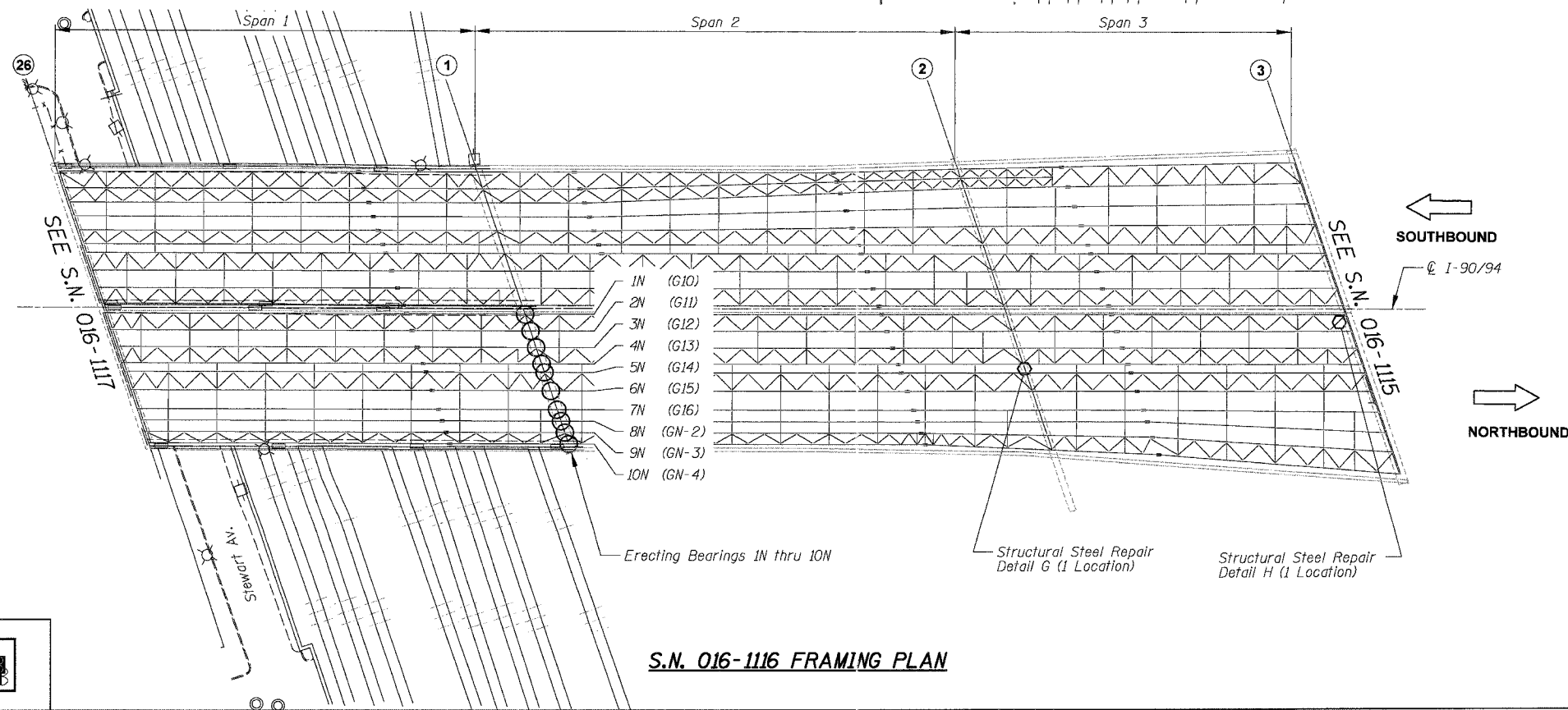
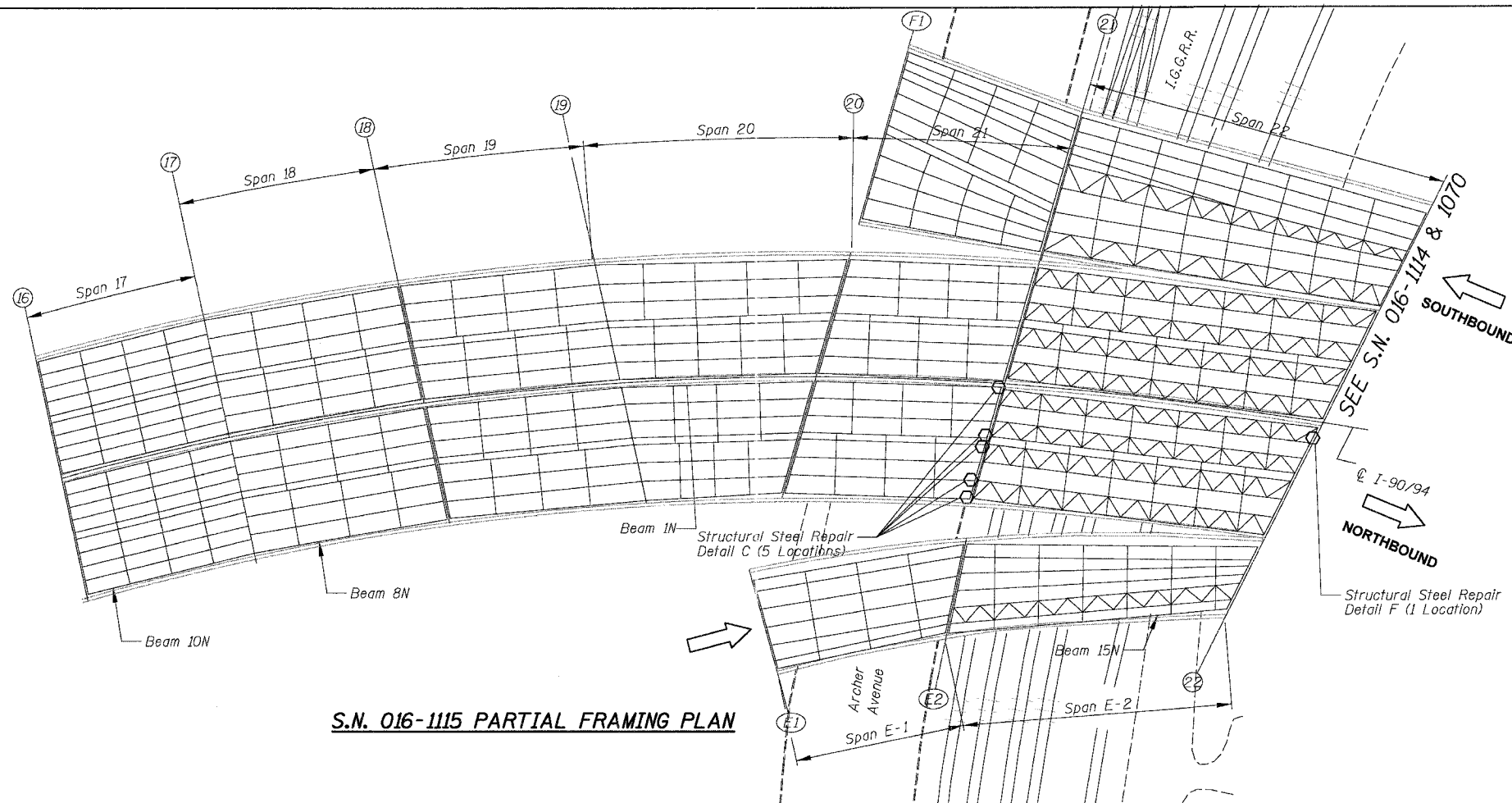

REVISIONS	
NAME	DATE

ILLINOIS DEPARTMENT OF TRANSPORTATION
 F.A.I. 94/90 (DAN RYAN EXPRESSWAY)
 NB DAN RYAN ELEVATED BRIDGE
 REPAIR FROM 15TH TO 28TH STREETS
 PARTIAL FRAMING PLAN
 S.N. 016-1115 & 016-1116
 SCALE: NTS DRAWN BY: BDC
 DATE: 7/22/2005 CHECKED BY: BLU

BOWMAN, BARRETT & ASSOCIATES INC
 CONSULTING ENGINEERS
 Chicago, Illinois
 312.228.0100
 www.bbainc.com

7/21/2005 3:55:27 PM