

CURVE COLLNBO1	CURVE COLLNBO2	CURVE COLLNBO3	CURVE COLLSBO1	CURVE COLLSBO2	CURVE COLLSBO3	CURVE SBRMPO1	CURVE SBRMPO2	CURVE SBRMPO3	CURVE SBRMPO4
P.I. STA= 17+15.43 N= 1,858,574.87 E= 1,177,378.55 Δ= 2° 07' 33" D= 0° 28' 38" R= 12,000.00' T= 222.67' L= 445.29 E= 2.06' e= N/A T.R.= N/A S.E. RUN= N/A P.C. STA= 14+92.76 N= 1,858,352.21 E= 1,177,377.25 P.T. STA= 19+38.05 N= 1,858,797.43 E= 1,177,371.58	P.I. STA= 25+45.61 N= 1,859,404.70 E= 1,177,352.58 Δ= 1° 17' 10" D= 0° 24' 33" R= 14,000.00' T= 157.14' L= 314.27 E= 0.88' e= N/A T.R.= N/A S.E. RUN= N/A P.C. STA= 23+88.47 N= 1,859,247.63 E= 1,177,357.49 P.T. STA= 27+02.74 N= 1,859,561.83 E= 1,177,351.19	P.I. STA= 28+45.20 N= 1,859,704.28 E= 1,177,349.93 Δ= 1° 09' 57" D= 0° 24' 33" R= 14,000.00' T= 142.45' L= 284.90 E= 0.72' e= N/A T.R.= N/A S.E. RUN= N/A P.C. STA= 27+02.74 N= 1,859,561.83 E= 1,177,351.19 P.T. STA= 29+87.65 N= 1,859,846.68 E= 1,177,345.57	P.I. STA= 62+03.18 N= 1,858,576.31 E= 1,177,181.55 Δ= 0° 45' 55" D= 0° 14' 56" R= 23,000.00' T= 153.61' L= 307.23 E= 0.51' e= N/A T.R.= N/A S.E. RUN= N/A P.C. STA= 60+49.56 N= 1,858,422.76 E= 1,177,186.19 P.T. STA= 63+56.79 N= 1,858,729.78 E= 1,177,174.87	P.I. STA= 70+53.37 N= 1,859,425.70 E= 1,177,144.56 Δ= 0° 22' 48" D= 0° 14' 56" R= 20,000.00' T= 132.70' L= 265.40 E= 0.22' e= N/A T.R.= N/A S.E. RUN= N/A P.C. STA= 69+20.67 N= 1,859,293.13 E= 1,177,150.34 P.T. STA= 71+86.08 N= 1,859,558.24 E= 1,177,137.91	P.I. STA= 81+04.03 N= 1,860,475.04 E= 1,177,091.89 Δ= 8° 56' 14" D= 0° 14' 56" R= 1,766.00' T= 138.01' L= 275.46 E= 5.38' e= N/A T.R.= N/A S.E. RUN= N/A P.C. STA= 79+66.02 N= 1,860,337.20 E= 1,177,098.81 P.T. STA= 82+41.49 N= 1,860,610.14 E= 1,177,063.64	P.I. STA= 7107+24.23 N= 1,859,529.38 E= 1,177,115.44 Δ= 5° 33' 25" D= 2° 51' 53" R= 2,000.00' T= 97.06' L= 193.98 E= 2.35' e= N/A T.R.= N/A S.E. RUN= N/A P.C. STA= 7108+21.14 N= 1,859,432.42 E= 1,177,120.01 P.T. STA= 7109+21.14 N= 1,859,432.42 E= 1,177,120.01	P.I. STA= 7108+91.39 N= 1,859,362.26 E= 1,177,123.31 Δ= 0° 12' 05" D= 0° 08' 36" R= 39,975.44' T= 70.24' L= 140.48 E= 0.06' e= N/A T.R.= N/A S.E. RUN= N/A P.C. STA= 7108+21.14 N= 1,859,432.42 E= 1,177,120.01 P.T. STA= 7109+61.63 N= 1,859,292.09 E= 1,177,126.36	P.I. STA= 7110+86.37 N= 1,859,167.46 E= 1,177,131.79 Δ= 6° 54' 42" D= 3° 49' 11" R= 1,500.00' T= 90.58' L= 180.95 E= 2.73' e= N/A T.R.= N/A S.E. RUN= N/A P.C. STA= 7109+95.79 N= 1,859,257.95 E= 1,177,127.85 P.T. STA= 7111+76.74 N= 1,859,077.14 E= 1,177,124.81	P.I. STA= 7119+30.94 N= 1,858,325.18 E= 1,177,066.71 Δ= 5° 56' 51" D= 28° 38' 52" R= 200.00' T= 10.39' L= 20.76 E= 0.27' e= N/A T.R.= N/A S.E. RUN= N/A P.C. STA= 7119+20.55 N= 1,858,335.54 E= 1,177,067.52 P.T. STA= 7119+41.31 N= 1,858,314.79 E= 1,177,066.99

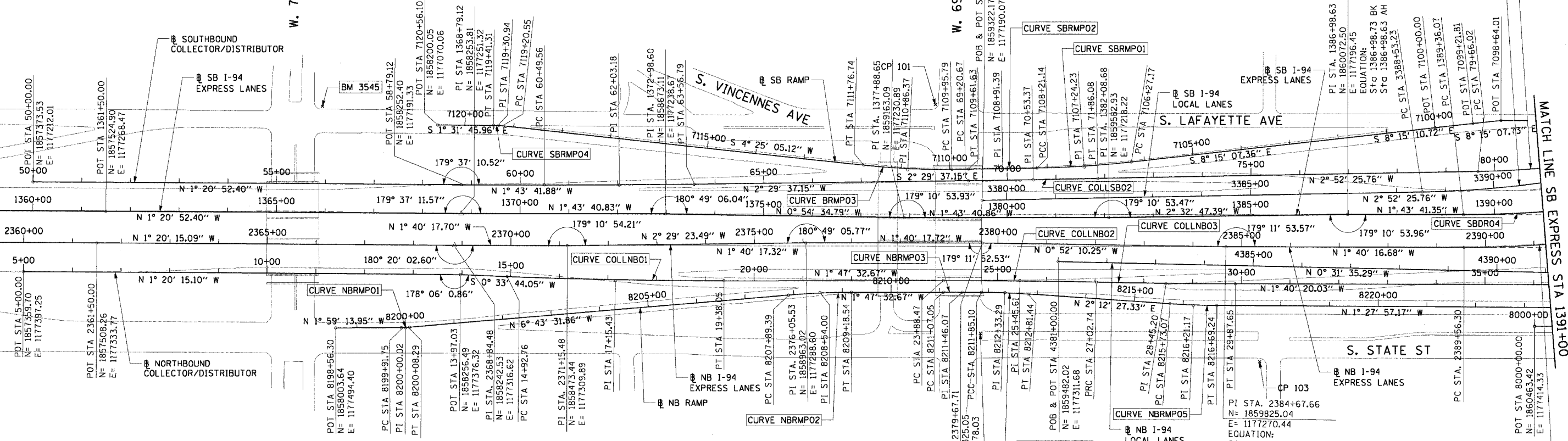

- BENCH MARK NO. 3528 ELEV. 16.20**
DESCRIPTION: CROSS CUT ON NORTHWESTERLY BOLT OF FIRE HYDRANT AT THE NORTHWEST CORNER OF 45TH ST AND WENTWORTH AVE
- BENCH MARK NO. 3530 ELEV. 18.18**
DESCRIPTION: CROSS CUT ON SOUTHEAST BOLT OF LIGHT POLE BASE AT THE NORTHWEST CORNER OF 51ST ST AND WELLS ST
- BENCH MARK NO. 3531 ELEV. 17.55**
DESCRIPTION: CROSS CUT ON NORTHEASTERLY FLANGE BOLT OF FIRE HYDRANT AT THE NORTHEAST CORNER OF GARFIELD BLVD AND WELLS ST
- BENCH MARK NO. 3532 ELEV. 18.84**
DESCRIPTION: HORIZONTAL BOLT ON CTA "EL" STRUCTURE, EAST SIDE OF WELLS ST ABOUT 50 FEET NORTH OF 59TH PL.
- BENCH MARK NO. 3533 ELEV. 19.71**
DESCRIPTION: BRASS DISK (CTA MONUMENT) AT THE SOUTHWEST CORNER OF 63RD ST AND HARVARD ST

- BENCH MARK NO. 3535 ELEV. 19.31**
DESCRIPTION: FOUND CROSS CUT ON SOUTHERLY FLANGE BOLT OF FIRE HYDRANT AT THE NORTHEAST CORNER OF 59TH ST AND WENTWORTH AVE
- BENCH MARK NO. 3536 ELEV. 18.37**
DESCRIPTION: CROSS CUT ON SOUTHEASTERLY FLANGE BOLT OF FIRE HYDRANT AT THE SOUTHEAST CORNER OF GARFIELD BLVD AND WENTWORTH AVE
- BENCH MARK NO. 3537 ELEV. 17.71**
DESCRIPTION: CROSS CUT ON NORTHEASTERLY FLANGE BOLT OF FIRE HYDRANT AT THE NORTHEAST CORNER OF 51ST ST AND WENTWORTH AVE
- BENCH MARK NO. 3538 ELEV. 17.31**
DESCRIPTION: CROSS CUT ON EASTERLY FLANGE BOLT OF FIRE HYDRANT AT THE NORTHEAST CORNER OF 47TH ST AND LASALLE ST
- BENCH MARK NO. 3544 ELEV. 19.38**
DESCRIPTION: CROSS CUT ON WESTERLY FLANGE BOLT OF FIRE HYDRANT AT THE NORTHWEST CORNER OF 67TH ST AND LAFAYETTE AVE
- BENCH MARK NO. 3545 ELEV. 10.53**
DESCRIPTION: CROSS CUT ON NORTHWEST BOLT OF LIGHT POLE BASE AT THE NORTHWEST CORNER OF 71ST ST AND LAFAYETTE AVE

- CURVE NBRMPO1**
P.I. STA= 8200+00.02
N= 1,858,147.27
E= 1,177,489.42
Δ= 4° 44' 18"
D= 28° 38' 52"
R= 200.00'
T= 8.27'
L= 16.54
E= 0.17'
e= N/A
T.R.= N/A
S.E. RUN= N/A
P.C. STA= 8199+91.75
N= 1,858,139.01
E= 1,177,489.70
P.T. STA= 8200+08.29
N= 1,858,155.49
E= 1,177,488.45
- CURVE NBRMPO2**
P.I. STA= 8208+54.00
N= 1,858,995.39
E= 1,177,389.40
Δ= 4° 55' 59"
D= 3° 49' 11"
R= 1,500.00'
T= 64.61'
L= 129.15
E= 1.39'
e= N/A
T.R.= N/A
S.E. RUN= N/A
P.C. STA= 8207+89.39
N= 1,858,931.22
E= 1,177,396.97
P.T. STA= 8209+18.54
N= 1,859,059.97
E= 1,177,387.38
- CURVE NBRMPO3**
P.I. STA= 8211+46.07
N= 1,859,287.39
E= 1,177,380.27
Δ= 0° 19' 12"
D= 0° 24' 36"
R= 13,976.00'
T= 39.03'
L= 78.05
E= 0.05'
e= N/A
T.R.= N/A
S.E. RUN= N/A
P.C. STA= 8211+07.05
N= 1,859,248.39
E= 1,177,381.49
P.T. STA= 8211+85.10
N= 1,859,326.41
E= 1,177,379.26
- CURVE NBRMPO4**
P.I. STA= 8212+33.29
N= 1,859,374.58
E= 1,177,378.02
Δ= 3° 40' 48"
D= 3° 49' 11"
R= 1,500.00'
T= 48.19'
L= 96.34
E= 0.77'
e= N/A
T.R.= N/A
S.E. RUN= N/A
P.C. STA= 8211+85.10
N= 1,859,326.41
E= 1,177,379.26
P.T. STA= 8212+81.44
N= 1,859,422.73
E= 1,177,379.88

- CURVE NBRMPO5**
P.I. STA= 8216+21.17
N= 1,859,762.21
E= 1,177,392.97
Δ= 3° 40' 25"
D= 2° 47' 17"
R= 1,500.00'
T= 48.10'
L= 96.17'
E= 0.77'
e= N/A
T.R.= N/A
S.E. RUN= N/A
P.C. STA= 8215+73.07
N= 1,859,714.14
E= 1,177,391.11
P.T. STA= 8216+69.24
N= 1,859,810.29
E= 1,177,391.74
- CURVE SBLOCSO1**
P.I. STA= 3391+35.61
N= 1,860,506.29
E= 1,177,130.62
Δ= 15° 38' 54"
D= 2° 47' 17"
R= 2,055.00'
T= 282.39'
L= 561.26'
E= 19.31'
e= 5.5%
T.R.= 41'
S.E. RUN= 196'
P.C. STA= 3388+53.23
N= 1,860,224.26
E= 1,177,144.78
P.T. STA= 3394+14.48
N= 1,860,774.05
E= 1,177,040.92

NOTES:
1. AVERAGE GRID TO GROUND CONVERSION FACTOR = 1.000010988654360

REVISIONS	
NAME	DATE

ILLINOIS DEPARTMENT OF TRANSPORTATION
F.A.I. 90/94 (DAN RYAN EXPRESSWAY)
59th ST TO 47th ST (FRONTAGE ROAD)
CITY OF CHICAGO LIGHTING CONDUIT & FOUNDATIONS
WELLS STREET

ALIGNMENT PLAN

SCALE: 1"=100'
DATE: February 11, 2005

DRAWN BY: NJH/AMM
CHECKED BY: JAL/MS



F.A.I. 90/94 SECTION 2004-067L COUNTY COOK TOTAL SHEETS 35 9
 STA. TO STA. ILLINOIS FED. AID PROJECT 62806
 SB I-94 EXPRESS LANES
 SB I-94 LOCAL LANES
 NB I-94 EXPRESS LANES
 NB I-94 LOCAL LANES
 SB RAMP
 NB RAMP
 SOUTHBOUND COLLECTOR/DISTRIBUTOR
 NORTHBOUND COLLECTOR/DISTRIBUTOR
 S. VINCENNES AVE
 S. LAFAYETTE AVE
 S. STATE ST
 W. 72nd ST
 W. 71st ST
 W. 69th ST
 MATCH LINE SB EXPRESS STA 1391+00