

62806

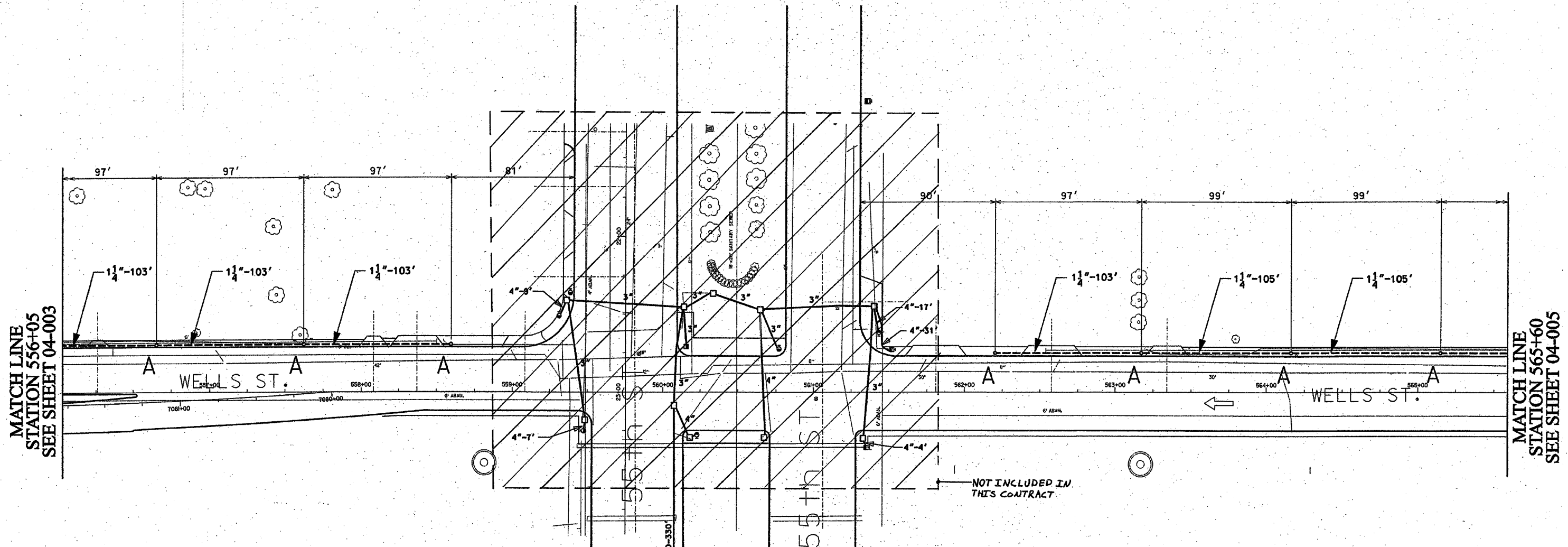

F. A. RTE	SECTION	COUNTY	TOTAL SHEETS	SHEET NO.
90/94	*	COOK	35	22
STA. 555+00		TO STA. 565+60		
FED. ROAD DIST. NO. 1		ILLINOIS	FED AID PROJECTS	

\* 2004-067L



MATCH LINE  
STATION 556+05  
SEE SHEET 04-003

MATCH LINE  
STATION 565+60  
SEE SHEET 04-005

- 1 1/4" DIRECT BORED CONDUIT SCHEDULE #80 AS PER IDOT ARTICLE 810.03
- ~~2" DIRECT BORED CONDUIT SCHEDULE #80 AS PER IDOT ARTICLE 810.03~~
- ~~2" CONDUIT SCHEDULE #40 INSTALLED IN TRENCH AS PER IDOT ARTICLE 810.03~~
- ~~2" GALVANIZED RIGID STEEL ELBOW ON STRUCTURE~~
- ~~2" GALVANIZED RIGID STEEL CONDUIT INSTALLED IN TRENCH AS PER IDOT ARTICLE 810.03~~
- ~~HAND HOLE 30" x 36" WITH 24" FRAME AND COVER~~
- CONCRETE FOUNDATION - 5' x 20", 10" B.C., 1" ANCHOR RODS

**NOTES:** CONTRACTOR IS TO INSTALL UNDERGROUND CONDUIT AND PULL ROPE BETWEEN FOUNDATIONS AS WELL AS PERFORM THE FOLLOWING WORK ITEMS ACCORDING TO BUREAU OF ELECTRICITY SPECIFICATIONS:

"A" - INSTALL 20" x 5' FOUNDATION, 10" B.C., 1" ANCHOR RODS AS PER DRAWING NO. 565, 2' OFF FACE OF CURB, UNLESS NOTED OTHERWISE. BUILD FOUNDATIONS FLUSH WITH SIDEWALK SURFACE.

"B" - INSTALL 30" HANDHOLE AS PER DRAWING NO. 867 WITH 24" FRAME AND COVER

FOR INSTALLATION PLAN SEE SHEETS 04-017, 04-018  
FOR REMOVAL PLAN SEE SHEET 04-025

CITY OF CHICAGO DEPT. OF STREETS AND SANITATION BUREAU OF ELECTRICITY DIVISION OF ELECTRICAL ENGINEERING		
DRAFTSMAN B. GARNSEY	CHIEF DRAFTSMAN ROBERT CARTER	ENGINEER B. GARNSEY
SUPERVISING ENGINEER	ELEC. DESIGN ENGR.	DWG. NO. <b>04-004</b>
ENGINEER OF ELECTRICITY:		DATE: 1/20/04
GEN'L SUPT. OF ELECTRICITY:		
DEPUTY COMMISSIONER:		
SIZES: 22"   36"	SCALE: 1"=30'	

ILLINOIS DEPARTMENT OF TRANSPORTATION  
F.A.I. 90/94 (DAN RYAN EXPRESSWAY)  
57th St. TO 47th St. (FRONTAGE ROADS)  
**STREET LIGHTING  
UNDERGROUND CONDUIT FACILITIES**

SCALE: 1" = 30'  
DATE: February 11, 2005  
DRAWN BY: B.T.G.  
CHECKED BY: O.L.

REVISIONS	
NAME	DATE