

FOR BIDDING AND CONSTRUCTION
SEE GENERAL NOTES 26 AND 27
ON SHEET 2.

NOTE: CONTRACTOR IS TO CONTACT ALL UTILITY COMPANIES TO
VERIFY EXACT LOCATION OF UNDERGROUND UTILITIES PRIOR
TO START OF CONSTRUCTION WORK. MOVE FOUNDATIONS AND
CONDUIT RUNS ACCORDINGLY.

FOR INSTALLATION PLAN SEE SHEET 04-024
FOR REMOVAL PLAN SEE SHEETS 04-027, 04-028

62807

F. A. RTE.	SECTION	COUNTY	TOTAL SHEETS	SHEET NO.
90/94		COOK	37	21
STA. 135+66	TO STA. 151+70			
FED. ROAD DIST. NO. 1	ILLINOIS	FED. AID PROJECTS		
* 2004-068L				

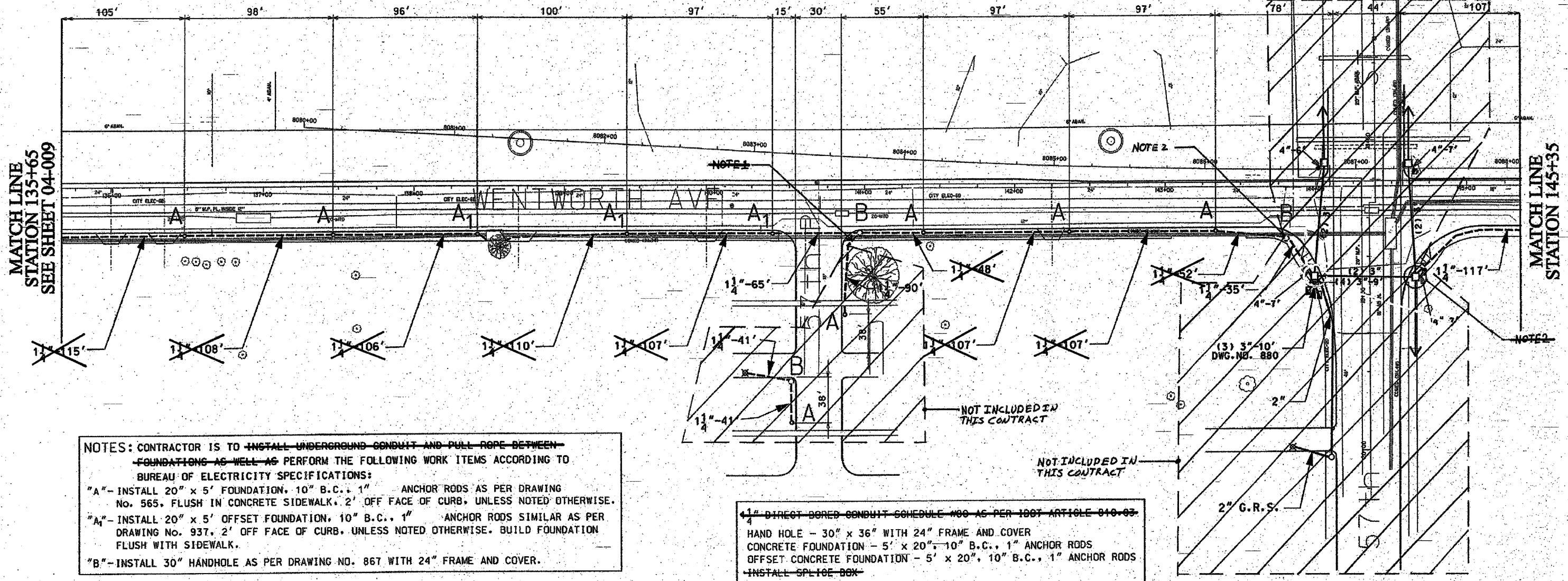

MATCH LINE
STATION 135+65
SEE SHEET 04-009

MATCH LINE
STATION 145+35

NOTES: CONTRACTOR IS TO ~~INSTALL UNDERGROUND CONDUIT AND PULL ROPE BETWEEN FOUNDATIONS AS WELL AS~~ PERFORM THE FOLLOWING WORK ITEMS ACCORDING TO BUREAU OF ELECTRICITY SPECIFICATIONS:
 "A"- INSTALL 20" x 5' FOUNDATION, 10" B.C., 1" ANCHOR RODS AS PER DRAWING NO. 565, FLUSH IN CONCRETE SIDEWALK, 2' OFF FACE OF CURB, UNLESS NOTED OTHERWISE.
 "A₁"- INSTALL 20" x 5' OFFSET FOUNDATION, 10" B.C., 1" ANCHOR RODS SIMILAR AS PER DRAWING NO. 937, 2' OFF FACE OF CURB, UNLESS NOTED OTHERWISE. BUILD FOUNDATION FLUSH WITH SIDEWALK.
 "B"- INSTALL 30" HANDHOLE AS PER DRAWING NO. 867 WITH 24" FRAME AND COVER.

~~1 1/4" DIRECT BORED CONDUIT SCHEDULE 400 AS PER 1007 ARTICLE 810-03.~~
 HAND HOLE - 30" x 36" WITH 24" FRAME AND COVER
 CONCRETE FOUNDATION - 5' x 20", 10" B.C., 1" ANCHOR RODS
 OFFSET CONCRETE FOUNDATION - 5' x 20", 10" B.C., 1" ANCHOR RODS
 INSTALL SPLICE BOX

NOT INCLUDED IN THIS CONTRACT

MATCH LINE
STATION 145+35

MATCH LINE
STATION 151+70
SEE SHEET 04-011

NOTES:
 1. PROVIDE A CONDUIT STUB AT HANDHOLE EXTENDING TO ONE FOOT PAST THE LIMITS OF SIDEWALK REPLACEMENT. PROVIDE A CONDUIT CAP FOR THE CONDUIT STUB. THE CONDUIT CAP WILL BE INCLUDED IN THE UNIT PRICE FOR THE CONDUIT OF SPECIFIED TYPE AND DIAMETER. SEPARATE PAYMENT WILL BE MADE. SEE DETAIL DRAWING NO. 62.796 FOR LIMITS OF SIDEWALK REPLACEMENT.
 2. ROUTE PROPOSED CONDUIT RUN TO THE EXISTING HANDHOLE OR HANDHOLE AS SHOWN. DRILL THE EXISTING HANDHOLE OR HANDHOLE AND INSTALL PROPOSED CONDUIT THROUGH THE HANDHOLE OR HANDHOLE WALL. SEE DRAWING B05-2 FOR DETAILS.

CITY OF CHICAGO DEPT. OF STREETS AND SANITATION BUREAU OF ELECTRICITY			
DRAFTSMAN P.R.S./B.T.G.	CHIEF DRAFTSMAN ROBERT CARTER	ENGINEER P.R.S./B.T.G.	DWG. NO. 04-010
SUPERVISING ENGINEER ELEC. DESIGN ENGR.		GEN'L. Supt. OF ELECTRICITY	
DEPUTY COMMISSIONER		DATE: 1/20/04	
ILLINOIS DEPARTMENT OF TRANSPORTATION F.A.I. 90/94 (DAN RYAN EXPRESSWAY) 57th St. to 47th St. (FRONTAGE ROADS)			

STREET LIGHTING
UNDERGROUND CONDUIT FACILITIES

SCALE: 1" = 30'
DATE: February 11, 2005
DRAWN BY: B.T.G.
CHECKED BY: O.L.

REVISIONS	
NAME	DATE