

62807

F. A. RTE	SECTION	COUNTY	TOTAL SHEETS	SHEET NO
90/94	*	COOK	37	21
STA. 135+65		TO STA. 151+70		
FED. ROAD DIST NO. 1		ILLINOIS		FED AID PROJECTS
* 2004-069L				

NOTE: CONTRACTOR IS TO CONTACT ALL UTILITY COMPANIES TO VERIFY EXACT LOCATION OF UNDERGROUND UTILITIES PRIOR TO START OF CONSTRUCTION WORK. MOVE FOUNDATIONS AND CONDUIT RUNS ACCORDINGLY.

FOR INSTALLATION PLAN SEE SHEET 04-021
FOR REMOVAL PLAN SEE SHEETS 04-027, 04-028

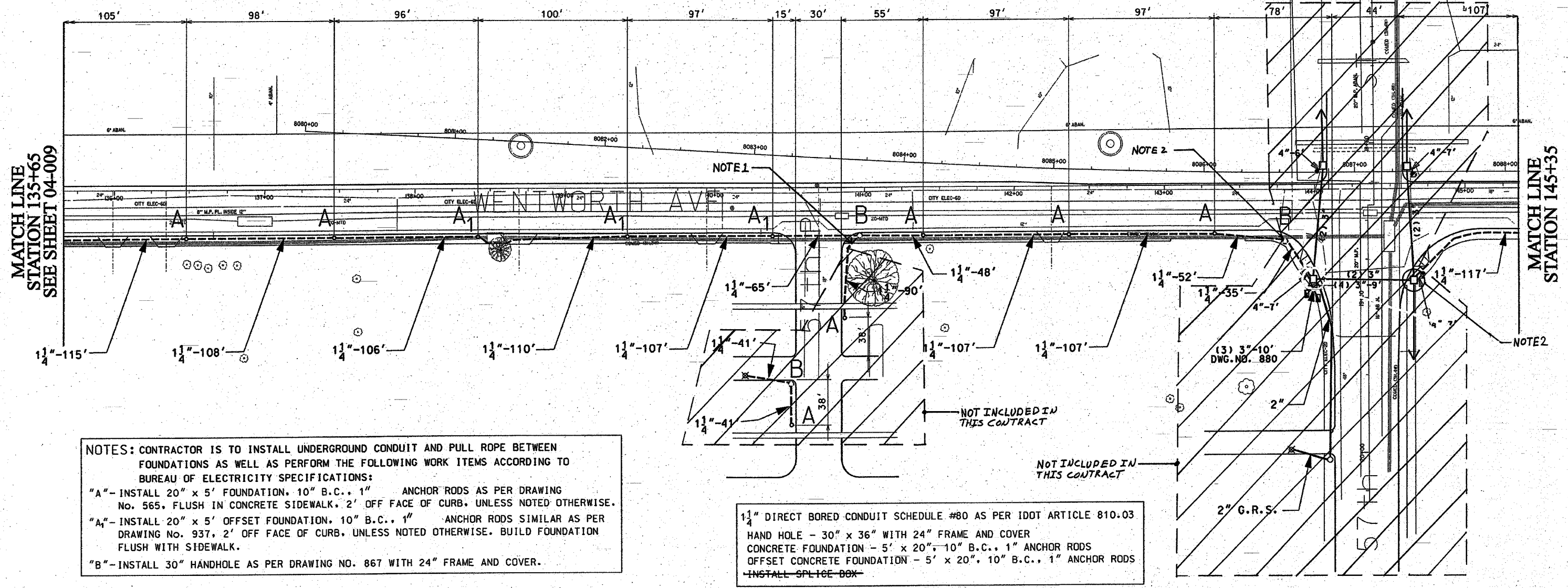
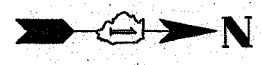

MATCH LINE
STATION 135+65
SEE SHEET 04-009

MATCH LINE
STATION 145+35

NOTES: CONTRACTOR IS TO INSTALL UNDERGROUND CONDUIT AND PULL ROPE BETWEEN FOUNDATIONS AS WELL AS PERFORM THE FOLLOWING WORK ITEMS ACCORDING TO BUREAU OF ELECTRICITY SPECIFICATIONS:
 "A"-INSTALL 20" x 5' FOUNDATION, 10" B.C., 1" ANCHOR RODS AS PER DRAWING NO. 565, FLUSH IN CONCRETE SIDEWALK, 2' OFF FACE OF CURB, UNLESS NOTED OTHERWISE.
 "A₁"-INSTALL 20" x 5' OFFSET FOUNDATION, 10" B.C., 1" ANCHOR RODS SIMILAR AS PER DRAWING NO. 937, 2' OFF FACE OF CURB, UNLESS NOTED OTHERWISE. BUILD FOUNDATION FLUSH WITH SIDEWALK.
 "B"-INSTALL 30" HANDHOLE AS PER DRAWING NO. 867 WITH 24" FRAME AND COVER.

1 1/4" DIRECT BORED CONDUIT SCHEDULE #80 AS PER IDOT ARTICLE 810.03
 HAND HOLE - 30" x 36" WITH 24" FRAME AND COVER
 CONCRETE FOUNDATION - 5' x 20", 10" B.C., 1" ANCHOR RODS
 OFFSET CONCRETE FOUNDATION - 5' x 20", 10" B.C., 1" ANCHOR RODS
 INSTALL SPLICE BOX

NOT INCLUDED IN THIS CONTRACT

MATCH LINE
STATION 145+35

MATCH LINE
STATION 151+70
SEE SHEET 04-011

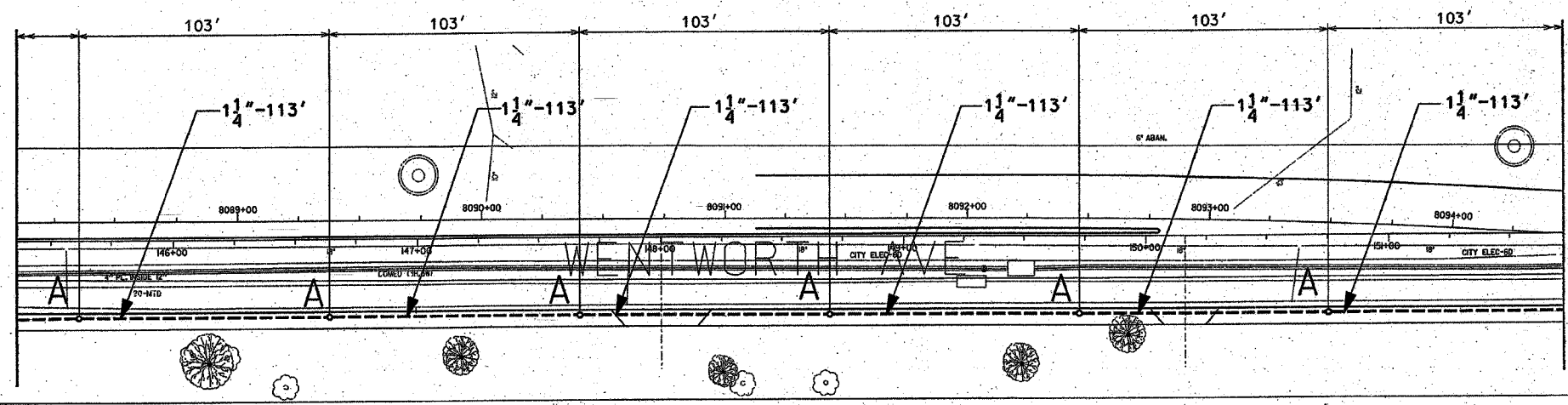

NOTES:

- PROVIDE A CONDUIT STUB AT HANDHOLE EXTENDING TO ONE FOOT PAST THE LIMITS OF SIDEWALK REPLACEMENT. PROVIDE A CONDUIT CAP FOR THE CONDUIT STUB. THE CONDUIT CAP WILL BE INCLUDED IN THE UNIT PRICE FOR THE CONDUIT OF SPECIFIED TYPE AND DIAMETER. NO SEPARATE PAYMENT WILL BE MADE. SEE IDOT CONTRACT NO. 62796 FOR LIMITS OF SIDEWALK REPLACEMENT.
- ROUTE PROPOSED CONDUIT RUN TO THE EXISTING MANHOLE OR HANDHOLE AS SHOWN. DRILL THE EXISTING MANHOLE OR HANDHOLE AND INSTALL PROPOSED CONDUIT THROUGH THE MANHOLE OR HANDHOLE WALL. SEE DRAWING BOE-2 FOR DETAILS.

CITY OF CHICAGO	
DEPT. OF STREETS AND SANITATION BUREAU OF ELECTRICITY DIVISION OF ELECTRICAL ENGINEERING	
DRAFTSMAN: P.R.S./B.T.G.	ENGINEER: P.R.S./B.T.G.
CHIEF DRAFTSMAN: ROBERT CARTER	ENGINEER: ELEC. DESIGN ENGR.
DWG. NO. 04-010	
ENGINEER OF ELECTRICITY:	
GEN'L SUPT. OF ELECTRICITY:	
DEPUTY COMMISSIONER:	
SIZE: 22" x 36"	SCALE: 1"=30'
DATE: 1/20/04	
ILLINOIS DEPARTMENT OF TRANSPORTATION F.A.I. 90/94 (DAN RYAN EXPRESSWAY) 59th St. TO 47th St. (FRONTAGE ROADS)	
STREET LIGHTING UNDERGROUND CONDUIT FACILITIES	
SCALE: 1" = 30'	
DRAWN BY: B.T.G.	
DATE: February 11, 2005	
CHECKED BY: O.L.	

REVISIONS	
NAME	DATE