

62807

F. A. RTE	SECTION	COUNTY	TOTAL SHEETS	SHEET NO.
90/94		COOK	37	23
STA. 161+10	TO STA. 176+30			
FED. ROAD DIST. NO. 1	ILLINOIS	FED AID PROJECTS		

* 2004-063L

MATCH LINE
STATION 161+10
SEE SHEET 04-011

MATCH LINE
STATION 169+95

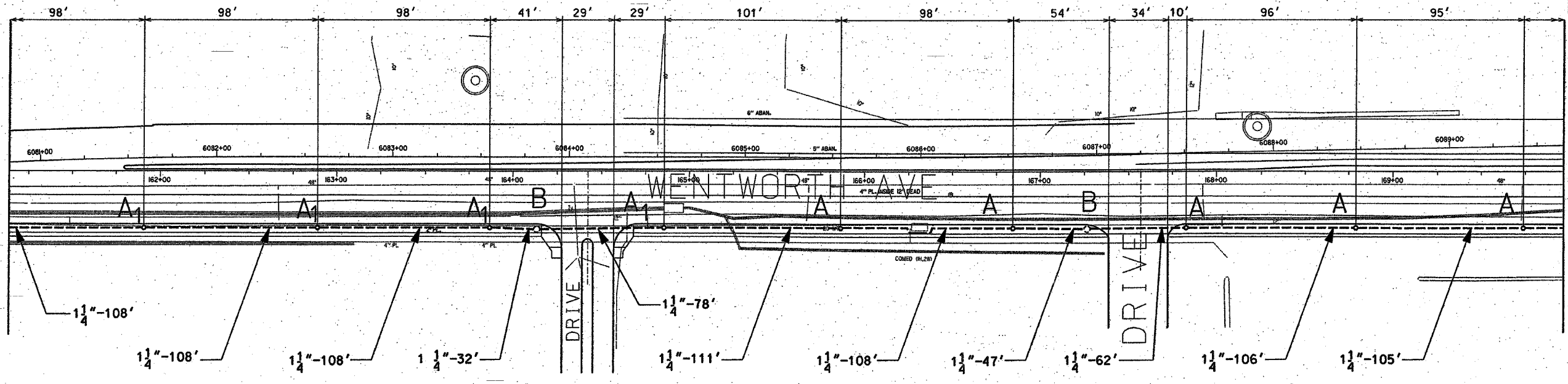

NOTE: CONTRACTOR IS TO CONTACT ALL UTILITY COMPANIES TO VERIFY EXACT LOCATION OF UNDERGROUND UTILITIES PRIOR TO START OF CONSTRUCTION WORK. MOVE FOUNDATIONS AND CONDUIT RUNS ACCORDINGLY.

NOTES: CONTRACTOR IS TO INSTALL UNDERGROUND CONDUIT AND PULL ROPE BETWEEN FOUNDATIONS AS WELL AS PERFORM THE FOLLOWING WORK ITEMS ACCORDING TO BUREAU OF ELECTRICITY SPECIFICATIONS:

"A"- INSTALL 20" x 5' FOUNDATION, 10" B.C., 1" ANCHOR RODS AS PER DRAWING NO. 565. FLUSH IN CONCRETE SIDEWALK, 2' OFF FACE OF CURB, UNLESS NOTED OTHERWISE.

"A1"- INSTALL 20" x 5' OFFSET FOUNDATION, 10" B.C., 1" ANCHOR RODS SIMILAR AS PER DRAWING NO. 937, 2' OFF FACE OF CURB, UNLESS NOTED OTHERWISE. BUILD FOUNDATION FLUSH WITH SIDEWALK.

"B"- INSTALL 30" HANDHOLE AS PER DRAWING NO. 867 WITH 24" FRAME AND COVER.

MATCH LINE
STATION 169+95

MATCH LINE
STATION 176+30
SEE SHEET 04-013

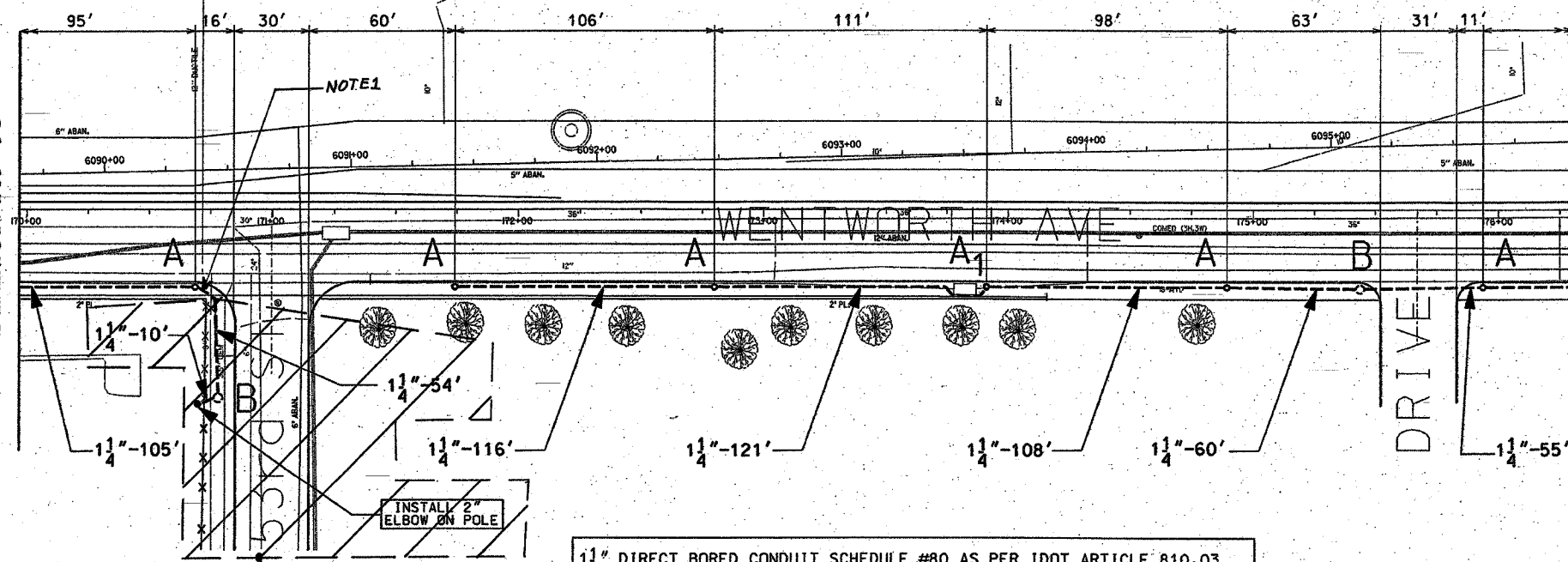

NOTES:

1. PROVIDE A CONDUIT STUB AT HANDHOLE EXTENDING TO ONE FOOT PAST THE LIMITS OF SIDEWALK REPLACEMENT. PROVIDE A CONDUIT CAP FOR THE CONDUIT STUB. THE CONDUIT CAP WILL BE INCLUDED IN THE UNIT PRICE FOR THE CONDUIT OF SPECIFIED TYPE AND DIAMETER. NO SEPARATE PAYMENT WILL BE MADE. SEE IDOT CONTRACT NO. 62796 FOR LIMITS OF SIDEWALK REPLACEMENT.

1 1/4" DIRECT BORED CONDUIT SCHEDULE #80 AS PER IDOT ARTICLE 810.03
 HAND HOLE - 30" x 36" WITH 24" FRAME AND COVER
 CONCRETE FOUNDATION - 5' x 20", 10" B.C., 1" ANCHOR RODS
 OFFSET CONCRETE FOUNDATION - 5' x 20", 10" B.C., 1" ANCHOR RODS
 2" GALVANIZED RIGID STEEL ELBOW ON STRUCTURE

FOR INSTALLATION PLAN SEE SHEET 04-022
 FOR REMOVAL PLAN SEE SHEET 04-028

NOT INCLUDED IN THIS CONTRACT

CITY OF CHICAGO DEPT. OF STREETS AND SANITATION BUREAU OF ELECTRICITY DIVISION OF ELECTRICAL ENGINEERING		
DRAFTSMAN P.R.S./ B.T.G.	CHIEF DRAFTSMAN ROBERT CARTER	ENGINEER P.R.S./ B.T.G.
SUPERVISING ENGINEER	ELEC. DESIGN ENGR.	DWG. NO.
ENGINEER OF ELECTRICITY:		04-012
GEN'L SUPT. OF ELECTRICITY:		
DEPUTY COMMISSIONER:		DATE: 1/20/04
SIZE: 22" 36"	SCALE: 1"=30'	

ILLINOIS DEPARTMENT OF TRANSPORTATION
 F.A.I. 90/94 (DAN RYAN EXPRESSWAY)
 59th St. TO 47th St. (FRONTAGE ROADS)

STREET LIGHTING
 UNDERGROUND CONDUIT FACILITIES

SCALE: 1" = 30'
 DATE: February 11, 2005
 DRAWN BY: B.T.G.
 CHECKED BY: O.L.

REVISIONS	
NAME	DATE