

ROUTE Various	SECTION 2004-089I	COUNTY COOK	TOTAL SHEETS 27	SHEET NUMBER 18
------------------	----------------------	----------------	--------------------	--------------------

CONTRACT 62833

BRIDGE NO.: 016-0161
I-94 OVER DOLTON AVE.

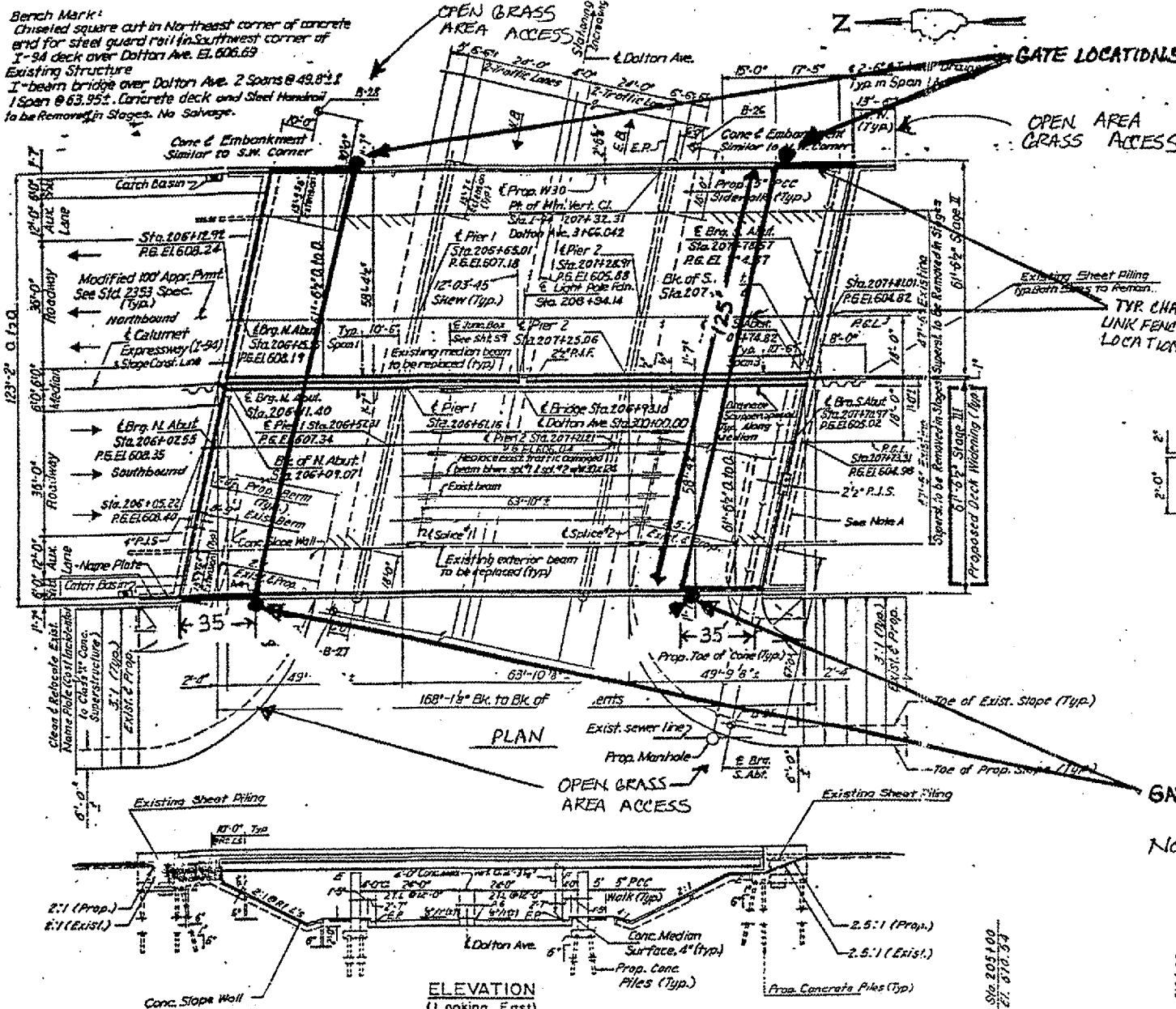

GENERAL NOTES:
DESIGN SPECIFICATIONS:
 A.A.S.H.T.O. 1983 Standard Specifications for Highway Bridges, and 1984 thru 1988 Interims.
 1983 Guide Specifications for Seismic Design of Highway Bridges with 1985 and 1988 Interim Specifications.
DESIGN CRITERIA:
 Service Load Design - Load Factor for Deck
 Live Load = HS 20-44 & AIT

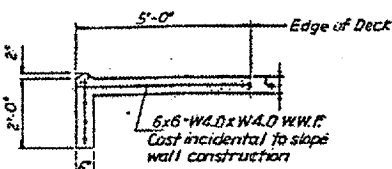
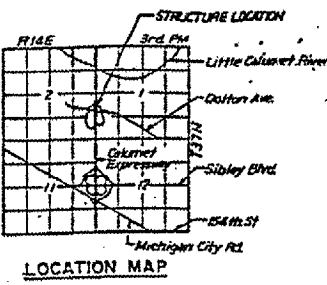

Allow 25 psf for Future Wearing Surface
DESIGN STRESSES
 Existing Structural Steel
 $f_s = 18,000$ psi, ASTM A7 & $f_s = 20,000$,
 ASTM A36 (M183 Steel Beam 16 Repair)
 Proposed Structural Steel
 $f_s = 20,000$ psi, (M183 Steel)
 Reinforced Concrete
 $f_c = 3500$ psi - Superstructure Composite Deck Slab
 $f_c = 1400$ psi - Substructure
 $f_s = 1000$ psi with earth pressure
 $n = 9$

REINFORCEMENT:
 $f_y = 60,000$ psi - Superstructure
 $f_s = 24,000$ psi - Substructure

TRAFFIC:
 All barricades, signs and other traffic control devices and their placement installed for the purpose of temporarily maintaining traffic during construction shall be in full compliance with the Illinois State Manual on Uniform Traffic Control Devices unless otherwise noted. The Contractor shall procure, install and remove all temporary pavement markings as per the traffic phasing shown on the plans or as directed by the Engineer. See Roadway Plans.

STATION 6+93.11
 RE-BUILT BY
 STATE OF ILLINOIS
 PROJECT ACCA-16-BHX-9A-
 2(307) TO
 LOADING HS 20 & ALL
 STR. No. 016-0161

NAME PLATE
 See Standard 2113

Indicates Removal of Existing Concrete Deck Slab.
 Indicates Boring Locations.

NOTE: GO 35' FROM ABUTMENT AND RUN FENCE ACROSS TO OTHER SIDE.

LOCATION NO. 10

DESCRIPTION	UNIT	QUANTITY
CHAIN LINK FENCE 8'	FOOT	346.00
CHAIN LINK GATES 8'X6' SINGLE	EACH	4.0

APPROVED
 FOR STRUCTURAL ADEQUACY ONLY
 Robert E. Anderson
 Engineer of Bridges and Structures



Sauder Bennett Date 8/16/90
 Exp. Date 11/30/92

PROPOSED PROFILE I-94 PROPOSED PROFILE -DOLTON AVE.

STAGE III - S.B. MAINLINE CONSTRUCTION
 STATE OF ILLINOIS
 DEPARTMENT OF TRANSPORTATION
 PLAN AND ELEVATION
 I-94 OVER DOLTON AVE.
 COOK COUNTY
 STA. 206+93.10 S.N. 016-0161
 SCALE DRAWN BY KCB/IMG
 DATE: NOV. 1991 CHECKED BY L.W.