

ROUTE	SECTION	COUNTY	TOTAL SHEETS	SHEET NUMBER
Various	2004-0891	COOK	27	20

CONTRACT 62833

BRIDGE No.: 016-0163
I-94 OVER LITTLE CALUMET RIVER

Station - About 0.12 mile N. of the Quarter Corner between Sec. 11 & 12, 93° S.E. of the Center of the intersection in a Triangular Strip of Ground and Between 2 Telephone Poles on top of a Concrete Post. Bronze Tablet Stamped "P.M. Tav. Sta. 53-1924-23-GR-1925" Elev. 606.815

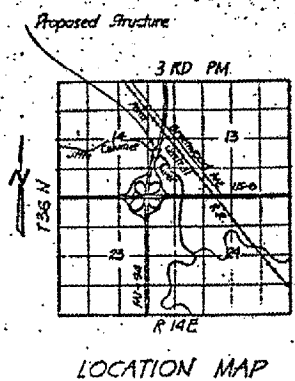
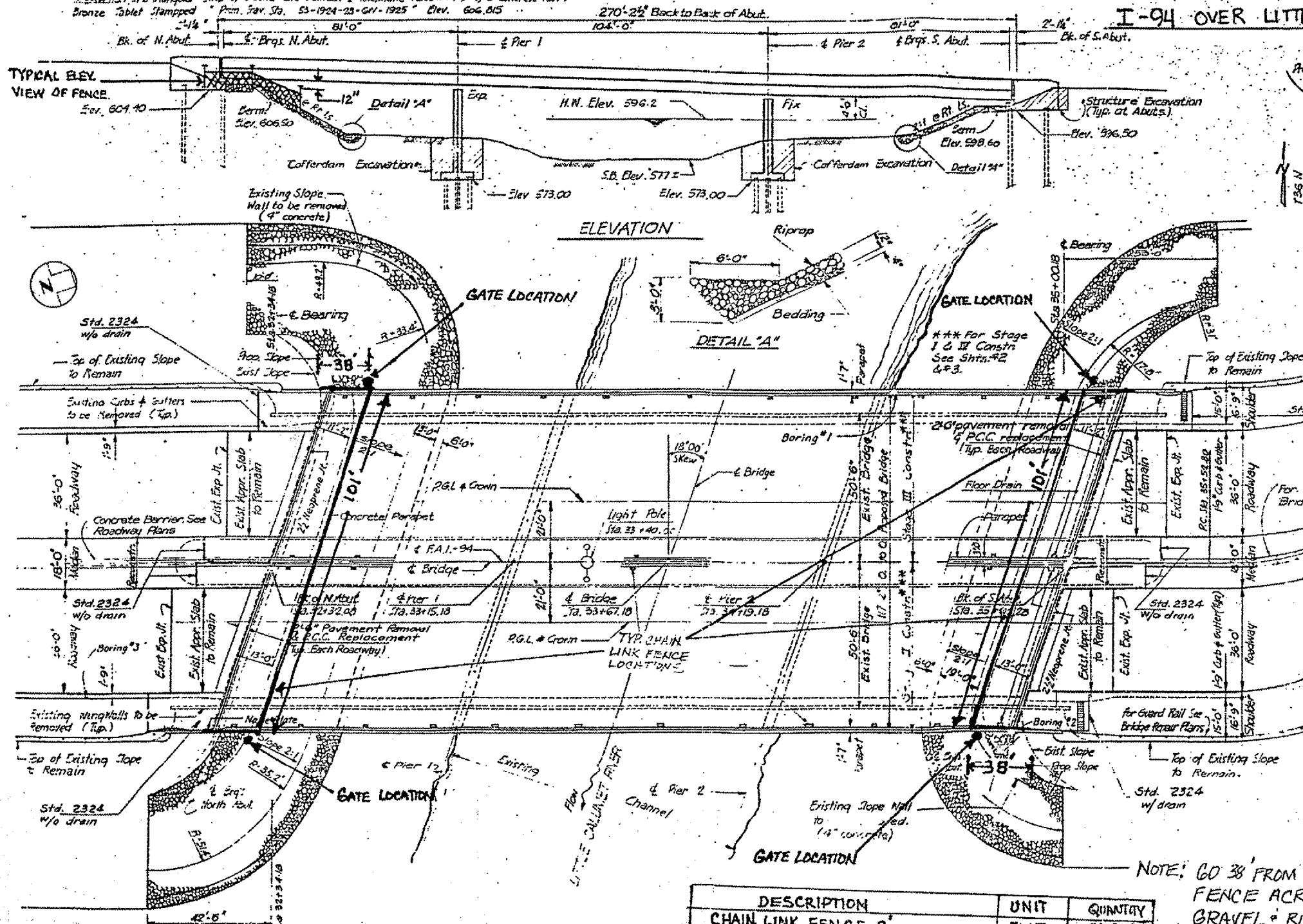

LOCATION NO. 12

WATERWAY INFORMATION
 Q 50 = 4890 cfs
 DHNE = 596.2
 Waterway Opening = 2200
 Q 100 = 5290 cfs
 HWE (100 yr) = 596.0
 Regulatory Flood Discharge = 8560 cfs
 Regulatory Flood Elev. = 598.4

CURVE DATA
 A = 23°24'14"
 D = 1°16"
 T = 936.89'
 L = 1847.67'
 E = 96.02'
 R = 4523.44'

NOTE: GO 38' FROM ABUTMENT AND RUN FENCE ACROSS TO OTHER SIDE GRAVEL & RIPRAP SLOPE ACCESS AREA IS VERY POOR & LIMITED (HEAVY VEGETATED AREA)

DESCRIPTION	UNIT	QUANTITY
CHAIN LINK FENCE 8'	FOOT	330.0
CHAIN LINK GATES 8'x6' SINGLE	EACH	4.0

EXISTING STRUCTURE
 SUPERSTRUCTURE: P.C. Deck on steel Beams 52'-0" long 10'-0" wide
 SUBSTRUCTURE: Abutments - Conc. Pile Bent; Piers - 2x2x12 on pile