

STATE OF ILLINOIS
DEPARTMENT OF TRANSPORTATION

ROUTE NO.	SECTION	COUNTY	DATE	SHEET NO.	SHEET NO. 10 14 SHEETS
FAP 305	*	Cook	72	68	
FED. ROAD DIST. NO. 7		ILLINOIS		FED. AID PROJECT	
				Contract No. 62853 *2004-108 BR	

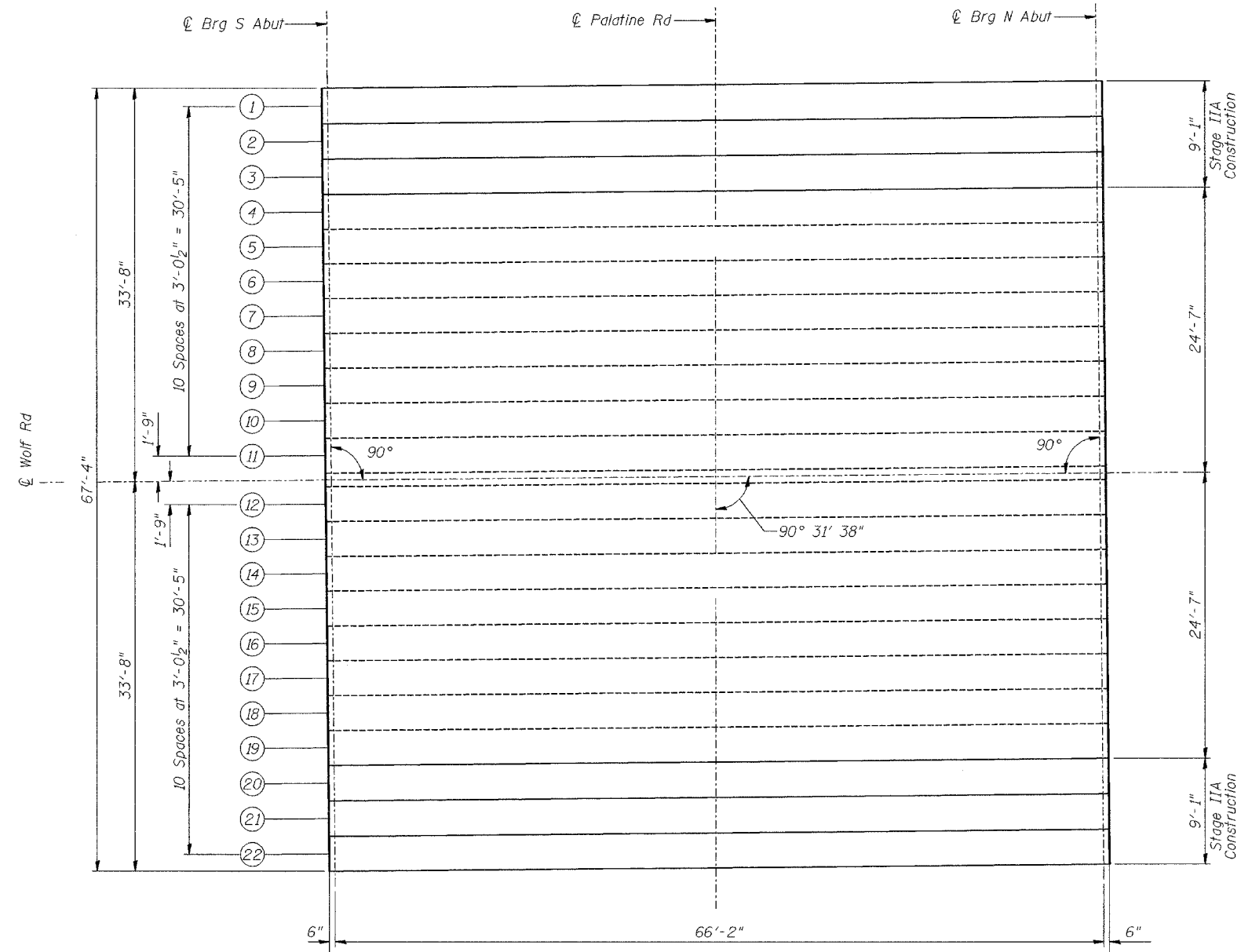

PLAN

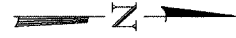
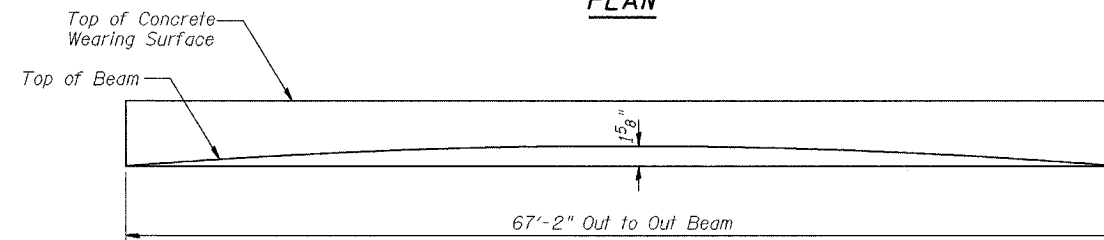

INITIAL CAMBER DIAGRAM

DESIGNED	BPS
CHECKED	KFA
DRAWN	MJB
CHECKED	GSP

FRAMING PLAN
WOLF RD. OVER PALATINE RD.
F.A.P. RTE. 305 SECT. 2004-108 BR
COOK COUNTY
STATION 950+00.00
STRUCTURE NO. 016-0680