

F.A.I. RTE.	SECTION	COUNTY	TOTAL SHEETS	SHEET NO.
290	0305-302K-1-3	COOK	55	27
STA. TO STA.		FED. ROAD DIST. NO. 1 ILLINOIS FED. AID PROJECT		

LEGEND

	EXISTING LIGHTING UNIT		UNIT DUCT
	REINSTALLED EXISTING LIGHTING UNIT		GROUND ROD
	EXISTING LIGHTING CONTROLLER SINGLE TYPE EXISTING		PROPOSED LIGHTING DECAL
	LIGHTING CONTROLLER, DUPLEX TYPE PROPOSED		EXISTING LIGHTING DECAL
	CONDUIT PUSHED		

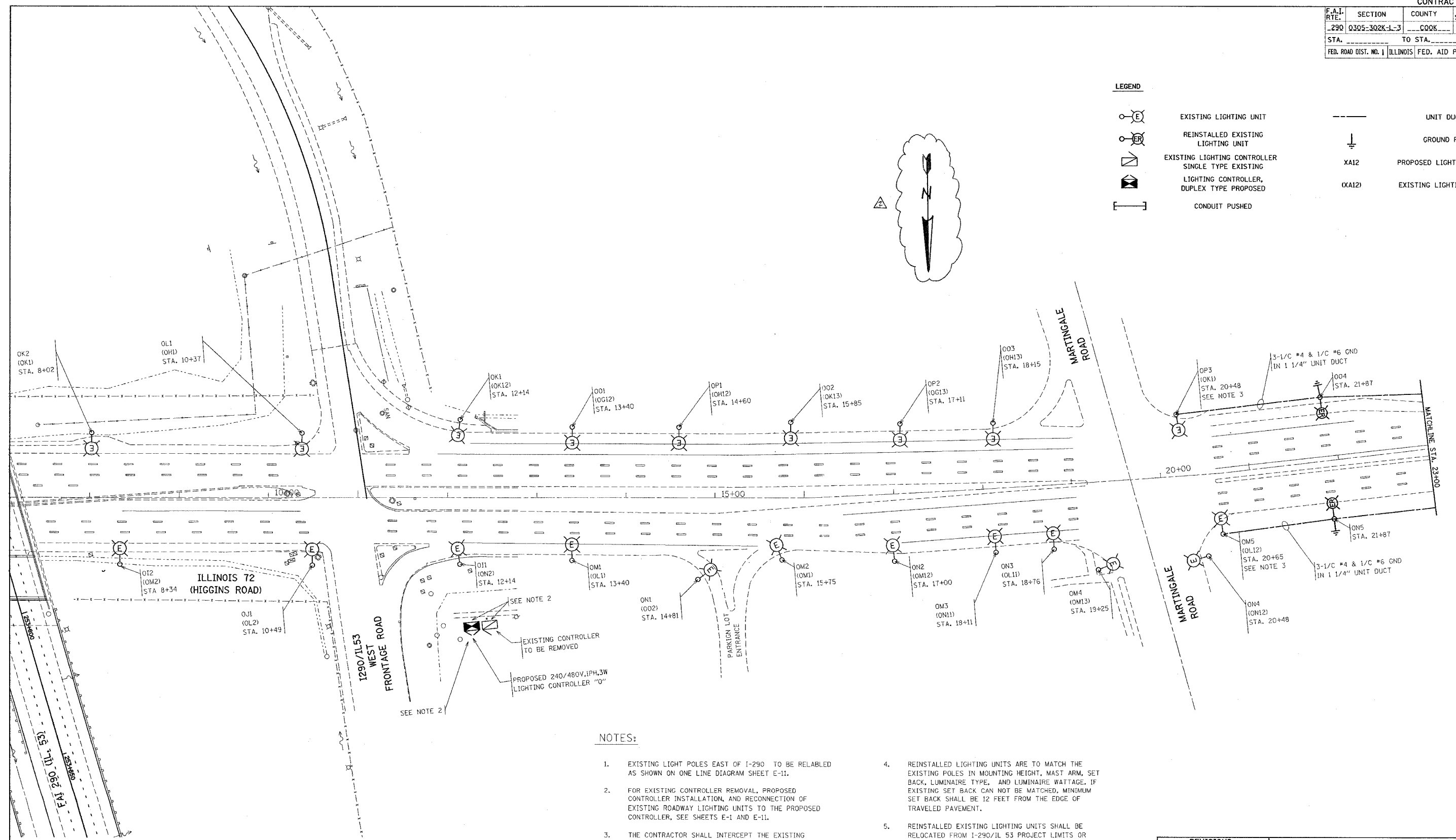
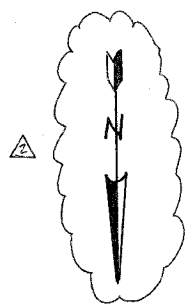

NOTES:

1. EXISTING LIGHT POLES EAST OF I-290 TO BE RELABELED AS SHOWN ON ONE LINE DIAGRAM SHEET E-11.
2. FOR EXISTING CONTROLLER REMOVAL, PROPOSED CONTROLLER INSTALLATION, AND RECONNECTION OF EXISTING ROADWAY LIGHTING UNITS TO THE PROPOSED CONTROLLER, SEE SHEETS E-1 AND E-11.
3. THE CONTRACTOR SHALL INTERCEPT THE EXISTING CIRCUITS AND EXTEND TO THE RELOCATED LIGHTING UNITS. PROVIDE NEW UNIT DUCT. COORDINATE EXACT ROUTING OF UNIT DUCT IN THE FIELD. THIS WORK IS PAID FOR UNDER THE PAY ITEM FOR UNIT DUCT OF THE TYPE SPECIFIED.
4. REINSTALLED LIGHTING UNITS ARE TO MATCH THE EXISTING POLES IN MOUNTING HEIGHT, MAST ARM, SET BACK, LUMINAIRE TYPE, AND LUMINAIRE WATTAGE. IF EXISTING SET BACK CAN NOT BE MATCHED, MINIMUM SET BACK SHALL BE 12 FEET FROM THE EDGE OF TRAVELED PAVEMENT.
5. REINSTALLED EXISTING LIGHTING UNITS SHALL BE RELOCATED FROM I-290/IL 53 PROJECT LIMITS OR DELIVERED FROM STATE STOCK, AS DIRECTED BY THE ENGINEER.
6. REPLACEMENT LUMINAIRES FOR THE EXISTING AND RELOCATED LIGHTING UNITS ON HIGGINS ROAD RECONNECTED TO PROPOSED CONTROLLER "O" SHALL BE DELIVERED FROM STATE STOCK. BALLASTS SHALL BE SET FOR 240 VOLT OPERATION. THIS WORK SHALL BE PAID FOR UNDER THE PAY ITEM FOR LUMINAIRE (INSTALL ONLY), OF THE TYPE SPECIFIED.

Rev 9-13-05

E-14

REVISIONS		DATE
NAME		

ILLINOIS DEPARTMENT OF TRANSPORTATION

IL-72 (HIGGINS ROAD)
LIGHTING RELOCATION
PLANS

SCALE: VERT. 1"=50'
HORIZ. DATE 4/7/2005

DRAWN BY MP
CHECKED BY SL

PLOT DATE = 4/7/2005
FILE NAME = c:\projects\62877\ah_01.dgn
PLOT SCALE = 1/8"=1'-0"
USER NAME = lupton