

IF.A. RTE.	SECTION	COUNTY	TOTAL SHEETS	SHEET NO.
55	2004-118 GRR	WILL	14	9
STA. 1347+00 TO		STA. 1352+19		
FED. ROAD DIST. NO.		ILLINOIS	FED. AID PROJECT	
D-91-074-05				

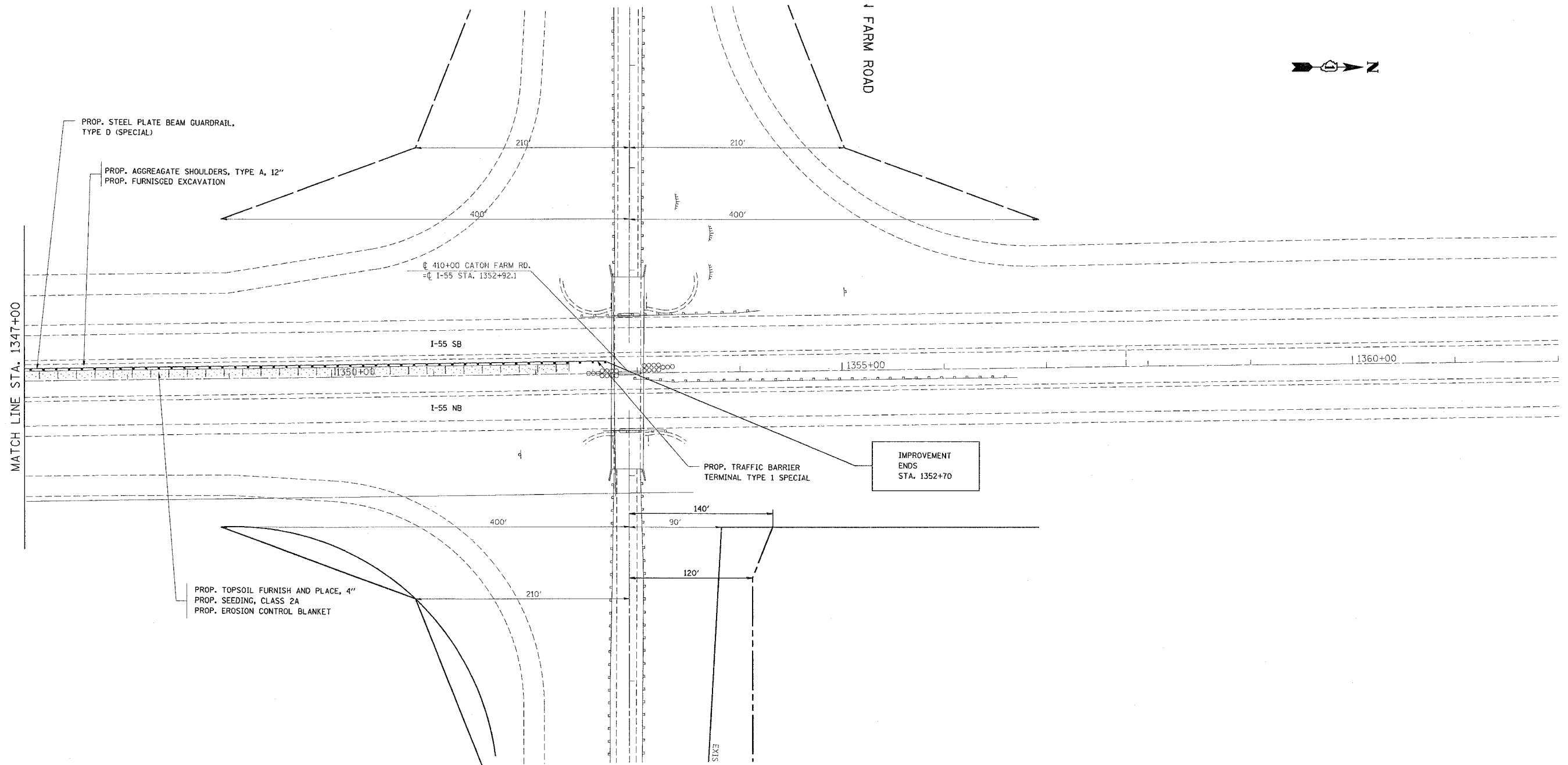

PROP. STEEL PLATE BEAM GUARDRAIL, TYPE D (SPECIAL)

PROP. AGGREGATE SHOULDERS, TYPE A, 12"  
PROP. FURNISHED EXCAVATION

410+00 CATON FARM RD.  
I-55 STA. 1352+92.1

I-55 SB

I-55 NB

PROP. TRAFFIC BARRIER TERMINAL TYPE 1 SPECIAL

IMPROVEMENT ENDS STA. 1352+70

PROP. TOPSOIL FURNISH AND PLACE, 4"  
PROP. SEEDING, CLASS 2A  
PROP. EROSION CONTROL BLANKET

EXIS

MATCH LINE STA. 1347+00

PLOT DATE = 6/14/2005  
PLOT SCALE = 500/2000' / IN.  
REFERENCE = #REF#

REVISIONS	
NAME	DATE

ILLINOIS DEPARTMENT OF TRANSPORTATION

FAI 55/ I-55

CATON FARM ROAD TO N/O BLACK ROAD

EXISTING / PROPOSED ROADWAY PLAN

SCALE: VERT.      DRAWN BY: HMO  
          HORIZ.      CHECKED BY

DATE