

F.A.I. RTE.	SECTION	COUNTY	TOTAL SHEETS	SHEET NO.
94		COOK	39	34
STA. 2210+00.00		TO STA. 2356+00.00		
FED. ROAD DIST. NO.		ILLINOIS FED. AID PROJECT		
(1516.1, 1717 & 1818) I-5				62934

MATCHLINE SB I-94 STA. 1328+00.00 (PREV. SHEET)

MATCHLINE SB I-94 STA. 1343+00.00 (BELOW)

MATCHLINE SB I-94 STA. 1343+00.00 (ABOVE)

MATCHLINE SB I-94 STA. 1358+00.00 (NEXT SHEET)

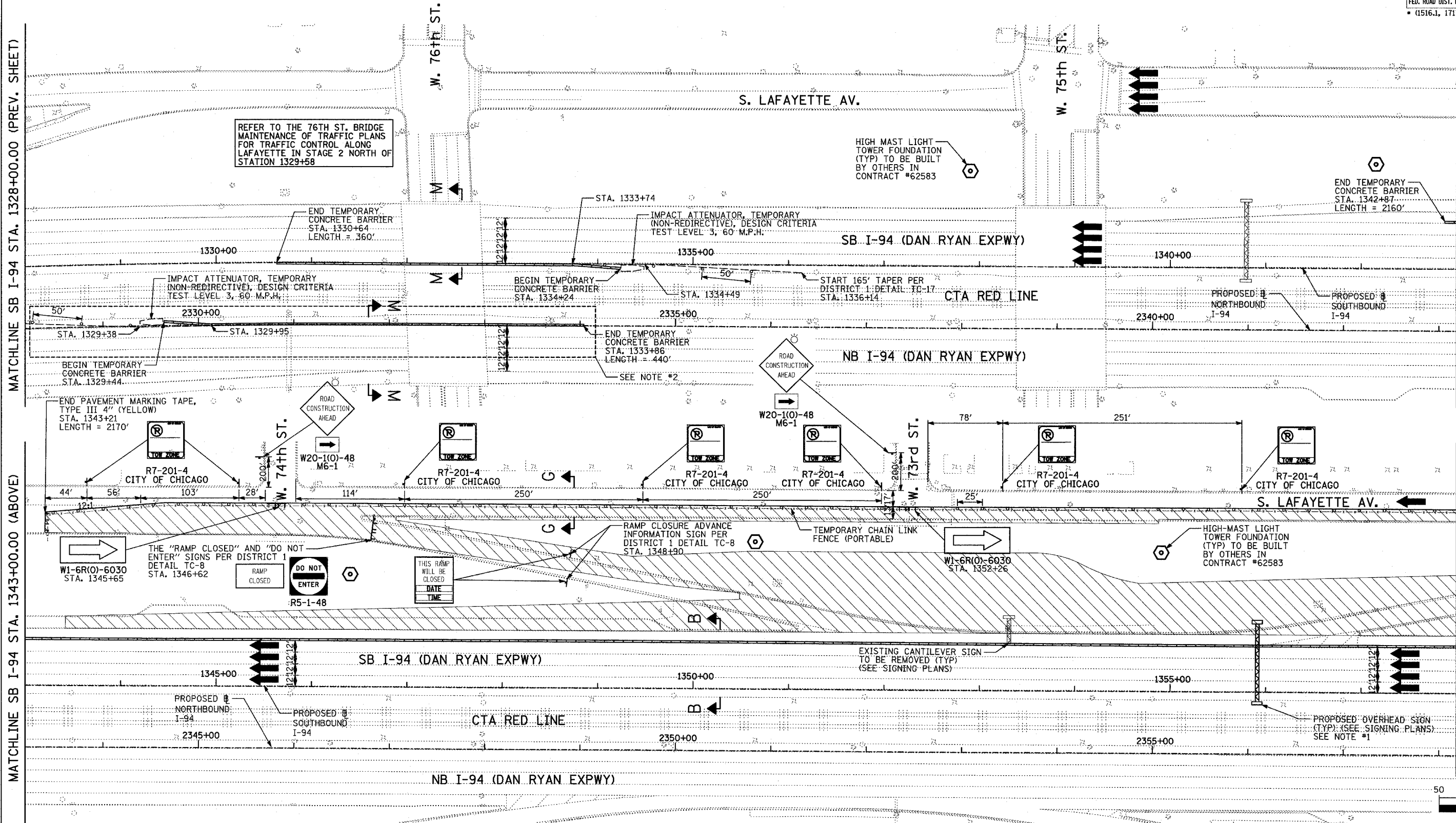

REFER TO THE 76TH ST. BRIDGE MAINTENANCE OF TRAFFIC PLANS FOR TRAFFIC CONTROL ALONG LAFAYETTE IN STAGE 2 NORTH OF STATION 1329+58

HIGH MAST LIGHT TOWER FOUNDATION (TYP) TO BE BUILT BY OTHERS IN CONTRACT #62583

END TEMPORARY CONCRETE BARRIER STA. 1342+87 LENGTH = 2160'

END TEMPORARY CONCRETE BARRIER STA. 1330+64 LENGTH = 360'

IMPACT ATTENUATOR, TEMPORARY (NON-REDIRECTIVE), DESIGN CRITERIA TEST LEVEL 3, 60' M.P.H.

BEGIN TEMPORARY CONCRETE BARRIER STA. 1334+24

START 165' TAPER PER DISTRICT 1: DETAIL TC-17 STA. 1336+14

PROPOSED NORTHBOUND I-94

PROPOSED SOUTHBOUND I-94

BEGIN TEMPORARY CONCRETE BARRIER STA. 1329+44

END TEMPORARY CONCRETE BARRIER STA. 1333+86 LENGTH = 440'

ROAD CONSTRUCTION AHEAD

END PAVEMENT MARKING TAPE, TYPE III 4" (YELLOW) STA. 1343+21 LENGTH = 2170'

ROAD CONSTRUCTION AHEAD

W20-1(O)-48 M6-1

R7-201-4 CITY OF CHICAGO

R7-201-4 CITY OF CHICAGO

R7-201-4 CITY OF CHICAGO

R7-201-4 CITY OF CHICAGO

R7-201-4 CITY OF CHICAGO

W1-6R(O)-6030 STA. 1345+65

THE "RAMP CLOSED" AND "DO NOT ENTER" SIGNS PER DISTRICT 1 DETAIL TC-8 STA. 1346+62

RAMP CLOSED

DO NOT ENTER

R5-1-48

THIS RAMP WILL BE CLOSED DATE TIME

RAMP CLOSURE ADVANCE INFORMATION SIGN PER DISTRICT 1 DETAIL TC-8 STA. 1348+90

TEMPORARY CHAIN LINK FENCE (PORTABLE)

W1-6R(O)-6030 STA. 1352+26

HIGH-MAST LIGHT TOWER FOUNDATION (TYP) TO BE BUILT BY OTHERS IN CONTRACT #62583

EXISTING CANTILEVER SIGN TO BE REMOVED (TYP) (SEE SIGNING PLANS)

PROPOSED OVERHEAD SIGN (TYP) (SEE SIGNING PLANS) SEE NOTE #1

NOTES:

- SEE MOT DETAILS FOR LANE NARROWING REQUIRED TO ALLOW SIGN WORK WITHIN THE INSIDE SHOULDER.
- CONTRACTOR SHALL COORDINATE WORK ON NB I-94 WITH CONTRACT #62694 TO CONSTRUCT THE 76TH ST. BRIDGE PIERS.

FOR INFORMATION ONLY

LEGEND:

- TEMPORARY CONCRETE BARRIER
- TRAFFIC LANE
- WORK ZONE
- BARRICADE, TYPE III
- DRUM WITH MONO-DIRECTIONAL STEADY BURNING LIGHT
- ARROW BOARD

REVISIONS	
NAME	DATE

ILLINOIS DEPARTMENT OF TRANSPORTATION
F.A.I. 94 (DAN RYAN EXPRESSWAY)
 MAINTENANCE OF TRAFFIC PLAN
 SB I-94 - STAGE 1
 SB I-94 STA. 1328+00 TO 1358+00
 CONTRACT #62695 (17B) - SHEET 1 OF 3
 SCALE: 1"=50'-0"
 DATE: JULY 8, 2005
 DRAWN BY: JPA, RTM
 CHECKED BY: MAG, JPM

TYLIN INTERNATIONAL

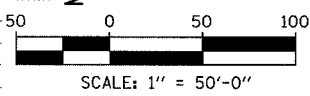
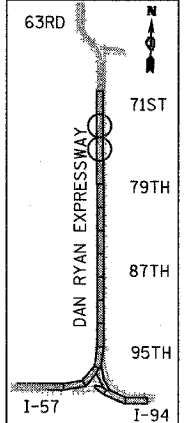

07/11/2005 12:37:48 PM