

F.A.P. RTE.	SECTION	COUNTY	TOTAL SHEETS	SHEET NO.
103	27-1R	ST. CLAIR	382	29
STA. 205+00.00 TO STA. 220+00.00		CONTRACT NO. 76300		
FED. ROAD DIST. NO. ILLINOIS		TEMP. CONSTRUCTION ESMT.		

NOTE:  
SEE SHEET 166 FOR INTERSECTION  
DETAIL FOR JEFFERSON ROAD AND  
ACCESS ROAD RT. 2

NOTE:  
SEE SHEET 172 FOR INTERSECTION  
DETAIL FOR PHANNIBACKER ROAD

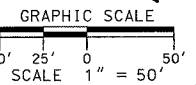

DENOTES  
EXISTING  
PAVEMENT

UNDERGROUND FACILITIES, STRUCTURES AND UTILITIES HAVE BEEN PLOTTED FROM FIELD MEASUREMENTS AND AVAILABLE RECORDS. THEIR LOCATIONS MUST THEREFORE BE CONSIDERED APPROXIMATE. THERE MAY BE OTHERS, THE EXISTENCE OF WHICH IS NOT PRESENTLY KNOWN. IT IS THE CONTRACTOR'S RESPONSIBILITY TO HAVE ALL UTILITIES LOCATED IN THE FIELD PRIOR TO CONSTRUCTION TO AVOID DAMAGE THERETO.

TBM #1 - TOP 1/2" IRON PIN w/IDOT CAP,  
CP #9811 3.31' RT., STA. 205+33.47,  
ELEV. 521.38

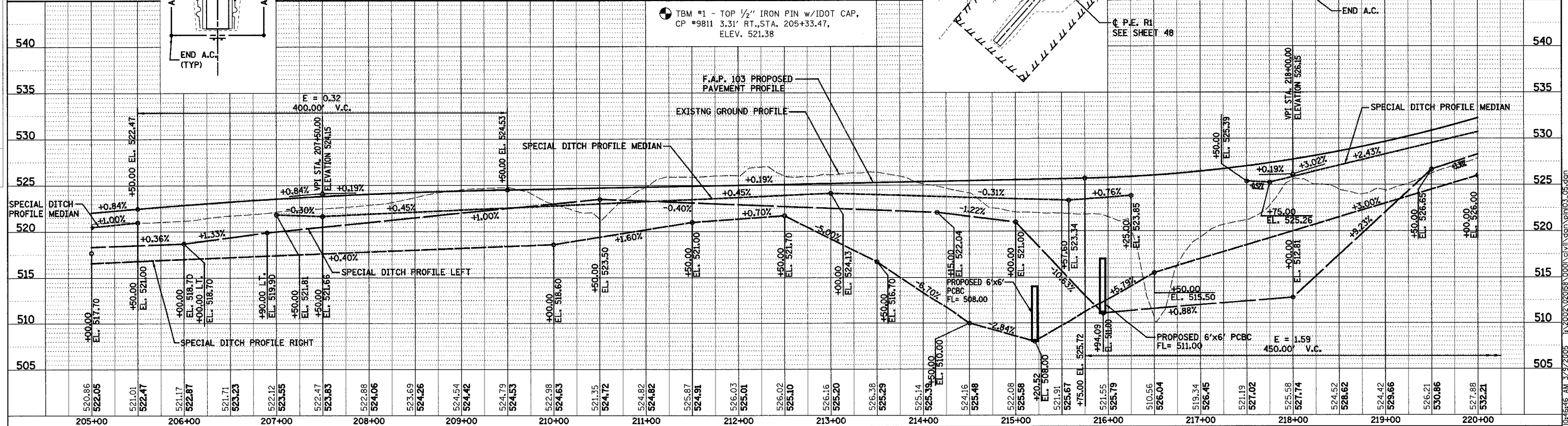

PLAN	SURVEYED	DATE
NOTE BOOK	BY	
NO.		

PROFILE	SURVEYED	DATE
NOTE BOOK	BY	
NO.		

104646 AM 3/5/2005 J:\2002\020158\000\GVI\NSG\p103.dgn

PLAN & PROFILE - F.A.P. 103