

F.A.P. RTE.	SECTION	COUNTY	TOTAL SHEETS	SHEET NO.
103	27-1R	ST. CLAIR	382	47
STA. 114+00.00		TO STA. 118+00.00		
FED. ROAD DIST. NO.		ILLINOIS FED. AID PROJECT		
CONTRACT NO. 76300				

PROP. CURVE P.AR.L1A-3
 P1 STA. = 114+02.90
 $\Delta = 6^\circ 51' 09''$ (RT)
 $D = 2^\circ 17' 31''$
 $R = 2,500.00'$
 $T = 149.68'$
 $L = 299.00'$
 $E = 4.48'$
 $e = 1.56\%$
 $T.R. = 27'$
 $S.E. RUN = 27'$
 $P.C. STA. = 112+53.22$
 $P.T. STA. = 115+52.22$

PLAN	SURVEYED	BY	DATE
NOTE BOOK	NOTED		
NO.	NO.		

PROFILE	SURVEYED	BY	DATE
NOTE BOOK	NOTED		
NO.	NO.		

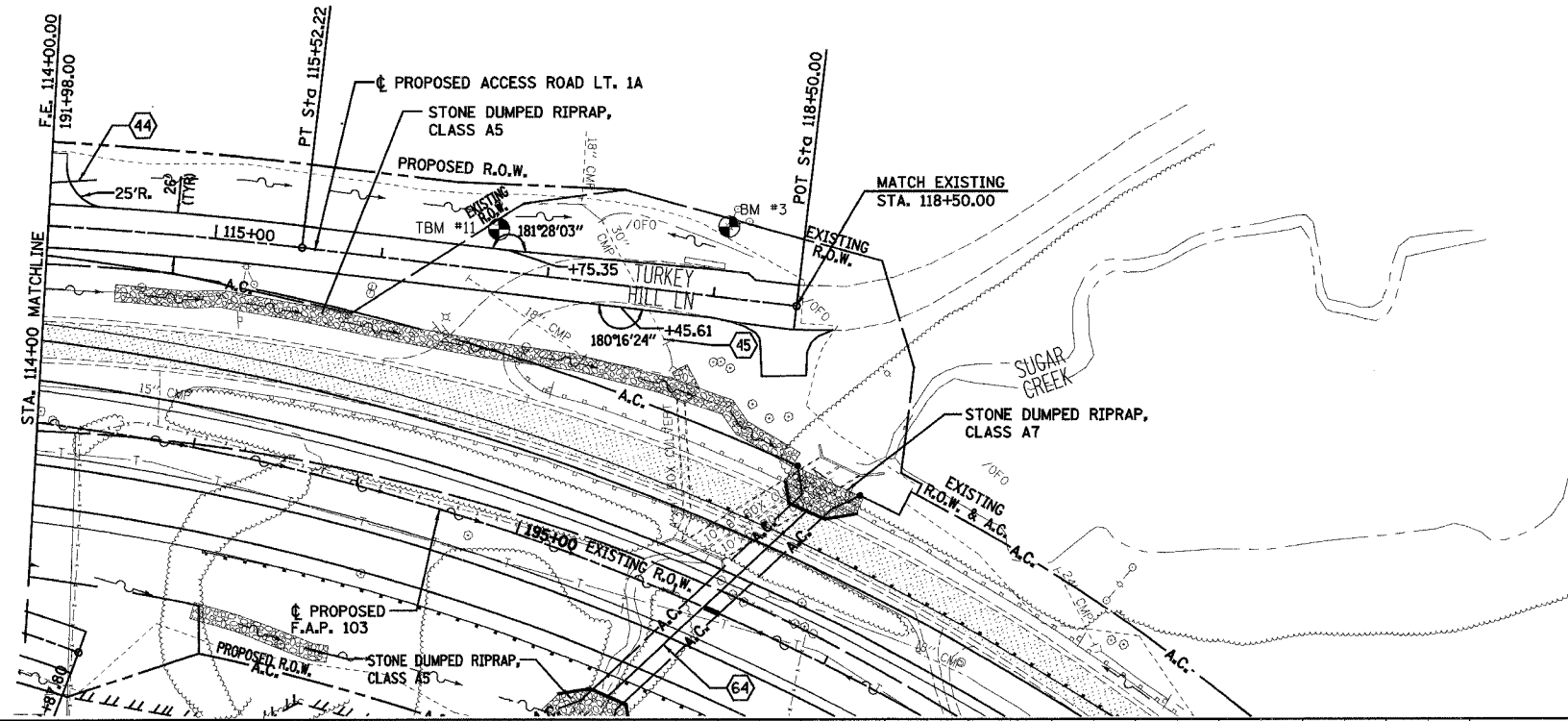
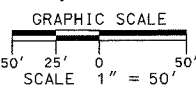

UNDERGROUND FACILITIES, STRUCTURES AND UTILITIES HAVE BEEN PLOTTED FROM FIELD MEASUREMENTS AND AVAILABLE RECORDS. THEIR LOCATIONS MUST THEREFORE BE CONSIDERED APPROXIMATE. THERE MAY BE OTHERS, THE EXISTENCE OF WHICH IS NOT PRESENTLY KNOWN. IT IS THE CONTRACTOR'S RESPONSIBILITY TO HAVE ALL UTILITIES LOCATED IN THE FIELD PRIOR TO CONSTRUCTION TO AVOID DAMAGE THERETO.

■ DENOTES EXISTING PAVEMENT

- TBM #11 - SET R.R. SPIKE IN POWERPOLE w/GUY N.W. CORNER OF ILL. 13/15 AND TURKEY HILL LANE, 109.00' LT., STA. 194+23+, ELEV. 509.22
- BM #3 - SET COTTON SPINDLE-SOUTH SIDE OF POWER POLE, 216.43' LT., STA. 195+53.32, ELEV. 510.94

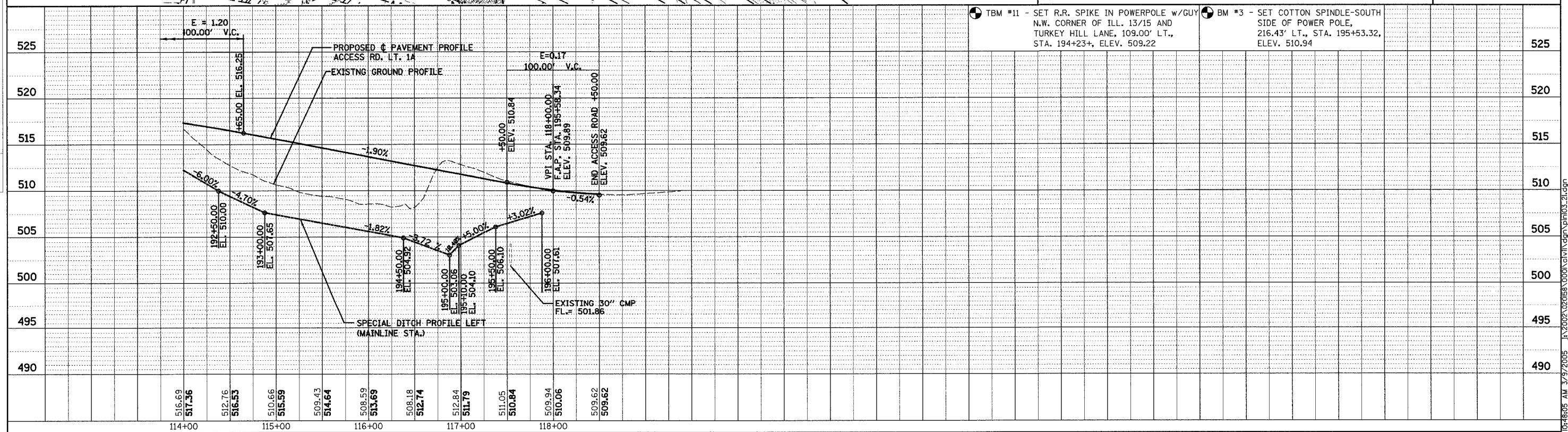

PLAN & PROFILE - ACCESS ROAD LT. 1A

10:48:05 AM 3/9/2005 J:\2002\02058\000\GWIN\GWIN.DWG\PRINT03-21.dgn