

PART OF U.S. SURVEY 389, T1N, R7W, T1N, R8W, T1S, R7W AND T1S, R8W
OF THE THIRD P.M., ST. CLAIR COUNTY, ILLINOIS

FAP ROUTE	SECTION	COUNTY	TOTAL SHEETS	SHEET NO.
103	27-1R	ST. CLAIR	382	121
STA. 170+54.19		TO STA. 182+34.04		
FED. ROAD DIST. NO.	ILLINOIS	FED. AID PROJECT		

LEGEND

- SECTION CORNER
- QUARTER SECTION CORNER
- EXISTING CENTERLINE
- EXISTING RIGHT OF WAY LINE
- EXISTING EASEMENT LINE
- PROPOSED CENTERLINE
- PROPOSED RIGHT OF WAY LINE
- PROPOSED ACCESS CONTROL LINE
- PROPOSED TEMPORARY EASEMENT LINE
- PROPOSED PERMANENT EASEMENT LINE
- SECTION LINE
- QUARTER SECTION LINE
- QUARTER QUARTER SECTION LINE
- PROPERTY (DEED) LINE
- APPARENT PROPERTY LINE
- MEASURED DIMENSION
- COMPUTED DIMENSION
- RECORDED DIMENSION
- FOUND IRON PIPE OR IRON ROD AT CORNER UNLESS OTHERWISE NOTED
- SET 3/8 INCH IRON ROD W/CAP
- PERMANENT SURVEY MONUMENT, I.D.O.T. STD. 667101
- (TO BE SET BY OTHERS)
- CUT CROSS FOUND OR SET
- SAME OWNERSHIP

U.S. SURVEY 389, CLAIM 332, 333, 334, AND 335

HAROLD LEE MILLER, AS TO AN UNDIVIDED 1/2 INTEREST; AND HAROLD LEE MILLER AND GLORIA M. MILLER, HIS WIFE AS JOINT TENANTS AS AN UNDIVIDED 1/2 INTEREST.
BK 1546, PG 117
BK 1393, PG 58

PROP. CURVE 1
P.I. STA. = 180+56.95
Δ = 00°01'36" LT
Δ = 214,348.22'
R = 100.00'
L = 100.00'
E = 0.01'
P.C. STA. 180+06.95
P.T. STA. 181+06.95

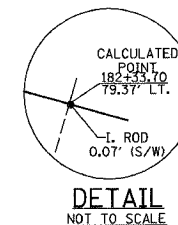

SEE SHEET 5 FOR ACCESS ROAD BASELINE INFORMATION

STATION	OFFSET	NORTH	EAST	
170+54.12	79.43' LT.	658898.2810	2363950.5440	EXIST. ROW
170+54.19	100.00' LT.	658918.0551	2363956.2106	PROP. ROW
177+90.00	100.00' LT.	658717.8418	2364664.2554	PROP. ROW
177+90.00	192.00' LT.	658806.3704	2364689.2889	PROP. ROW
180+91.84	192.00' LT.	658724.2640	2364979.6490	PROP. ROW
181+87.20	179.15' LT.	658686.0060	2365067.9430	PROP. ROW
182+33.70	79.37' LT.	658577.3480	2365085.5850	EXIST. ROW
182+34.04	166.33' LT.	658660.9433	2365109.5406	PROP. ROW
182+46.94	0	658497.3659	2365076.7666	PROP. ROW @ TRIN. LINE BRASS DISK END.

PARCEL NO.	OWNER	BOOK & PAGE	TOTAL HOLDING ACRES	FEE SIMPLE ACQUISITION				EASEMENTS		PERMANENT TAX NUMBER	PROPERTY ACQUIRED BY		
				GROSS ACRES	PREVIOUSLY DEDICATED ACRES	NET ACRES	REMAINDER ACRES	PE = PERMANENT ACRES	TE = TEMPORARY ACRES			EASEMENT PURPOSE	
8019004	HAROLD LEE MILLER, AS TO AN UNDIVIDED 1/2 INTEREST; AND HAROLD LEE MILLER AND GLORIA M. MILLER, HIS WIFE AS JOINT TENANTS, AS TO AN UNDIVIDED 1/2 INTEREST. TITLE REPORT NO. SC-2820	BK 1546 PG 117 BK 1393 PG 58 BK 2636 PG 93	80.1937 ACRES	1.4643	63,785	N/A	N/A	1.4643	63,785	87.7294 ACRES	TE 0.1060 TE 4.617	GRADING AND ENTRANCE CONSTRUCTION	13-01-0-00-002 14-06-0-100-001

- NOTES:
- BEARINGS AND COORDINATES SHOWN HEREON ARE BASED ON SURVEY CONTROL DATA PROVIDED BY THE ILL. DEPARTMENT OF TRANSPORTATION.
 - TOPOGRAPHY AS SHOWN SUPPLIED BY ILL. DEPARTMENT OF TRANSPORTATION, DISTRICT 8 COLLINSVILLE, IL.
 - MRBK = MONUMENT AND RECORD BOOK.

KdG KUHLMANN DESIGN GROUP, INC.
15 E. WASHINGTON STREET
BELLEVILLE, ILLINOIS 62220
(618) 234-8898

ILLINOIS DEPARTMENT OF TRANSPORTATION
PLAT OF HIGHWAYS
FAP ROUTE 103 (IL RTE. 13/15)
SECTION 27-1R
ST. CLAIR COUNTY
JOB NO. R-98-019-00
STATION 170+54.19 TO STATION 182+34.04

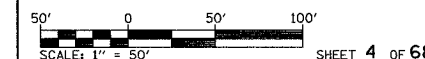

ILLINOIS DEPARTMENT OF TRANSPORTATION
DIVISION OF HIGHWAYS/DISTRICT 8
1102 EASTPORT PLAZA DRIVE
COLLINSVILLE, ILLINOIS 62234-6198