

160 150 140 130 120 110 100 90 80 70 60 50 40 30 20 10 0 10 20 30 40 50 60 70 80 90 100 110 120

|                     |         |           |                  |           |
|---------------------|---------|-----------|------------------|-----------|
| F.A. RTE.           | SECTION | COUNTY    | TOTAL SHEETS     | SHEET NO. |
| 103                 | 27-IR   | ST. CLAIR | 382              | 243       |
| STA.                |         | TO STA.   |                  |           |
| FED. ROAD DIST. NO. |         | ILLINOIS  | FED. AID PROJECT |           |
| CONTRACT NO. 76300  |         |           |                  |           |

PROP. F.A.P. 103

|              |      |
|--------------|------|
| FINAL SURVEY | DATE |
| BY           |      |
| NO.          |      |
| APPROVED     | DATE |
| BY           |      |
| NO.          |      |
| APPROVED     | DATE |
| BY           |      |
| NO.          |      |

|                 |      |
|-----------------|------|
| ORIGINAL SURVEY | DATE |
| BY              |      |
| NO.             |      |
| APPROVED        | DATE |
| BY              |      |
| NO.             |      |
| APPROVED        | DATE |
| BY              |      |
| NO.             |      |

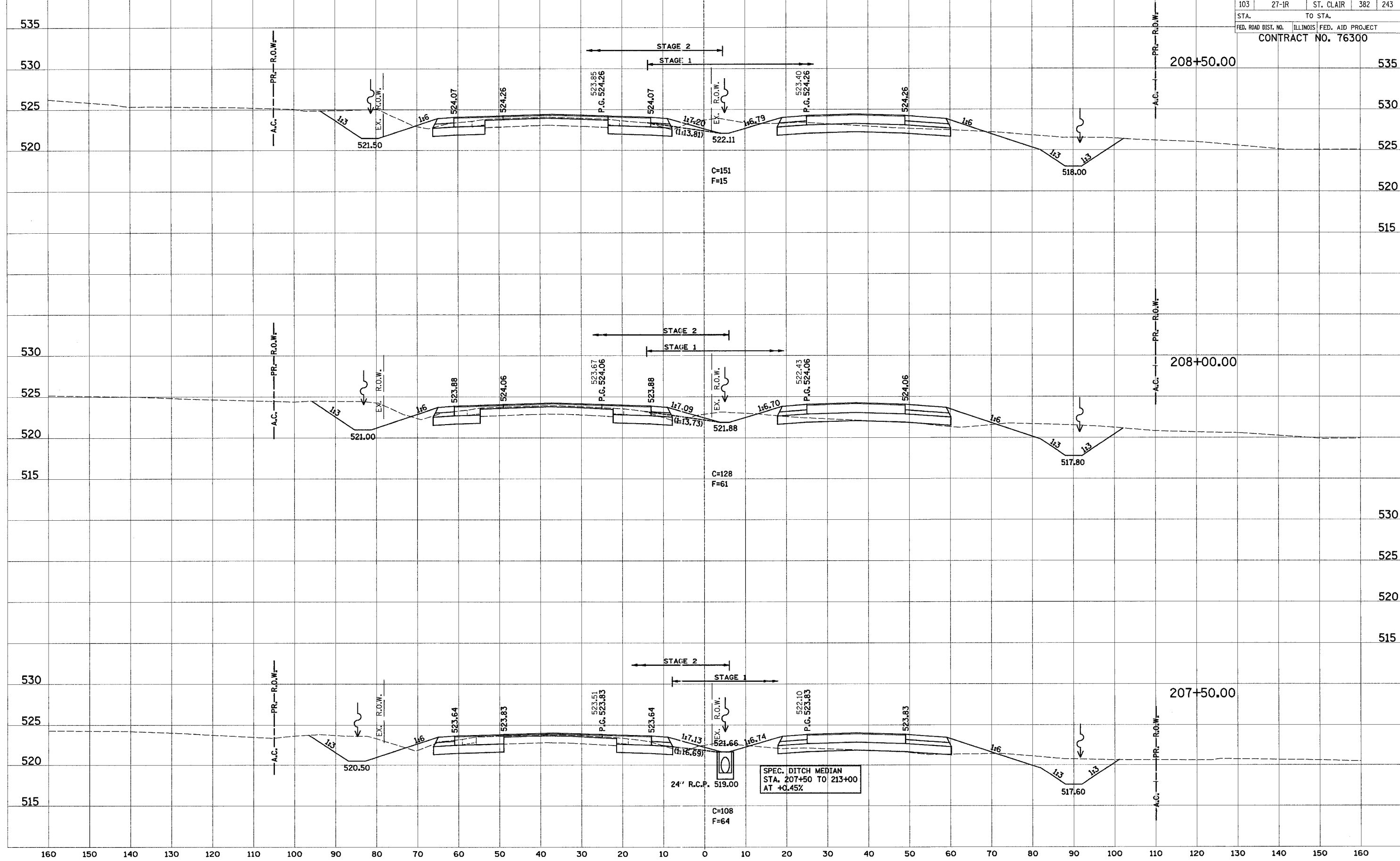

SPEC. DITCH MEDIAN  
 STA. 207+50 TO 213+00  
 AT +0.45%

160 150 140 130 120 110 100 90 80 70 60 50 40 30 20 10 0 10 20 30 40 50 60 70 80 90 100 110 120 130 140 150 160