

160 150 140 130 120 110 100 90 80 70 60 50 40 30 20 10 0 10 20 30 40 50 60 70 80 90 100 110 120

PROP. F.A.P. 103

F.A. RTE.	SECTION	COUNTY	TOTAL SHEETS	SHEET NO.
103	27-1R	ST. CLAIR	382	257
STA. 219+65		TO STA. 219+25		
FED. ROAD DIST. NO.		ILLINOIS FED. AID PROJECT		
CONTRACT NO. 76300				

SPEC. DITCH LT. AC. RD.
STA. 219+65 TO 220+25
AT -0.50 %

SPEC. DITCH LEFT
STA. 219+50 TO 229+00
AT +3.30 %

SPEC. DITCH LT. AC. RD.
STA. 219+25 TO 219+50
AT +10.00 %

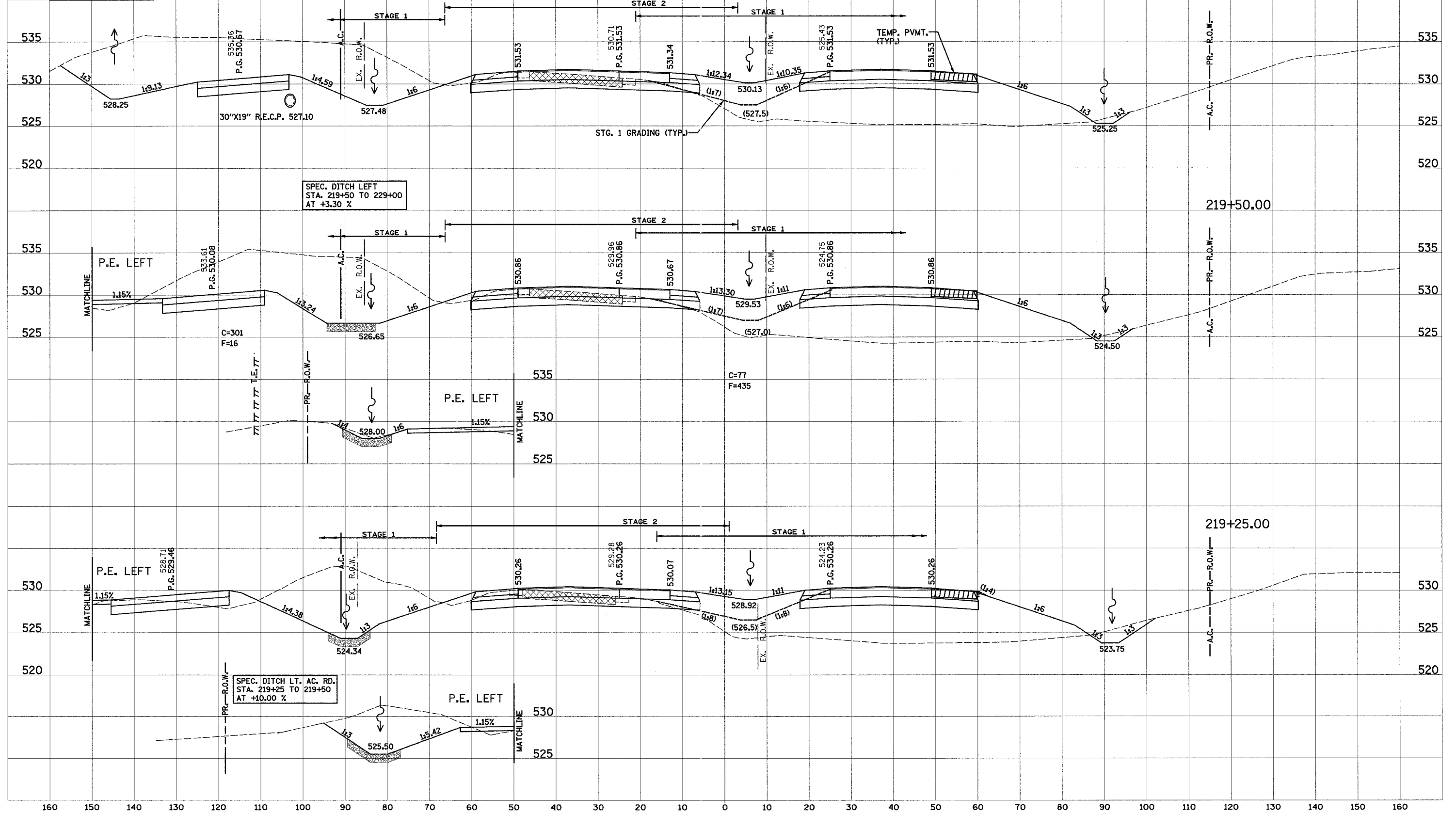

DATE
BY
SURVEYED
SURVEY
NOTE BOOK
AREAS
AREAS CHECKED

DATE
BY
ORIGINAL SURVEY
NOTE BOOK
AREAS
AREAS CHECKED

160 150 140 130 120 110 100 90 80 70 60 50 40 30 20 10 0 10 20 30 40 50 60 70 80 90 100 110 120 130 140 150 160