

160 150 140 130 120 110 100 90 80 70 60 50 40 30 20 10 0 10 20 30 40 50 60 70 80 90 100 110 120

PROP. F.A.P. 103

F.A. RTE.	SECTION	COUNTY	TOTAL SHEETS	SHEET NO.
103	27-1R	ST. CLAIR	382	274
STA.		TO STA.		
FED. ROAD DIST. NO.		ILLINOIS FED. AID PROJECT		
CONTRACT NO. 76300				

FINAL SURVEY	SURVEYED	DATE
NOTE BOOK	PLOTTED	
NO.	TEMPLATE	
	AREAS CHECKED	

ORIGINAL SURVEY	SURVEYED	DATE
NOTE BOOK	PLOTTED	
NO.	TEMPLATE	
	AREAS CHECKED	

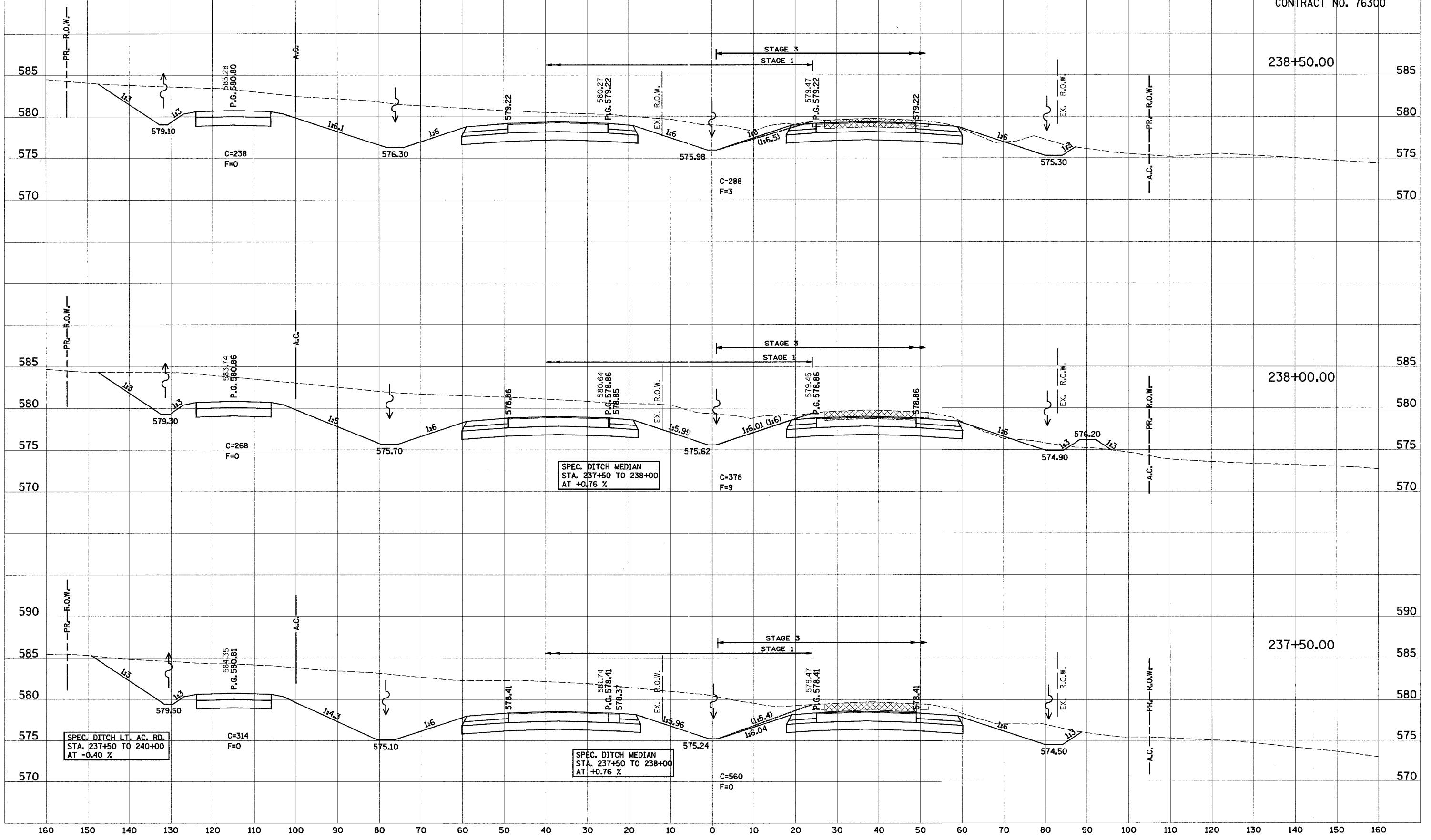

238+50.00

238+00.00

237+50.00

585
580
575
570
585
580
575
570
590
585
580
575
570

SPEC. DITCH MEDIAN
STA. 237+50 TO 238+00
AT +0.76 %

SPEC. DITCH L.T. AC. RD.
STA. 237+50 TO 240+00
AT -0.40 %

SPEC. DITCH MEDIAN
STA. 237+50 TO 238+00
AT +0.76 %