

160 150 140 130 120 110 100 90 80 70 60 50 40 30 20 10 0 10 20 30 40 50 60 70 80 90 100 110 120

PROP. F.A.P. 103

F.A. RTE.	SECTION	COUNTY	TOTAL SHEETS	SHEET NO.
103	27-1R	ST. CLAIR	382	309
STA.		TO STA.		
FED. ROAD DIST. NO.		ILLINOIS	FED. AID PROJECT	
CONTRACT NO. 76300				

FINAL SURVEY	DATE
BY	
SURVEYED	
NOTE BOOK	
AREAS CHECKED	

ORIGINAL SURVEY	DATE
BY	
SURVEYED	
NOTE BOOK	
AREAS CHECKED	

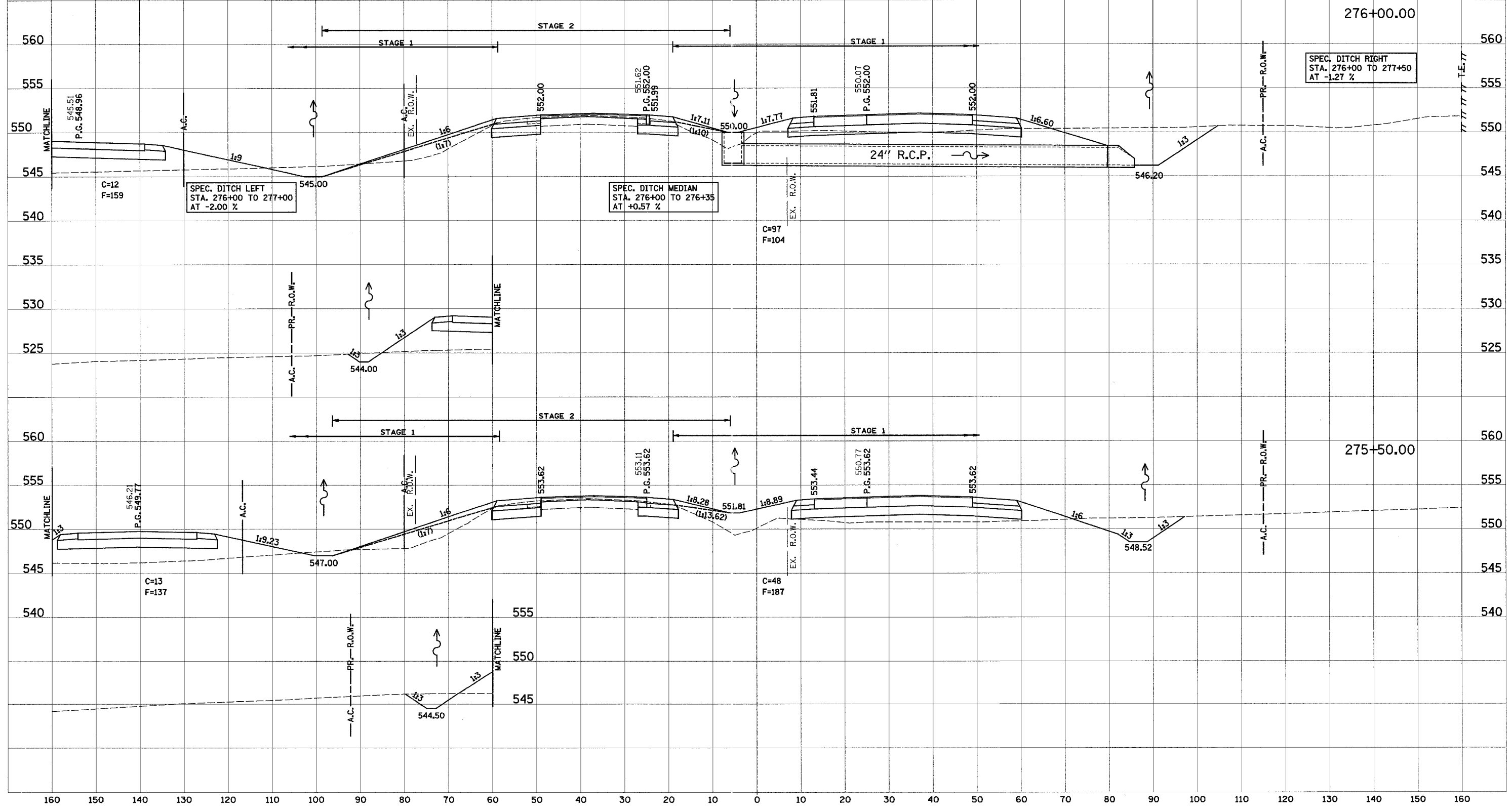

SPEC. DITCH RIGHT STA. 276+00 TO 277+50 AT -1.27 %

SPEC. DITCH MEDIAN STA. 276+00 TO 276+35 AT +0.57 %

SPEC. DITCH LEFT STA. 276+00 TO 277+00 AT -2.00 %

275+50.00

276+00.00