

160 150 140 130 120 110 100 90 80 70 60 50 40 30 20 10 0 10 20 30 40 50 60 70 80 90 100 110 120

F.A. RTE.	SECTION	COUNTY	TOTAL SHEETS	SHEET NO.
103	27-1R	ST. CLAIR	382	374
STA.		TO STA.		
FED. ROAD DIST. NO.		ILLINOIS FED. AID PROJECT		
CONTRACT NO. 76300				

¢ P.CR.65

DATE	BY
SURVEYED	
NO.	

DATE	BY
SURVEYED	
NO.	

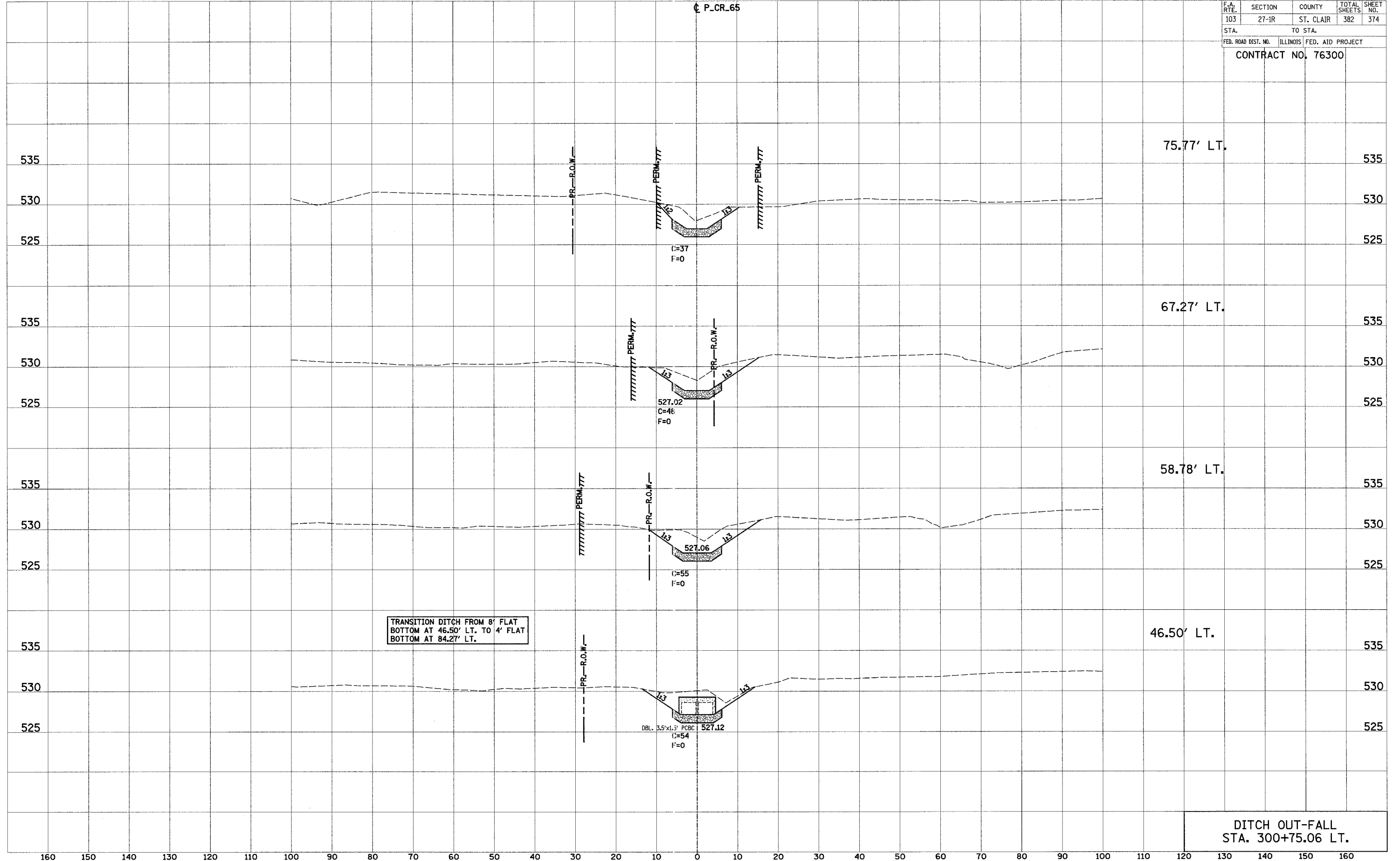

TRANSITION DITCH FROM 8' FLAT BOTTOM AT 46.50' LT. TO 4' FLAT BOTTOM AT 84.27' LT.

DITCH OUT-FALL STA. 300+75.06 LT.

160 150 140 130 120 110 100 90 80 70 60 50 40 30 20 10 0 10 20 30 40 50 60 70 80 90 100 110 120 130 140 150 160