

F.A.I. RTE.	SECTION	COUNTY	TOTAL SHEETS	SHEET NO.
55	60-(1,2)1-2	MADISON	21	1

STATE OF ILLINOIS
DEPARTMENT OF TRANSPORTATION
DIVISION OF HIGHWAYS

**PROPOSED
HIGHWAY PLANS**

FAI ROUTE 55(I-55)
SECTION 60-(1,2)1-2
PROJECT
MADISON COUNTY
WIRE ROPE SAFETY FENCE
C-98-104-05

INDEX OF SHEETS

- 1 COVER SHEET
- 2 SUMMARY OF QUANTITIES
- 3 GENERAL NOTES INDEX OF SHEETS, COMMITMENTS, & STANDARDS
- 4 TYPICAL SECTIONS
- 5-11 PLAN SHEETS
- 12-21 DETAILS

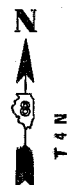
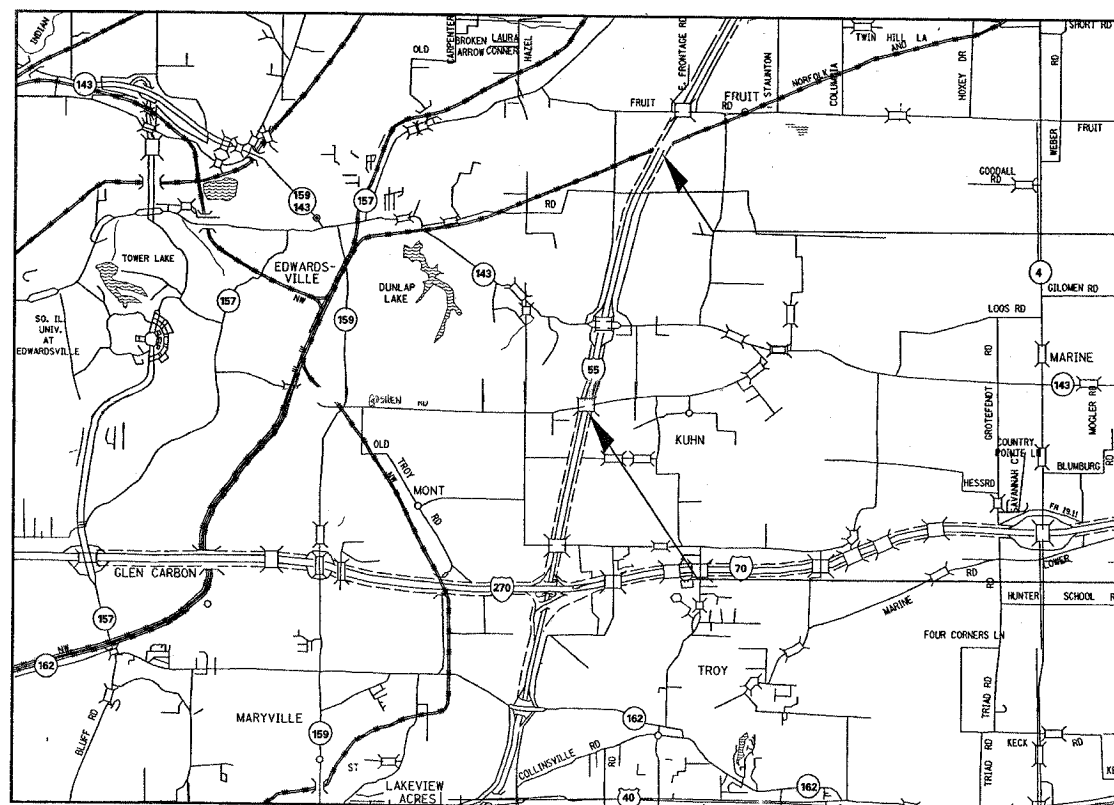
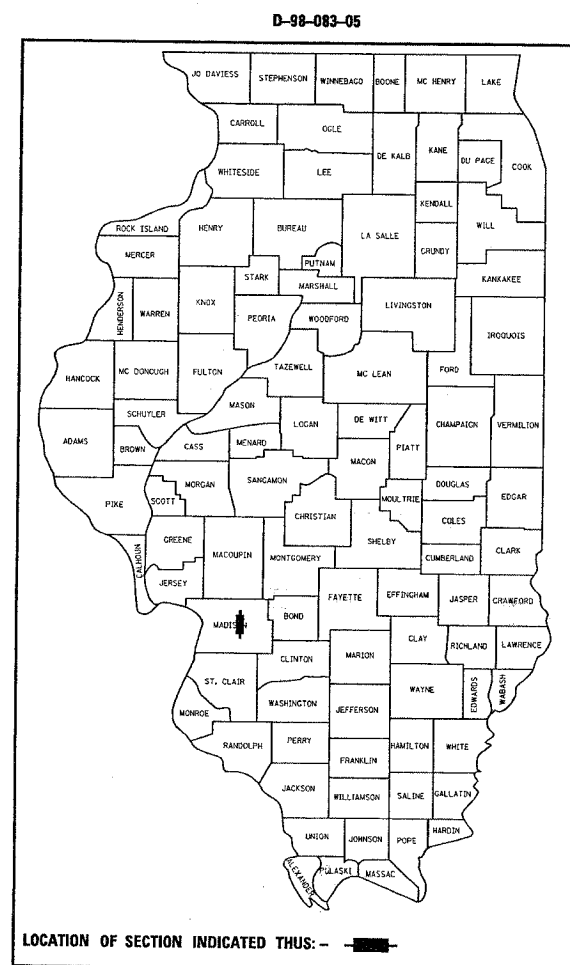

MICROFILMED _____
REEL NUMBER _____
AWARDED _____
RESIDENT ENGINEER _____
AS BUILT CHANGES WERE MADE
ON THE FOLLOWING SHEETS

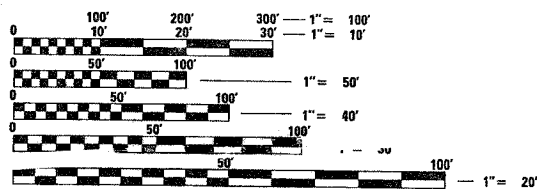

FULL SIZE PLANS HAVE BEEN PREPARED USING STANDARD ENGINEERING SCALES. REDUCED SIZED PLANS WILL NOT CONFORM TO STANDARD SCALES. IN MAKING MEASUREMENTS ON REDUCED PLANS, THE ABOVE SCALES MAY BE USED.

J.U.L.I.E.
JOINT UTILITY LOCATION INFORMATION FOR EXCAVATION
1-800-892-0123

CONTRACT NO. 76940

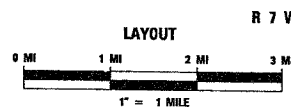

ADT	
2003	29,000
S.U.	22.1%
M.U.	4.1%

GROSS LENGTH = 18,470 FT = 3.50 MI
NET LENGTH = 18,470 FT = 3.50 MI

STATE OF ILLINOIS
DEPARTMENT OF TRANSPORTATION
DIVISION OF HIGHWAYS

SUBMITTED June 29, 2005
Mary P. Amis DEPUTY DIRECTOR OF HIGHWAYS
REGION FIVE ENGINEER

August 19, 2005
Mike Hare ENGINEER OF DESIGN AND ENVIRONMENT

August 19, 2005
Victor Mader DIRECTOR, DIVISION OF HIGHWAYS

**PRINTED BY THE AUTHORITY
OF THE STATE OF ILLINOIS**

PROJECT ENGINEER WENDA SOUTHERLAND (618)346-3159
SQUAD LEADER: BRIAN COURTWRIGHT (618)346-3192

F.A.I. SHEETS	SECTION	COUNTY	TOTAL SHEETS	SHEET NO.
55	60-(1,2)I-2	MADISON	21	3
STA.		TO STA.		
FED. ROAD DIST. NO. 5		ILLINOIS	FED. AID PROJECT	

GENERAL NOTES

- THE LOCATIONS OF THE IMPROVEMENTS AS SHOWN IN THE PLANS ARE APPROXIMATE LOCATIONS. THE ENGINEER SHALL DETERMINE THE EXACT LOCATIONS.
- THE CONTRACTOR SHALL VERIFY ALL DIMENSIONS AND CONDITIONS IN THE FIELD PRIOR TO CONSTRUCTION AND ORDERING MATERIALS.
- ILLINOIS STATE LAW REQUIRES A 48-HOUR NOTICE TO BE GIVEN TO UTILITIES BEFORE DIGGING. FIELD MARKING OF FACILITIES MAY BE OBTAINED BY CONTACTING J.U.L.I.E. (PHONE: 800-892-0123) OR FOR NON-MEMBER, THE UTILITY COMPANIES DIRECTLY. AGENCIES KNOWN TO HAVE FACILITIES WITHIN THE PROJECT AREA ARE AS FOLLOWS:
 - BOND MADISON WATER COMPANY
 - CENTERPOINT ENERGY
 - CHARTER COMMUNICATIONS, INC
 - CITY OF EDWARDSVILLE (SANITARY SEWER)
 - MARATHON ASHLAND PIPELINE, LLC (PIPELINE)
 - SBC (COMMUNICATIONS)
 - SOUTHWESTERN ELECTRIC COOPERATIVE, INC.
 - WILTEL COMMUNICATIONS, LLC

MEMBERS OF J.U.L.I.E. (800) 892-0123 ARE INDICATED BY *. NON J.U.L.I.E MEMBERS MUST BE CONTACTED INDIVIDUALLY.

- ALL EXCAVATION ADJACENT TO THE EDGE OF PAVEMENT SHALL BE PROTECTED WITH EXTENDED LEG BARRICADES AND APPROPRIATE LIGHTS.
- WHEN NO WORK IS BEING PERFORMED, THE FLAGGERS WILL NOT BE REQUIRED. IF FLAGGERS ARE NOT PRESENT, THE FLAGGER SIGNS SHALL BE REMOVED OR COVERED.
- FLAGMEN SHALL BE PRESENT DURING ALL CLOSURE HOURS, INCLUDING LUNCH HOUR, AND NO ADDITIONAL COMPENSATION WILL BE APPLIED.
- LIGHTS WILL NOT BE REQUIRED FOR DAY OPERATIONS.
- STANDARD 701101 SHALL BE USED FOR SHOULDER CLOSING WITH A SHOULDER CLOSED SIGN. THE COST IS INCLUDED IN THE COST OF TRAFFIC CONTROL.
- NO OVERNIGHT LANE CLOSURES WILL BE ALLOWED.
- ALL TRAFFIC CONTROL DEVICES SHALL BE SKID MOUNTED.
- "ROAD CONSTRUCTION AHEAD" SIGNS SHALL BE PLACED AT THE BEGINNING AND END OF THE PROJECT, AND WILL BE INCLUDED IN THE TRAFFIC CONTROL PAY ITEMS. ALL CONSTRUCTION SIGNS SHALL BE FLOURESCENT ORANGE.
- THE CONTRACTOR SHALL BE AWARE THE UNIT OF MEASUREMENT FOR THE HIGH TENSION CABLE MEDIAN BARRIER SYSTEM IS FROM END OF TERMINAL TO END OF TERMINAL, REGARDLESS OF THE NUMBER OF WIRE ROPES.

COMMITMENTS:

COMMITMENTS FOR THESE PROJECTS ARE AS FOLLOWS:
NONE

STANDARDS

- 000001-04
- 701101
- 701400
- 701406
- 701426
- 702001-05

PLOT DATE = 7/19/2005
FILE NAME = c:\projects\76940\plan\pl_081305a.dgn
PLOT SCALE = 50.0000 / IN.
REFERENCE = \$REF\$

REVISIONS	
NAME	DATE

ILLINOIS DEPARTMENT OF TRANSPORTATION
INDEX OF SHEETS, COMMITMENTS,
STANDARDS AND GENERAL NOTES
FAI ROUTE 55
SECTION 60-(1,2)I-2
MADISON COUNTY

SCALE: VERT.
DATE: HORIZ.

DRAWN BY: EKS
CHECKED BY

F.A.L. RTE.	SECTION	COUNTY	TOTAL SHEETS	SHEET NO.
55	60-1,2)I-2	MADISON	21	4
STA.		TO STA.		
FED. ROAD DIST. NO. 5		ILLINOIS FED. AID PROJECT		

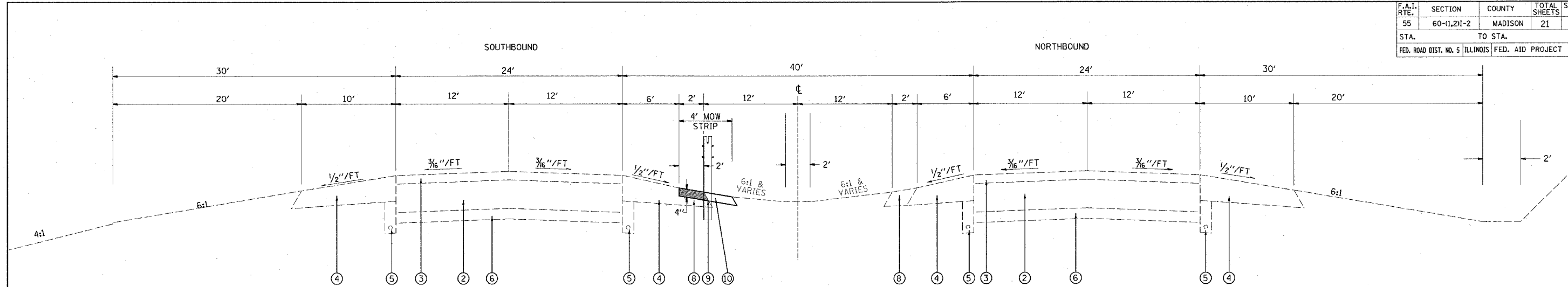

TYPICAL SECTION I-55

NB STA 978+86.68 TO STA 1095+96 SB STA 978+86.68 TO STA 1102+06
 NB STA 1109+21 TO STA 1126+26 SB STA 1109+21 TO STA 1126+26
 NB STA 1133+78 TO STA 1189+15.35 SB STA 1138+71 TO STA 1189+15.35

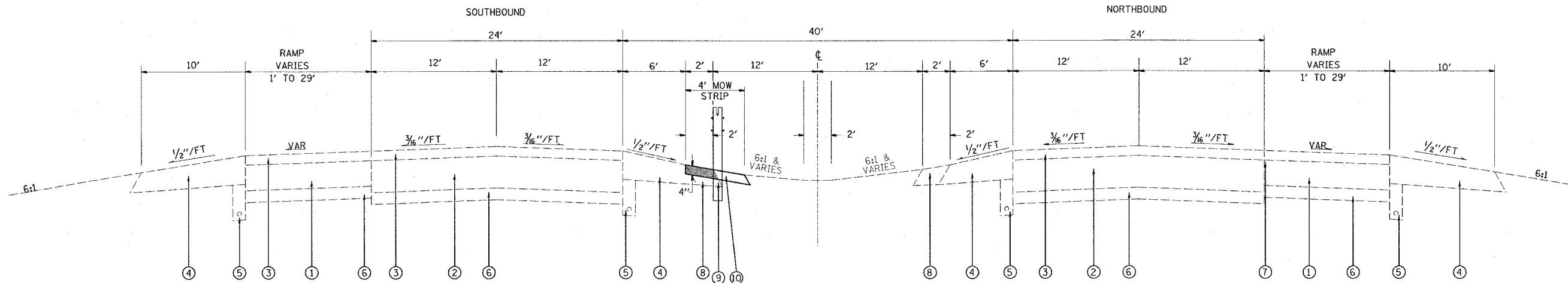

TYPICAL SECTION I-55

NB STA 1095+96 TO STA 1109+21 SB STA 1102+06 TO STA 1109+21
 NB STA 1126+26 TO STA 1133+78 SB STA 1126+26 TO STA 1138+71

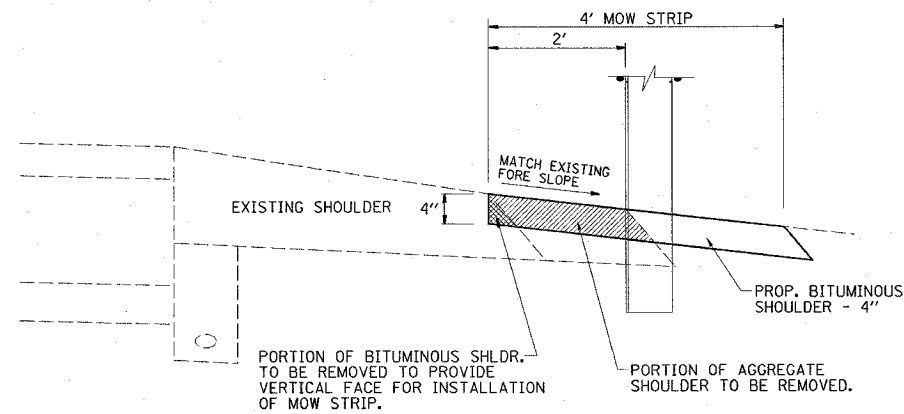

- LEGEND**
- ① EXISTING PCC PAVEMENT, 8"
 - ② EXISTING PCC PAVEMENT, 10"
 - ③ EXISTING RESURFACING, 6"
 - ④ EXISTING BITUMINOUS SHOULDER, 9 1/2"
 - ⑤ EXISTING PIPE UNDERDRAINS, 6"
 - ⑥ EXISTING SUB BASE, 6"
 - ⑦ EXISTING STRIP REFLECTIVE CRACK CONTROL TREATMENT
 - ⑧ EXISTING AGGREGATE SHOULDER
 - ⑨ PROPOSED WIRE ROPE SAFETY FENCE
 - ⑩ PROPOSED BITUMINOUS SHOULDER - 4"

MIXTURE REQUIREMENT CHART

MIXTURE USE	SHOULDERS	TOP LIFT SHOULDERS
AC/PG	PG 58-22	PG 58-22
RAP % (MAX)	30%	30%
DESIGN AIR VOIDS	2.0% @ Ndes=30	**2.0% @ Ndes=30
MIX COMPOSITION (GRADATION MIXTURE)	BAM	BAM
FRICITION AGG	BAM	BAM

REVISIONS	
NAME	DATE

ILLINOIS DEPARTMENT OF TRANSPORTATION
TYPICAL SECTIONS
 FAI ROUTE 55
 SECTION 60-(1,2)I-2
 MADISON COUNTY

SCALE: VERT. 1"=4'
 HORIZ. 1"=40'
 DATE

DRAWN BY: EKS
 CHECKED BY:

PLOT DATE = 7/16/2008
 FILE NAME = C:\pwork\76940\1109+21\1109+21.dgn
 PLOT SCALE = 50.000000 / 1"
 REFERENCE = #REF#

F.A.I. RTE.	SECTION	COUNTY	TOTAL SHEETS	SHEET NO.
55	60-(1,2)1-2	MADISON	21	5
STA. 996+00 TO STA. 1026+00				
FED. ROAD DIST. NO. 5 ILLINOIS FED. AID PROJECT				

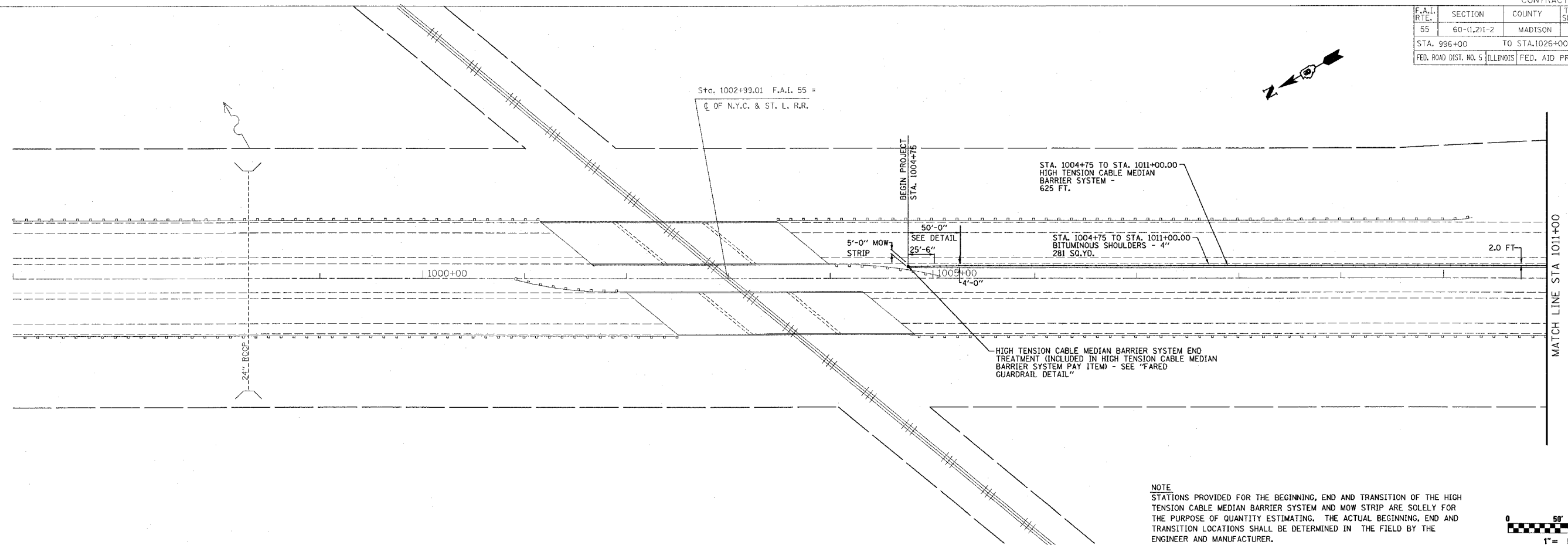

NOTE
 STATIONS PROVIDED FOR THE BEGINNING, END AND TRANSITION OF THE HIGH TENSION CABLE MEDIAN BARRIER SYSTEM AND MOW STRIP ARE SOLELY FOR THE PURPOSE OF QUANTITY ESTIMATING. THE ACTUAL BEGINNING, END AND TRANSITION LOCATIONS SHALL BE DETERMINED IN THE FIELD BY THE ENGINEER AND MANUFACTURER.

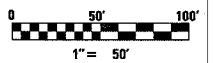
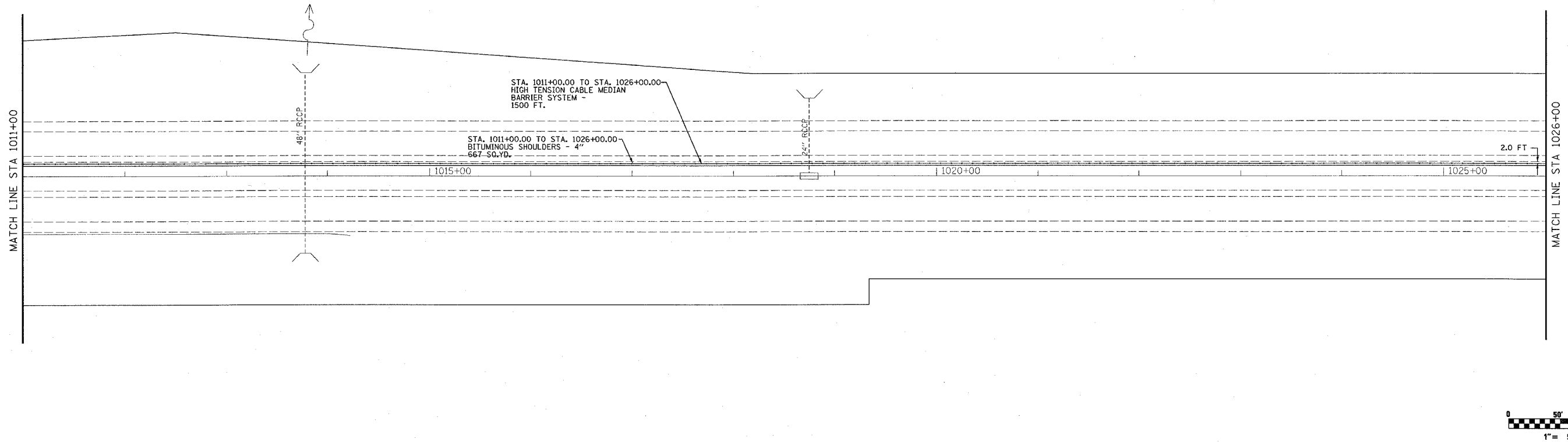

PLOT DATE = 7/19/2005
 FILE NAME = \\s01\proj\76940\plan\100505.dgn
 PLOT SCALE = 1" = 50'
 REFERENCE = #REF#

F.A.I. RTE.	SECTION	COUNTY	TOTAL SHEETS	SHEET NO.
55	60-11,211-2	MADISON	21	6
STA. 1026+00		TO STA. 1056+00		
FED. ROAD DIST. NO. 5 ILLINOIS		FED. AID PROJECT		

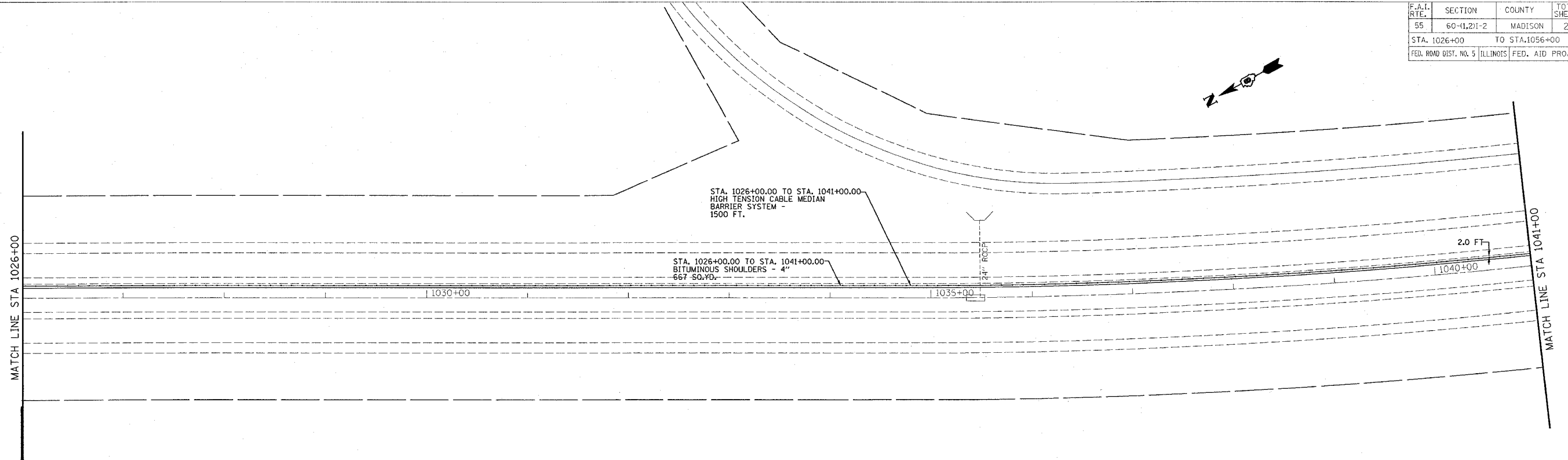

STA. 1026+00.00 TO STA. 1041+00.00
HIGH TENSION CABLE MEDIAN
BARRIER SYSTEM -
1500 FT.

STA. 1026+00.00 TO STA. 1041+00.00
BITUMINOUS SHOULDERS - 4"
667 SQ.YD.

2.0 FT

MATCH LINE STA 1041+00

MATCH LINE STA 1026+00

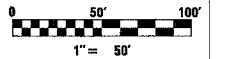

EXIST. CURVE CL55-11
PI STA. = 1043+34.62
 Δ = 16° 39' 29" (LT)
D = 1° 00' 00"
R = 5,729.58'
T = 838.83'
L = 1,665.82'
E = 61.08'
e = -----
T.R. = -----
S.E. RUN = -----

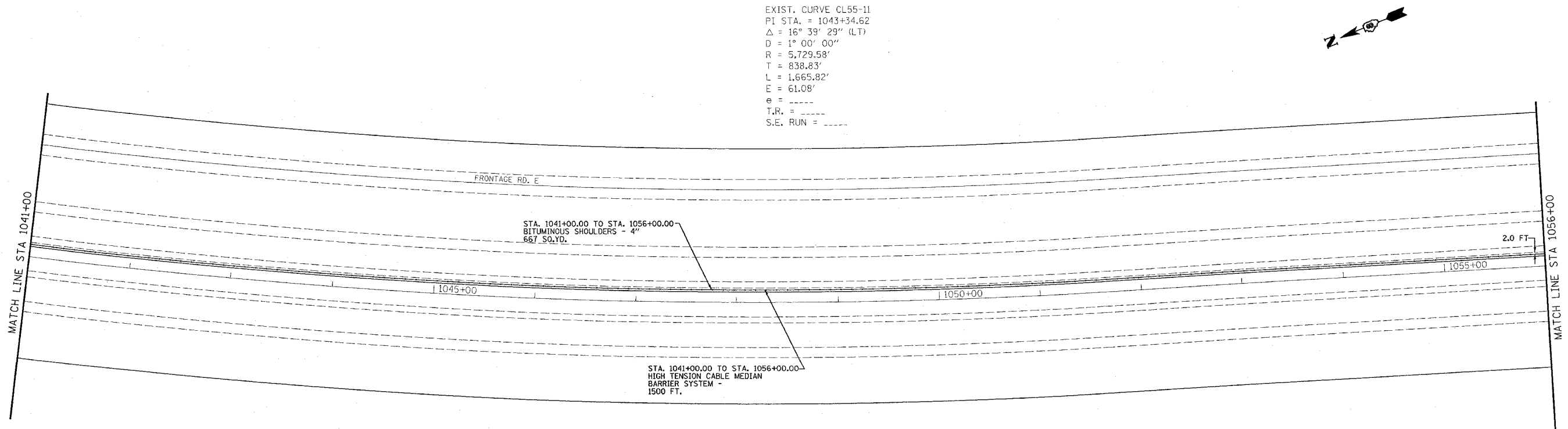

FRONTAGE RD. E

STA. 1041+00.00 TO STA. 1056+00.00
BITUMINOUS SHOULDERS - 4"
667 SQ.YD.

2.0 FT

MATCH LINE STA 1056+00

MATCH LINE STA 1041+00

STA. 1041+00.00 TO STA. 1056+00.00
HIGH TENSION CABLE MEDIAN
BARRIER SYSTEM -
1500 FT.



F.A.I. RTE.	SECTION	COUNTY	TOTAL SHEETS	SHEET NO.
55	60-11,211-2	MADISON	21	7
STA. 1056+00		TO STA. 1086+00		
FED. ROAD DIST. NO. 5 ILLINOIS FED. AID PROJECT				

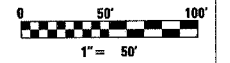
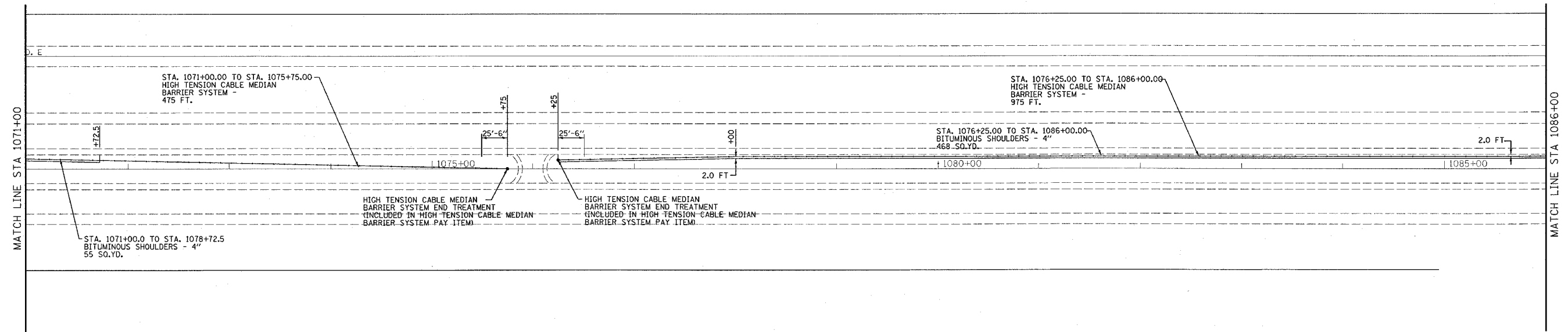
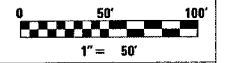
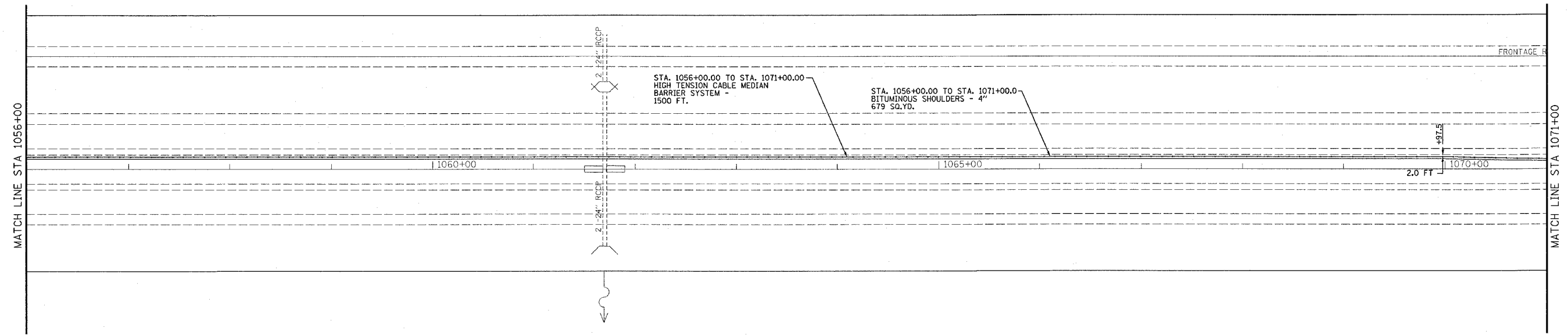

NOTE
 STATIONS PROVIDED FOR THE BEGINNING, END AND TRANSITION OF THE HIGH TENSION CABLE MEDIAN BARRIER SYSTEM AND MOW STRIP ARE SOLELY FOR THE PURPOSE OF QUANTITY ESTIMATING. THE ACTUAL BEGINNING, END AND TRANSITION LOCATIONS SHALL BE DETERMINED IN THE FIELD BY THE ENGINEER AND MANUFACTURER.

PLOT DATE = 7/18/2005
 PLOT SCALE = 1" = 50'
 REFERENCE = #REF*

F.A.I. RTE.	SECTION	COUNTY	TOTAL SHEETS	SHEET NO.
55	60-1,211-2	MADISON	21	8
STA. 1086+00		TO STA. 1116+00		
FED. ROAD DIST. NO. 5		ILLINOIS	FED. AID PROJECT	

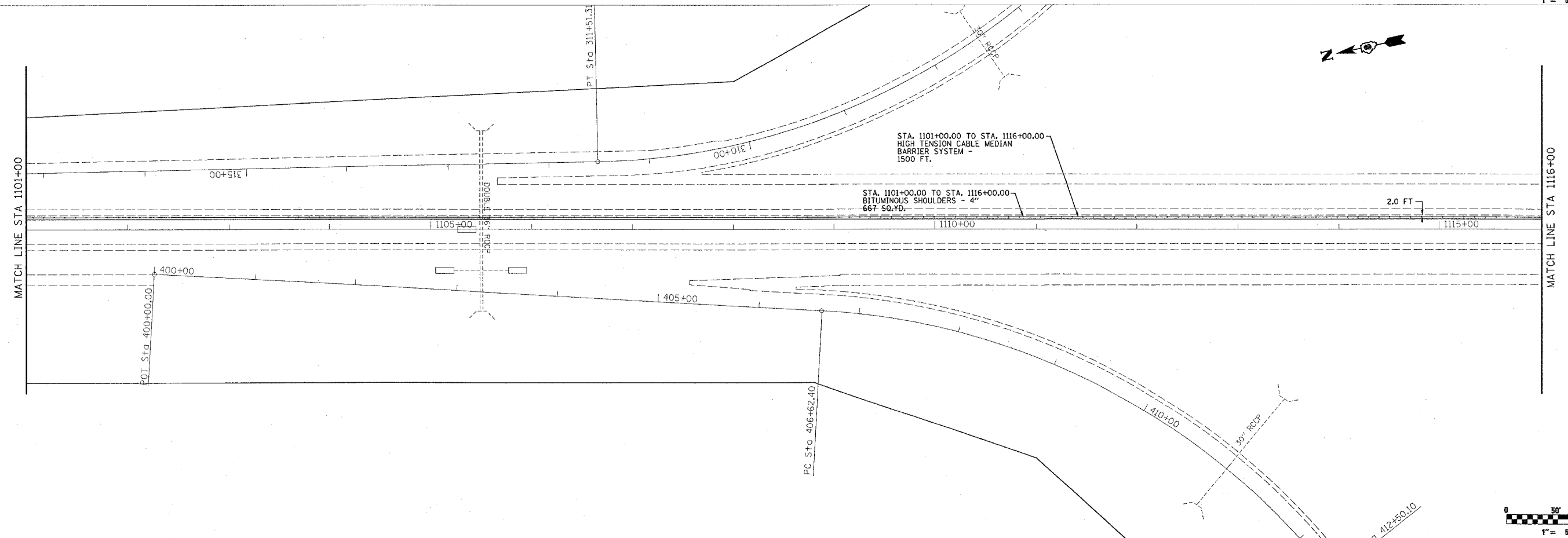
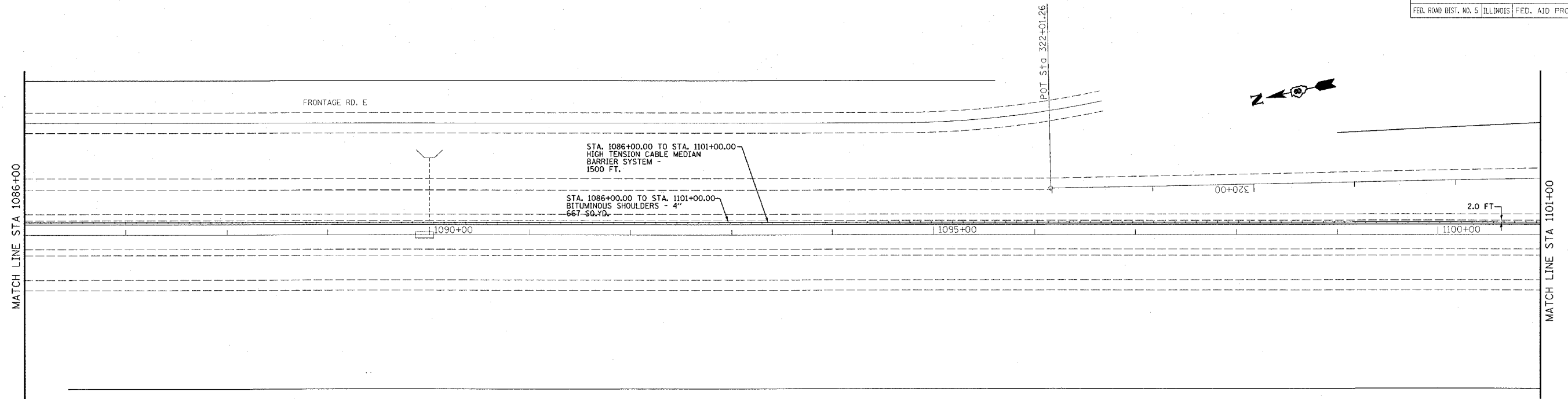

PLOT DATE = 7/18/2005
 FILE NAME = c:\projects\76940\plan\p1108325a.dgn
 PLOT SCALE = 1/8" = 1' IN.
 REFERENCE = REF

F.A.I. RTE.	SECTION	COUNTY	TOTAL SHEETS	SHEET NO.
55	60-1,211-2	MADISON	21	9
STA. 1116+00		TO STA. 1146+00		
FED. ROAD DIST. NO. 5		ILLINOIS FED. AID PROJECT		

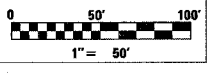
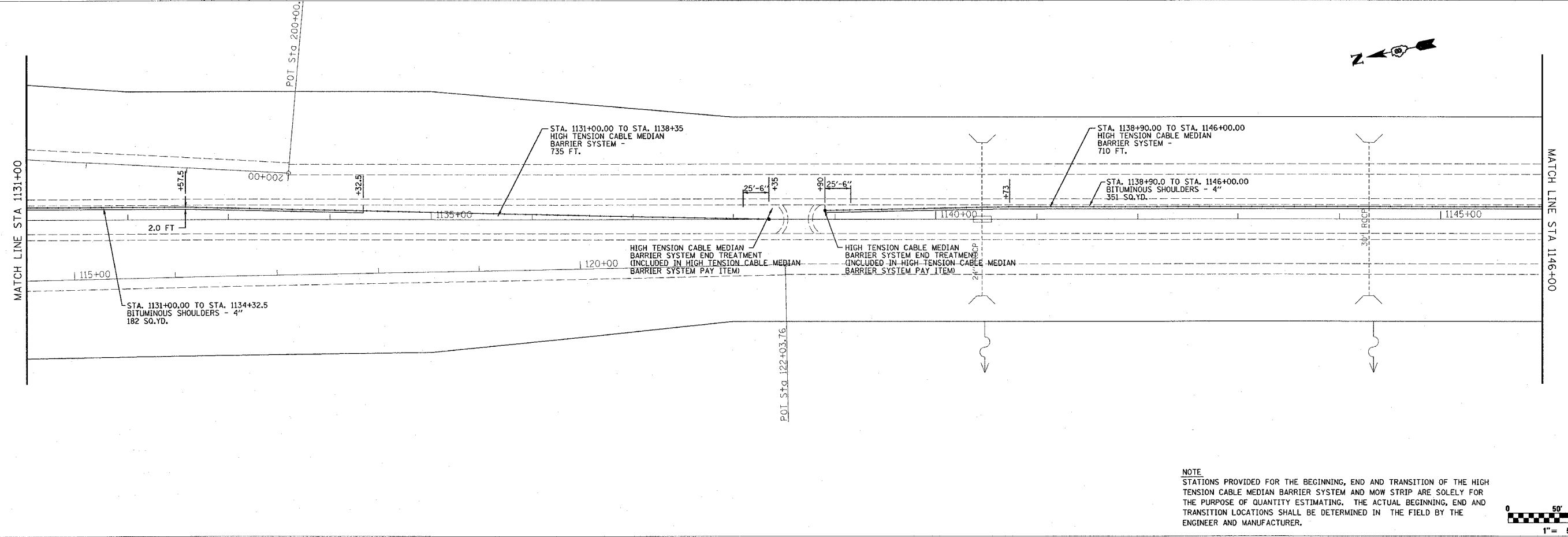
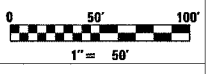
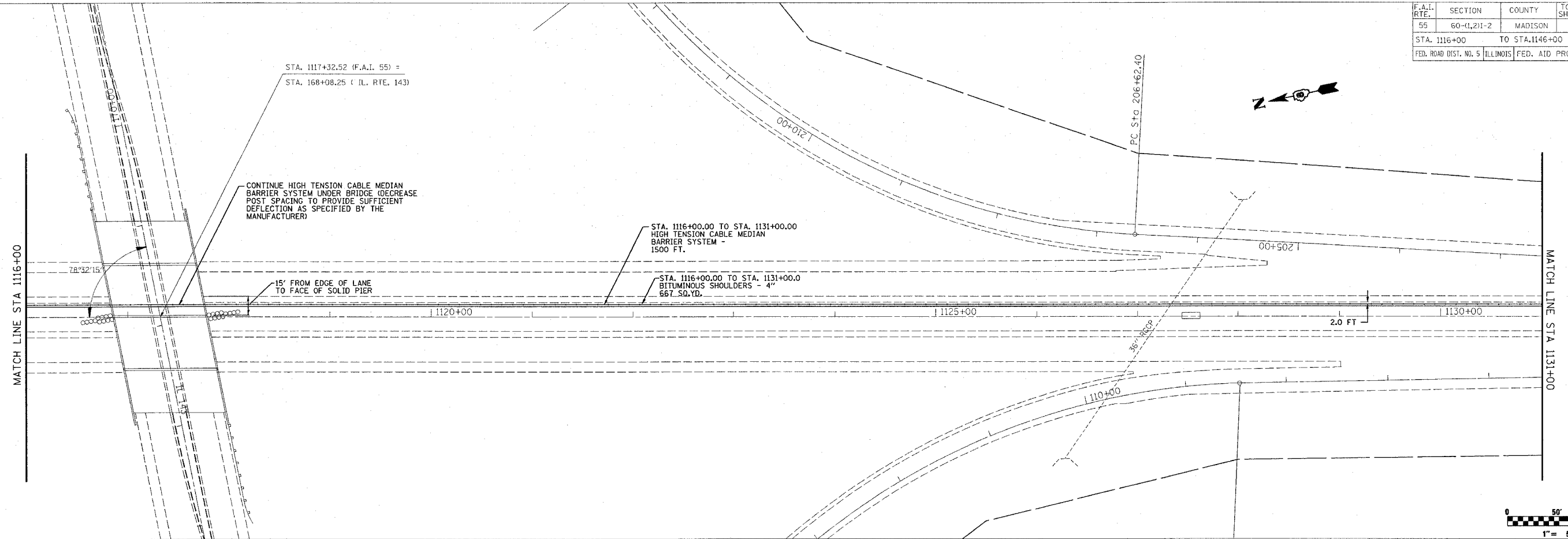

NOTE
 STATIONS PROVIDED FOR THE BEGINNING, END AND TRANSITION OF THE HIGH TENSION CABLE MEDIAN BARRIER SYSTEM AND MOW STRIP ARE SOLELY FOR THE PURPOSE OF QUANTITY ESTIMATING. THE ACTUAL BEGINNING, END AND TRANSITION LOCATIONS SHALL BE DETERMINED IN THE FIELD BY THE ENGINEER AND MANUFACTURER.

PLOT DATE = 7/18/2005
 FILE NAME = c:\pca\projects\76940\plan\p11-08305.dwg
 PLOT SCALE = 1/8" = 1' / IN.
 REFERENCE = 80074

F.A.I. RTE.	SECTION	COUNTY	TOTAL SHEETS	SHEET NO.
55	60-11,21-2	MADISON	21	10

STA. 1116+00 TO STA. 1146+00
 FED. ROAD DIST. NO. 5 ILLINOIS FED. AID PROJECT

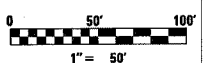
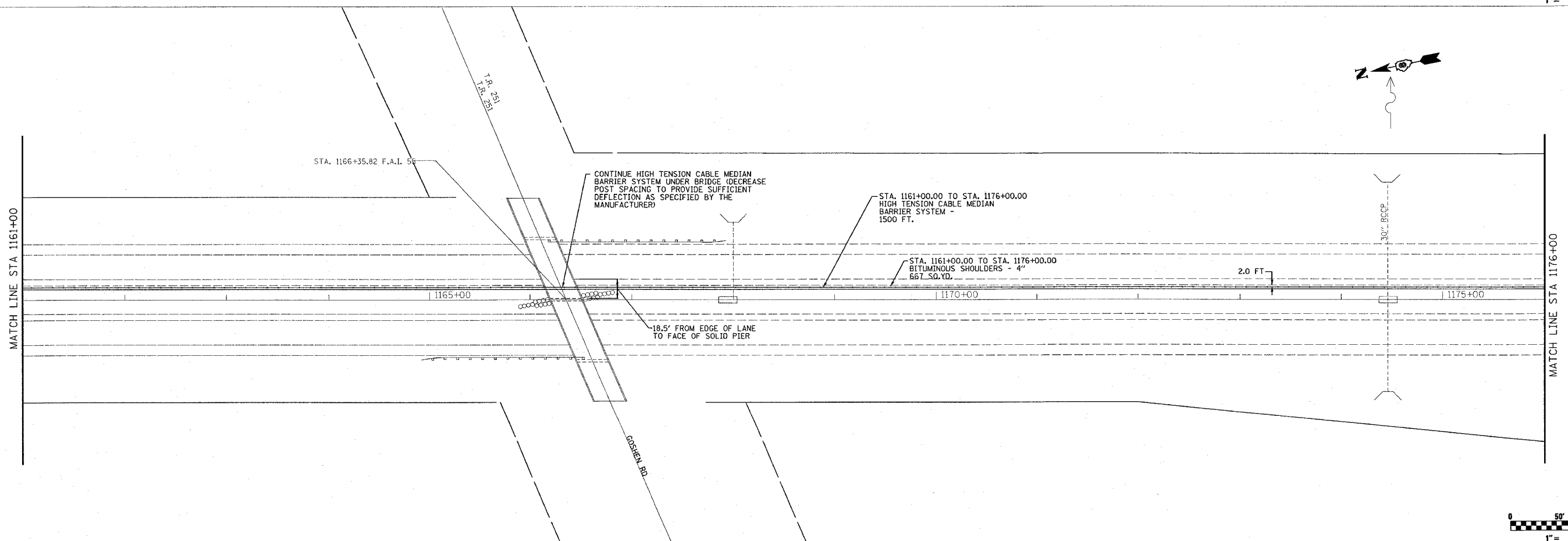
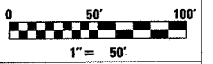
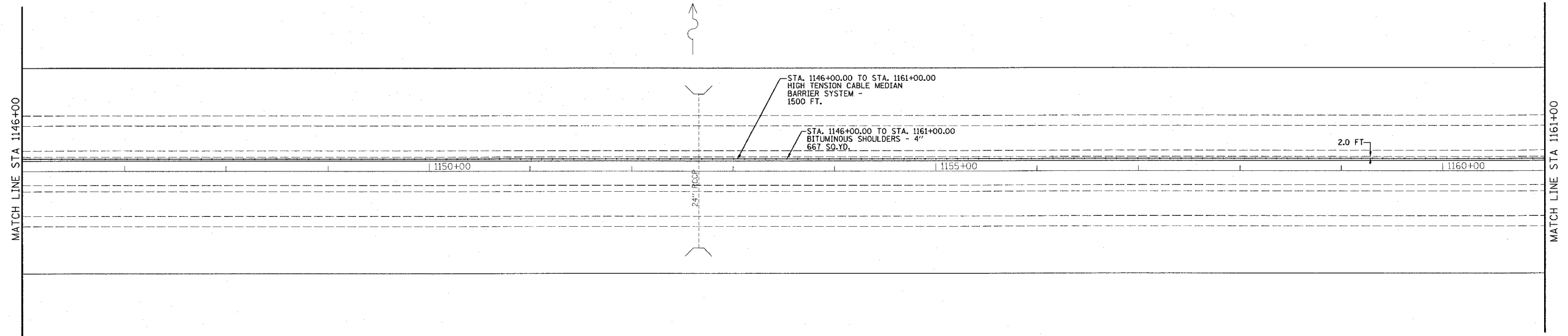

PLOT DATE = 7/19/2005
 FILE NAME = c:\p\g\m\c\w\4803385\plan\p1n05305a.dgn
 PLOT SCALE = 50.0000 / IN.
 REFERENCE = #REF#

F.A.I. RTE.	SECTION	COUNTY	TOTAL SHEETS	SHEET NO.
55	60-1(1,2)I-2	MADISON	21	11
STA. 1176+00 TO STA. 1206+00				
FED. ROAD DIST. NO. 5 ILLINOIS FED. AID PROJECT				

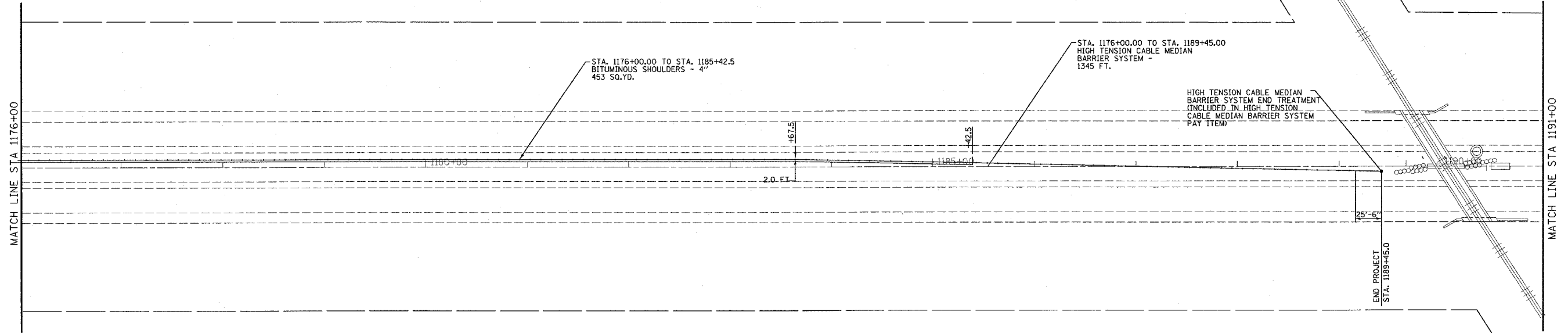

NOTE
 STATIONS PROVIDED FOR THE BEGINNING, END AND TRANSITION OF THE HIGH TENSION CABLE MEDIAN BARRIER SYSTEM AND MOW STRIP ARE SOLELY FOR THE PURPOSE OF QUANTITY ESTIMATING. THE ACTUAL BEGINNING, END AND TRANSITION LOCATIONS SHALL BE DETERMINED IN THE FIELD BY THE ENGINEER AND MANUFACTURER.

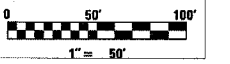
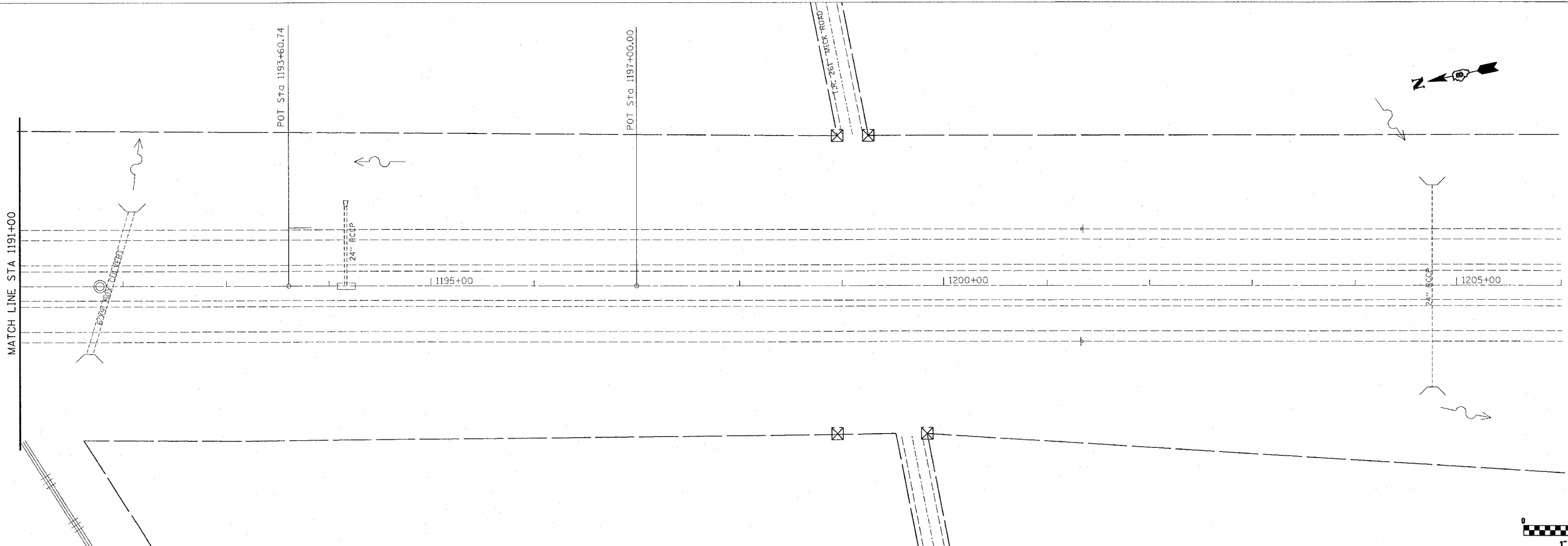
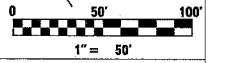

PLOT DATE = 7/18/2005
 FILE NAME = c:\projeas\ad83395\plan\p11083395a.dgn
 PLOT SCALE = 1/8" = 1' IN.
 REFERENCE = SHEET 4

F.A.I. RTE.	SECTION	COUNTY	TOTAL SHEETS	SHEET NO.
55	60-(1,2)I-2	MADISON	21	12
STA.		TO STA.		
FED. ROAD DIST. NO. 5		ILLINOIS FED. AID PROJECT		

- NOTES:
- 2'-0" HIGH TENSION CABLE MEDIAN BARRIER SYSTEM OFFSET FROM SHOULDER UNLESS OTHERWISE NOTED
 - ASSUMED VEHICLE DEPARTURE ANGLE IS 25°
 - REFER TO DETAILS FOR POST SPACING
 - PROVIDE REFLECTORS AT EVERY FIFTH POST (50' SPACING ±, AMBER)

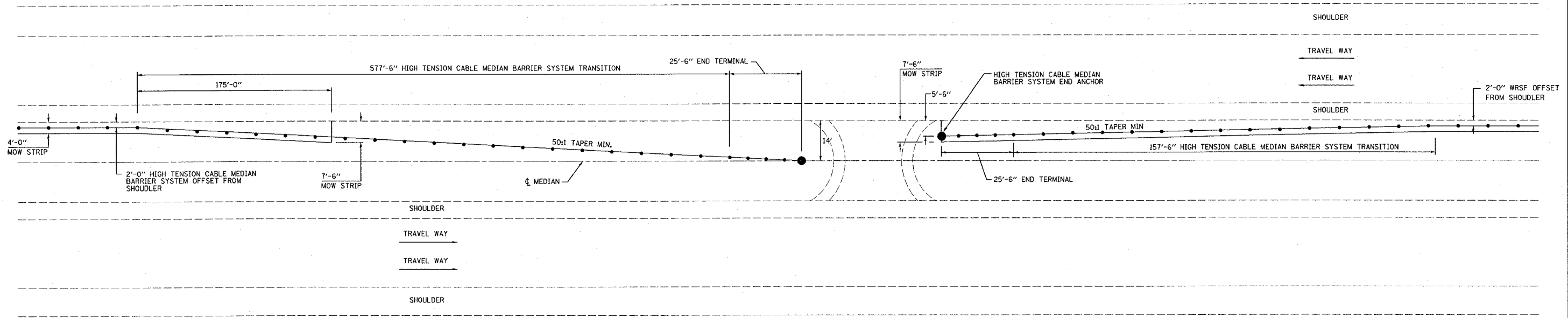

AT TRAFFIC CROSSOVERS
N.T.S.

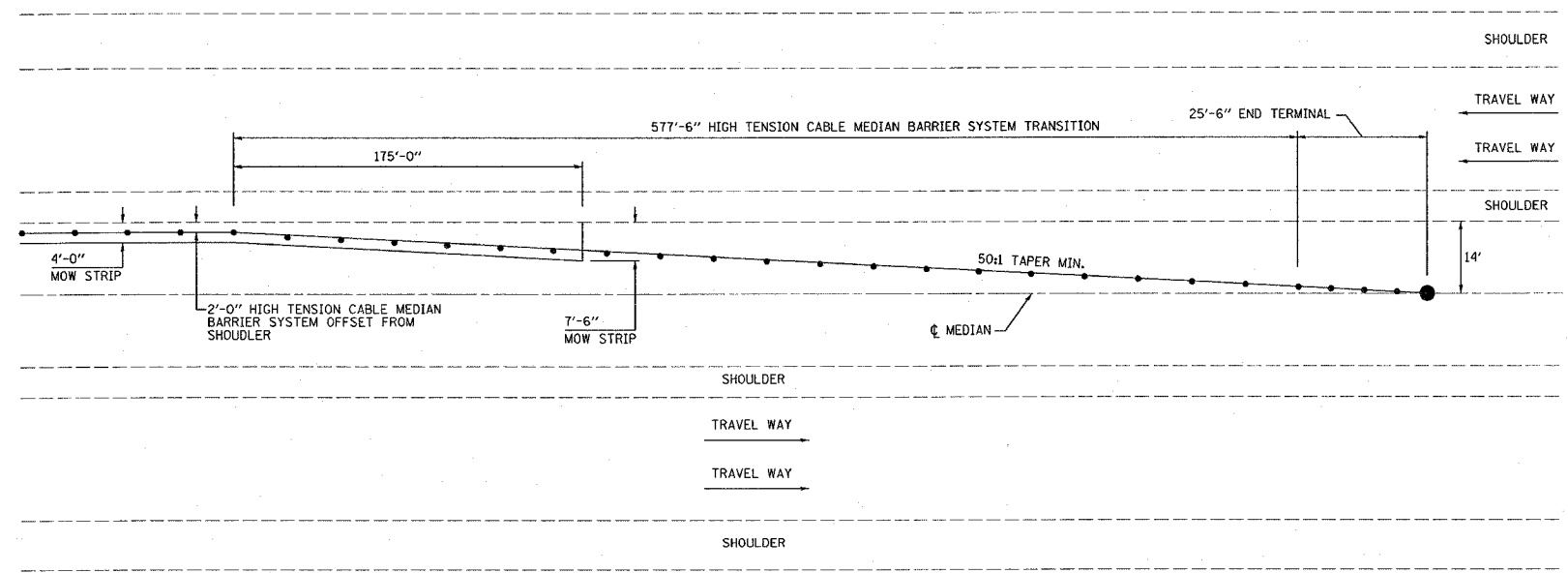

AT END OF PROJECT
N.T.S.

REVISIONS	
NAME	DATE

ILLINOIS DEPARTMENT OF TRANSPORTATION
MEDIAN CROSSOVER DETAILS
FAI ROUTE 55
SECTION 60-(1,2)I-2
MADISON COUNTY

SCALE: VERT. _____
HORIZ. _____
DATE _____

DRAWN BY: EKS
CHECKED BY _____

PLOT DATE = 7/17/2005
 FILE NAME = \\s010000000000\p01n083085.dgn
 PLOT SCALE = 50.0000 / IN.
 REFERENCE = REF#

F.A.I. RTE.	SECTION	COUNTY	TOTAL SHEETS	SHEET NO.
55	60-(1,2)I-2	MADISON	21	14
STA. 996+00		TO STA. 1026+00		
FED. ROAD DIST. NO. 5 ILLINOIS FED. AID PROJECT				

COMPONENT ROPE

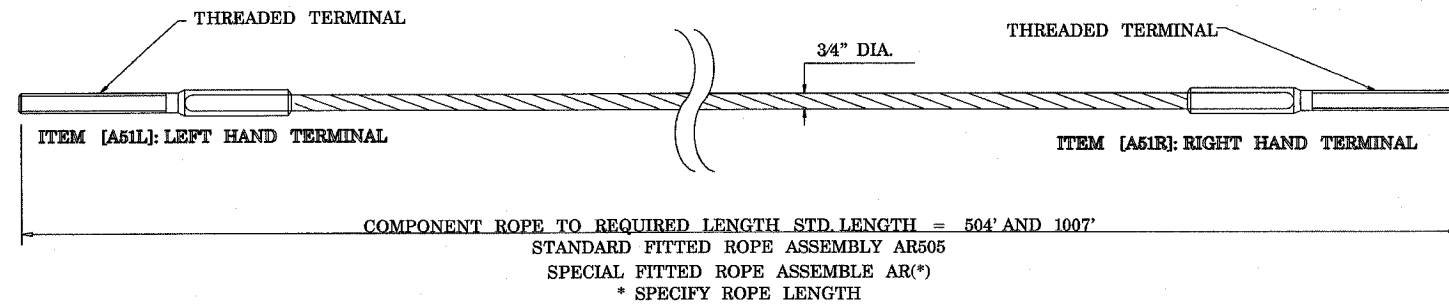

NOTES:

1. BRIFEN WIRE ROPE TO BE 3/4" (19mm) PRE-STRETCHED 3 X 7 CONSTRUCTION.
2. MINIMUM BREAKING LOAD OF FITTED ROPES SHALL BE 36,800 POUNDS (16.7 TONNE F METRIC).
3. COMBINATION MECHANICAL FITTING SHALL DEVELOP MINIMUM BREAKING LOAD AS NOTE 2.
4. RIGGING SCREWS SHALL NOT BE LOCATED BETWEEN END ANCHORAGE AND TYPE POST 'A'.
5. WIRE ROPES ARE TO BE TENSIONED AFTER INSTALLATION, PER TENSION CHART BELOW, AND RE-CHECKED AFTER 2-3 WEEKS.

TENSION CHART

AMBIENT TEMPERATURE		ROPE TENSION	
C	F	KN	LBS
43	110	6.5	1410
38	100	9.4	2110
35	95	11.25	2531
30	86	14.00	3150
25	77	16.75	3769
20	68	19.50	4387
15	59	22.25	5006
10	50	25.00	5625
5	41	27.75	6244
0	32	30.50	6863
-5	23	33.25	7481
-10	14	36.00	8100
-18	0	40.40	9100

TAIL ROPE

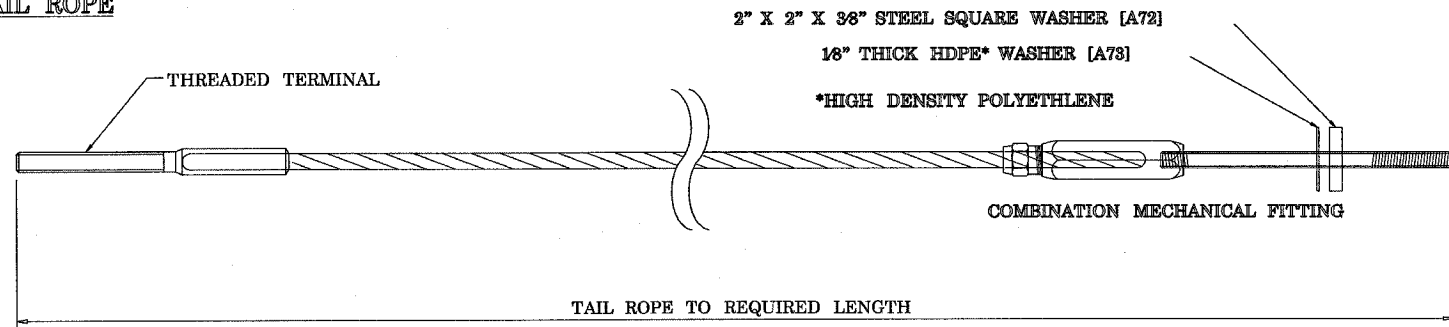

**RIGGING SCREW [A52]
(TURNBUCKLE)**

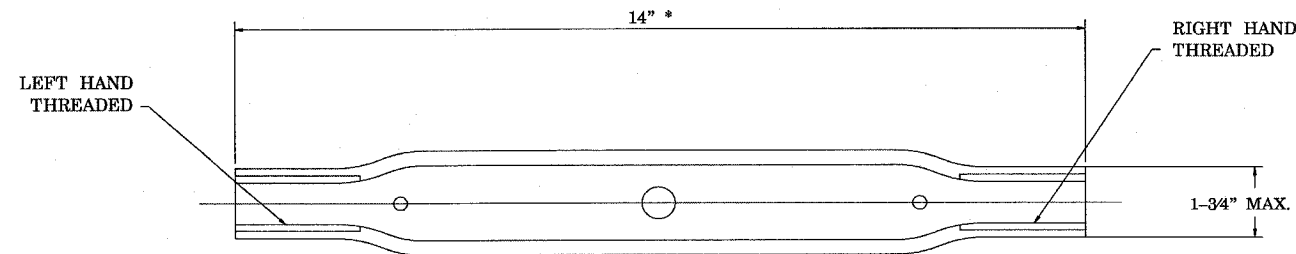

The information herein is proprietary to BRIFEN USA, and shall not be disclosed, duplicated or used otherwise without the express written consent of BRIFEN USA, Inc.

BRIFEN★USA INC.

Revisions			WIRE ROPE AND FITTINGS		
No.	Date	By	Date	Drawn By	Scale
1.	5.25.05	MW	5.17.05	Aaron Wells	None
2.	6.21.05	MW			
3.	6.28.05	MW			
4.					Sheet No.
5.			Dwg. No.	WRSF-05-202a	2 of 9

F.A.I. RTE.	SECTION	COUNTY	TOTAL SHEETS	SHEET NO.
55	60-0,211-2	MADISON	21	15
STA. 996+00		TO STA. 1026+00		
FED. ROAD DIST. NO. 5 ILLINOIS FED. AID PROJECT				

NOTES:

- BRIFEN DRAWINGS, SPECIFICATIONS AND PRODUCT MANUAL SHOULD BE REVIEWED PRIOR TO STARTING AN INSTALLATION. FOR ASSISTANCE OR ADDITIONAL INFORMATION CALL 1-866-427-4336 TOLL FREE.
- WIRE ROPE SAFETY FENCE (WRSF) IS RECOMMENDED FOR INSTALLATIONS ON SLOPES OF 6:1 OR FLATTER. THE AREA SHOULD BE RELATIVELY SMOOTH, WITHOUT EDGE DROP-OFF, ABRUPT SLOPE CHANGES, HOLES, DEBRIS, ETC. THAT COULD PREVENT A VEHICLE FROM IMPACTING THE WRSF WITH ALL WHEELS ON THE GROUND AND SUSPENSION NORMAL. SOME FILLING AND/OR GRADING AND COMPACTION MAY BE NECESSARY. THE ROPES MUST BE PLACED AT DESIGN HEIGHT ABOVE GROUND LINE. TOLERANCE IS * 1".
- WRSF MAY BE INSTALLED ON EITHER SIDE OF THE ROAD WAY. THE RADIUS EDGE OF POSTS SHALL BE ON THE APPROACH SIDE OF TRAFFIC. ALSO SEE SHEET 5.
- POSTS SHALL BE SOCKETED DESIGN, UNLESS OTHERWISE SPECIFIED; SPACING MAY BE DECREASED TO AVOID OBSTACLES. ADEQUATE CLEARANCE TO RIGID OBSTACLES SUCH AS BRIDGE PIERS, SIGN SUPPORTS, POWER POLES, AND TREES, IS CRITICAL. SEE PRODUCT MANUAL OR CONTACT MANUFACTURER.
- CONCRETE (BY OTHERS) TO BE 3,500 PSI MINIMUM. EXPOSED SURFACES TO BE HAND TROWELED. FOUNDATION (TYPICALLY 30" DEPTH) FOR USE IN FIRM SOIL OR WHEN INSTALLED SURROUNDED BY 4" MIN. SURFACING.
- PRISMATIC REFLECTIVE SHEETING (ADHESIVE BACK) WHEN SPECIFIED SHALL BE FIELD APPLIED. SPECIFY COLOR, POST INTERVAL AND SINGLE OR DOUBLE SIDED.
- EXCLUDER TO BE PUSHED DOWN TIGHT AGAINST TOP OF SOCKET. SOCKET SHALL BE FLUSH WITH THE TOP OF THE FOUNDATION.

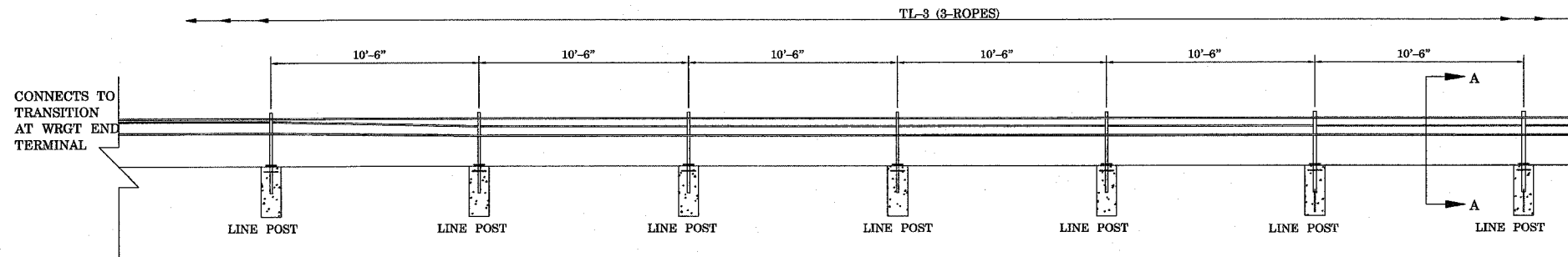

TYPICAL ELEVATION

(SEE DETAIL BELOW)

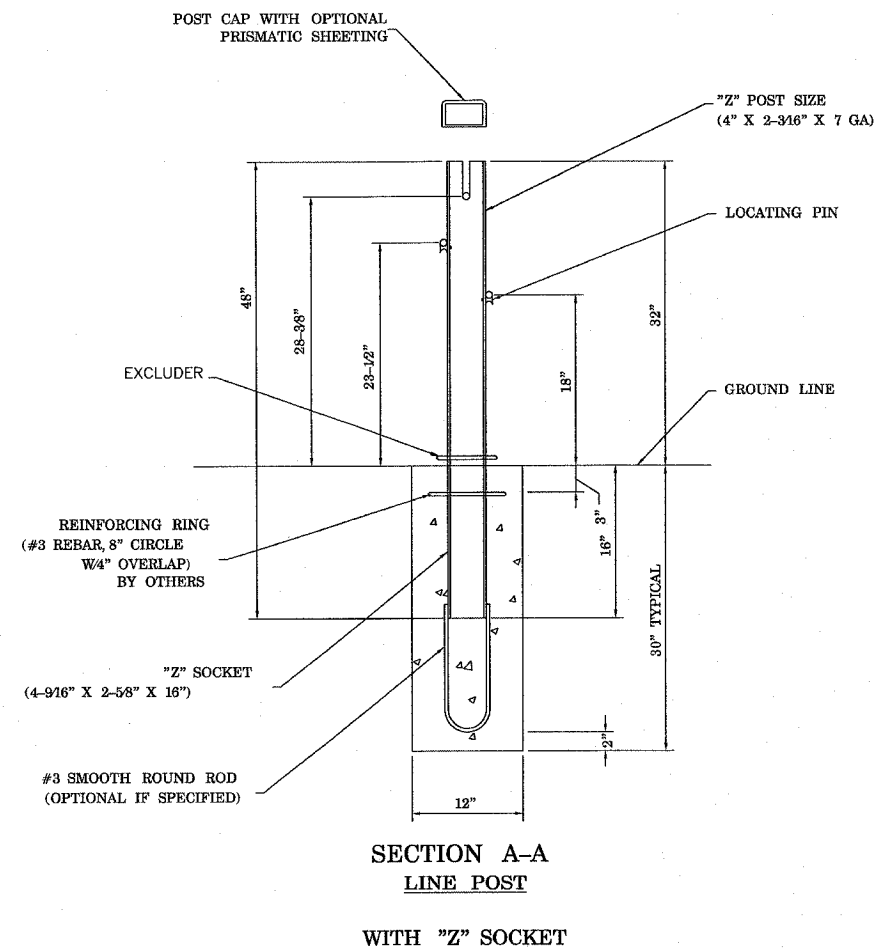

CONCRETE SOCKETED FOUNDATION

(DRIVEN STEEL SOCKET OPTIONAL)

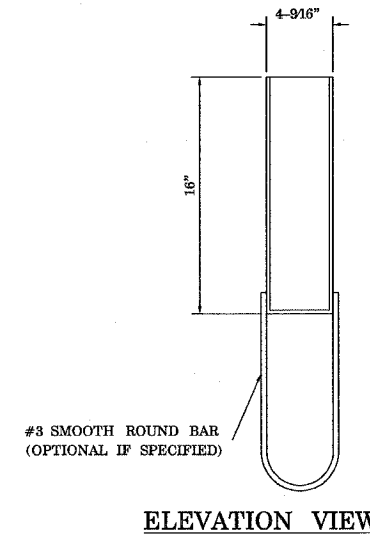

ELEVATION VIEW

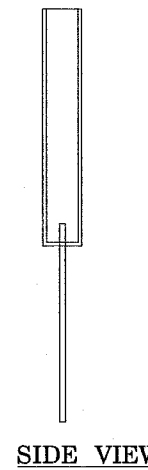

SIDE VIEW

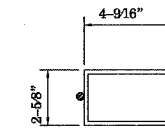

PLAN VIEW

'Z' SOCKET DETAIL

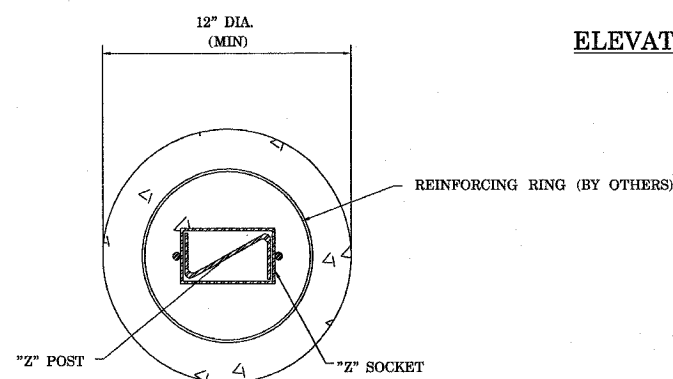

FOUNDATION PLAN VIEW

The information herein is proprietary to BRIFEN USA, and shall not be disclosed, duplicated or used otherwise without the express written consent of BRIFEN USA, Inc.

BRIFEN★USA INC.

Revisions			TL-3 WRSF DETAIL (3-ROPE @ 10'-6" POST SPACING)		
No.	Date	By	Date	Drawn By	Scale
1.	5.26.05	MW	5.17.05	Manita Workman	None
2.	6.21.05	MW			
3.	6.28.05	MW	(INCLUDING TRANSITION TO WRGT)		
4.					
5.			Dwg. No.	WRSF-05-203a	3 of 9

PLOT DATE = 7/18/2005
 FILE NAME = c:\p\projects\4082305\plan\14d8388.dgn
 PLOT SCALE = 50.0000 / IN.
 REFERENCE = 4107*

F.A.I. RTE.	SECTION	COUNTY	TOTAL SHEETS	SHEET NO.
55	60-(1,2)I-2	MADISON	21	17
STA. 996+00		TO STA. 1026+00		
FED. ROAD DIST. NO. 5 ILLINOIS FED. AID PROJECT				

NOTES:

1. RADIUS EDGE OF POSTS SHALL BE ON THE APPROACH SIDE OF TRAFFIC.
2. ROPES B, C, AND D INTERWEAVE BETWEEN ALL POSTS. SEE NOTE 3.
3. THE 15 TRANSITION LINE POSTS ADJACENT TO WRGT END TERMINAL DO NOT HAVE TOP ROPE SLOTS. THE TOP ROPE WEAVES ON EITHER SIDE OF POSTS UNTIL THE FIRST LINE POST WITH A SLOT.
4. POSTS PEG HOLES ARE PRE-DRILLED SO THAT ROPES MAY BE PLACED ON EITHER SIDE OF POST DEPENDING ON ROPE WEAVE PATTERN.
5. PRISMATIC REFLECTIVE SHEETING (ADHESIVE BACK) WHEN SPECIFIED SHALL BE FIELD APPLIED. SPECIFY COLOR, POST INTERVAL AND SINGLE OR DOUBLE SIDED. SEE SHEET 6 FOR CAP DETAILS.
6. EXCLUDER TO BE PUSHED DOWN TIGHT AGAINST TOP OF SOCKET. SOCKET SHOULD BE FLUSH WITH THE TOP OF THE FOUNDATION.
7. CONCRETE (BY OTHERS) TO BE 3,500 PSI MINIMUM. EXPOSED SURFACES TO BE HAND TROWELED.
8. WRGT END ANCHOR TERMINAL POSTS (TYPE A & B) TO BE PLACED WITH WEAKENING CUT (RELIEF NOTCH) TOWARD END ANCHOR.

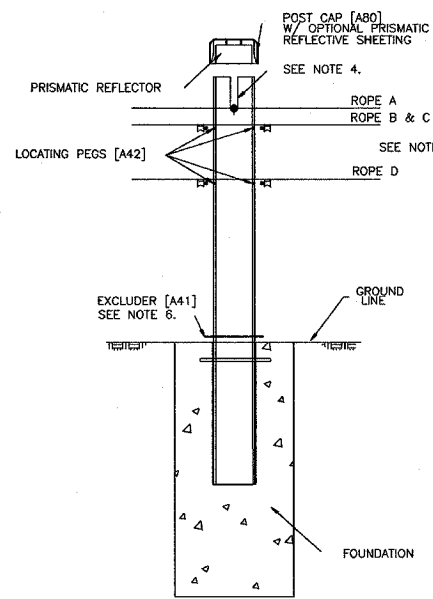

SOCKETED LINE POST ASSEMBLY

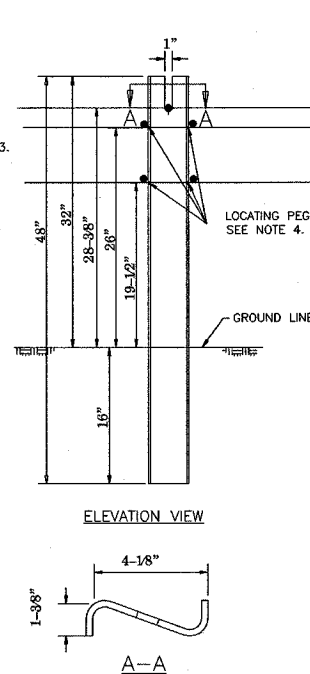

STANDARD LINE POST DETAIL

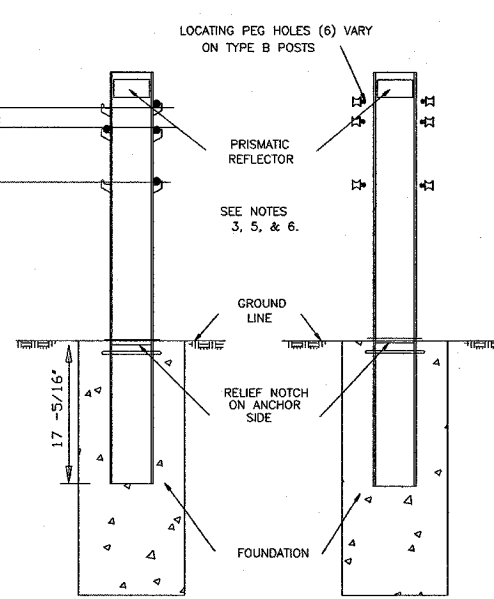

POST TYPE 'A'
POST #1

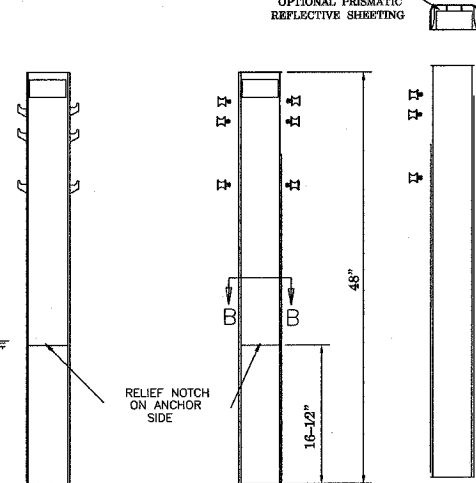

POST TYPE 'B'
POST #2 THRU 4

WRGT TERMINAL POSTS ASSEMBLY

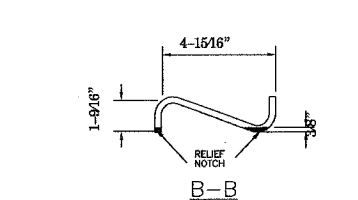

NON - SLOTTED
TRANSITION LINE POST
(8 GA)

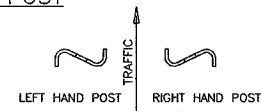

POST ORIENTATION
LEFT HAND POST [A11L] RIGHT HAND POST [A11R]

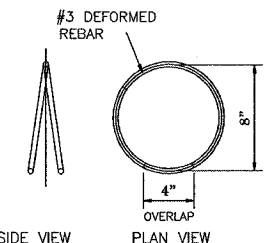

REINFORCING RING DETAIL
(BY OTHERS)

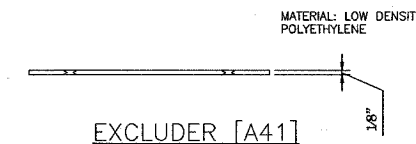

EXCLUDER [A41]

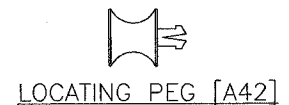

LOCATING PEG [A42]

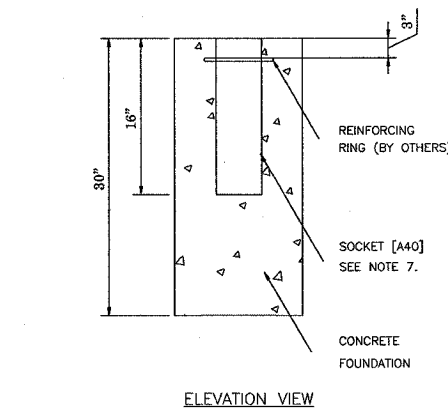

ELEVATION VIEW

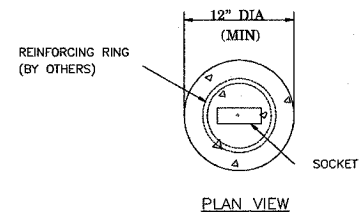

PLAN VIEW

LINE POST FOUNDATION

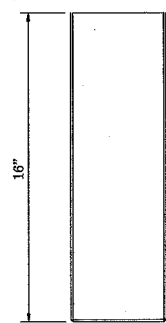

ELEVATION VIEW

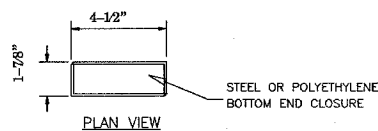

PLAN VIEW

LINE POST SOCKET [A40]

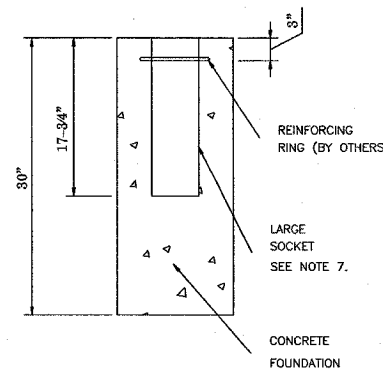

ELEVATION VIEW

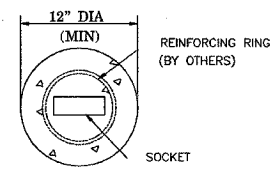

PLAN VIEW

WRGT TERMINAL
POST FOUNDATION

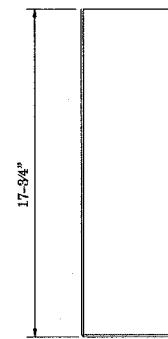

ELEVATION VIEW

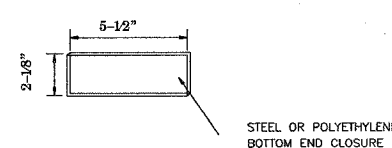

PLAN VIEW

WRGT LARGE SOCKET

The information herein is proprietary to BRIFEN USA, and shall not be disclosed, duplicated or used otherwise without the express written consent of BRIFEN USA, Inc.

BRIFEN USA INC.

Revisions			SOCKETED POST DETAILS (TL-3, 4 - ROPE SHOWN)		
No.	Date	By	Date	Drawn By	Scale
1.	5.26.05	MW	5.17.05	Manita Workman	None
2.	6.21.05	MW			
3.	6.28.05	MW			
4.					Sheet No.
5.			Dwg. No.	WRSF-05-205a	5 of 9

PLOT DATE = 7/16/2005
 FILE NAME = c:\p\brifen\wrsf\05\plan\p\05205a.dgn
 PLOT SCALE = 1"=10'-0"
 REFERENCE = BRIFEN

F.A.I. RTE.	SECTION	COUNTY	TOTAL SHEETS	SHEET NO.
55	60-1,211-2	MADISON	21	19
STA. 996+00		TO STA.1026+00		
FED. ROAD DIST. NO. 5 ILLINOIS FED. AID PROJECT				

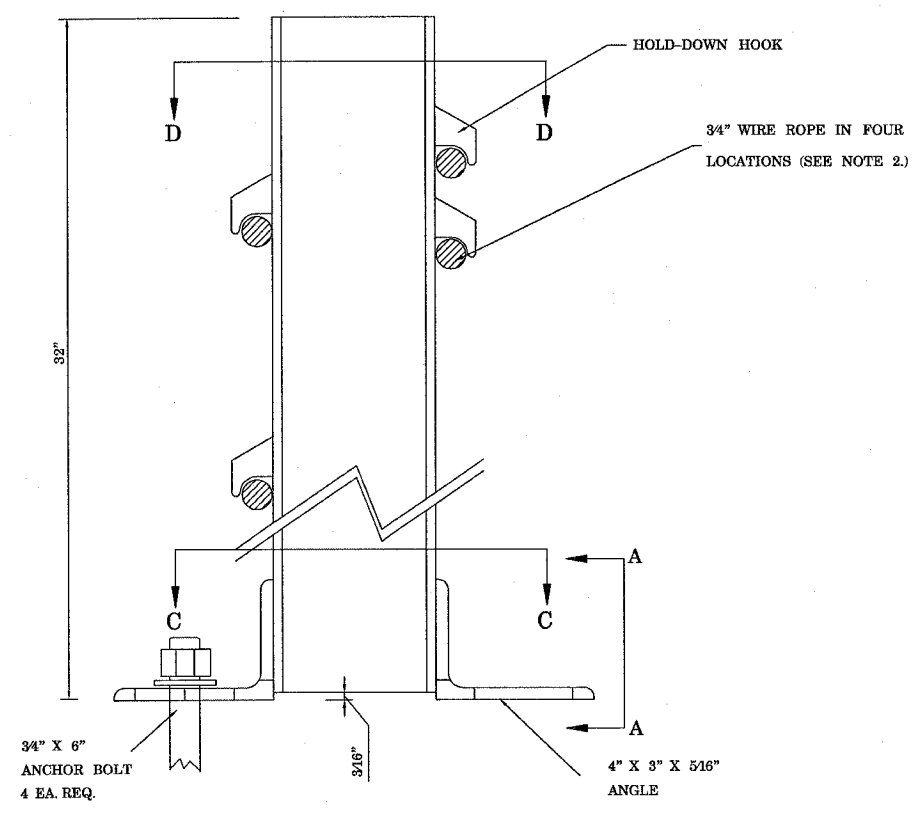

HOLD-DOWN SURFACE MOUNT POST
(LEFT-HAND SHOWN)

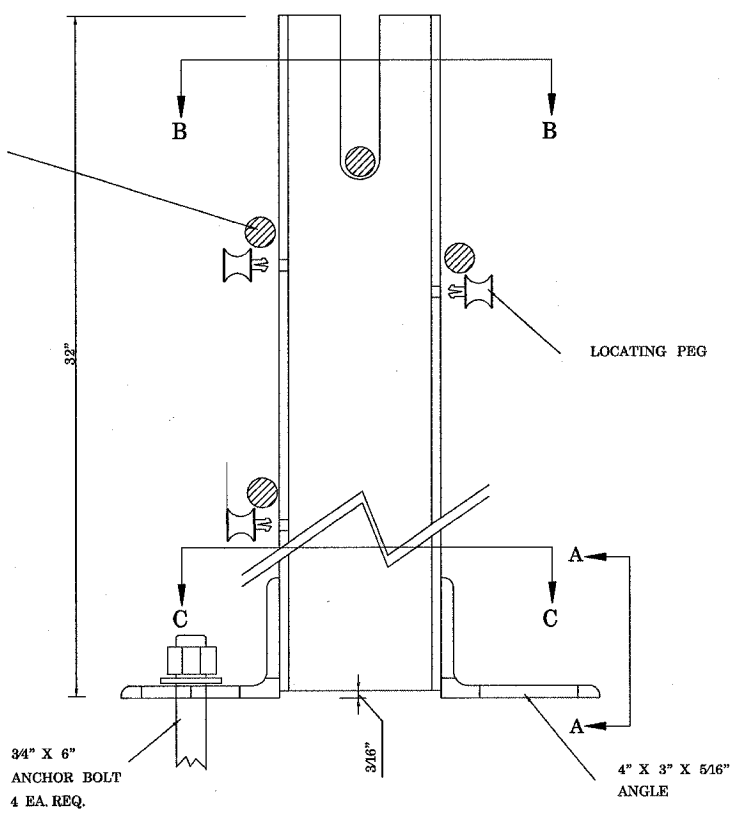

STANDARD SURFACE MOUNT POST
(LEFT-HAND SHOWN)

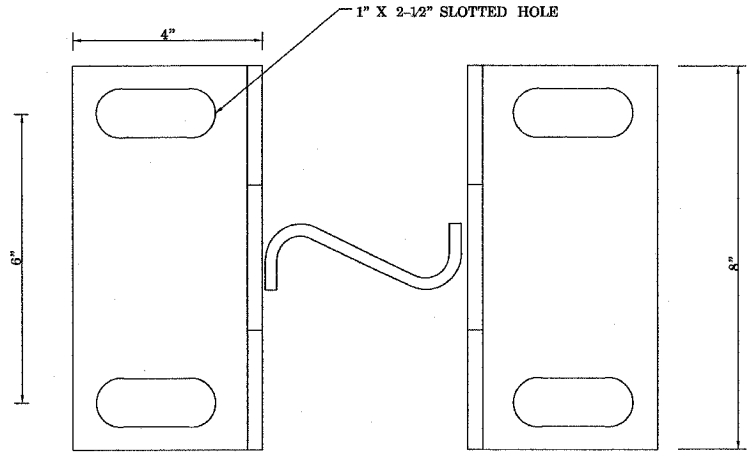

SECTION C-C

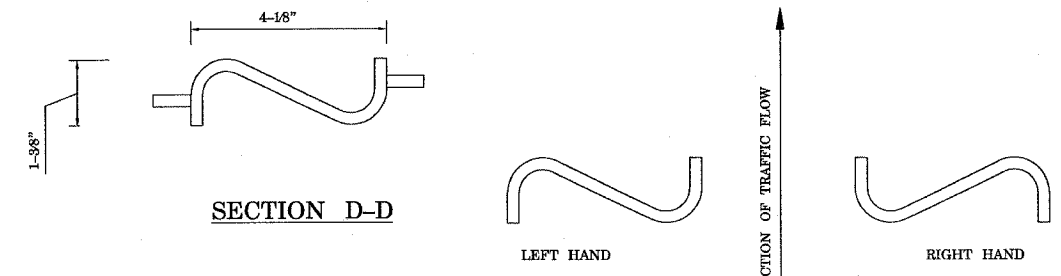

SECTION D-D

LEFT HAND DIRECTION OF TRAFFIC FLOW RIGHT HAND

POST ORIENTATION

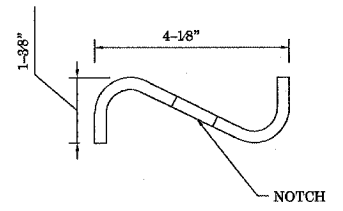

SECTION B-B

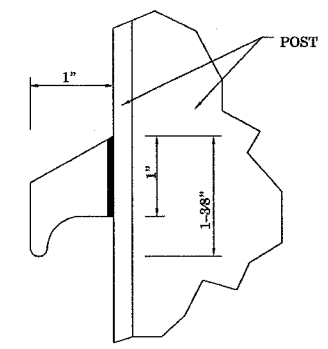

HOLD-DOWN HOOK

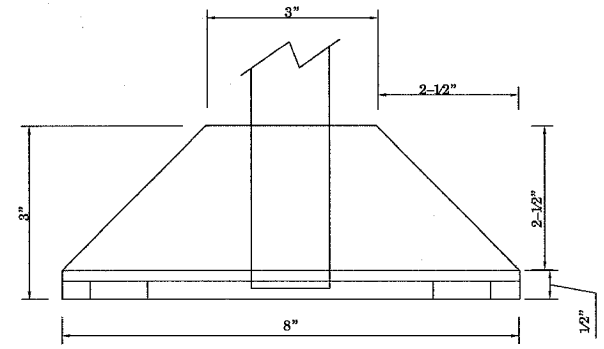

SECTION A-A

The information herein is proprietary to BRIFEN USA, and shall not be disclosed, duplicated or used otherwise without the express written consent of BRIFEN USA, Inc.

BRIFEN★USA INC.

Revisions			SURFACE MOUNT POSTS (4-ROPES, TL-3)		
No.	Date	By	Date	Drawn By	Scale
1.	5.26.05	MW	5.17.05	Manita Workman	None
2.	6.21.05	MW			
3.	6.28.05	MW	Sheet No.		
4.					
5.			Dwg. No.	WRSF-05-207a	7 OF 9

PLOT DATE = 7/16/2005
FILE NAME = s:\brifenc\usa\050825\plan\050825.dgn
PLOT SCALE = 50.0000 / 1"
REFERENCE = BRIFEN

F.A.I. RTE.	SECTION	COUNTY	TOTAL SHEETS	SHEET NO.
55	60-(1,2)-2	MADISON	21	20
STA. 996+00		TO STA. 1026+00		
FED. ROAD DIST. NO. 5		ILLINOIS FED. AID PROJECT		

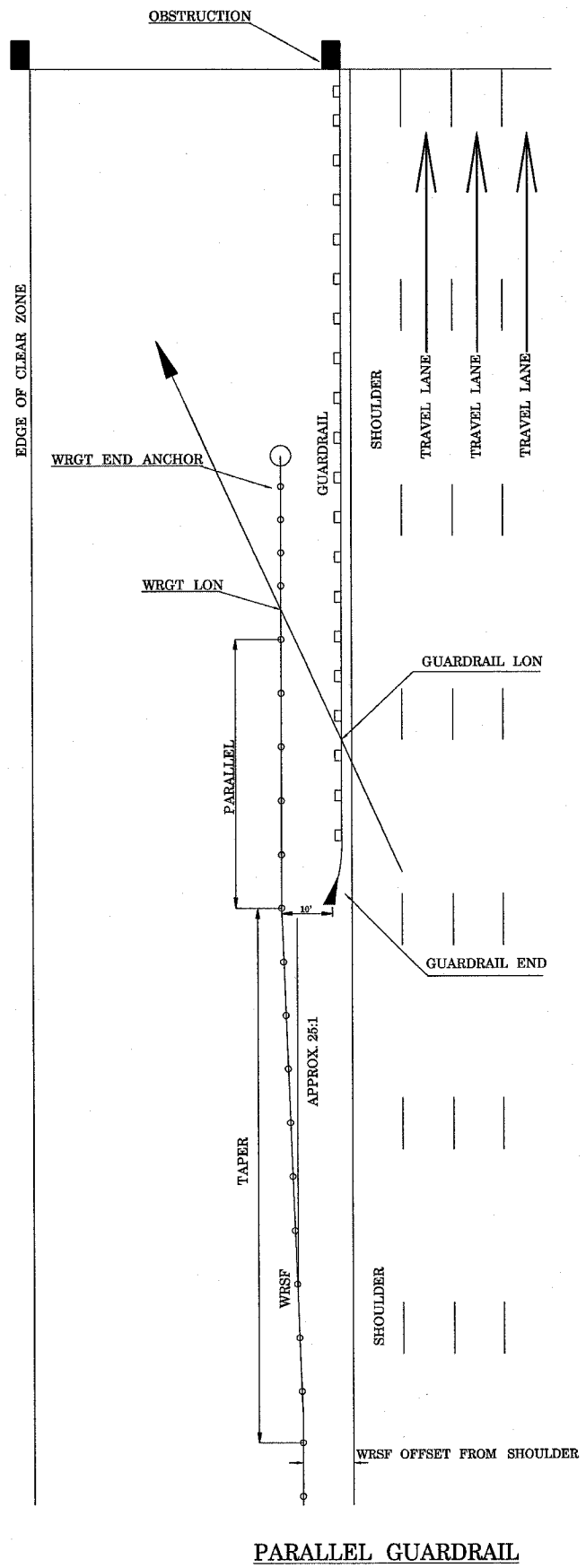

PARALLEL GUARDRAIL

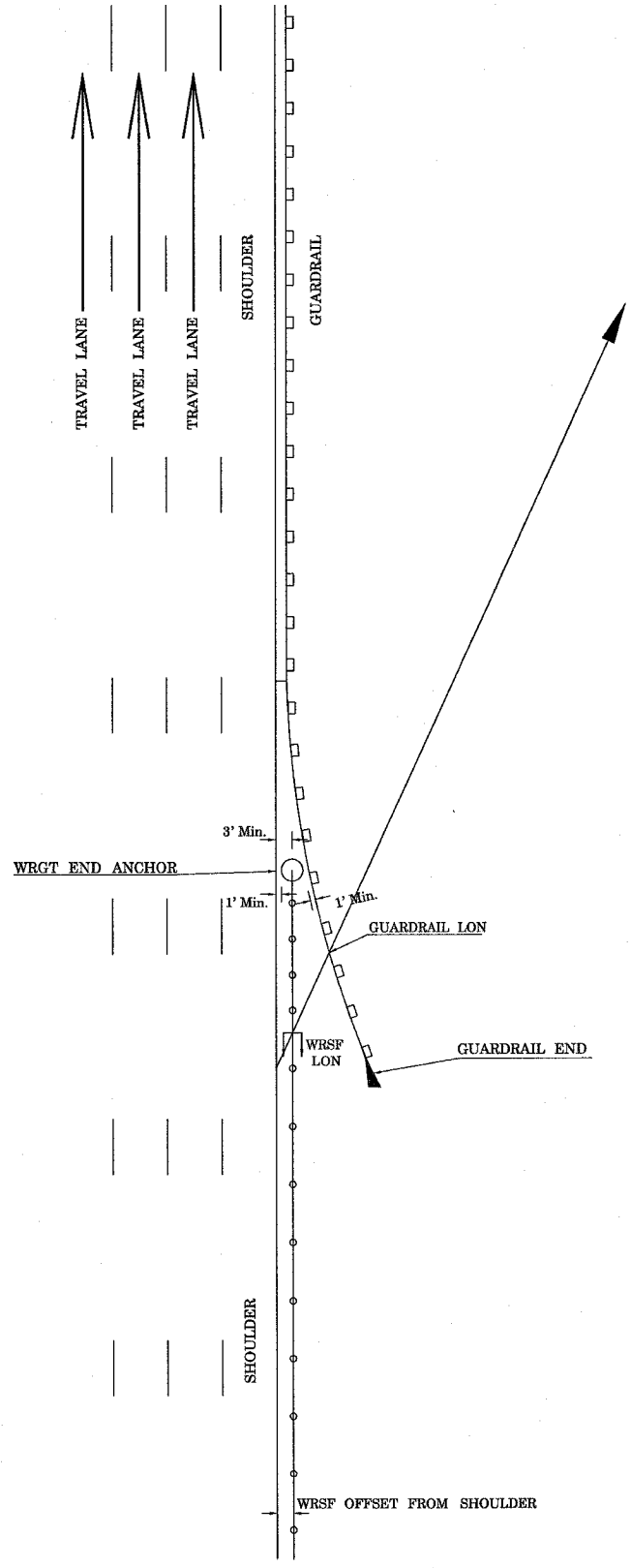

FLARED GUARDRAIL

The information herein is proprietary to BRIFEN USA, and shall not be disclosed, duplicated or used otherwise without the express written consent of BRIFEN USA, Inc.

BRIFEN★USA INC.

Revisions			RECOMMENDED WRSF INTERFACE WITH GUARDRAIL		
No.	Date	By	Date	Drawn By	Scale
1.	5.26.05	MW	5.17.05	Manita Workman	None
2.	6.21.05	MW			
3.	6.28.05	MW			
4.					Sheet No.
5.			Dwg. No.	WRSF-50-208a	8 of 9

PLOT DATE = 7/18/2005
 FILE NAME = c:\projects\wdr\10305\plan\p108305a.dgn
 PLOT SCALE = 1/8" = 1'-0"
 REFERENCE = WRSF

F.A.I. RTE.	SECTION	COUNTY	TOTAL SHEETS	SHEET NO.
55	60-(1,2)1-2	MADISON	21	21
STA. 996+00		TO STA. 1026+00		
FED. ROAD DIST. NO. 5 ILLINOIS FED. AID PROJECT				

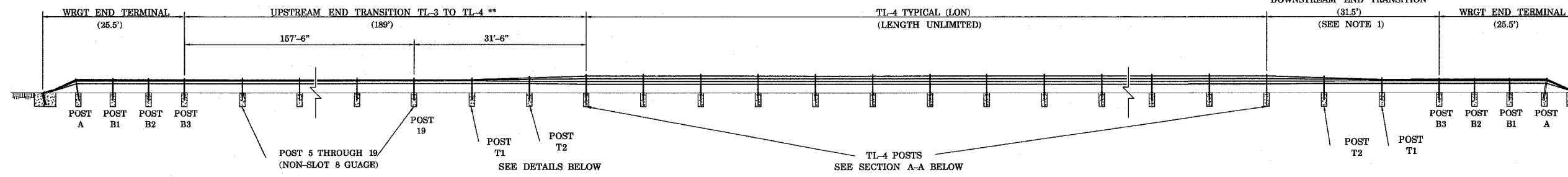

TYPICAL TL-4 LAYOUT

** PAID AS LF OF TL-4 WRSF

NOTE:

1. DOWNSTREAM END TRANSITION USED ONLY WHEN WRGT END ANCHOR IS PLACED WHERE IT CANNOT BE IMPACTED HEAD-ON; OTHERWISE USE UPSTREAM END TRANSITION.
2. A SPECIAL TL-4 END TERMINAL IS AVAILABLE (LON BEGINS 20' FROM END) FOR USE OUTSIDE THE CLEAR ZONE OR IF SHIELDED FROM IMPACT. CONTACT BRIFEN USA.

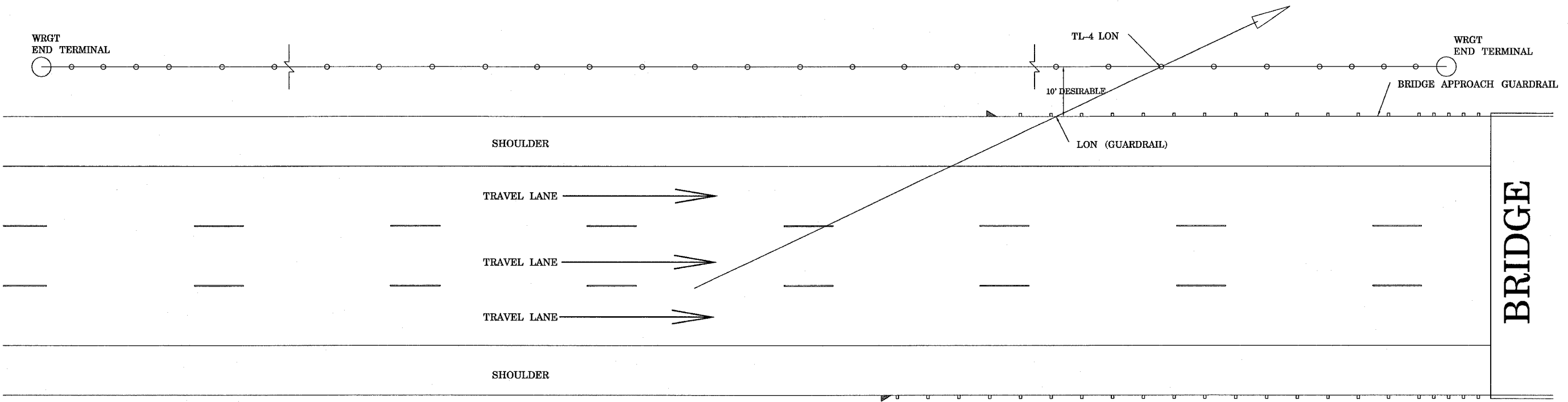

PLAN

**TL-4 WRSF @ BRIDGE APPROACHES, ETC
(DOWNSTREAM WRGT END ANCHOR SHIELDED)**

The information herein is proprietary to BRIFEN USA, and shall not be disclosed, duplicated or used otherwise without the express written consent of BRIFEN USA, Inc.

BRIFEN★USA INC.

Revisions			TL-4 WRSF AT BRIDGE APPROACHES (PARALLEL GUARDRAIL)		
No.	Date	By	Date	Drawn By	Scale
1.	5.26.05	MW	5.17.05	Manita Workman	None
2.	6.21.05	MW			
3.	6.28.05	MW			
4.					Sheet No.
5.			Dwg. No.	WRSF-05-209a	9 of 9

PLOT DATE = 7/18/2005
 FILE NAME = c:\p\m\meta\and86386\plan\plan0805a.dgn
 PLOT SCALE = 3/32" = 1' / IN.
 REFERENCE = WRSF