

F.A. R.T.E.	SECTION	COUNTY	TOTAL SHEETS	SHEET NO.
	05-00192-00-SW	COOK	11	5
MOUNT PROSPECT ROAD				
STA. 1+75		TO STA. 18+50		

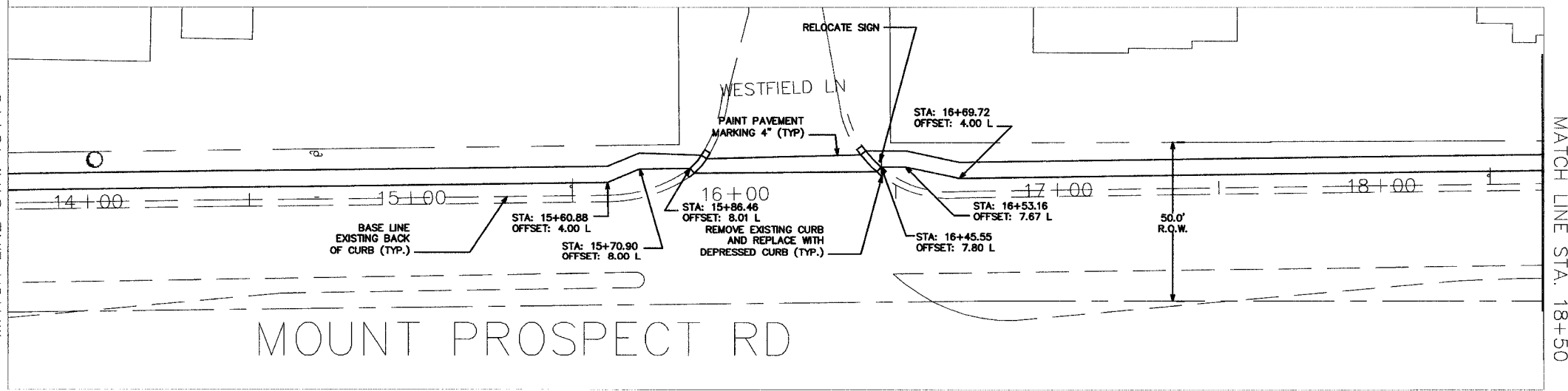
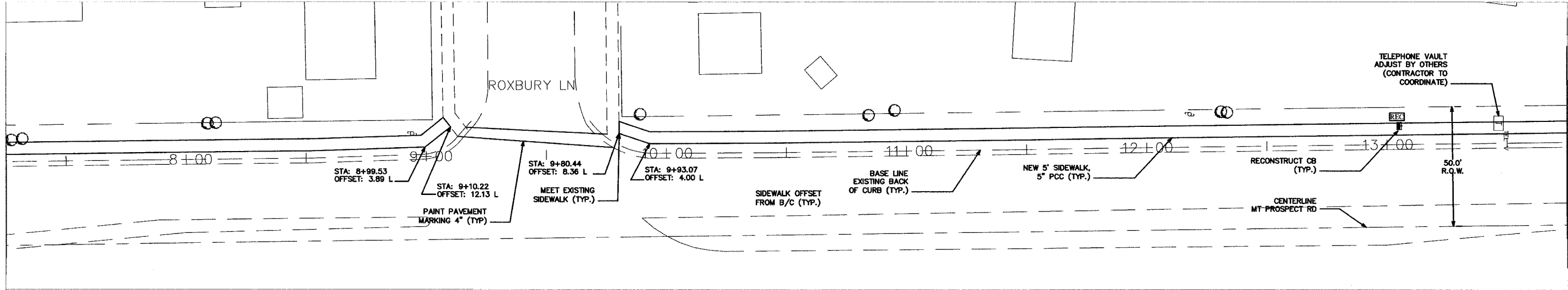
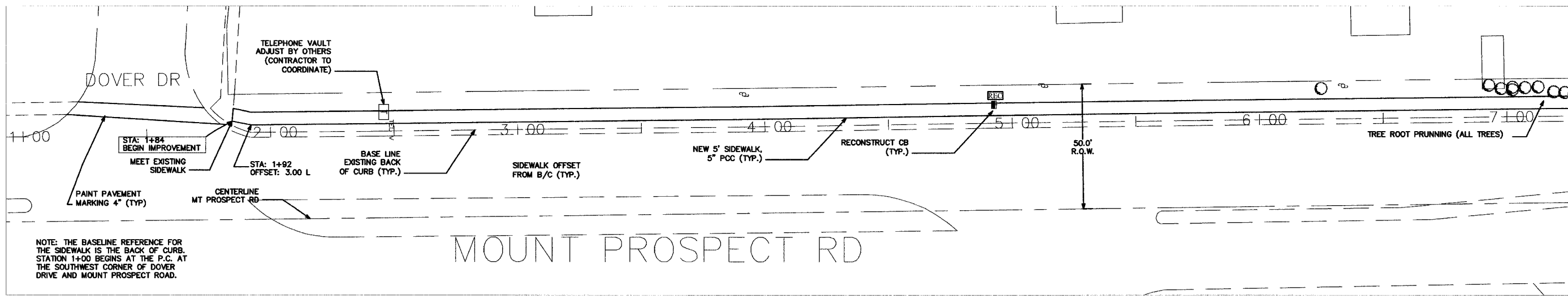

DETECTABLE WARNINGS ARE TO BE INSTALLED AT ALL INTERSECTIONS

REVISIONS	
NAME	DATE

ILLINOIS DEPARTMENT OF TRANSPORTATION
PLAN
 MOUNT PROSPECT ROAD
 DOVER DRIVE TO
 DEMPSTER/THACKER STREET
 SCALE: 20 SCALE
 DATE: 5-31-05
 DRAWN BY: BLS
 CHECKED BY: AJD