

### DETOUR ROUTE

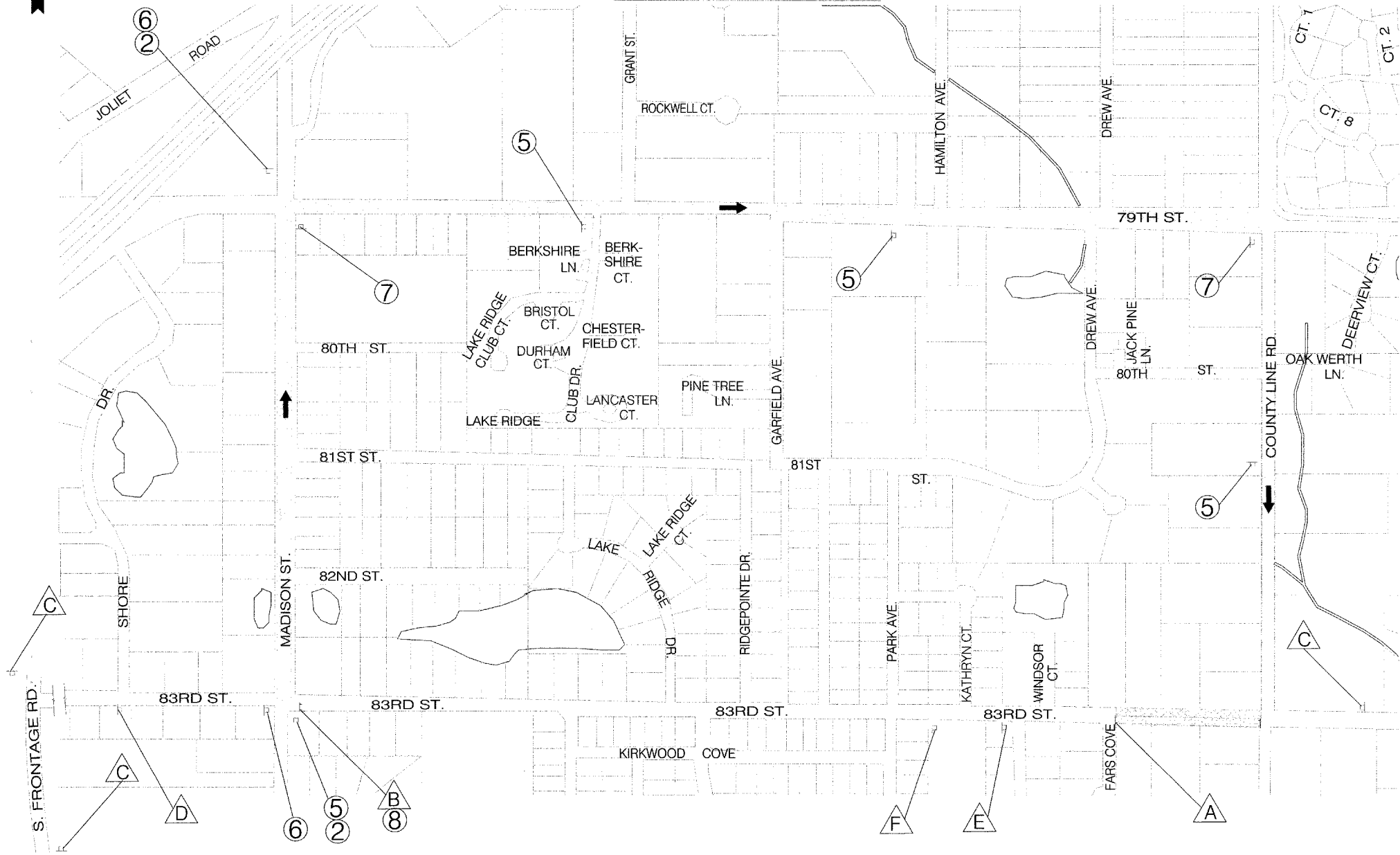

### NOTES

1. During construction of both stages 83rd street will be closed for through traffic from Fars Cove to County Line Road and traffic will be detoured via Madison Street & 79th Street as shown in detour plan. However, the local traffic shall be kept open in the Westbound direction.
2. Additional construction warning signs may be required (which are not shown in this plan) & shall be provided as per the instruction of the Engineer in charge. The cost incurred to comply will not be paid for separately, but included in the item "Traffic Control Devices".
3. All signs, barricades, sign's lights and flags shall be in accordance with those indicated in Traffic Control Standards of MUTCD & Standard Specifications.

### LEGEND

- PHASE 1 CONSTRUCTION ZONE
- PHASE 2 CONSTRUCTION ZONE
- DETOUR ROUTE
- TYPE II BARRICADE, WING TYPE
- TYPE III BARRICADE
- DETOUR SIGN
- CONSTRUCTION WARNING SIGN

<b>NORTH</b> ①	<b>SOUTH</b> ③
M3-1	M3-3
<b>EAST</b> ②	<b>WEST</b> ④
M3-2	M3-4
83RD STREET	
<b>DETOUR</b> ↑	
M4-9	
83RD STREET	
<b>DETOUR</b> ←	
M4-9L	
83RD STREET	
<b>DETOUR</b> →	
M4-9R	
<b>← DETOUR</b>	
M4-10L	
<b>DETOUR →</b>	
M4-10R	

<b>ROAD CLOSED</b>	A
R11-2	
<b>ROAD CLOSED TO THRU TRAFFIC</b>	B
R11-4	
TYPE A MONODIRECTIONAL FLASHING LIGHT	
<b>ROAD CONSTRUCTION AHEAD</b>	C
W20-1	
TYPE A MONODIRECTIONAL FLASHING LIGHT	
<b>DETOUR AHEAD</b>	D
W20-2	
TYPE A MONODIRECTIONAL FLASHING LIGHT	
<b>ROAD CLOSED AHEAD</b>	E
W20-3	
TYPE A MONODIRECTIONAL FLASHING LIGHT	
<b>ROAD CLOSED 1000 FT</b>	F
W20-10	

<b>83rd Street Improvements</b>	
Section No./TIP No.: 04-00029-00-PV/08-04-0020	Scale: NONE
Date: JULY, 2005	Sheet No.: 16 of 25
<b>TRAFFIC CONTROL PLAN</b>	
Plan Revisions	Comments:
Date:	
Village of Burr Ridge, IL Engineering Department 451 Commerce St. Burr Ridge, IL 60527 Phone: (630) 323-4733 FAX: (630) 323-4798	