

LEGEND

	NEW PAVEMENT		EXISTING UNDERGROUND COMED ELECTRIC LINE
	EXISTING INLET/MANHOLE		EXISTING OVERHEAD COMED ELECTRIC LINE
	EXISTING FLARED END SECTION		EXISTING UTILITY POLE
	EXISTING SLOPE BOX		EXISTING TELEPHONE
	EXISTING STORM SEWER AND SIZE		EXISTING 6' FENCE
	EXISTING FIRE HYDRANT		EXISTING RIGHT-OF-WAY
	EXISTING CONCRETE ENCASED DUCT BANK (NUMBER OF WAYS)		EXISTING UNDERDRAIN
	EXISTING GRS CONDUIT		EXISTING WATERMAIN
	EXISTING ELECTRICAL BOX		EXISTING ITEM TO BE REMOVED OR ABANDONED
	EXISTING BITUMINOUS PAVEMENT TO BE REMOVED (PAID FOR AS PAVEMENT REMOVAL) AND ROADWAY EMBANKMENT TO BE DEGRADED (PAID FOR AS UNCLASSIFIED EXCAVATION)		EXISTING GUARDRAIL
	EXISTING AGGREGATE TO BE REMOVED AND DEGRADED (PAID FOR AS UNCLASSIFIED EXCAVATION)		EXISTING ITEM TO BE RELOCATED
	EXISTING BITUMINOUS PAVEMENT TO BE REMOVED AND EXISTING AGGREGATE TO REMAIN (PAID FOR AS PAVEMENT REMOVAL)(SEE SEQUENCE OF CONSTRUCTION PLAN)		EXISTING MALSr TOWER
	NEW BUTT JOINT CONSTRUCTION		EXISTING MALSr SUPPORT
			EXISTING MONITORING WELL
			EXISTING SIGN/REFLECTIVE MARKER
			EXISTING CONCRETE CABLE MARKER

THE INFORMATION SHOWN ON THESE PLANS HAVE BEEN OBTAINED FROM AVAILABLE RECORDS. NEITHER THE OWNER NOR THE ENGINEER ASSUMES ANY RESPONSIBILITY WHATEVER IN RESPECT TO THE ACCURACY OR SUFFICIENCY OF THE INFORMATION AND THERE IS NO GUARANTEE EITHER EXPRESSED OR IMPLIED THAT THE CONDITIONS INDICATED ARE REPRESENTATIVE OF THOSE TO BE THE CONTRACTOR'S RESPONSIBILITY TO VISIT THE SITE AND ACQUAINT HIMSELF WITH THE EXISTING CONDITIONS.

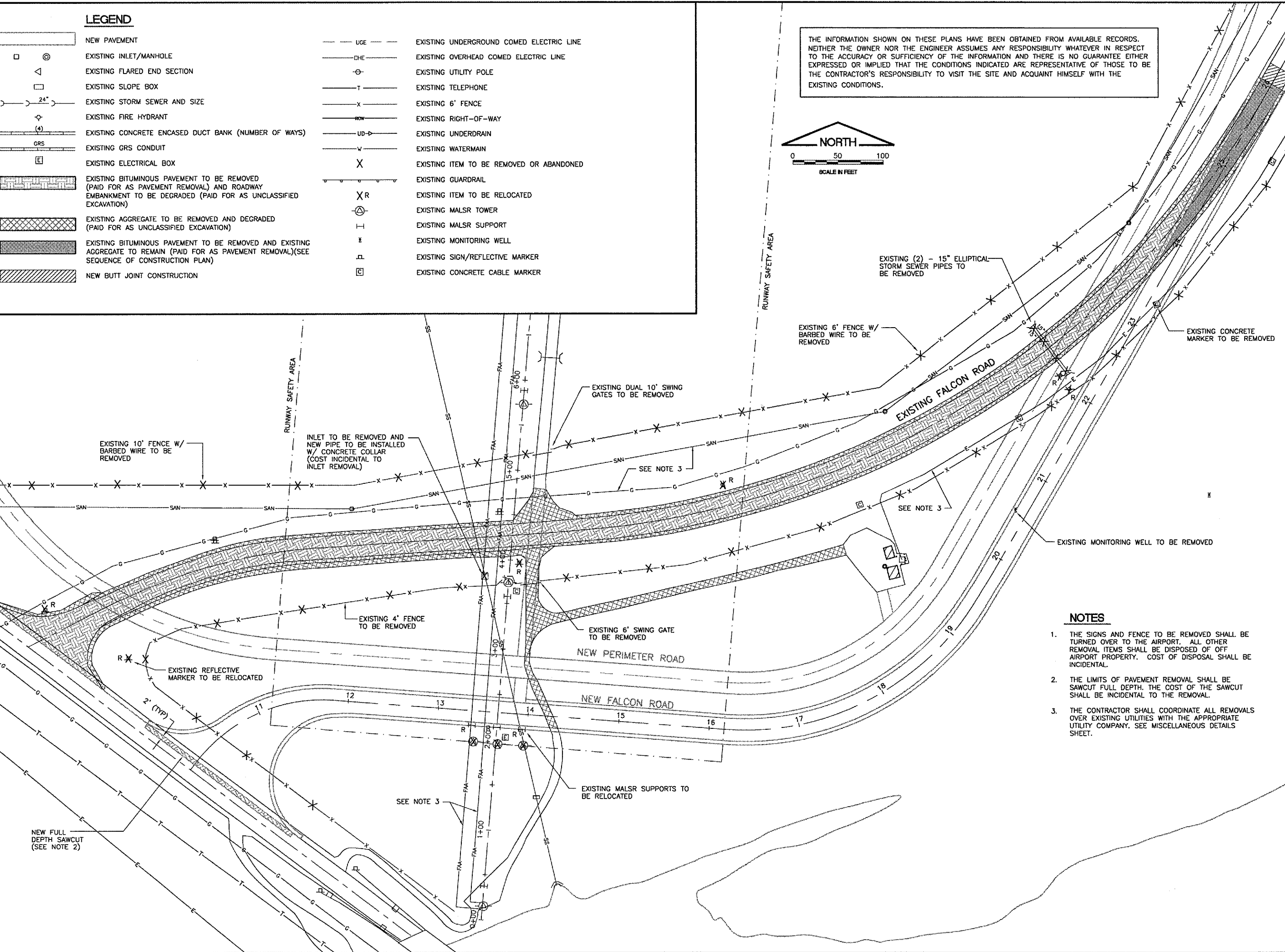
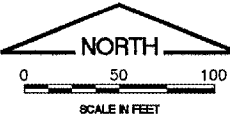

R0012



Rockford, Illinois

Greater Rockford Airport Authority

**AIP: 3-17-0088-43
RFD-3487**

**Rehab. Txy B;
Rwy 1/19 RSA Impr.,
Falcon Rd. Reloc.
S. RIAT Rd. Constr.
E. RIAT Rd. Reloc.**

Revisions

No.	Date	Description

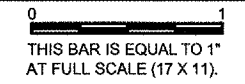

DESIGN BY: CMT-ARR
 DRAWN BY: CMT-ARR
 CHECKED BY: CMT-ARR
 APPROVED BY: JGP
 DATE: 7.29.2005
 JOB No: 04258-05-00

EXISTING CONDITIONS AND REMOVALS (FEC1)

22

NOTES

1. THE SIGNS AND FENCE TO BE REMOVED SHALL BE TURNED OVER TO THE AIRPORT. ALL OTHER REMOVAL ITEMS SHALL BE DISPOSED OF OFF AIRPORT PROPERTY. COST OF DISPOSAL SHALL BE INCIDENTAL.
2. THE LIMITS OF PAVEMENT REMOVAL SHALL BE SAWCUT FULL DEPTH. THE COST OF THE SAWCUT SHALL BE INCIDENTAL TO THE REMOVAL.
3. THE CONTRACTOR SHALL COORDINATE ALL REMOVALS OVER EXISTING UTILITIES WITH THE APPROPRIATE UTILITY COMPANY. SEE MISCELLANEOUS DETAILS SHEET.