

RO012



Rockford, Illinois  
 Greater Rockford  
 Airport Authority  
 AIP: 3-17-0088-43  
 RFD-3487

Rehab. Txy B;  
 Rwy 1/19 RSA Impr.,  
 Falcon Rd. Reloc.  
 S. RIAT Rd. Constr.  
 E. RIAT Rd. Reloc.

SEE RIAT ROAD  
 PLAN AND PROFILE 8  
 FOR LEGEND

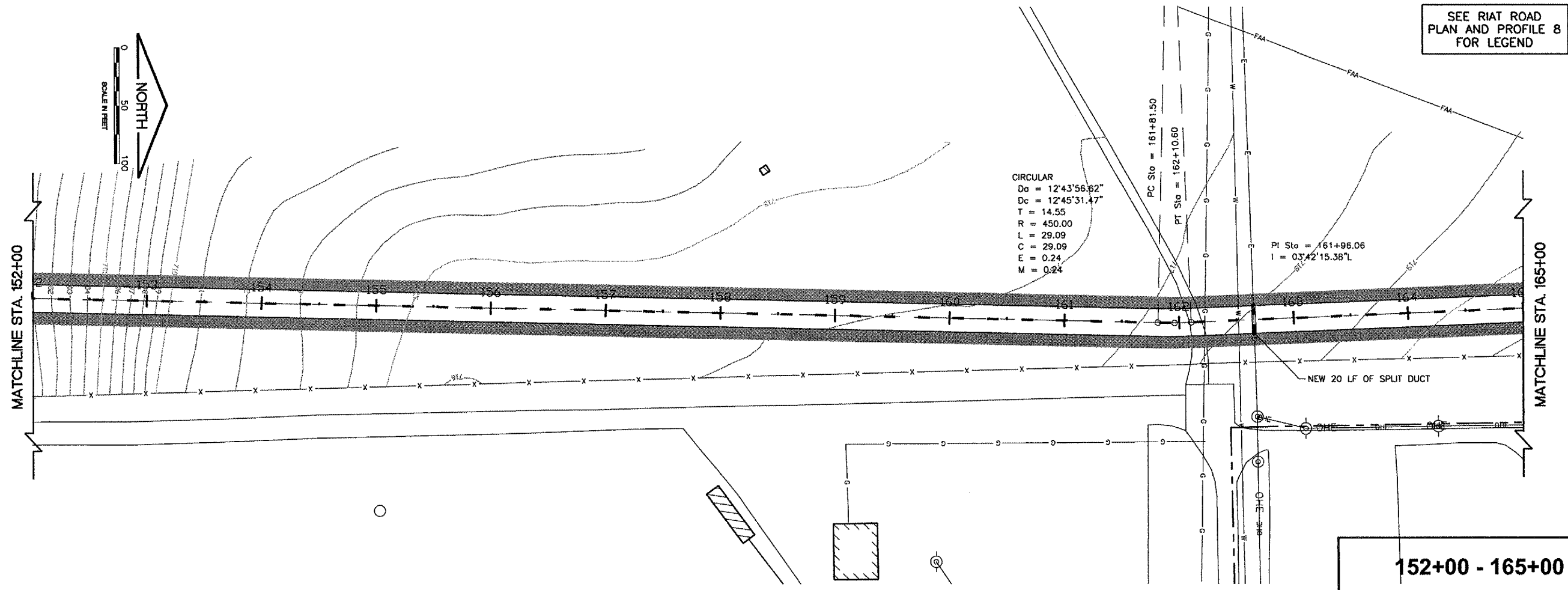

152+00 - 165+00

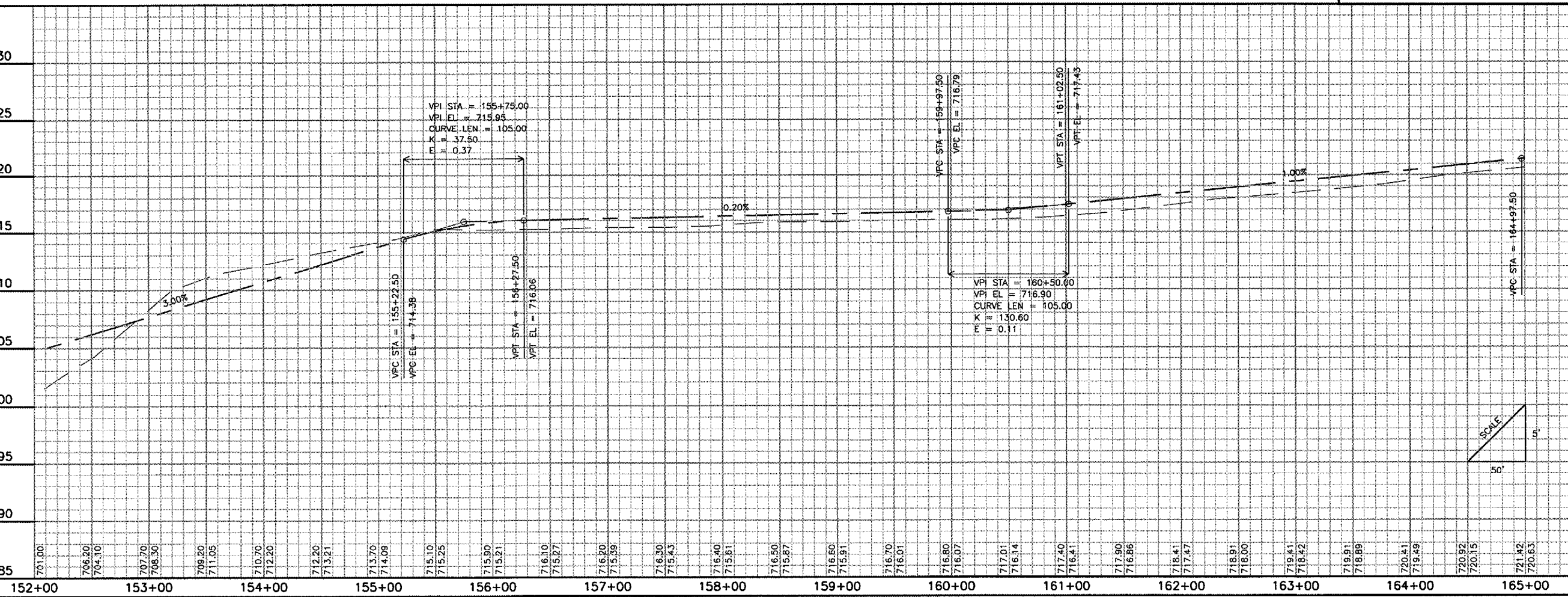

Revisions		
No.	Date	Description
730		
725		
720		
715		
710		
705		
700		

0 1  
 THIS BAR IS EQUAL TO 1" AT FULL SCALE (17 X 11).

DESIGN BY:	CMT- ARR
DRAWN BY:	CMT- ARR
CHECKED BY:	CMT- ARR
APPROVED BY:	JGP
DATE:	7.29.2005
JOB No:	05258-04-00

PLAN AND  
 PROFILE  
 5  
 (SPP5)

34