

RO012



Rockford, Illinois  
Greater Rockford  
Airport Authority

AIP: 3-17-0088-43  
RFD-3487

Rehab. Txy B;  
Rwy 1/19 RSA Impr.,  
Falcon Rd. Reloc.  
S. RIAT Rd. Constr.  
E. RIAT Rd. Reloc.

LEGEND

- EXISTING BUILDING
- EXISTING WATERMAIN
- EXISTING GAS LINE
- EXISTING FAA CABLE
- EXISTING AIRFIELD CABLE
- EXISTING TELEPHONE CABLE
- EXISTING FENCE
- EXISTING STORM SEWER
- EXISTING SANITARY SEWER
- EXISTING OVERHEAD ELECTRICAL CABLE
- EXISTING UTILITY POLE
- EXISTING WATER VALVE
- EXISTING STORM SEWER MANHOLE
- EXISTING FIRE HYDRANT
- EXISTING MONITORING WELL
- EXISTING STORM SEWER INLET
- EXISTING ITEM TO BE REMOVED
- NEW STORM SEWER
- NEW FLARED END SECTION
- NEW INLET
- NEW END SECTION
- NEW SPLIT DUCT

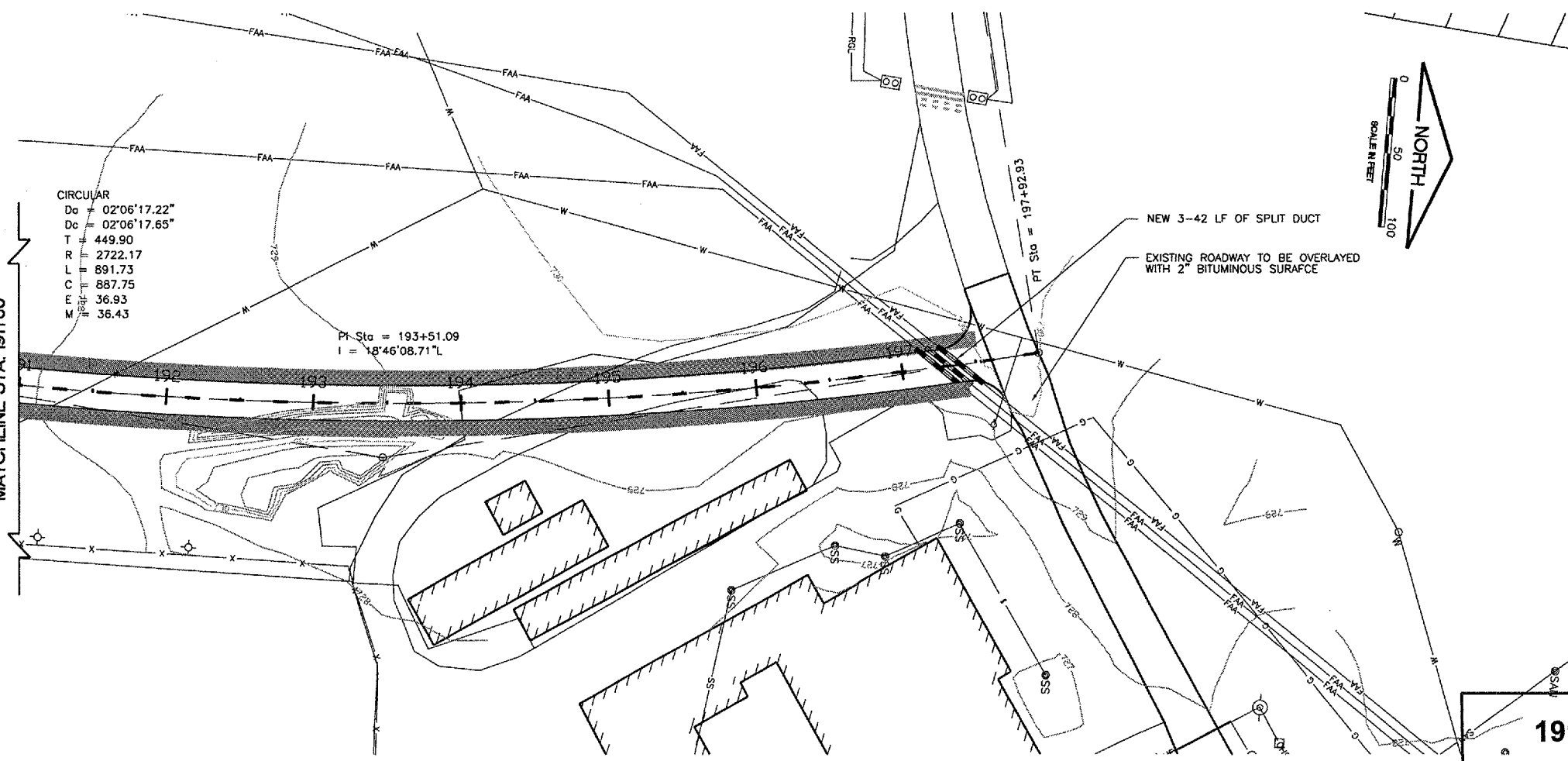
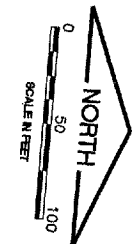

CIRCULAR  
D<sub>a</sub> = 02°06'17.22"  
D<sub>c</sub> = 02°06'17.65"  
T = 449.90  
R = 2722.17  
L = 891.73  
C = 887.75  
E = 36.93  
M = 36.43

PT Sta = 193+51.09  
I = 18°46'08.71" L

191+00 - 197+62

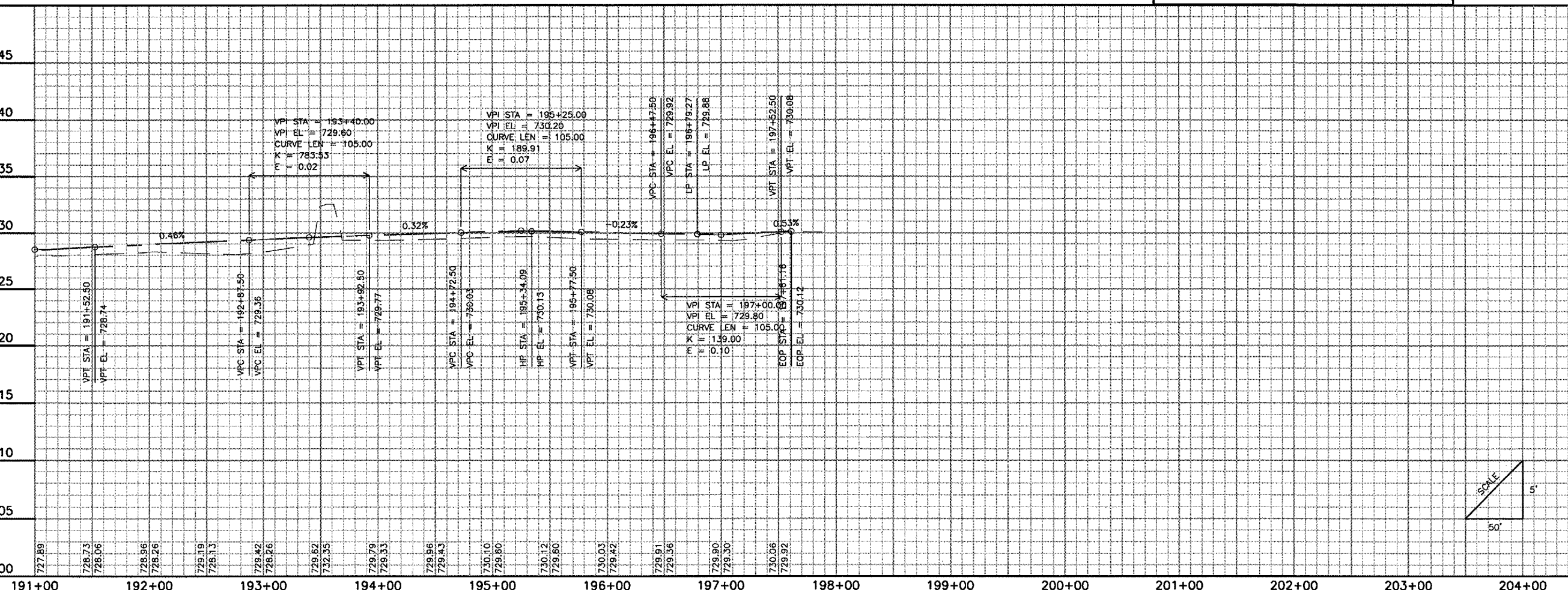

Revisions		
No.	Date	Description
745		
740		
735		
730		
725		
720		
715		
710		
705		
700		

0 1  
THIS BAR IS EQUAL TO 1"  
AT FULL SCALE (17 X 11).

DESIGN BY: CMT- ARR  
DRAWN BY: CMT- ARR  
CHECKED BY: CMT- ARR  
APPROVED BY: JGP  
DATE: 7.29.2005  
JOB No: 05258-04-00

**PLAN AND  
PROFILE  
8  
(SPP8)**

37

SHEET 37 OF 52 SHEETS