

PLAN	DESIGNED	BY	DATE
NOTE BOOK	ALIGNED		
NO.	CHECKED		
	CADD FILE NAME		

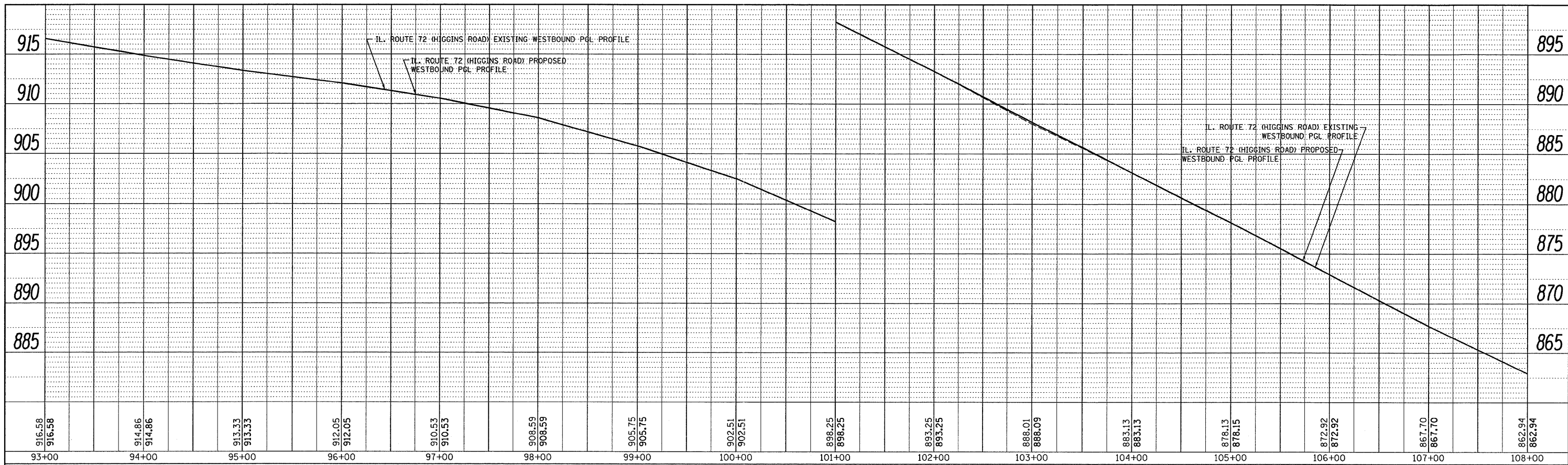

WESTBOUND PGL PROFILE

PROFILE	DESIGNED	BY	DATE
NOTE BOOK	GRADES CHECKED		
NO.	STRUCTURE NOTATIONS OK'D		

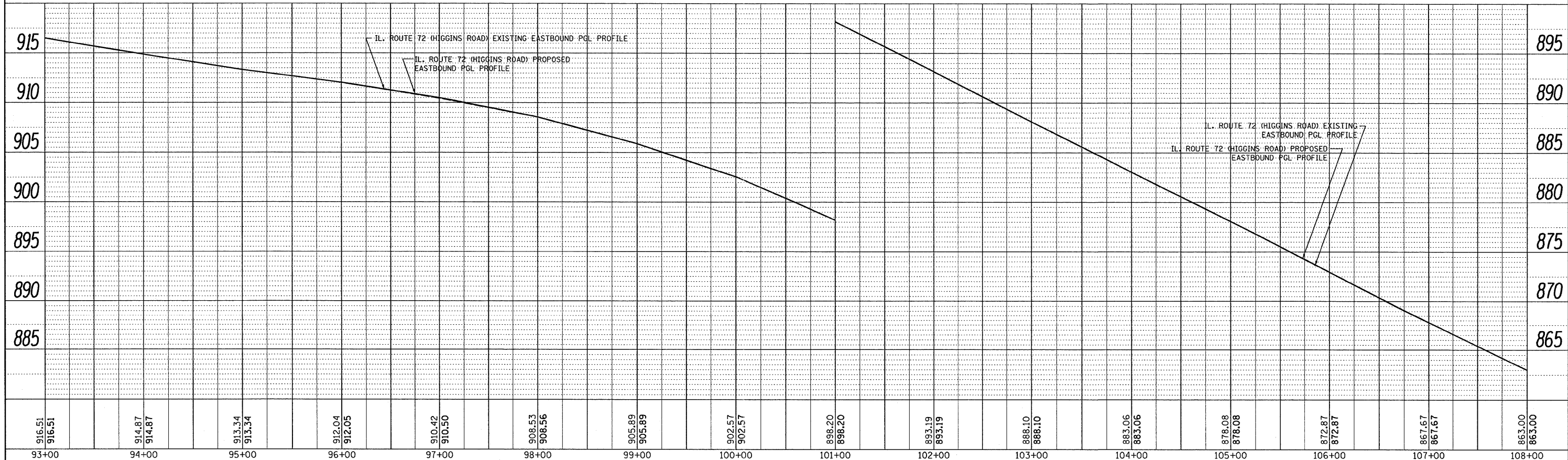

FILE NAME = P110008-shr-profile.dgn	USER NAME = drvakosgn	DESIGNED -	REVISED -	STATE OF ILLINOIS DEPARTMENT OF TRANSPORTATION	IL ROUTE 72 (HIGGINS ROAD) EXISTING & PROPOSED ROADWAY PROFILE		F.A.P. RTE. 341	SECTION 62-N-1	COUNTY KANE	TOTAL SHEETS 148	SHEET NO. 26	
PLOT SCALE = 50.0000' / IN.	CHECKED -	REVISED -	REVISED -		SCALE H: 1" = 50'	SHEET NO. OF SHEETS	STA. 93+00.00 TO STA. 108+00.00	CONTRACT NO. 60K09				
PLOT DATE = 5/31/2011	DATE -	REVISED -	REVISED -		ILLINOIS FED. AID PROJECT							

19:12:55 05/22/2011