

PLAN	SURVEYED	BY	DATE
	ALIGNED		
	NOTE BOOK		
	NO. OF WAY CHECKED		
	NO.		
	CADD FILE NAME		

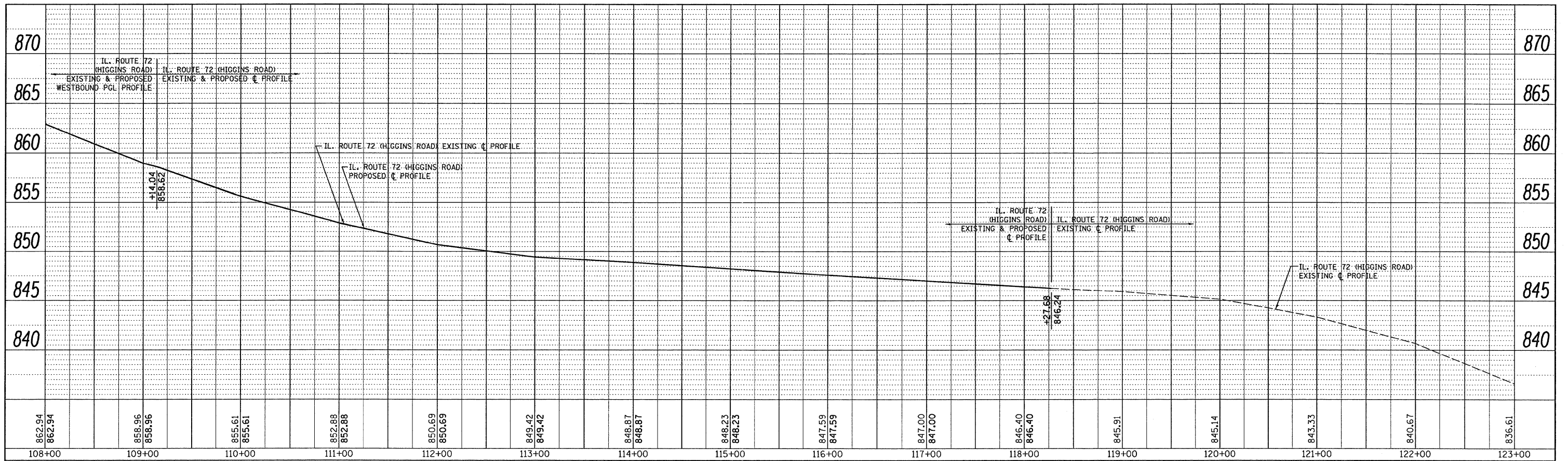

**WESTBOUND PGL PROFILE**

**EASTBOUND PGL PROFILE**

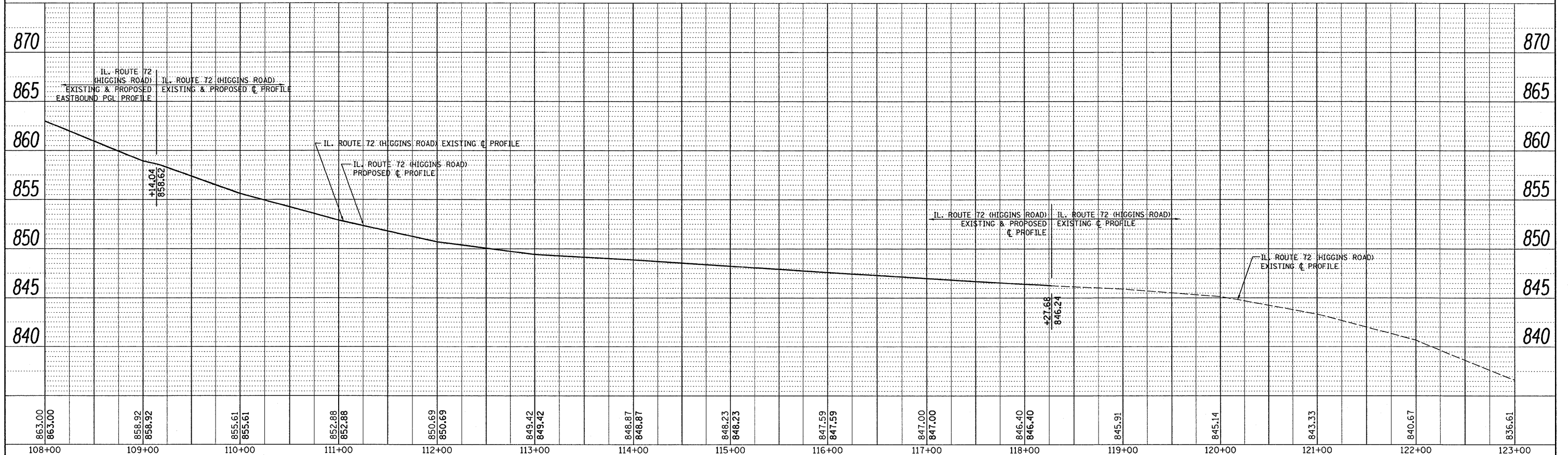

PROFILE	SURVEYED	BY	DATE
	ALIGNED		
	NOTE BOOK		
	NO. OF WAY CHECKED		
	NO.		
	STRUCTURE NOTATIONS CHECKED		

FILE NAME = P110028-shr-profile.dgn	USER NAME = drivakosgn	DESIGNED -	REVISED -	<b>STATE OF ILLINOIS DEPARTMENT OF TRANSPORTATION</b>	<b>IL. ROUTE 72 (HIGGINS ROAD) EXISTING &amp; PROPOSED ROADWAY PROFILE</b>		F.A.P. RTE. 341	SECTION 62-N-1	COUNTY KANE	TOTAL SHEETS 148	SHEET NO. 27	
	PLOT SCALE = 50.0000' / IN.	CHECKED -	REVISED -		SCALE H: 1" = 50'	SCALE V: 1" = 5'	SHEET NO. OF SHEETS	STA. 108+00.00 TO STA. 123+00.00	CONTRACT NO. 60K09			
	PLOT DATE = 5/31/2011	DATE -	REVISED -		ILLINOIS FED. AID PROJECT							

19:12:59 05/22/2011