

PLAN	SURVEYED	BY	DATE
	ALIGNED		
	RT. OF WAY CHECKED		
	CADD FILE NAME		

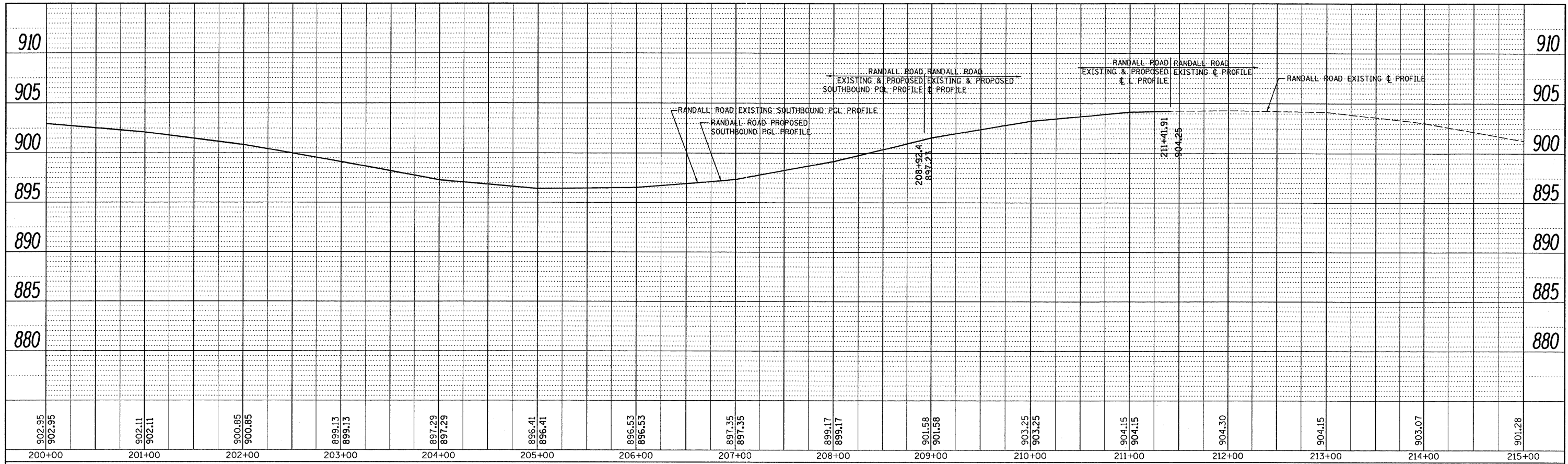

PROFILE	SURVEYED	BY	DATE
	PLOTTED		
	STRUCTURE NOTATIONS CHECKED		

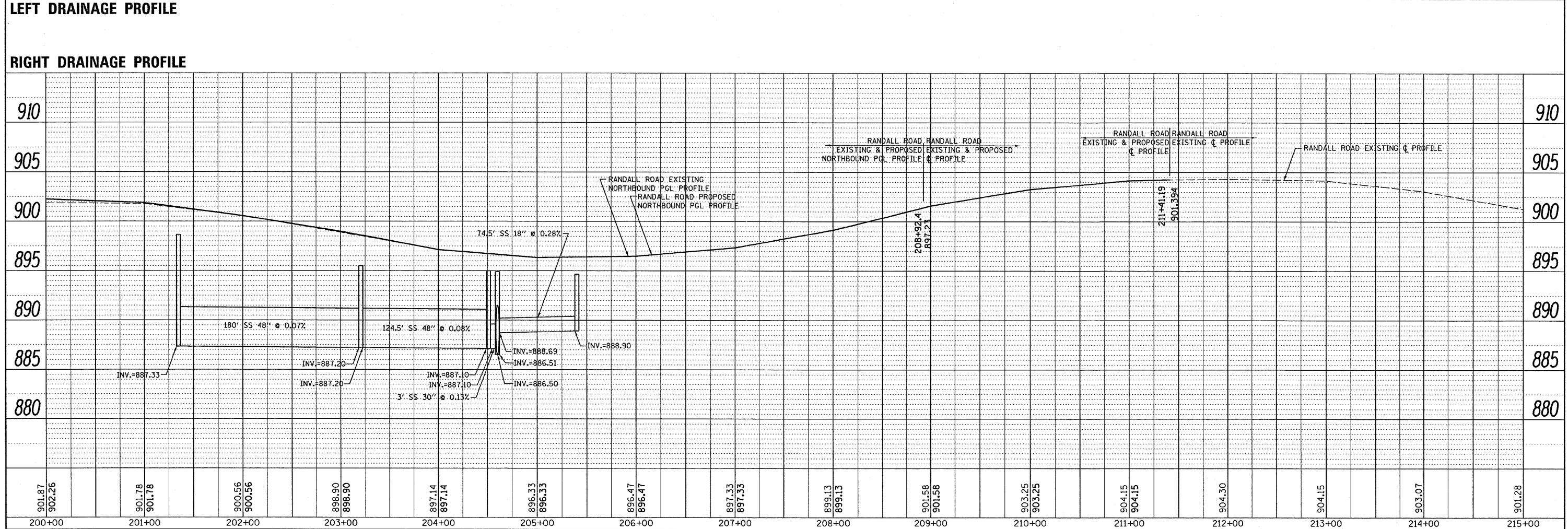

FILE NAME = P118008-shd-drain.dgn	USER NAME = drvakosgn	DESIGNED -	REVISED -	STATE OF ILLINOIS DEPARTMENT OF TRANSPORTATION	RANDALL ROAD EXISTING & PROPOSED DRAINAGE PROFILE	F.A.P. RTE. 341	SECTION 62-N-1	COUNTY KANE	TOTAL SHEETS 148	SHEET NO. 41			
PLOT SCALE = 50.0000' / IN.	CHECKED -	REVISED -	SCALE H: 1" = 50'			SCALE V: 1" = 5'	SHEET NO. OF	SHEETS	STA. 200+00.00 TO STA. 215+00.00	CONTRACT NO. 60K09			
PLOT DATE = 5/31/2011	DATE -	REVISED -	ILLINOIS FED. AID PROJECT										

19:23:01 05/22/2011