

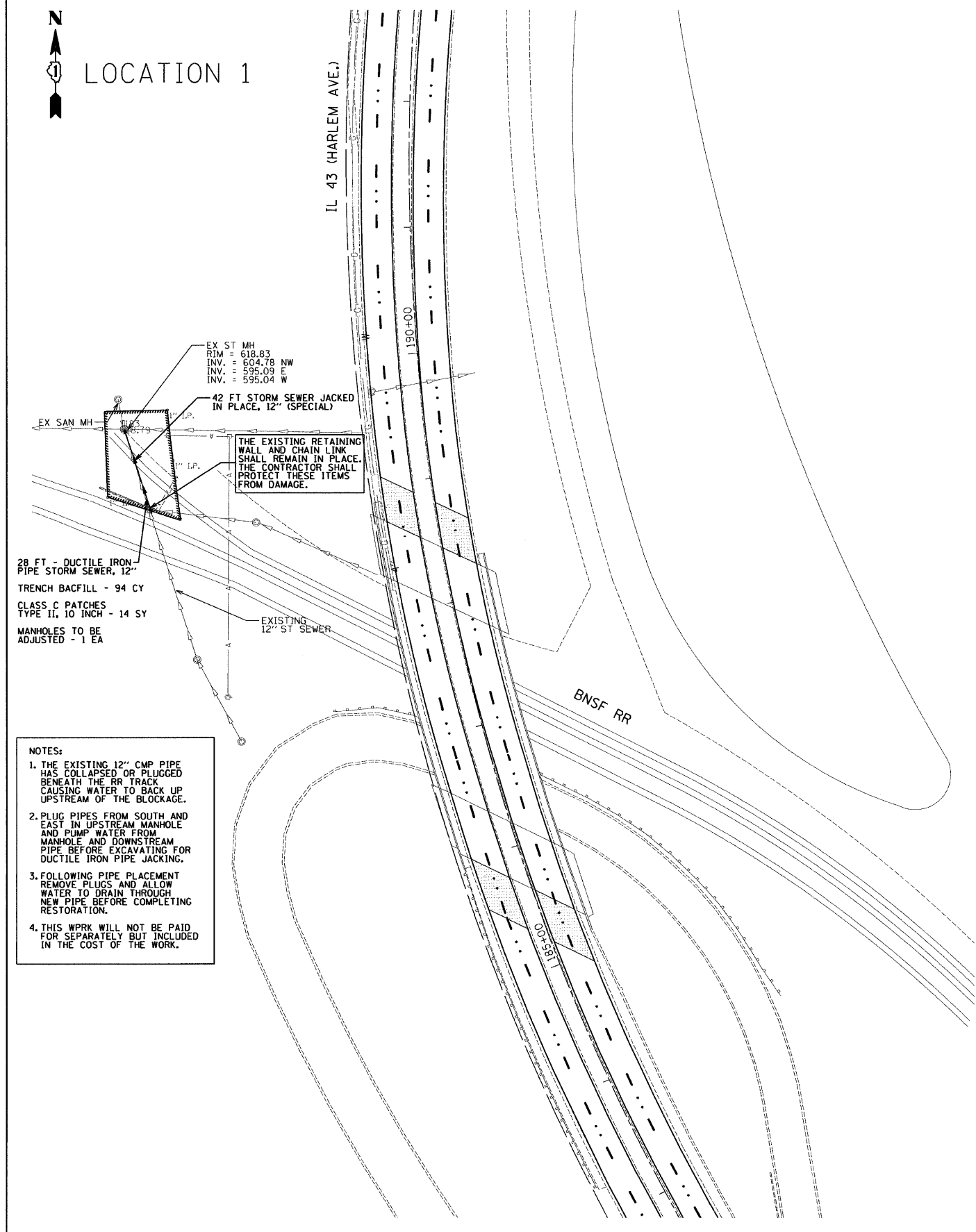

LOCATION 1



- NOTES:**
1. THE EXISTING 12" CMP PIPE HAS COLLAPSED OR PLUGGED BENEATH THE RR TRACK CAUSING WATER TO BACK UP UPSTREAM OF THE BLOCKAGE.
 2. PLUG PIPES FROM SOUTH AND EAST IN UPSTREAM MANHOLE AND PUMP WATER FROM MANHOLE AND DOWNSTREAM PIPE BEFORE EXCAVATING FOR DUCTILE IRON PIPE JACKING.
 3. FOLLOWING PIPE PLACEMENT REMOVE PLUGS AND ALLOW WATER TO DRAIN THROUGH NEW PIPE BEFORE COMPLETING RESTORATION.
 4. THIS WPRK WILL NOT BE PAID FOR SEPARATELY BUT INCLUDED IN THE COST OF THE WORK.



LOCATION 2

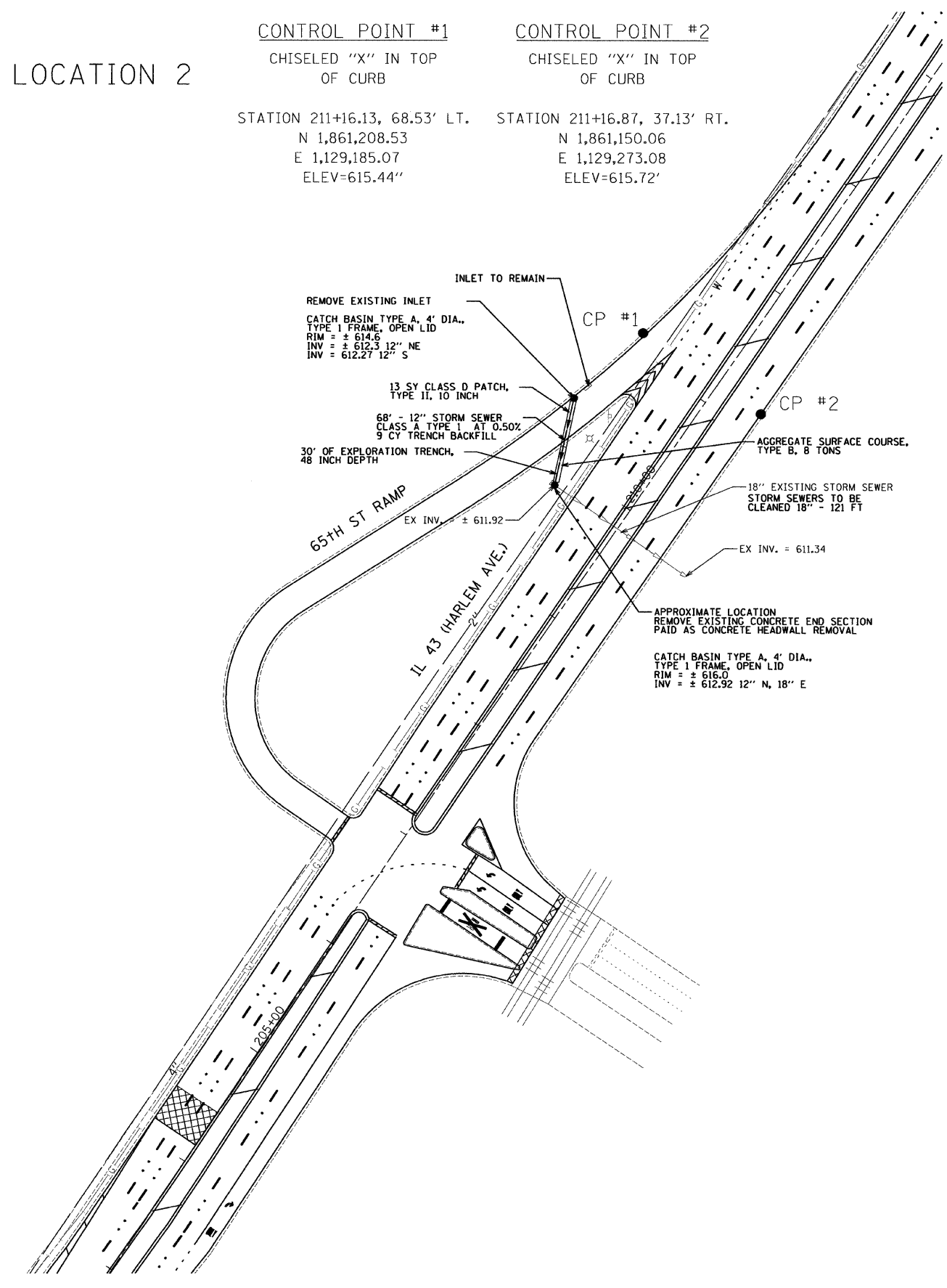

CONTROL POINT #1
 CHISELED "X" IN TOP OF CURB
 STATION 211+16.13, 68.53' LT.
 N 1,861,208.53
 E 1,129,185.07
 ELEV=615.44"

CONTROL POINT #2
 CHISELED "X" IN TOP OF CURB
 STATION 211+16.87, 37.13' RT.
 N 1,861,150.06
 E 1,129,273.08
 ELEV=615.72"

FILE NAME =	USER NAME = .USER.	DESIGNED - TP	REVISED -
\$FILEL\$		DRAWN - EF	REVISED -
	PLOT SCALE = 50.0000' / IN.	CHECKED - RS	REVISED -
	PLOT DATE = 7/5/2011	DATE - 07-06-2011	REVISED -

**STATE OF ILLINOIS
 DEPARTMENT OF TRANSPORTATION**

**IL 43 - 65th STREET TO 79th STREET
 DRAINAGE IMPROVEMENTS**

SCALE: 50 SHEET NO. 1 OF 1 SHEETS STA. TO STA.

F.A.P. RTE.	SECTION	COUNTY	TOTAL SHEETS	SHEET NO.
348	2010-084-RS	COOK	27	11
CONTRACT NO. 60L78				
ILLINOIS FED. AID PROJECT				