

NOTE: REFER TO DISTRICT 1 DETAILS FOR ADDITIONAL INFORMATION ON "RAISED REFLECTIVE PAVEMENT MARKERS (SNOW PLOW RESISTANT)" AND "TYPICAL PAVEMENT MARKINGS."

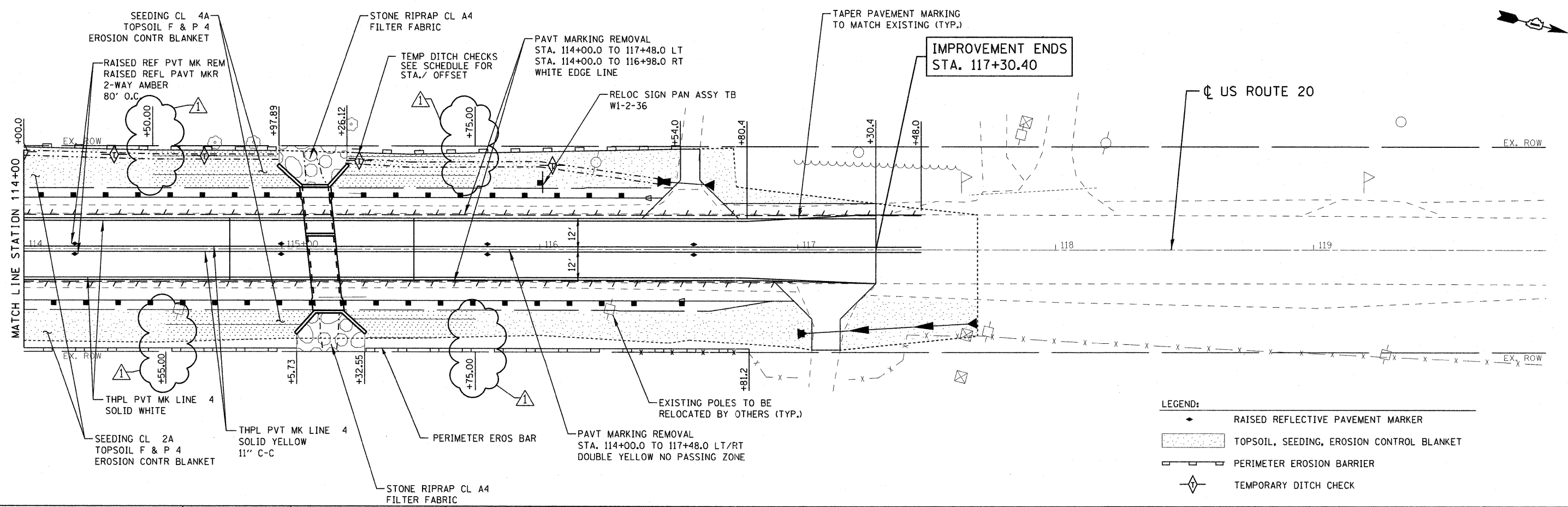

- LEGEND:
- RAISED REFLECTIVE PAVEMENT MARKER
 - TOPSOIL, SEEDING, EROSION CONTROL BLANKET
 - PERIMETER EROSION BARRIER
 - TEMPORARY DITCH CHECK

FILE NAME = G:\p\proj\2102155_003\CADD\Gv11\ShA\160M53-09\h1+PK.dgn



USER NAME = 2bookd	DESIGNED - DJB	REVISED - 09-06-11 REV.
PLOT SCALE = 20.00' / IN.	DRAWN - ENTRAN	REVISED -
PLOT DATE = 9/6/2011	CHECKED - TMH	REVISED -
	DATE - 06/24/11	REVISED -

STATE OF ILLINOIS
DEPARTMENT OF TRANSPORTATION

FAP ROUTE 525 (US ROUTE 20) OVER DRAINAGE DITCH
PAVEMENT MARKING, LANDSCAPING, & EROSION CONTROL PLAN
SCALE: 1" = 20' SHEET NO. OF SHEETS STA. TO STA.

F.A.P. RTE. 525	SECTION 11-T-1	COUNTY McHENRY	TOTAL SHEETS 34	SHEET NO. 12
CONTRACT NO. 60M53			ILLINOIS FED. AID PROJECT	