

INDEX OF SHEETS

1	COVER SHEET
2	INDEX OF SHEETS, GENERAL NOTES, COMMITMENTS, AND STANDARDS
3	SUMMARY OF QUANTITIES
4	TYPICAL SECTIONS
5 - 6	SCHEDULES OF QUANTITIES
7	ALIGNMENT, TIES, AND BENCHMARKS
8	EXISTING AND PROPOSED PLAN AND PROFILE
9	MAINTENANCE OF TRAFFIC - GENERAL NOTES AND TYPICAL SECTIONS
10	MAINTENANCE OF TRAFFIC - STAGE 1 AND 2
11	EXISTING AND PROPOSED DRAINAGE AND UTILITY PLAN
12	PAVEMENT MARKING, LANDSCAPING, & EROSION CONTROL PLAN
13 - 14	TEMPORARY CABLE PLAN AND PHASE DESIGNATION DIAGRAM
15	CULVERT GENERAL PLAN AND ELEVATION
16-17	CULVERT DETAILS
18	TEMPORARY CONCRETE BARRIER FOR STAGE CONSTRUCTION
19	SOIL BORING LOGS
20	EXISTING CULVERT PLANS
21	BD-01 DRIVEWAY DETAILS - DISTANCE BETWEEN ROW AN CURB OR EDGE GREATER THAN OF EQUAL TO 15'
22	BD-32 BUTT JOINTS AND HMA TAPER
23-25	BE-805 TEMPORARY LIGHTING AND TRAFFIC SIGNALS FOR SINGLE LANE STAGING
26	TC-10 TRAFFIC CONTROL AND PROTECTION FOR SIDE ROADS, INTERSECTIONS, AND DRIVEWAYS
27	TC-11 RAISED REFLECTIVE PAVEMENT MARKERS (SNOW PLOW RESISTANT)
28	TC-13 DISTRICT ONE TYPICAL PAVEMENT MARKINGS
29	TC-22 ARTERIAL ROAD INFORMATION SIGN
30-34	US ROUTE 20 CROSS SECTIONS

COMMITMENTS

NONE

GENERAL NOTES - MISCELLANEOUS

BEFORE STARTING ANY EXCAVATION, THE CONTRACTOR SHALL CALL "JULIE" AT (800) 892-0123 FOR FIELD LOCATIONS OF BURIED ELECTRIC, TELEPHONE AND GAS FACILITIES. (48 HOURS NOTIFICATION IS REQUIRED).

TEN FOOT (10-FT) TRANSITIONS SHALL BE USED TO MATCH PROPOSED ITEMS OF WORK TO EXISTING ITEMS IN THE FIELD, UNLESS OTHERWISE SHOWN. THE TRANSITIONS SHALL BE PAID FOR AT THE CONTRACT UNIT PRICE FOR THE PROPOSED ITEM OF WORK SPECIFIED.

THE CONTRACTOR SHALL COORDINATE CONSTRUCTION ACTIVITIES WITH THE RESPECTIVE UTILITIES, THE CITY OF MARENGO, AND MCHENRY COUNTY.

THE CONTRACTOR WILL NOT BE ALLOWED TO SET UP A YARD OR FIELD OFFICE ON STATE PROPERTY WITHOUT WRITTEN PERMISSION FROM THE DEPARTMENT.

ALL DAMAGE TO EXISTING PAVEMENT MARKINGS OR RAISED REFLECTIVE PAVEMENT MARKINGS OUTSIDE THE REMOVAL LIMITS SHOWN ON THE PLANS SHALL BE REPLACED AT NO ADDITIONAL COST TO THE DEPARTMENT.

BEFORE BEGINNING ANY WORK, THE CONTRACTOR SHALL RETAIN AND RECORD FOR FUTURE REFERENCE, ALL EXISTING PAVEMENT MARKING LINES AND RAISED REFLECTIVE PAVEMENT MARKERS IN ORDER THAT THESE LOCATIONS CAN BE RE-ESTABLISHED FOR STRIPING. EXACT LOCATIONS OF ALL PAVEMENT MARKINGS SHALL BE AS DIRECTED BY THE ENGINEER.

IT SHALL BE THE CONTRACTOR'S RESPONSIBILITY TO VERIFY ALL DIMENSIONS AND CONDITIONS EXISTING IN THE FIELD PRIOR TO CONSTRUCTION AND ORDERING MATERIALS.

THE RESIDENT ENGINEER SHALL CONTACT THE TRAFFIC CONTROL SUPERVISOR AT (847) 705-4470 A MINIMUM OF 72 HOURS PRIOR TO THE PLACEMENT ON ANY TEMPORARY TRAFFIC CONTROL DEVICES.

THE RESIDENT ENGINEER SHALL CONTACT MS. DEBBIE HANLON, AREA TRAFFIC FIELD ENGINEER AT (847) 438-2300 A MINIMUM OF TWO WEEKS PRIOR TO PLACEMENT OF PERMANENT PAVEMENT MARKINGS.

DO NOT SCALE PLANS FOR CONSTRUCTION DIMENSIONS.

WET REFLECTIVE TEMPORARY TAPE, TYPE 3 SHALL BE USED FOR TEMPORARY PAVEMENT MARKINGS ON ALL FINAL SURFACES. THE COST OF THE TEMPORARY PAVEMENT MARKING TAPE REMOVAL SHALL BE INCLUDED IN THE COST OF WORK ZONE PAVEMENT MARKING REMOVAL.

SAW CUTS WILL NOT BE PAID FOR SEPERATELY, BUT SHALL BE INCLUDED IN THE COST OF THE ITEM BEING REMOVED.

ANY REFERENCE TO STANDARDS THROUGHOUT THE PLANS OR SPECIAL PROVISIONS SHALL BE INTERPRETED AS THE LATEST STANDARD OF THE DEPARTMENT AS SHOWN.

WHERE SECTION OR SUBSECTION MONUMENTS ARE ENCOUNTERED, THE ENGINEER SHALL BE NOTIFIED BEFORE SUCH MONUMENTS ARE REMOVED. THE CONTRACTOR SHALL PROTECT AND CAREFULLY PRESERVE ALL PROPERTY MARKS AND MONUMENTS. THE ENGINEER, OR AN AUTHORIZED SURVEYOR OR AGENT WILL WITNESS OR OTHERWISE REFERENCE AND RESET MONUMENTS AS NECESSARY. ALL PROPERTY CORNERS EXCEPT THOSE WITHIN AREAS WHERE THE SCHEDULE SHOWS PLACEMENT OF R.O.W. MARKERS SHALL REMAIN UNDISTURBED.

THE CONTRACTOR AS REQUIRED, SHALL OBTAIN ALL NECESSARY PERMITS PRIOR TO COMMENCING WITH CONSTRUCTION.

THE CONTRACTOR WILL BE REQUIRED TO COMPLY WITH STATE OR LOCAL REGULATIONS REGARDING AIR, WATER, AND NOISE POLLUTION.

THE CONTRACTOR'S OPERATIONS AND TEMPORARY STORAGE ACTIVITIES SHALL BE LIMITED TO THE WORK AREA AND/OR CONSTRUCTION LIMITS. ANY ADDITIONAL STAGING AREAS ADJACENT TO THE PROJECT ARE SUBJECT TO PRIOR APPROVAL BY THE ENGINEER. NO ADDITIONAL COMPENSATION WILL BE ALLOWED TO THE CONTRACTOR FOR COMPLIANCE WITH THE ABOVE REQUIREMENTS.

THE CONTRACTOR'S PERSONNEL SHALL NOT BE ALLOWED TO PARK PERSONAL VEHICLES IN THE WORK AREA AND/OR CONSTRUCTION LIMITS.

THE REMOVAL OF EXISTING ENTRANCE CULVERTS SHALL BE INCLUDED IN THE COST OF EARTH EXCAVATION.

ACCESS SHALL BE PROVIDED AT ALL TIMES TO PROPERTIES ABUTTING THE PROPOSED IMPROVEMENT.

ALL CONSTRUCTION PERSONNEL WILL BE REQUIRED TO WEAR FLUORESCENT ORANGE, FLUORESCENT YELLOW/GREEN OR A COMBINATION OF FLUORESCENT ORANGE AND FLUORESCENT YELLOW/GREEN VESTS AND HARD HATS AT ALL TIMES WHILE ON THE CONSTRUCTION SITE. COMPLIANCE WITH THIS REQUIREMENT SHALL BE CONSIDERED INCIDENTAL TO THE CONTRACT.

GENERAL NOTES - ROADWAY

THE CONTRACTOR SHALL USE CARE IN GRADING OR EXCAVATING NEAR ANY AND ALL EXISTING ITEMS WHICH WILL NOT BE REMOVED. ANY DAMAGE DONE TO EXISTING ITEMS BY THE CONTRACTOR SHALL BE REPAIRED BY HIM AT HIS OWN EXPENSE.

ANY MAIL BOXES REQUIRING RELOCATION TO CONSTRUCT PORTIONS OF THE CONTRACT SHALL BE MOVED BY THE CONTRACTOR. THIS WORK SHALL BE DONE TO THE SATISFACTION OF THE OWNER AND THE ENGINEER. THIS WORK SHALL NOT BE PAID FOR SEPARATELY, BUT SHALL BE CONSIDERED INCIDENTAL TO THE CONTRACT.

BUTT JOINTS WILL BE INSTALLED AT THE ENDS OF ALL RESURFACING (WHERE RESURFACING MEETS EXISTING PAVEMENT). IN ACCORDANCE WITH THE BUTT JOINT AND BITUMINOUS TAPER DETAILS SHEET INCLUDED IN THE PLANS, UNLESS OTHERWISE SPECIFIED.

THE INSTALLATION OF GUARDRAIL OVER THE PROPOSED CULVERT SHALL BE MOUNTED IN ACCORDANCE WITH STANDARD 630101. THE COST OF THE INSTALLATION SHALL BE CONSIDERED INCIDENTAL TO THE UNIT PRICE OF STEEL PLATE BEAM GUARDRAIL, TYPE A.

THE REMOVAL OF SINGLE RAIL, DOUBLE RAIL, RUB RAIL, AND TERMINAL SECTIONS (TAPERS AND END SECTIONS) SHALL BE PAID FOR AT THE CONTRACT UNIT PRICE COST PER LINEAL FOOT FOR STEEL PLATE BEAM GUARD RAIL REMOVAL.

THE ENGINEER SHALL BE THE SOLE JUDGE CONCERNING CURING TIME FOR THE VARIOUS BITUMINOUS LIFTS.

GENERAL NOTES - DRAINAGE

THE COST OF MAKING ANY CONNECTIONS TO EXISTING DRAINAGE STRUCTURES SHALL BE INCLUDED IN THE UNIT PRICE FOR THE PROPOSED ITEM OF WORK SPECIFIED.

LENGTHS AND SIZES OF STORM SEWERS AS SHOWN ON THE PLANS AND DRAINAGE STRUCTURE ELEVATIONS SHALL BE VERIFIED BY THE CONTRACTOR IN THE FIELD PRIOR TO ORDERING AND INSTALLATION OF DRAINAGE ITEMS. THE INVERTS OF THE PROPOSED DRAINAGE STRUCTURES MAY REQUIRE REVISIONS TO MEET EXISTING FIELD CONDITIONS. ANY ADJUSTMENTS SHALL BE AS DIRECTED BY THE ENGINEER.

THE CONTRACTOR SHALL MAINTAIN THE SURFACE DRAINAGE OF THE ROAD DURING CONSTRUCTION OF THIS PROJECT. THIS WORK SHALL NOT BE PAID FOR SEPARATELY, BUT SHALL BE CONSIDERED INCIDENTAL TO THE CONTRACT.

STORM SEWER SHALL BE BACKFILLED IN ACCORDANCE WITH ARTICLE 550.07 METHOD 1 ONLY.

ANY LOOSE MATERIAL DEPOSITED IN THE FLOW LINE OF DITCHES, GUTTERS, CROSSROAD PIPES, OR DRAINAGE STRUCTURES DUE TO CONSTRUCTION OPERATIONS SHALL BE REMOVED AT THE CLOSE OF EACH WORKING DAY. AT THE CONCLUSION OF CONSTRUCTION OPERATIONS, ALL STRUCTURES SHALL BE FREE OF DIRT AND DEBRIS. THIS WORK SHALL NOT BE PAID FOR SEPARATELY, BUT SHALL BE CONSIDERED INCIDENTAL TO THE CONTRACT.

GENERAL NOTES - UTILITIES

THE CONTRACTOR SHALL PROTECT EXISTING AND NEW UTILITIES, WHEN REQUIRED BY THE ENGINEER. THE CONTRACTOR SHALL BRACE AND SUPPORT THE UTILITIES PROPERLY IN ORDER TO PREVENT SETTLEMENT, DISPLACEMENT, OR DAMAGE TO THE UTILITIES. THE PROTECTION OF THE UTILITIES AS SPECIFIED HEREIN WILL NOT BE PAID FOR SEPARATELY, BUT THE COST THEREOF SHALL BE CONSIDERED AS INCIDENTAL TO THE CONTRACT.

THE CONTRACTOR SHALL BE RESPONSIBLE FOR CONTACTING THE OWNERS OF ALL EXISTING FACILITIES SO THE UTILITIES AND THEIR APPURTENANCES MAY BE LOCATED AND ADJUSTED OR MOVED, IF NECESSARY, PRIOR TO THE START OF CONSTRUCTION OPERATIONS. THE CONTRACTOR SHALL COOPERATE WITH ALL UTILITY OWNERS AS PROVIDED FOR IN THE STANDARD SPECIFICATIONS.

GENERAL NOTES - LANDSCAPING

FERTILIZER NUTRIENTS SHALL BE APPLIED AT THE FOLLOWING RATES PER ACRE:

- NITROGEN FERTILIZER NUTRIENT - 90 LBS./ACRE
- PHOSPHORUS FERTILIZER NUTRIENT - 90 LBS./ACRE
- POTASSIUM FERTILIZER NUTRIENT - 90 LBS./ACRE

GENERAL NOTES - EROSION AND SEDIMENT CONTROL

TEMPORARY EROSION CONTROL SEEDING SHALL BE PROVIDED AT ALL ERODIBLE BARE EARTH AREAS. REFER TO SPECIAL PROVISIONS.

ALL EROSION CONTROL MEASURES SHALL BE IN ACCORDANCE WITH THE REQUIREMENTS OF THE STANDARD SPECIFICATIONS AND OF THE APPLICABLE STATE STANDARDS FOR THE ENTIRE DURATION OF THE CONTRACT, OR UNTIL SUCH A TIME AS DIRECTED BY THE ENGINEER.

AT ANY AREA WHERE THERE IS NO PROPOSED GRADING, THE EXISTING GROUND COVER SHALL REMAIN.

HIGHWAY STANDARDS

280001-05 TEMPORARY EROSION CONTROL SYSTEMS

406201-01 MAILBOX TURNOUT

482001-02 HMA SHOULDER ADJACENT TO FLEXIBLE PAVEMENT

482011-03 HMA SHLD. STRIPS / SHLDS. WITH RESURFACING OR WIDENING AND RESURFACING PROJECTS

542301-03 PRECAST REINFORCED CONCRETE FLARED END SECTION

630001-09 STEEL PLATE BEAM GUARDRAIL

630101-09 GUARDRAIL MOUNTED ON EXISTING CULVERTS

630301-05 SHOULDER WIDENING FOR TYPE 1(SPECIAL) GUARDRAIL TERMINALS

701006-03 OFF-ROAD OPERATIONS, 2L, 2W, 4.5 m (15') TO 600 mm (24") FROM PAVEMENT EDGE

701201-04 LANE CLOSURE, 2L, 2W, DAY ONLY, FOR SPEEDS ≥ 45 MPH

701306-03 LANE CLOSURE, 2L, 2W, SLOW MOVING OPERATIONS DAY ONLY, FOR SPEEDS ≥ 45 MPH

701311-03 LANE CLOSURE, 2L, 2W, MOVING OPERATIONS - DAY ONLY

701321-11 LANE CLOSURE, 2L, 2W, BRIDGE REPAIR WITH BARRIER

701326-04 LANE CLOSURE, 2L, 2W, PAVEMENT WIDENING, FOR SPEEDS ≥ 45 MPH

701901-01 TRAFFIC CONTROL DEVICES

704001-06 TEMPORARY CONCRETE BARRIER

862001-01 UNINTERRUPTABLE POWER SUPPLY (UPS)

880001-01 SPAN WIRE MOUNTED SIGNALS AND FLASHING BEACON INSTALL

STATE OF ILLINOIS
DEPARTMENT OF TRANSPORTATION

Rev. 9-8-11

FAP ROUTE 525 (US ROUTE 20) OVER DRAINAGE DITCH
INDEX OF SHEETS, GENERAL NOTES, COMMITMENTS, AND STANDARDS

SCALE: 1" = 50' SHEET NO. OF SHEETS STA. TO STA.

F.A.P. RTE.	SECTION	COUNTY	TOTAL SHEETS	SHEET NO.
525	11-T-1	MCHENRY	34	2
FED. ROAD DIST. NO.			ILLINOIS FED. AID PROJECT	
			CONTRACT NO. 60M53	

FILE NAME: g:\p\proj\110225\110225_001\110225_001.dwg



USER NAME = zkujowc	DESIGNED - DJB	REVISED -
	DRAWN - ENTRAN	REVISED -
PLOT SCALE = 50.0000' / IN.	CHECKED - TMH	REVISED -
PLOT DATE = 06/20/2011	DATE - 06/24/11	REVISED -

SUMMARY OF QUANTITIES

801.FED./201.STATE

CODE NO.	ITEM	UNIT	TOTAL QUANTITY	CONSTRUCTION TYPE CODE	
				ROADWAY 0004	BRIDGE 0040
20100110	TREE REMOVAL (6 TO 15 UNITS DIAMETER)	UNIT	272	272	0
20100210	TREE REMOVAL (OVER 15 UNITS DIAMETER)	UNIT	20	20	0
20200100	EARTH EXCAVATION	CU YD	438	438	0
20201200	REMOVAL AND DISPOSAL OF UNSUITABLE MATERIAL	CU YD	379	303	76
20300100	CHANNEL EXCAVATION	CU YD	6	6	0
20400800	FURNISHED EXCAVATION	CU YD	708	708	0
20700220	POROUS GRANULAR EMBANKMENT	CU YD	76	0	76
21001000	GEOTECHNICAL FABRIC FOR GROUND STABILIZATION	SO YD	317	317	0
21101615	TOPSOIL FURNISH AND PLACE, 4"	SO YD	1,682	1,682	0
25000210	SEEDING, CLASS 2A	ACRE	0.29	0.29	0.00
25000312	SEEDING, CLASS 4A	ACRE	0.06	0.06	0.00
25000400	NITROGEN FERTILIZER NUTRIENT	POUND	31	31	0
25000500	PHOSPHORUS FERTILIZER NUTRIENT	POUND	31	31	0
25000600	POTASSIUM FERTILIZER NUTRIENT	POUND	31	31	0
25100630	EROSION CONTROL BLANKET	SO YD	1,682	1,682	0
28000250	TEMPORARY EROSION CONTROL SEEDING	POUND	26	26	0
28000305	TEMPORARY DITCH CHECKS	FOOT	140	140	0
28000400	PERIMETER EROSION BARRIER	FOOT	1,051	1,051	0
28100107	STONE RIPRAP, CLASS A4	SO YD	74	0	74
28200200	FILTER FABRIC	SO YD	74	74	0
31101000	SUBBASE GRANULAR MATERIAL, TYPE B	TON	270	270	0
35501308	HOT-MIX ASPHALT BASE COURSE, 6"	SO YD	162	162	0
35501329	HOT-MIX ASPHALT BASE COURSE, 11 1/4"	SO YD	190	190	0
40600100	BITUMINOUS MATERIALS (PRIME COAT)	GALLON	261	261	0
40600300	AGGREGATE (PRIME COAT)	TON	6.5	6.5	0.0
40600982	HOT-MIX ASPHALT SURFACE REMOVAL - BUTT JOINT	SO YD	24	24	0
40603310	HOT-MIX ASPHALT SURFACE COURSE, MIX "C", N50	TON	18	18	0
40603340	HOT-MIX ASPHALT SURFACE COURSE, MIX "D", N70	TON	182	182	0
44000100	PAVEMENT REMOVAL	SO YD	830	830	0
44000155	HOT-MIX ASPHALT SURFACE REMOVAL, 1 1/2"	SO YD	1,438	1,438	0
44000200	DRIVEWAY PAVEMENT REMOVAL	SO YD	152	152	0
48101498	AGGREGATE SHOULDERS, TYPE B 4"	SO YD	349	349	0
48203029	HOT-MIX ASPHALT SHOULDERS, 8"	SO YD	985	985	0
50100100	REMOVAL OF EXISTING STRUCTURES	EACH	1	0	1
50104400	CONCRETE HEADWALL REMOVAL	EACH	1	1	0
50800105	REINFORCEMENT BARS	POUND	14,420	0	14,420

801.FED./201.STATE

CODE NO.	ITEM	UNIT	TOTAL QUANTITY	CONSTRUCTION TYPE CODE	
				ROADWAY 0004	BRIDGE 0040
51500100	NAME PLATES	EACH	1	0	1
54003000	CONCRETE BOX CULVERTS	CU YD	72.9	0.0	72.9
54213660	PRECAST REINFORCED CONCRETE FLARED END SECTIONS 15"	EACH	8	8	0
5422024	PIPE CULVERTS, CLASS D, TYPE 2 24" (TEMPORARY)	FOOT	20	20	0
542A0220	PIPE CULVERTS, CLASS A, TYPE 1 15"	FOOT	250	250	0
* 63000003	STEEL PLATE BEAM GUARD RAIL, TYPE A, 9 FOOT POSTS	FOOT	550	550	0
* 63100167	TRAFFIC BARRIER TERMINAL, TYPE 1 (SPECIAL) TANGENT	EACH	4	4	0
63200310	GUARDRAIL REMOVAL	FOOT	876	876	0
67000400	ENGINEER'S FIELD OFFICE, TYPE A	CAL MO	3	3	0
67100100	MOBILIZATION	L SUM	1.0	1.0	0.0
70106500	TEMPORARY BRIDGE TRAFFIC SIGNALS	EACH	1	1	0
70301000	WORK ZONE PAVEMENT MARKING REMOVAL	SO FT	729	729	0
70400100	TEMPORARY CONCRETE BARRIER	FOOT	248	248	0
* 70400200	RELOCATE TEMPORARY CONCRETE BARRIER	FOOT	240	240	0
* 72400600	RELOCATE SIGN PANEL ASSEMBLY - TYPE B	EACH	1	1	0
* 78000200	THERMOPLASTIC PAVEMENT MARKING - LINE 4"	FOOT	2,496	2,496	0
* 78100100	RAISED REFLECTIVE PAVEMENT MARKER	EACH	14	14	0
* 78201000	TERMINAL MARKER - DIRECT APPLIED	EACH	4	4	0
78300100	PAVEMENT MARKING REMOVAL	SO FT	608	608	0
78300200	RAISED REFLECTIVE PAVEMENT MARKER REMOVAL	EACH	14	14	0
X0322672	SPLIT RAIL FENCE TO BE REMOVED AND RE-ERECTED	FOOT	62	62	0
* X0326276	TEMPORARY LIGHTING FOR SINGLE LANE STAGING	L SUM	1.0	1.0	0.0
X0426200	DEWATERING	L SUM	1.0	1.0	0.0
X4400198	CONCRETE BARRIER REMOVAL (SPECIAL)	FOOT	75	75	0
X7010216	TRAFFIC CONTROL AND PROTECTION, (SPECIAL)	L SUM	1.0	1.0	0.0
X7030030	WET REFLECTIVE TEMPORARY TAPE TYPE III, 4 INCH	FOOT	2,024	2,024	0
X7030055	WET REFLECTIVE TEMPORARY TAPE TYPE III, 24 INCH	FOOT	27	27	0
Z0001050	AGGREGATE SUBGRADE 12"	SO YD	317	317	0
Z0013798	CONSTRUCTION LAYOUT	L SUM	1.0	1.0	0.0
Z0026407	TEMPORARY SHEET PILING	SO FT	1,275	0	1,275
Z0030280	IMPACT ATTENUATORS, TEMPORARY (SEVERE USE, NARROW), TEST LEVEL 3	EACH	2	2	0
Z0030370	IMPACT ATTENUATORS, RELOCATE (SEVERE USE, NARROW), TEST LEVEL 3	EACH	2	2	0
Z0030850	TEMPORARY INFORMATION SIGNING	SO FT	51	51	0
Z0062456	TEMPORARY PAVEMENT	SO YD	76	76	0

* SPECIALTY ITEMS

FILE NAME = G:\pro\beta\2102155_000\CAD\DWG\11\SHA-0160M53-03.dwg



USER NAME = zbookd	DESIGNED - DJB	REVISED -
PLOT SCALE = 50.00' / IN.	DRAWN - ENTRAN	REVISED -
PLOT DATE = 7/7/2011	CHECKED - TMH	REVISED -
	DATE - 06/24/11	REVISED -

**STATE OF ILLINOIS
DEPARTMENT OF TRANSPORTATION**

**FAP ROUTE 525 (US ROUTE 20) OVER DRAINAGE DITCH
SUMMARY OF QUANTITIES**

SCALE: 1" = 50' SHEET NO. OF SHEETS STA. TO STA.

F.A.P. RTE. 525	SECTION 11-T-1	COUNTY McHENRY	TOTAL SHEETS 34	SHEET NO. 3
FED. ROAD DIST. NO. ILLINOIS FED. AID PROJECT			CONTRACT NO. 60M53	

Rev. 9-8-11

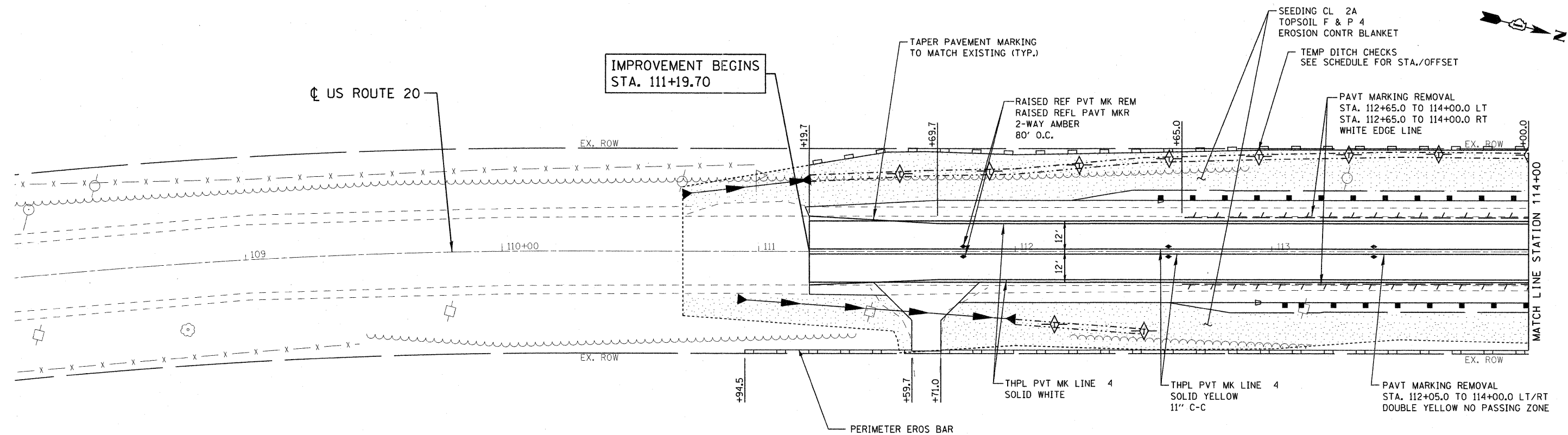

NOTE: REFER TO DISTRICT 1 DETAILS FOR ADDITIONAL INFORMATION ON "RAISED REFLECTIVE PAVEMENT MARKERS (SNOW PLOW RESISTANT)" AND "TYPICAL PAVEMENT MARKINGS."

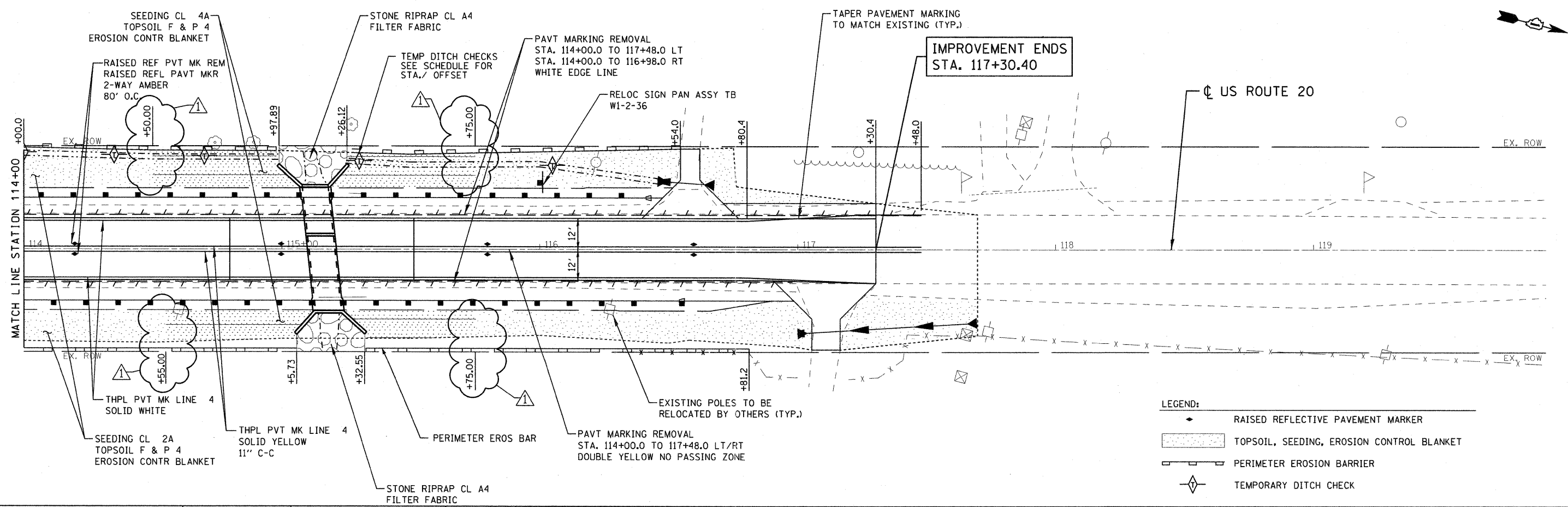

- LEGEND:
- RAISED REFLECTIVE PAVEMENT MARKER
 - TOPSOIL, SEEDING, EROSION CONTROL BLANKET
 - PERIMETER EROSION BARRIER
 - TEMPORARY DITCH CHECK

FILE NAME = G:\p\proj\2102155_003\CADD\Gv11\ShA\160M53-09\h1t+PMK.dgn



USER NAME = 2bookd	DESIGNED - DJB	REVISED - 09-06-11 REV.
PLOT SCALE = 28.00' / IN.	DRAWN - ENTRAN	REVISED -
PLOT DATE = 9/6/2011	CHECKED - TMH	REVISED -
	DATE - 06/24/11	REVISED -

**STATE OF ILLINOIS
DEPARTMENT OF TRANSPORTATION**

**FAP ROUTE 525 (US ROUTE 20) OVER DRAINAGE DITCH
PAVEMENT MARKING, LANDSCAPING, & EROSION CONTROL PLAN**

SCALE: 1" = 20' SHEET NO. OF SHEETS STA. TO STA.

F.A.P. RTE. 525	SECTION 11-T-1	COUNTY McHENRY	TOTAL SHEETS 34	SHEET NO. 12
FED. ROAD DIST. NO.		ILLINOIS FED. AID PROJECT		
CONTRACT NO. 60M53				



NOTES:

- * EXACT PLACEMENT OF TEMPORARY WOOD POSTS TO BE DETERMINED IN THE FIELD BY THE RESIDENT ENGINEER.
- * ALL VIDEO DETECTION ZONES ARE TO BE REDEFINED DURING EACH STAGE OF CONSTRUCTION AND ARE INCIDENTAL TO THE COST OF TEMPORARY BRIDGE TRAFFIC SIGNAL INSTALLATION.

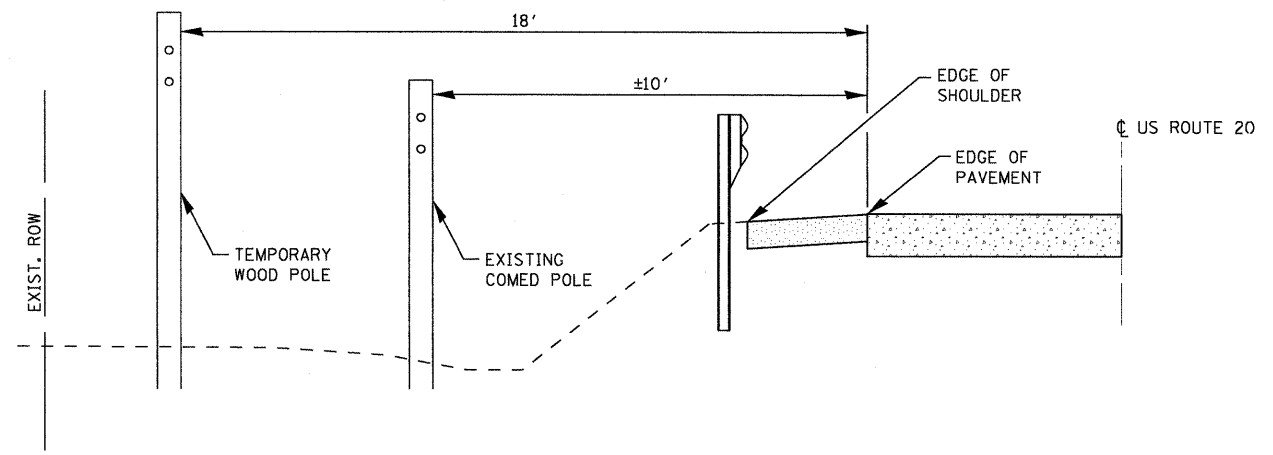
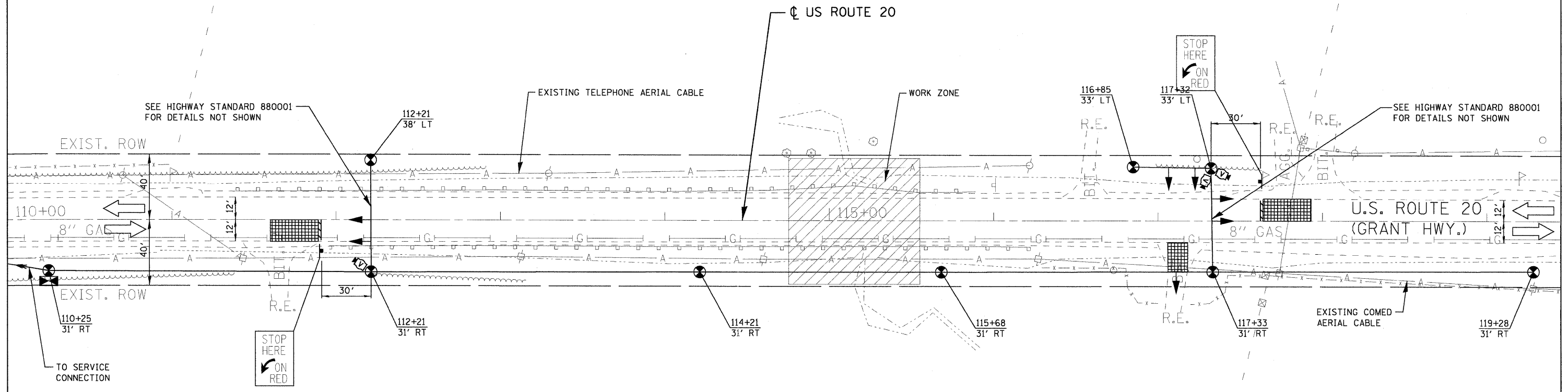

CROSS SECTION DETAIL
NOT TO SCALE
LOOKING SOUTH

THIS SHEET TO BE WORKED WITH DISTRICT 1
DETAIL "TEMPORARY LIGHTING AND TRAFFIC
SIGNALS FOR SINGLE LANE STAGING" AND THE
MAINTENANCE OF TRAFFIC PLANS.

TEMPORARY TRAFFIC SIGNAL LEGEND

- TEMPORARY WOOD POLE
NOMINAL 60 FT, CLASS 4
- TEMPORARY TRAFFIC SIGNAL
HEAD SPAN WIRE MOUNTED
- TEMPORARY SPAN WIRE
TETHER WIRE, AND CABLE
- VIDEO DETECTION CAMERA
- TEMPORARY CONTROLLER
CABINET
- VIDEO DETECTION ZONE

FILE NAME = G:\p\proj\603\003\CADD\Cvt11\Sh\A\1160M53-13\ht-Sigpln101.dgn



USER NAME = 2KUJAWC	DESIGNED - DJB	REVISED - 9-8-11 Rev.
DRAWN - ENTRAN	CHECKED - TMH	REVISED -
PLOT SCALE = 30.00' / IN.	DATE - 06/24/11	REVISED -
PLOT DATE = 08/17/2011		

**STATE OF ILLINOIS
DEPARTMENT OF TRANSPORTATION**

**FAP ROUTE 525 (US ROUTE 20) OVER DRAINAGE DITCH
TEMPORARY TRAFFIC SIGNAL PLAN**

SCALE: 1" = 30' SHEET NO. OF SHEETS STA. TO STA.

F.A.P. RTE. 525	SECTION 11-T-1	COUNTY McHENRY	TOTAL SHEETS 34	SHEET NO. 13
FED. ROAD DIST. NO. ILLINOIS FED. AID PROJECT			CONTRACT NO. 60M53	

NOTES FOR TEMPORARY TRAFFIC SIGNALS

1. ALL CONTROL EQUIPMENT INCLUDING EMERGENCY PRE-EMPTION AND COMMUNICATION DEVICES FOR THE TEMPORARY TRAFFIC SIGNAL(S) SHALL BE FURNISHED BY THE CONTRACTOR.
2. ONLY CONTROLLERS SUPPLIED BY ONE OF THE DISTRICT APPROVED CLOSED LOOP EQUIPMENT MANUFACTURERS WILL BE APPROVED FOR USE AT TEMPORARY SIGNAL LOCATIONS. ALL CONTROLLERS USED FOR TEMPORARY TRAFFIC SIGNALS SHALL BE FULLY ACTUATED NEMA MICROPROCESSOR BASED WITH RS232 DATA ENTRY PORTS COMPATIBLE WITH EXISTING MONITORING SOFTWARE APPROVED BY IDOT DISTRICT 1. INSTALLED IN A NEMA TS2 CABINET. ONLY ONE BRAND OF CONTROLLER WILL BE ACCEPTED FOR ANY ONE CONTRACT.
3. ALL TRAFFIC SIGNAL SECTIONS AND PEDESTRIAN SIGNAL SECTIONS SHALL BE LED AND 12" (300mm) DIAMETER. HEADS SHALL BE PLACED AS INDICATED ON THE TEMPORARY TRAFFIC SIGNAL PLAN OR AS DIRECTED BY THE ENGINEER. PEDESTRIAN SIGNALS SHALL INCLUDE SOLID INTERNATIONAL SYMBOLS. PEDESTRIAN SIGNALS WITH COUNTDOWN TIMERS SHALL BE USED WHEN THE EXISTING INSTALLATION UTILIZES COUNTDOWN TYPE OR AS DIRECTED BY THE ENGINEER. COUNTDOWN TYPE PEDESTRIAN SIGNALS ARE NOT TO BE INSTALLED AT A RAILROAD INTERSECTION. THE CONTRACTOR SHALL FURNISH ENOUGH CABLE SLACK TO RELOCATE HEADS TO ANY POSITION ON THE SPAN WIRE OR AT LOCATIONS ILLUSTRATED ON THE PLANS FOR CONSTRUCTION STAGING. THE TEMPORARY TRAFFIC SIGNAL SHALL REMAIN IN OPERATION DURING ALL SIGNAL HEAD RELOCATIONS. EACH TEMPORARY TRAFFIC SIGNAL HEAD SHALL HAVE ITS OWN CABLE FROM THE CONTROLLER CABINET TO THE SIGNAL HEAD.
4. ALL EXISTING STREET NAME AND INTERSECTION REGULATORY SIGNS SHALL BE REMOVED FROM EXISTING POLES, RELOCATED AND SECURELY FASTENED TO THE SPAN WIRE OR WOOD POLE AS DIRECTED BY THE ENGINEER.
5. ANY TEMPORARY SIGNAL WITHIN AN EXISTING CLOSED LOOP TRAFFIC SIGNAL SYSTEM SHALL BE INTERCONNECTED TO THAT SYSTEM USING SIMILAR BRAND CONTROL EQUIPMENT.
6. THE TEMPORARY TRAFFIC SIGNAL SHALL HAVE THE SIGNAL HEAD DISPLAYS, SIGNAL HEAD PLACEMENTS AND CONTROLLER PHASING MATCH THE EXISTING TRAFFIC SIGNAL. AT THE TIME OF THE TURN ON, IF NO TRAFFIC STAGING IS IN PLACE OR WILL NOT BE STAGED ON THE DAY OF THE TURN ON.
7. UNINTERRUPTIBLE POWER SUPPLY (UPS) SYSTEMS SHALL BE INSTALLED AND MADE OPERATIONAL AT TEMPORARY TRAFFIC SIGNAL INSTALLATIONS WHERE UPS IS INSTALLED AT THE EXISTING TRAFFIC SIGNAL, TEMPORARY TRAFFIC SIGNALS AT RAILROAD INTERSECTIONS, AND TEMPORARY TRAFFIC SIGNALS AT INTERSECTIONS WITH FIRE STATION ACTUATED EMERGENCY VEHICLE PRE-EMPTION, OR WHEN INDICATED ON THE PLANS.
8. TRAFFIC SIGNAL MANAGEMENT SYSTEMS SHALL BE MAINTAINED IN OPERATION AS INDICATED ON THE PLANS OR AS DIRECTED BY THE ENGINEER. REQUIRED EQUIPMENT SHALL BE AS SHOWN ON THE PLANS AND THE CONTRACTOR SHALL PLACE THE EQUIPMENT IN OPERATION TO THE SATISFACTION OF THE ENGINEER AND THE AGENCY RESPONSIBLE FOR THE TRAFFIC SIGNAL MANAGEMENT SYSTEM.
9. DETECTION AT TEMPORARY TRAFFIC SIGNALS SHALL BE INCLUDED FOR ALL APPROACHES OF THE INTERSECTION UNLESS INDICATED OTHERWISE ON THE PLANS. THE DETECTION SYSTEM MUST MEET THE SPECIFICATIONS OF DISTRICT 1 AND THE CONTRACTOR SHALL PLACE THE DETECTORS INTO OPERATION TO THE SATISFACTION OF THE ENGINEER.
10. WHEN PAN, TILT, ZOOM CAMERAS ARE INSTALLED AT THE EXISTING INTERSECTION OR ARE CALLED FOR IN THE PLANS, THE CONTRACTOR SHALL BE RESPONSIBLE FOR INSTALLING AND MAINTAINING THE CAMERAS TO THE SATISFACTION OF THE ENGINEER AND THE AGENCY RESPONSIBLE FOR THE CAMERAS.

GENERAL NOTES

11. 24" WHITE STOP BAR TO BE INSTALLED AFTER THE INSTALLATION AND IMPLEMENTATION OF THE TEMPORARY TRAFFIC SIGNALS.
12. CONTROLLER WITH STEEL BASE CABINET AND BATTERY BACK-UP CABINET SHALL BE MOUNTED ON A WOOD STAND.
13. UN-INTERRUPTABLE POWER SUPPLY (UPS) SHALL BE INCLUDED IN "TEMPORARY BRIDGE TRAFFIC SIGNAL INSTALLATION" PAY ITEM.
14. 9 WOOD POLES INSTALLED BY THE TRAFFIC CONTRACTOR (SEE TEMPORARY TRAFFIC SIGNAL PLANS).
15. PROPOSED WOOD POLES FOR ROADWAY LIGHTING SHALL BE USED TO SUPPORT TRAFFIC SIGNAL CABLE.
16. TRAFFIC SIGNAL AND ROADWAY LIGHTING SHALL UTILIZE A COMBINATION ELECTRIC SERVICE BOX. (SEE DETAIL)
17. ALL SIGNAL HEADS SHALL BE L.E.D.

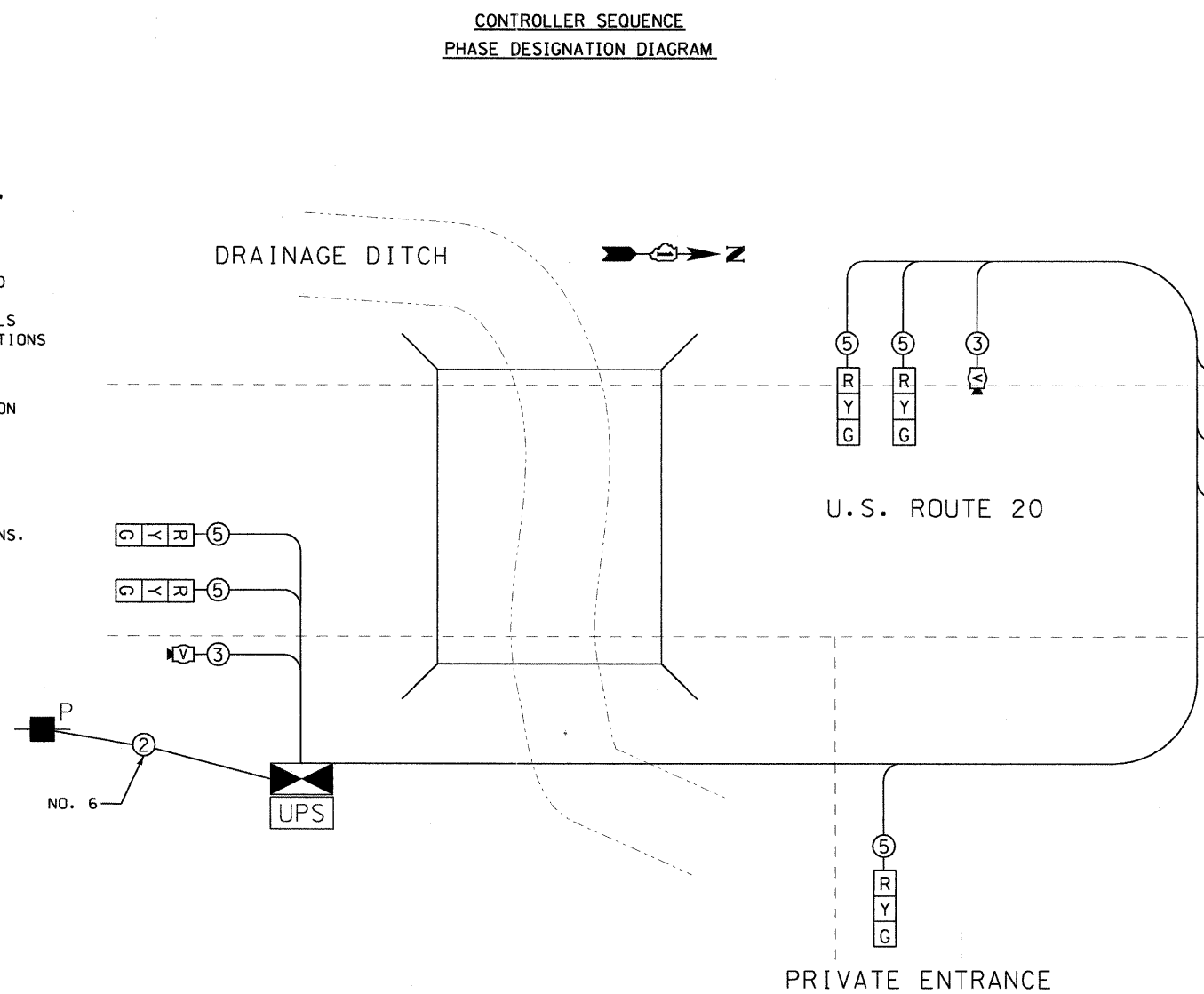
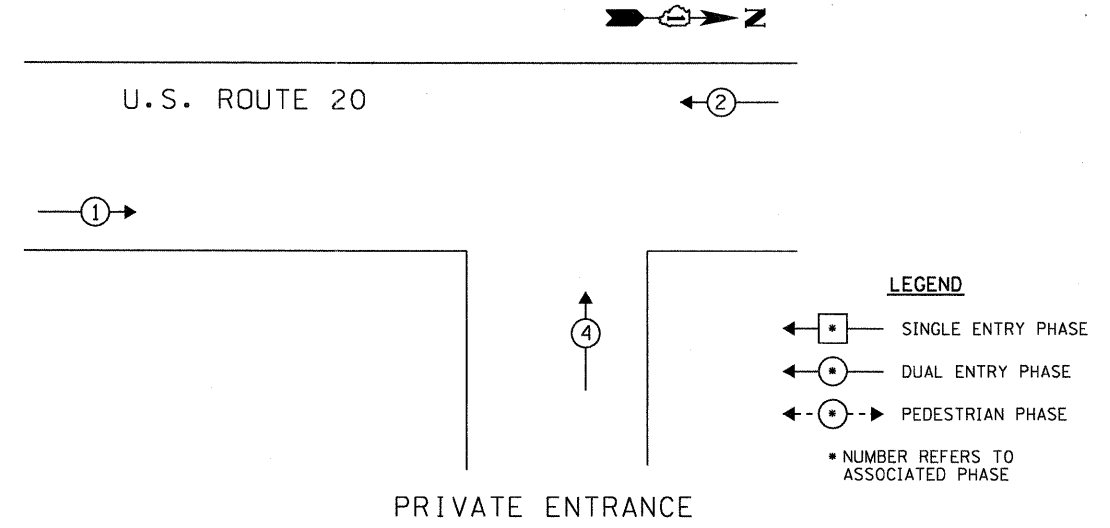

TEMPORARY CABLE DIAGRAM LEGEND

- CONTROLLER CABINET
- UNINTERRUPTIBLE POWER SUPPLY (UPS)
- SERVICE INSTALLATION, (P) POLE OR (G) GROUND MOUNT
- VIDEO DETECTION CAMERA
- INDICATES NUMBER OF CONDUCTORS IN CABLE. ALL CONDUCTORS TO BE NUMBER 14 AWG WIRE UNLESS OTHERWISE NOTED.

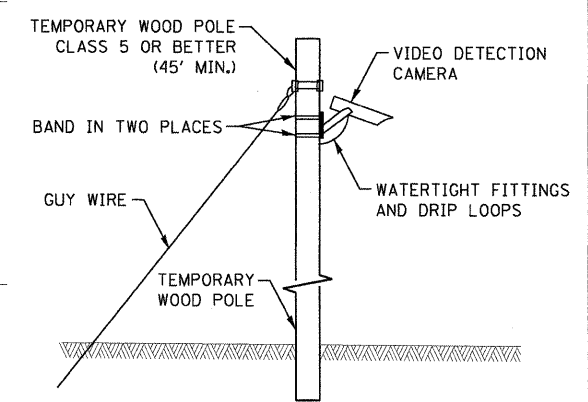

THIS SHEET TO BE WORKED WITH DISTRICT 1 DETAIL "TEMPORARY LIGHTING AND TRAFFIC SIGNALS FOR SINGLE LANE STAGING" AND THE MAINTENANCE OF TRAFFIC PLANS.

SUMMARY OF QUANTITIES			
ITEM	DESCRIPTION	UNIT	QUANTITY
X8900005	TEMPORARY BRIDGE TRAFFIC SIGNAL INSTALLATION	EACH	1

I.D.O.T. TRAFFIC SIGNAL INSTALLATION ELECTRICAL SERVICE REQUIREMENTS					TOTAL WATTAGE
TYPE	NO. LAMPS	WATTAGE (INCAND.)	LED	% OPERATION	
SIGNAL (RED)	7	135	17	0.50	59.5
(YELLOW)	7	135	25	0.25	43.8
(GREEN)	7	135	15	0.25	26.3
ARROW		135	12	0.10	
PED. SIGNAL		90	25	1.00	
CONTROLLER	1	100	100	1.00	100.0
ILLUM. SIGN		84		0.05	
FLASHER				0.50	--
TOTAL =					230.0

FOUNDATION (DEPTH)	FT. (m)	CABLE SLACK	FT. (m)	VERTICAL	FT. (m)
TYPE A - POST	4 (1.2)	HANDHOLE	6.5 (2.0)	ALL FOUNDATIONS	3.5 (1.0)
D - CONTROLLER	4 (1.2)	DOUBLE HANDHOLE	13 (4.0)	MAST ARM (L) POLE	20'-H-2'
E - M. ARM POLE		SIGNAL POST	2 (0.6)	6m-H-0.6m	
24" (600mm)	10 (3.0)	CONTROLLER CAB.	1 (0.5)	BRACKET MOUNTED	13 (4.0)
30" (750mm)	15 (4.6)	FIBER OPTIC	13 (4.0)	PED. PUSHBUTTON	4 (1.2)
		ELECTRIC SERVICE	1 (0.5)	ELECTRIC SERVICE	13.5 (4.1)
		GROUND CABLE	1 (0.5)	SERVICE TO GROUND	13.5 (4.1)
				POST MOUNTED	6 (1.8)

J.U.L.I.E.
JOINT UTILITY LOCATION INFORMATION FOR EXCAVATION
1-800-892-0123

ENTRAN
USER NAME = 2KJ1JWC
DESIGNED - DJB
DRAWN - ENTRAN
CHECKED - TMH
DATE - 06/24/11

REVISIONS
REVISED - 9-8-11 Rev.
REVISIONS
REVISIONS
REVISIONS

STATE OF ILLINOIS
DEPARTMENT OF TRANSPORTATION

FAP ROUTE 525 (US ROUTE 20) OVER DRAINAGE DITCH
TEMPORARY CABLE PLAN AND PHASE DESIGNATION DIAGRAM
SCALE: 1" = 50' SHEET NO. OF SHEETS STA. TO STA.

F.A.P. RTE.	SECTION	COUNTY	TOTAL SHEETS	SHEET NO.
525	11-T-1	McHENRY	34	14
CONTRACT NO. 60M53				

FILE NAME = G:\p\o\ea\1\202105_003\CAD\01\G\1\ShA\0160ME3-13a\41-Signa02.dgn

FINAL SURVEY	SURVEYED	BY	DATE
NOTE BOOK	PLOTTED		
AREAS	TEMPLATE		
AREAS	CHECKED		
NO.			

ORIGINAL SURVEY	SURVEYED	BY	DATE
NOTE BOOK	PLOTTED		
AREAS	TEMPLATE		
AREAS	CHECKED		
NO.			

FILE NAME = G:\pcc\jst\2102155_003\ACAD\DWG\11-T-1\SP110168\US21\2102155.dgn

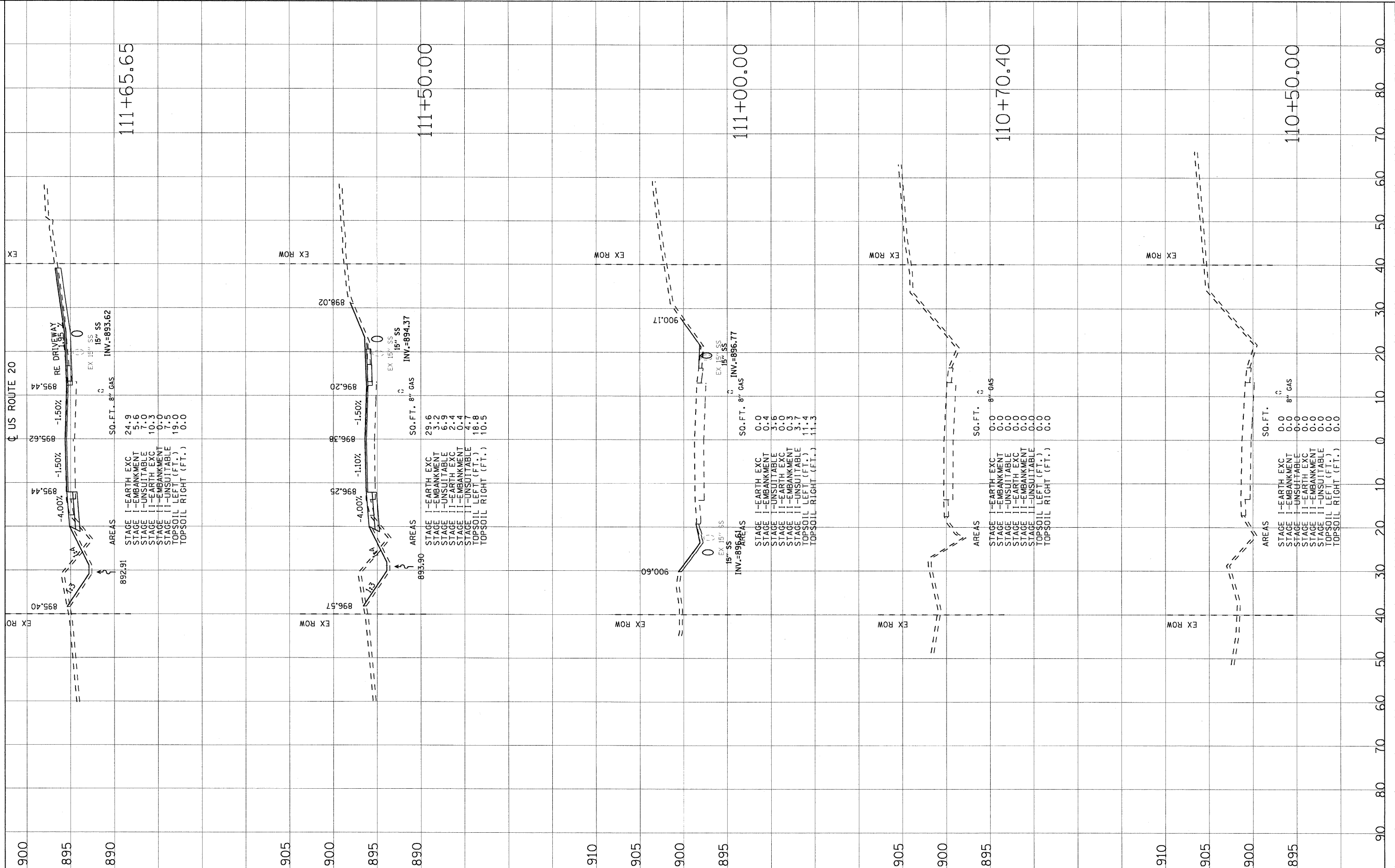

	USER NAME = 2KJAJWC	DESIGNED - DJB	REVISED - 9-8-11 Rev.	STATE OF ILLINOIS DEPARTMENT OF TRANSPORTATION	FAP ROUTE 525 (US ROUTE 20) OVER DRAINAGE DITCH US ROUTE 20 CROSS SECTIONS			F.A.P. RTE. 525	SECTION 11-T-1	COUNTY McHENRY	TOTAL SHEETS 34	SHEET NO. 30
	PLOT SCALE = 10,0000' / IN.	CHECKED - TMH	REVISED -		SCALE: 1"=5'-V/10'-H	SHEET NO. OF SHEETS STA. TO STA.	FED. ROAD DIST. NO. ILLINOIS FED. AID PROJECT	CONTRACT NO. 60M53				
	PLOT DATE = 06/17/2011	DATE - 06/24/11	REVISED -									

DATE	BY
SURVEYED	PLOTTED
NOTE BOOK	TEMPLATE
AREAS	CHECKED
NO.	

DATE	BY
SURVEYED	PLOTTED
NOTE BOOK	TEMPLATE
AREAS	CHECKED
NO.	

FILE NAME = E:\pco\met\2102105_003\CADD\G:\11\Sta\11\010\005\12ht\9999.dgn

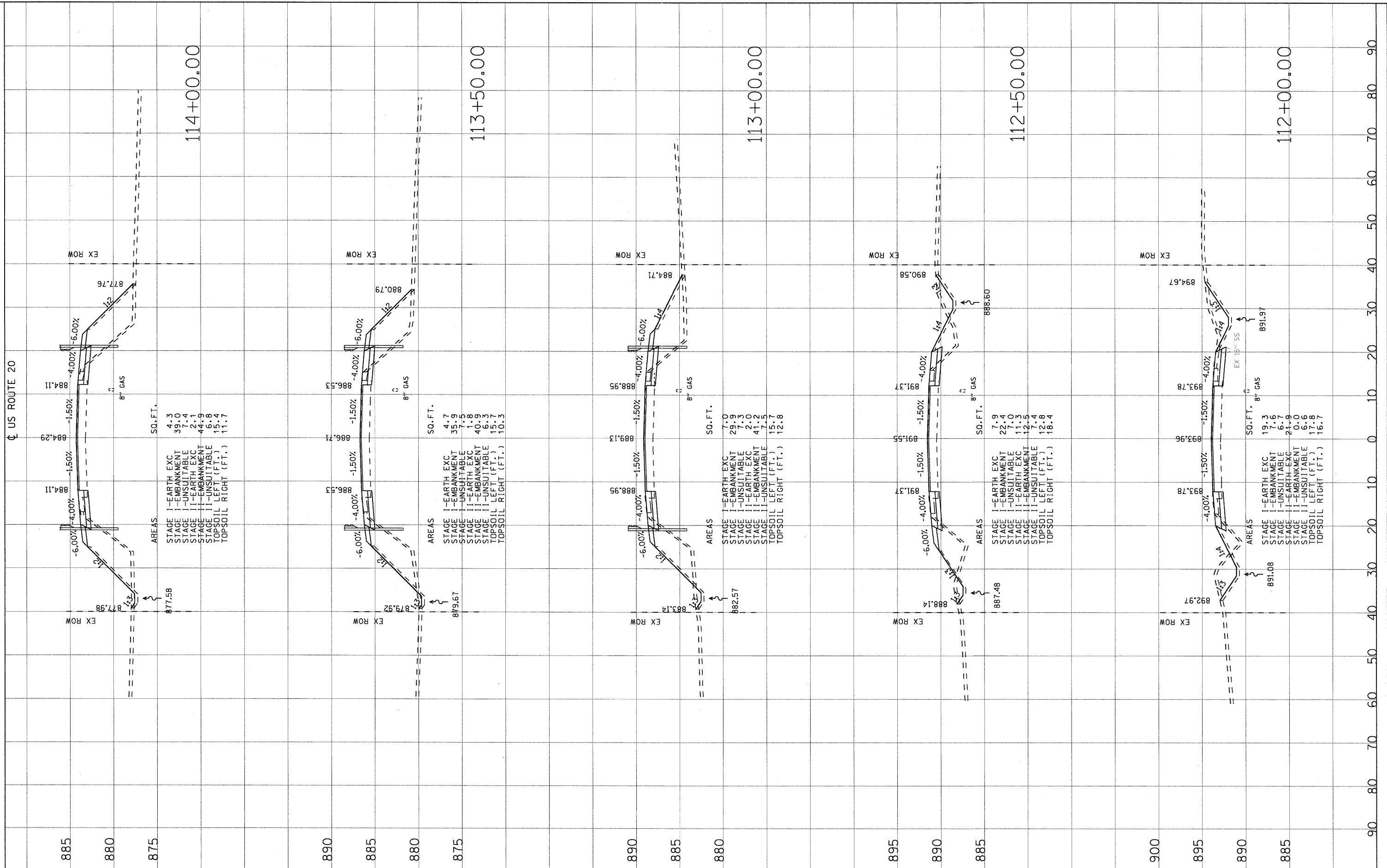

US ROUTE 20

885 880 875 890 885 880 875 890 885 880 895 890 885 900 895 890 885

90 80 70 60 50 40 30 20 10 0 10 20 30 40 50 60 70 80 90



USER NAME = 2KJJAWC
 PLLOT SCALE = 10.0000' / IN.
 PLOT DATE = 08/17/2011

DESIGNED - DJB
 DRAWN - ENTRAN
 CHECKED - TMH
 DATE - 06/24/11

REVISED - 9-8-11 Rev.
 REVISED -
 REVISED -
 REVISED -

STATE OF ILLINOIS
 DEPARTMENT OF TRANSPORTATION

FAP ROUTE 525 (US ROUTE 20) OVER DRAINAGE DITCH
 US ROUTE 20 CROSS SECTIONS

SCALE: 1"=5'V/10'H SHEET NO. OF SHEETS STA. TO STA.

F.A.P. RTE.	SECTION	COUNTY	TOTAL SHEETS	SHEET NO.
525	11-T-1	McHENRY	34	31
CONTRACT NO. 60M53				
FED. ROAD DIST. NO. ILLINOIS FED. AID PROJECT				

FINAL SURVEY	SURVEYED	BY	DATE
NOTE BOOK	PLOTTED		
AREAS CHECKED	TEMPLATE		
NO.	AREAS CHECKED		

ORIGINAL SURVEY	SURVEYED	BY	DATE
NOTE BOOK	PLOTTED		
AREAS CHECKED	TEMPLATE		
NO.	AREAS CHECKED		

FILE NAME = G:\p\c\j\202355_003\C400\C411\SH1\08065312.dwg

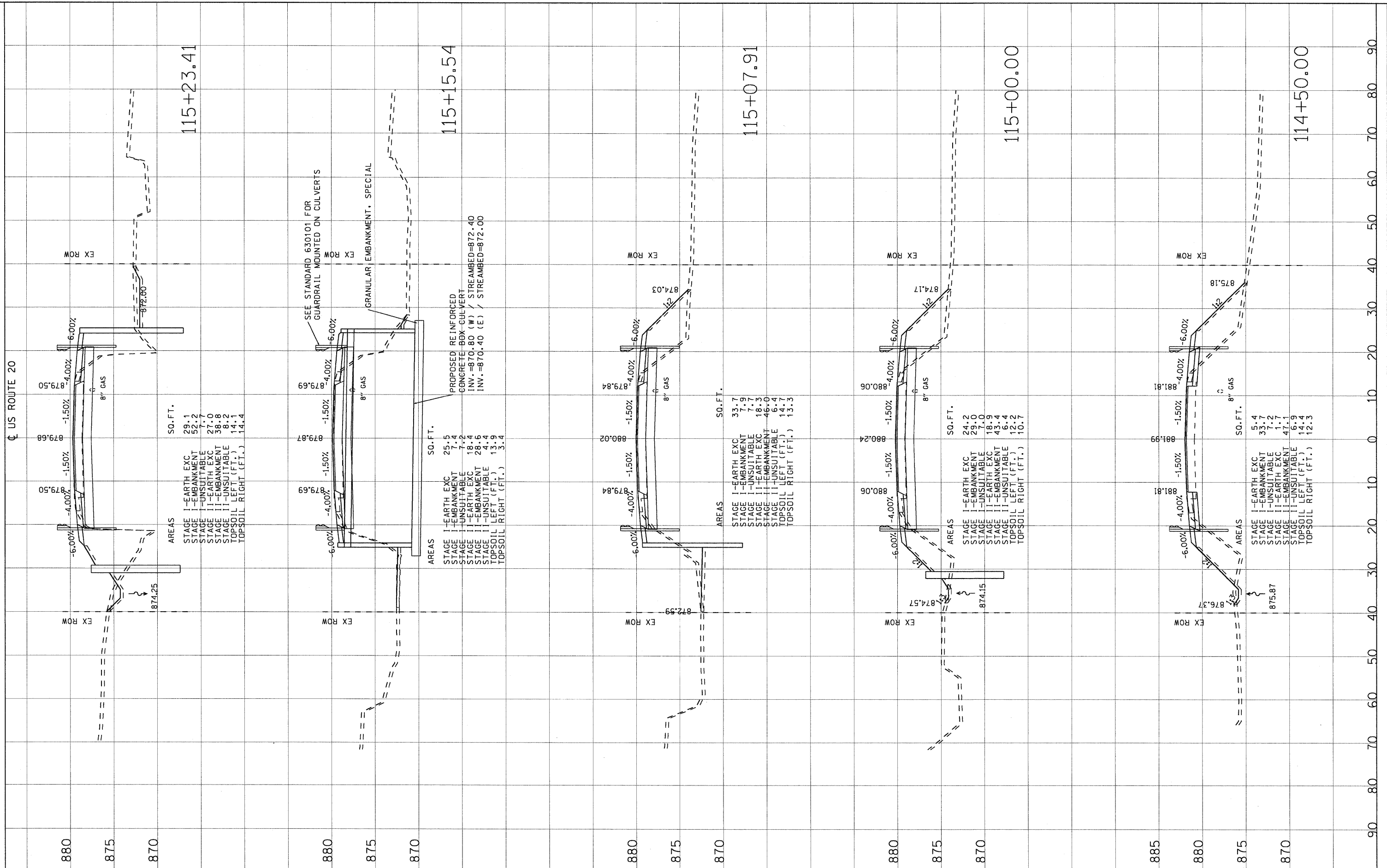

US ROUTE 20



USER NAME = 2KUJAWC
 PLOT SCALE = 10.0000' / IN.
 PLOT DATE = 06/17/2011

DESIGNED - DJB
 DRAWN - ENTRAN
 CHECKED - TMH
 DATE - 06/24/11

REVISED - 9-8-11 Rev.
 REVISED -
 REVISED -
 REVISED -

STATE OF ILLINOIS
 DEPARTMENT OF TRANSPORTATION

FAP ROUTE 525 (US ROUTE 20) OVER DRAINAGE DITCH
 US ROUTE 20 CROSS SECTIONS

SCALE: 1"=5'V/10'H SHEET NO. OF SHEETS STA. TO STA.

F.A.P. RTE. 525	SECTION 11-T-1	COUNTY McHENRY	TOTAL SHEETS 34	SHEET NO. 32
CONTRACT NO. 60M53				

FED. ROAD DIST. NO. ILLINOIS FED. AID PROJECT

FINAL	SURVEYED	BY	DATE
SURVEY	PLOTTED		
NOTE BOOK	TEMPLATE		
NO.	AREAS CHECKED		

ORIGINAL	SURVEYED	BY	DATE
SURVEY	PLOTTED		
NOTE BOOK	TEMPLATE		
NO.	AREAS CHECKED		

FILE NAME = G:\p\p\j\m\2102165_003\CADD\G_11\5\11\010809312.dwg

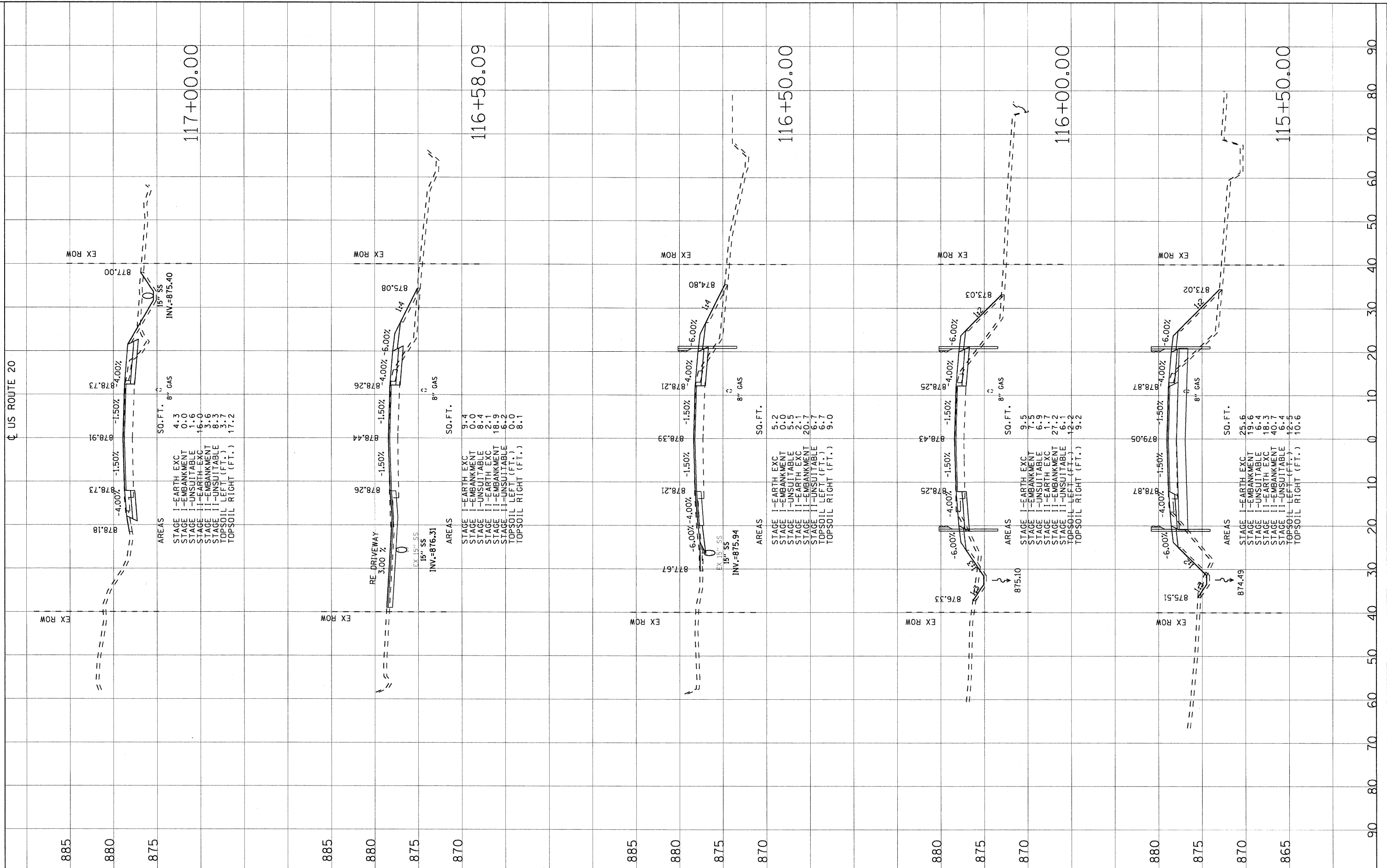

US ROUTE 20

USER NAME = 2KJJAWC	DESIGNED - DJB	REVISED - 9-8-11 Rev.
DESIGNED - DJB	DRAWN - ENTRAN	REVISED -
PLLOT SCALE = 10,0000' / IN.	CHECKED - TMH	REVISED -
PLLOT DATE = 08/17/2011	DATE - 06/24/11	REVISED -

STATE OF ILLINOIS
DEPARTMENT OF TRANSPORTATION

FAP ROUTE 525 (US ROUTE 20) OVER DRAINAGE DITCH
US ROUTE 20 CROSS SECTIONS

SCALE: 1"=5'-V/10'-H SHEET NO. OF SHEETS STA. TO STA.

F.A.P. RTE 525	SECTION 11-T-1	COUNTY McHENRY	TOTAL SHEETS 34	SHEET NO. 33
CONTRACT NO. 60M53				
FED. ROAD DIST. NO. ILLINOIS FED. AID PROJECT				

FINAL SURVEY NO.	SURVEY CHECKED	BY	DATE
NOTE BOOK NO.	PLOTTED		
	TEMPLATE		
	AREAS CHECKED		

ORIGINAL SURVEY NO.	SURVEY CHECKED	BY	DATE
	PLOTTED		
	TEMPLATE		
	AREAS CHECKED		

FILE NAME = G:\p\c\m\1202105_003\CD00\C111\SH1\0160\63212417.dgn

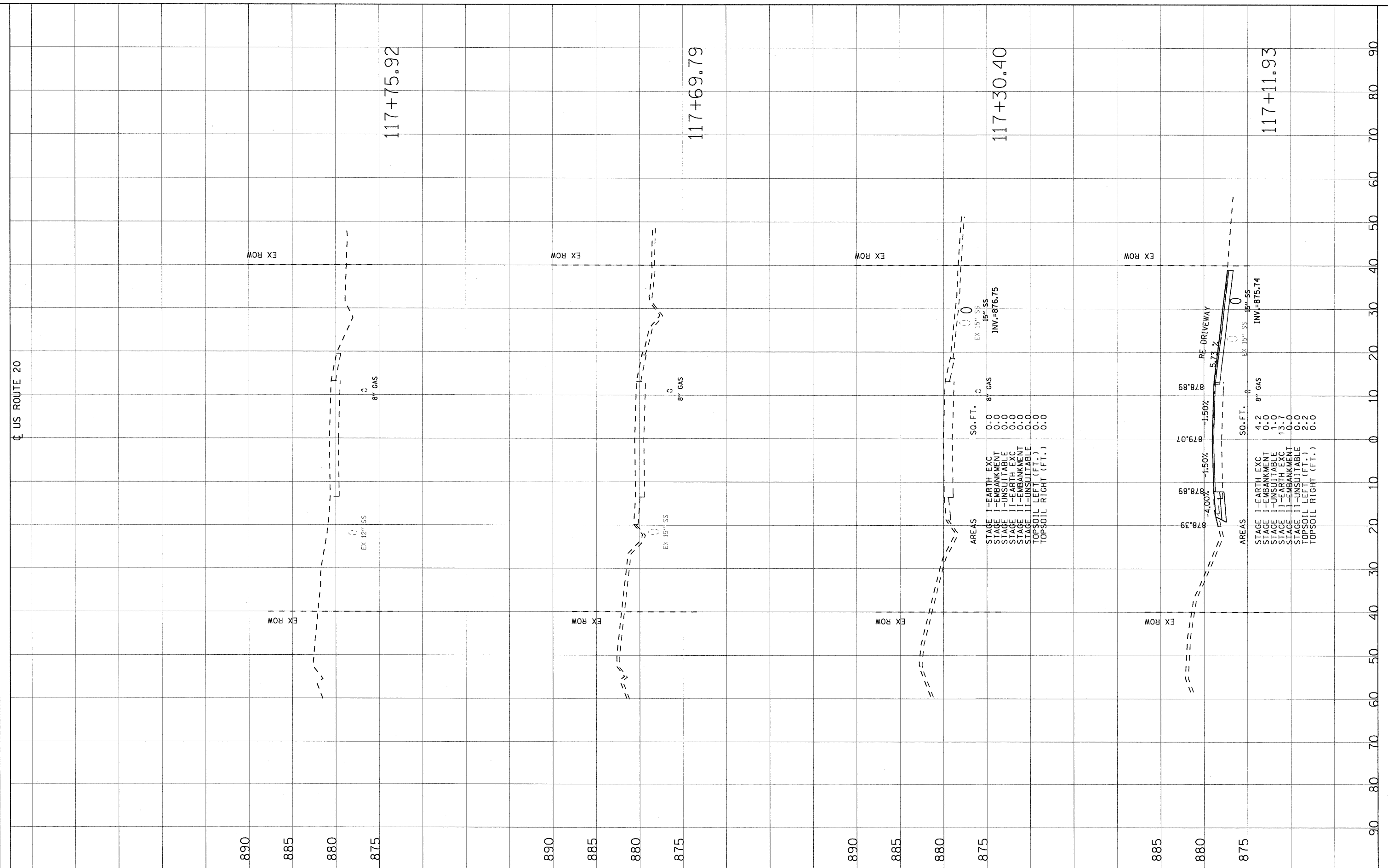

USER NAME = 2KLUJAWC
 PLOT SCALE = 10.0000' / 1" IN.
 PLOT DATE = 06/17/2011

DESIGNED - DJB
 DRAWN - ENTRAN
 CHECKED - TMH
 DATE - 06/24/11

REVISED - 9-8-11 Rev.
 REVISED -
 REVISED -
 REVISED -

STATE OF ILLINOIS
 DEPARTMENT OF TRANSPORTATION

FAP ROUTE 525 (US ROUTE 20) OVER DRAINAGE DITCH
 US ROUTE 20 CROSS SECTIONS
 SCALE: 1"=5'V/10'H SHEET NO. OF SHEETS STA. TO STA.

F.A.P. RTE. 525	SECTION 11-T-1	COUNTY McHENRY	TOTAL SHEETS 34	SHEET NO. 34
FED. ROAD DIST. NO. ILLINOIS FED. AID PROJECT			CONTRACT NO. 60M53	