

SCHEDULE OF QUANTITIES

U.S. RTE 41 (SKOKIE HIGHWAY) AT MARTIN LUTHER KING JR. DRIVE/22ND STREET

NO.	QUANT.	UNIT
1.	1	EACH MAINTENANCE OF EXISTING TRAFFIC SIGNAL INSTALLATION
2.	1	EACH REMOVE EXISTING TRAFFIC SIGNAL EQUIPMENT
3.	13	EACH RETROREFLECTIVE TRAFFIC SIGNAL BACKPLATE

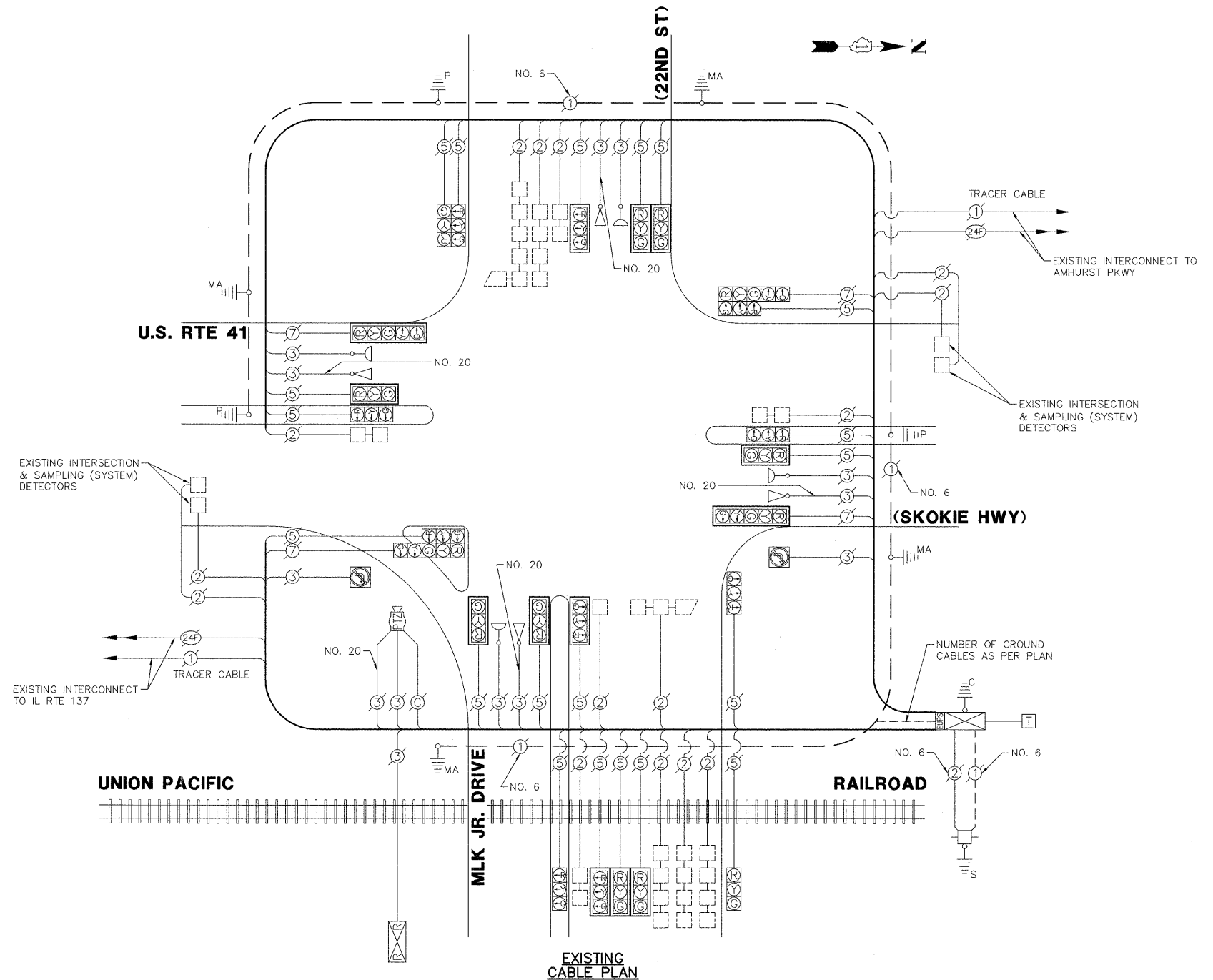

I.D.O.T. TRAFFIC SIGNAL INSTALLATION ELECTRICAL SERVICE REQUIREMENTS					TOTAL WATTAGE
TYPE	NO. LAMPS	WATTAGE INCAND.	L.E.D.	% OPERATION	
SIGNAL (RED)	23	135	17	0.50	195.5
SIGNAL (YELLOW)	23	135	25	0.25	143.75
SIGNAL (GREEN)	23	135	15	0.25	86.25
ARROW	8	135	12	0.10	9.6
PED. SIGNAL	-	90	25	1.00	-
CONTROLLER	1	-	100	1.00	100.0
LUMINAIRE	-	-	250	0.50	-
L.E.D. ST. NAME SIGN	-	-	64	0.50	-
VIDEO SYSTEM	-	-	150	1.00	-
BATTERY BACKUP	1	-	25	1.00	25.0
ILLUMINATED SIGN	-	-	25	0.05	-
TOTAL =					560.1

ENERGY COSTS - BILLED TO: IDOT - DISTRICT 1
 (ADDRESS) 201 WEST CENTER COURT
 (ADDRESS) SCHAUMBURG, IL 60196
 ENERGY SUPPLY - CONTACT: ALICE TAYLOR
 PHONE: 847.816.5458
 COMPANY: COMED

THE TRAFFIC SIGNAL CONTROL EQUIPMENT FOR THIS PROJECT SHALL BE "ECONOLITE" TO MATCH THE EXISTING ADJACENT SYSTEM.

FILE NAME = 4085.874-TR1.dwg	USER NAME = ZACH WALLSTEN	DESIGNED - JRD	REVISED -
PLOT SCALE = 1" = .0833'	DATE = 6/30/2011	DRAWN - JRM	REVISED -
		CHECKED - KLB	REVISED -
			REVISED -

**STATE OF ILLINOIS
 DEPARTMENT OF TRANSPORTATION**

**SCHEDULE OF QUANTITIES, CABLE PLAN, PHASE DESIGNATION
 DIAGRAM, & EMERGENCY VEHICLE PREEMPTION SEQUENCE
 U.S. RTE 41 (SKOKIE HWY) AT MLK JR. DRIVE/22ND STREET**

SCALE: N.A. SHEET NO. OF SHEETS STA. TO STA.

F.A.P. RTE. 346	SECTION 2011-042-TS	COUNTY LAKE	TOTAL SHEETS 62	SHEET NO. 37
ILLINOIS FED. AID PROJECT			CONTRACT # 60P49	

GHA #4085.874