

ROCK OUTLET PROTECTION

SECTION A-A

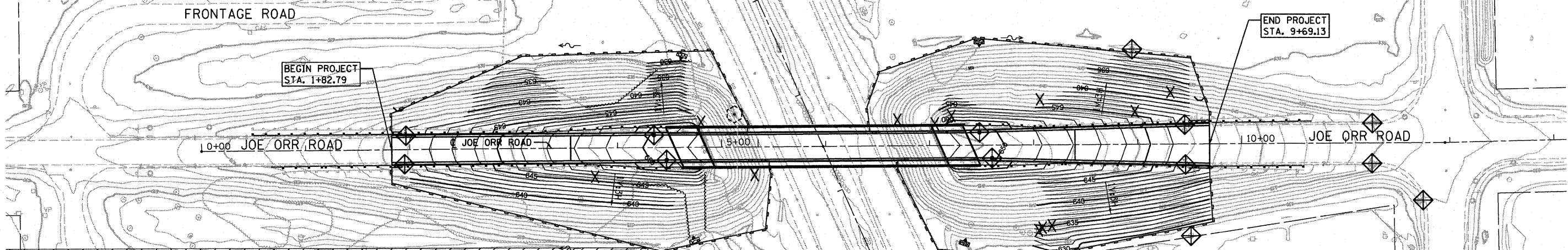

NOTES

1. SEE IDOT STANDARD 280001 FOR TEMPORARY EROSION CONTROL SYSTEM.
2. EROSION CONTROL MEASURES AS SHOWN SHALL BE PROVIDED AS A MINIMUM. THE CONTRACTOR SHALL PROVIDE ADDITIONAL EROSION CONTROL DEVICES, AS REQUIRED, TO COMPLY WITH ILLINOIS URBAN MANUAL.
3. AFTER INSTALLATION OF DRAINAGE STRUCTURES AND BEFORE THE GROUND IS STABILIZED WITH PERMANENT GROUND COVER OR PAVEMENT, CONTRACTOR TO PROVIDE INLET PROTECTION AROUND ALL DRAINAGE STRUCTURES.
4. THE CONTRACTOR SHALL PROVIDE DUST CONTROL BY APPLYING MULCHES, VEGETATIVE COVER, WATERING, STONE, STREET CLEANING, ETC. WHERE APPLICABLE.
5. PROVIDE TEMPORARY SEEDING WITHIN 7 DAYS FOR AREAS SUBJECT TO EROSION THAT WILL BE LEFT UNSTABILIZED FOR LONGER THAN 14 DAYS.
6. TEMPORARY SEEDING OF TOPSOIL STOCKPILES SHALL BE COMPLETED WITHIN 7 DAYS OF FORMATION OF THE STOCKPILE.
7. THE CONTRACTOR SHALL ENSURE THAT THE PERIMETER EROSION BARRIER IS CONSTRUCTED AND SET IN PLACE PRIOR TO THE COMMENCEMENT OF ANY EXCAVATION, GRADING OR OTHER DISTURBANCE OF THE EXISTING GROUND.
8. THE LOCATION OF THE PERIMETER EROSION BARRIER MAY BE ADJUSTED AS NEEDED FOR TEMPORARY CONSTRUCTION EASEMENTS FOR ACCESS TO THE SITE. THE CONTRACTOR SHALL ENSURE THAT ADJACENT PROPERTIES REMAIN PROTECTED FROM SEDIMENT DEPOSITION.
9. ALL DISTURBED AREAS SHALL BE RESTORED WITH PERMANENT CLASS 3 SEEDING, FERTILIZER AND EROSION CONTROL BLANKETS.

LEGEND

- INLET AND PIPE PROTECTION INLET FILTERS TO BE USED FOR GRATES IN THE PAVEMENT
- TREE REMOVAL, UNITS
- PERIMETER EROSION BARRIER
- TREE TRUNK PROTECTION AND TREE PRUNING (OVER 10 INCH DIAMETER)
- ROCK OUTLET PROTECTION
- FLOODPLAIN

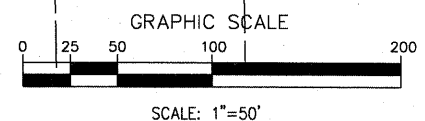

FILE NAME =	DESIGNED - JCP	REVISED -	<p>800 WEST FULTON STREET CHICAGO, ILLINOIS 60611-1258 TEL: 312 466 9100 FAX: 312 868 1217 WEB: www.sepsteindigital.com</p>	<p align="center">STATE OF ILLINOIS DEPARTMENT OF TRANSPORTATION</p>				<p align="center">EROSION AND SEDIMENT CONTROL AND LANDSCAPING PLAN</p>				F.A.P. RTE. =	SECTION	COUNTY	TOTAL SHEETS	SHEET NO.
...NDI-xxxxx-sh13-ersc.dgn	DRAWN - JCP	REVISED -										332	0101.1 BR-3	COOK	60	13
PLOT TIME = 10:30:35 AM	CHECKED - TRP	REVISED -		SCALE: 1" = 50' SHEET NO. 1 OF 1 SHEETS STA. 0+00.00 TO STA. 13+00.00				CONTRACT NO. 62421								
PLOT DATE = 6/30/2011	DATE - 07/01/2011	REVISED -						ILLINOIS FED. AID PROJECT								