

BM #117: Chiseled square located on top of jersey wall at the south end of easterly pier of Joe Orr Road bridge El. 635.00
 Existing Structure: S.N. 016-2121 Built in 1954 as part of F.A. Route 122 Section 066B-0101.1 at Sta. 5+97.57.
 The structure is a four-span bridge 225'-6 1/2" long back to back of abutments and 40'-0" out to out of deck carrying two lanes of traffic. The superstructure consists of reinforced concrete deck on continuous wide flange steel beam structure. The substructure consists of solid stem concrete piers and spill thru abutments supported on concrete piles. The existing structure has a substandard minimum vertical clearance height of 14'-3" over IL Route 394.
 The existing superstructure will be removed and replaced. The existing substructure will be repaired, modified and reused to increase the minimum vertical clearance to 16'-0". The concrete slope wall will be reconstructed. The traffic will be detoured to an alternate route.

Salvage: None, except existing protective shield to be salvaged and returned to the IDOT Bridge Maintenance office located at Biesterfeld Road in Elk Grove Village, IL. Phone No. 847-956-1501. 24 Hours advance notice is required. This work shall not be paid separately but shall be included in the cost of the work.

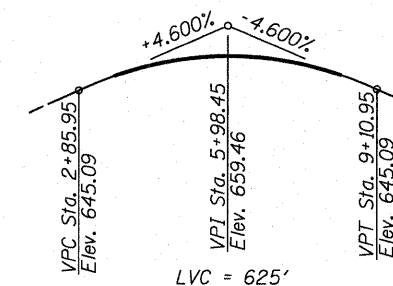

PROFILE GRADE
 (along Joe Orr Road)

DESIGN SPECIFICATIONS
 2002 AASHTO Standard Specifications
 for Highway Bridges
LOADING HS 20-44
 Allow 25#/sq. ft. for future wearing surface.

DESIGN STRESSES
FIELD UNITS (New Construction)
 $f'_c = 3,500$ psi
 $f_y = 60,000$ psi (Reinforcement)
 $f_y = 50,000$ psi (M270 Grade 50)
 $f_y = 36,000$ psi (M270 Grade 36)
FIELD UNITS (Existing Construction)
 $f_c = 1,400$ psi
 $f_s = 20,000$ psi (Reinforcement)

SEISMIC DATA
 Seismic Performance Category (SPC) = A
 Bedrock Acceleration Coefficient (A) = 0.04g
 Site Coefficient (S) = 1.5

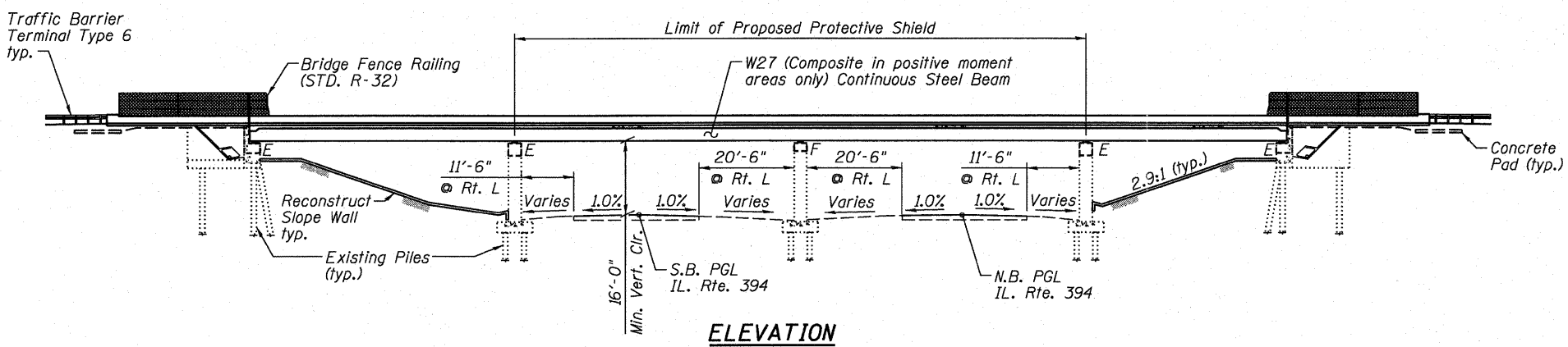

ELEVATION

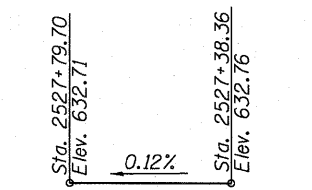

PROFILE GRADE
 (along S.B. PGL IL. Rte. 394)

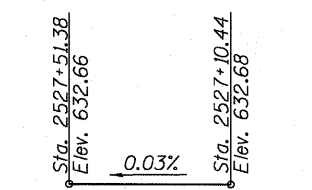

PROFILE GRADE
 (along N.B. PGL IL. Rte. 394)

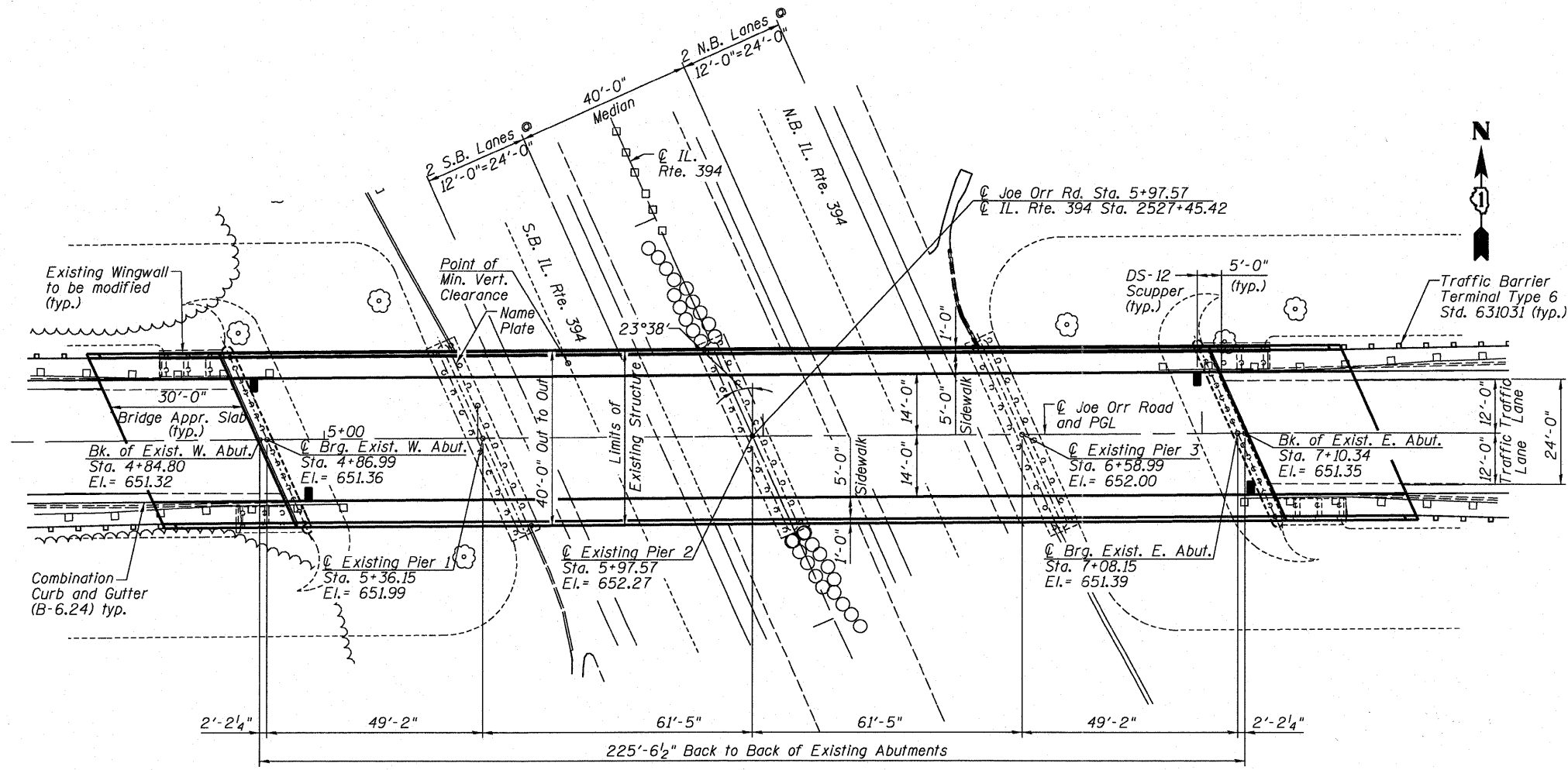

PLAN

STATION 2527+45.42
 RE-BUILT 2011 BY
 STATE OF ILLINOIS
 F.A.P. RT. 332 SEC. 0101.1 BR-3
 LOADING HS20-44
 STR. NO. 016-2121

NAME PLATE

Existing Name Plate located on the west face of the Pier 3 shall be removed and discarded. Existing Name Plate located on the east face of the Pier 1 shall be cleaned and new Name Plate shall be located next to it. Cost included with Name Plates.

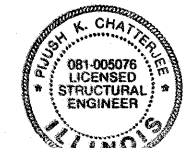

Pijush K. Chatterjee 6-30-2011
 Expires: 11-30-2012

APPROVED
 FOR STRUCTURAL ADEQUACY ONLY
 D. Carl Pappas (P.E.)
 ENGINEER OF BRIDGES AND STRUCTURES

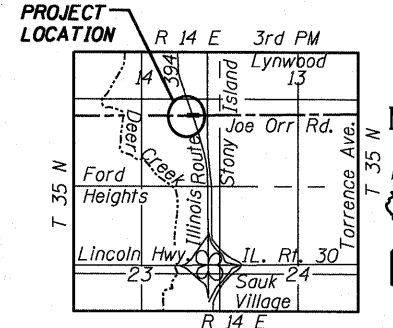

LOCATION MAP

Note:
 Section thru Abutment and Slope Wall Details shown on sheet S24.

GENERAL PLAN AND ELEVATION
IL ROUTE 394 at JOE ORR ROAD
 F.A.P. RT. 332 SECTION 0101.1 BR-3
 COOK COUNTY
 STATION 2527+45.42
 STRUCTURE NO. 016-2121

FILE NAME = ...Structure\0162121-001-0PE.dgn	DESIGNED EV DRAWN JCP CHECKED PC	REVISED - REVISED - REVISED - REVISED -	 800 WEST FULTON STREET CHICAGO, ILLINOIS 60611-1209 TEL 312 454 6100 FAX 312 688 1217 WEB www.sepstein-global.com	STATE OF ILLINOIS DEPARTMENT OF TRANSPORTATION	F.A.P. RTE. 332	SECTION 0101.1 BR-3	COUNTY COOK	TOTAL SHEETS 60	SHEET NO. 16
PLOT TIME = 12/17/51 PM PLOT DATE = 6/30/2011	DATE 07 01 2011				SHEET NO. S1 OF S29 SHEETS	CONTRACT NO. 62421		ILLINOIS FED. AID PROJECT	