

NORTH EDGE OF SIDEWALK

Location	Station	Offset	Theoretical Grade Elevations
W. End West Appr. Slab	4+46.04	-20.00	650.25
A1	4+56.04	-20.00	650.47
A2	4+66.04	-20.00	650.67
E. End West Appr. Slab	4+76.04	-20.00	650.86

NORTH EDGE OF PAVEMENT

Location	Station	Offset	Theoretical Grade Elevations
W. End West Appr. Slab	4+48.67	-14.00	650.40
A1	4+58.67	-14.00	650.62
A2	4+68.67	-14.00	650.81
E. End West Appr. Slab	4+78.67	-14.00	651.00

☉ ROADWAY, PROFILE GRADE LINE

Location	Station	Offset	Theoretical Grade Elevations
W. End West Appr. Slab	4+54.80	0.00	650.75
A1	4+64.80	0.00	650.96
A2	4+74.80	0.00	651.15
E. End West Appr. Slab	4+84.80	0.00	651.32

SOUTH EDGE OF PAVEMENT

Location	Station	Offset	Theoretical Grade Elevations
W. End West Appr. Slab	4+60.93	14.00	650.66
A1	4+70.93	14.00	650.86
A2	4+80.93	14.00	651.04
E. End West Appr. Slab	4+90.93	14.00	651.20

SOUTH EDGE OF SIDEWALK

Location	Station	Offset	Theoretical Grade Elevations
W. End West Appr. Slab	4+63.56	20.00	650.62
A1	4+73.56	20.00	650.81
A2	4+83.56	20.00	650.99
E. End West Appr. Slab	4+93.56	20.00	651.15

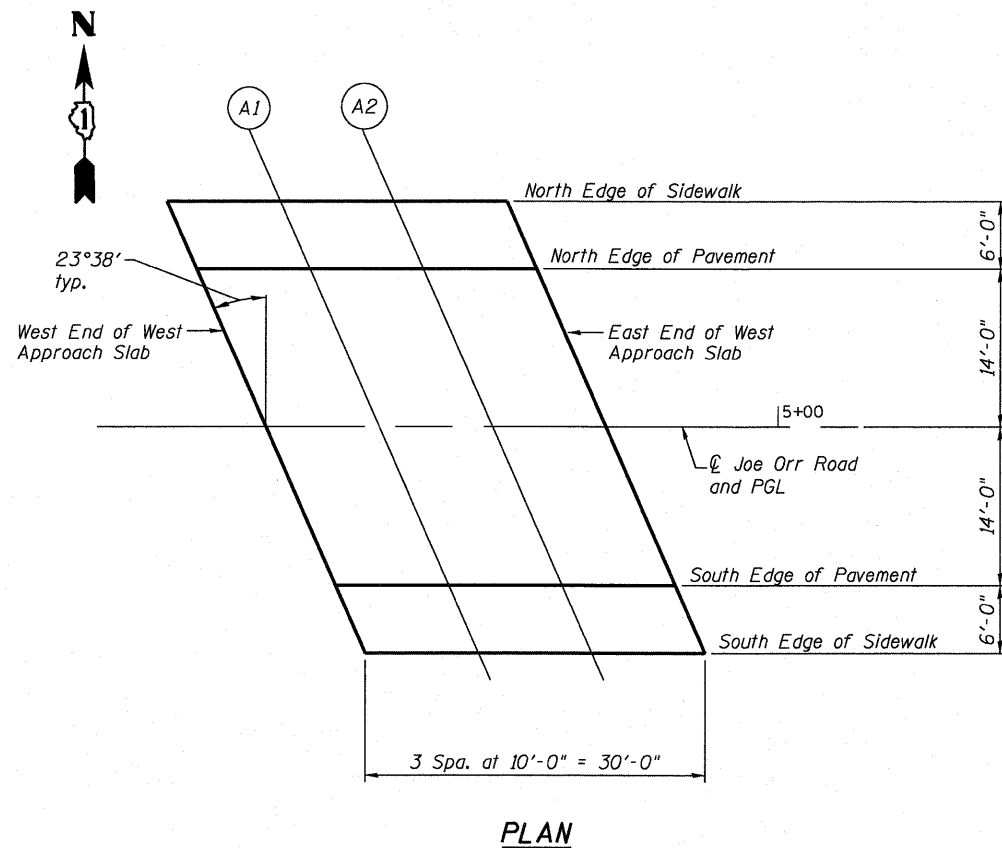

PLAN

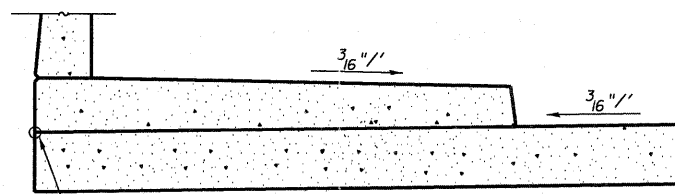

El. at Edge of Sidewalks are given at the theoretical top of Appr. slab which is the projection of the roadway slope to the Edge of sidewalk

PROJECTION UNDER SIDEWALK DETAIL

E-AS 7-1-10

FILE NAME = ...0162121-007-T05 WAppr.dgn	DESIGNED EV	REVISD -	<p>900 WEST FULTON STREET CHICAGO, ILLINOIS 60611-1209 TEL 312 456 9100 FAX 312 598 1217 WEB www.sepsteinglobal.com</p>	<p>STATE OF ILLINOIS DEPARTMENT OF TRANSPORTATION</p>	<p>TOP OF WEST APPROACH SLAB ELEVATIONS STRUCTURE NO. 016-2121</p>	F.A.P. RTE. 332	SECTION 0101.1 BR-3	COUNTY COOK	TOTAL SHEETS 60	SHEET NO. 22			
PLOT TIME = 5:17:44 PM	DRAWN JCP	REVISD -				SHEET NO. 57 OF 529 SHEETS			CONTRACT NO. 62421				
PLOT DATE = 6/29/2011	CHECKED PC	REVISD -				ILLINOIS FED. AID PROJECT							
	DATE 07 01 2011	REVISD -											