

NORTH EDGE OF SIDEWALK

Location	Station	Offset	Theoretical Grade Elevations
W. End East Appr. Slab	7+01.58	-20.00	651.18
A3	7+11.58	-20.00	651.02
A4	7+21.58	-20.00	650.84
E. End East Appr. Slab	7+31.58	-20.00	650.66

NORTH EDGE OF PAVEMENT

Location	Station	Offset	Theoretical Grade Elevations
W. End East Appr. Slab	7+04.21	-14.00	651.23
A3	7+14.21	-14.00	651.07
A4	7+24.21	-14.00	650.89
E. End East Appr. Slab	7+34.21	-14.00	650.70

☉ ROADWAY, PROFILE GRADE LINE

Location	Station	Offset	Theoretical Grade Elevations
W. End East Appr. Slab	7+10.34	0.00	651.35
A3	7+20.34	0.00	651.18
A4	7+30.34	0.00	650.99
E. End East Appr. Slab	7+40.34	0.00	650.79

SOUTH EDGE OF PAVEMENT

Location	Station	Offset	Theoretical Grade Elevations
W. End East Appr. Slab	7+16.47	14.00	651.03
A3	7+26.47	14.00	650.85
A4	7+36.47	14.00	650.65
E. End East Appr. Slab	7+46.47	14.00	650.44

SOUTH EDGE OF SIDEWALK

Location	Station	Offset	Theoretical Grade Elevations
W. End East Appr. Slab	7+19.09	20.00	650.89
A3	7+29.09	20.00	650.70
A4	7+39.09	20.00	650.50
E. End East Appr. Slab	7+49.09	20.00	650.29

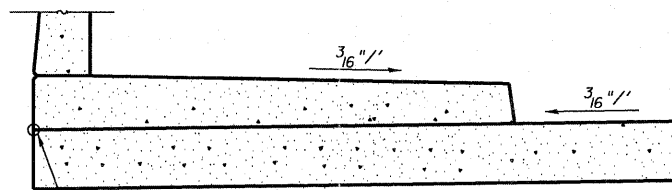
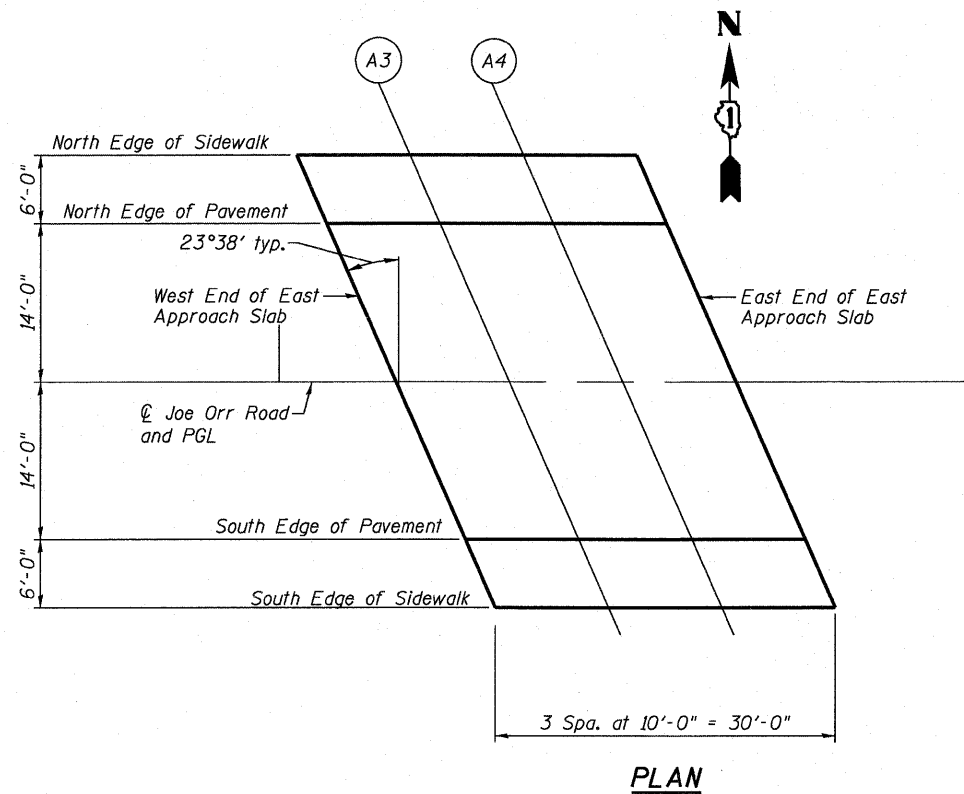

El. at Edge of Sidewalks are given at the theoretical top of Appr. slab which is the projection of the roadway slope to the Edge of sidewalk

PROJECTION UNDER SIDEWALK DETAIL

E-AS

7-1-10

FILE NAME *	DESIGNED EV	REVISED -	 500 WEST FALTON STREET CHICAGO, ILLINOIS 60611-1259 TEL 312 454 9100 FAX 312 558 1217 WEB www.sepstein.com	STATE OF ILLINOIS DEPARTMENT OF TRANSPORTATION	TOP OF EAST APPROACH SLAB ELEVATIONS STRUCTURE NO. 016-2121 SHEET NO. 58 OF 529 SHEETS	F.A.P. RTE.	SECTION	COUNTY	TOTAL SHEETS	SHEET NO.
...0162121-008-TOS EAppr.dgn	DRAWN JCP	REVISED -				332	0101.1 BR-3	COOK	60	23
PLOT TIME = 5:18:05 PM	CHECKED PC	REVISED -				CONTRACT NO. 62421				
PLOT DATE = 6/29/2011	DATE 07 01 2011	REVISED -				ILLINOIS FED. AID PROJECT				