

GENERAL NOTES
 Rivets 3/4" diam. unless noted
 Open Holes 1/2" diam. unless noted.

REVISIONS	DATE	INITIALS
R3	Hole in diaphragm for conduit	5-22-32 GJ

This Drawing is supplemented and modified by Drwg. #26-A Mar. 21, 1934

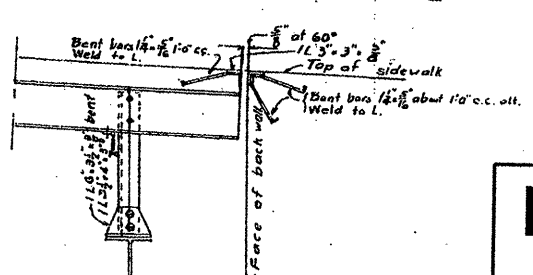
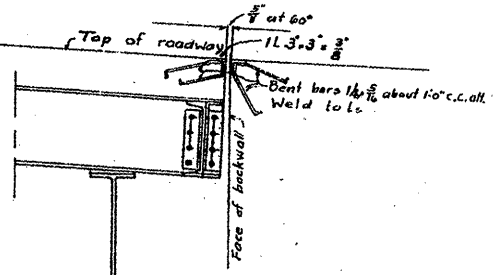

FOR INFORMATION ONLY

APPROACH FLOORBEAMS FH
 DOUBLE LEAF TRUNNION BASCULE BRIDGE
 OVER
 THE ILLINOIS WATERWAY
 AT
 RUBY ST., JOLIET, ILL.

DESIGNED BY
 THE SCHERZER ROLLING LIFT BRIDGE CO.
 MONROCK BLOCK CHICAGO, ILL.

DRAWN BY E.A.K.
 TRACED BY E.A.K.
 CHECKED BY G.R.D.
 REVISED Aug 23, 1932

SCALE: 3/8" = 1'-0"
 DATE: April 23, 1932

FILE NAME =	USER NAME = midgjo	DESIGNED -	REVISED -	STATE OF ILLINOIS DEPARTMENT OF TRANSPORTATION	RUBY STREET OVER DES PLAINES RIVER SN 099-9901	F.A.P. RTE.	SECTION	COUNTY	TOTAL SHEETS	SHEET NO.	
en\pwwork\PKWIDOT\MIDJ\J\0148931\dl1159	aa.dgn	DRAWN -	REVISED -			112	M-BDR-1	WILL	66	25	
		CHECKED -	REVISED -			CONTRACT NO. 62714					
		DATE -	REVISED -			ILLINOIS FED. AID PROJECT					