

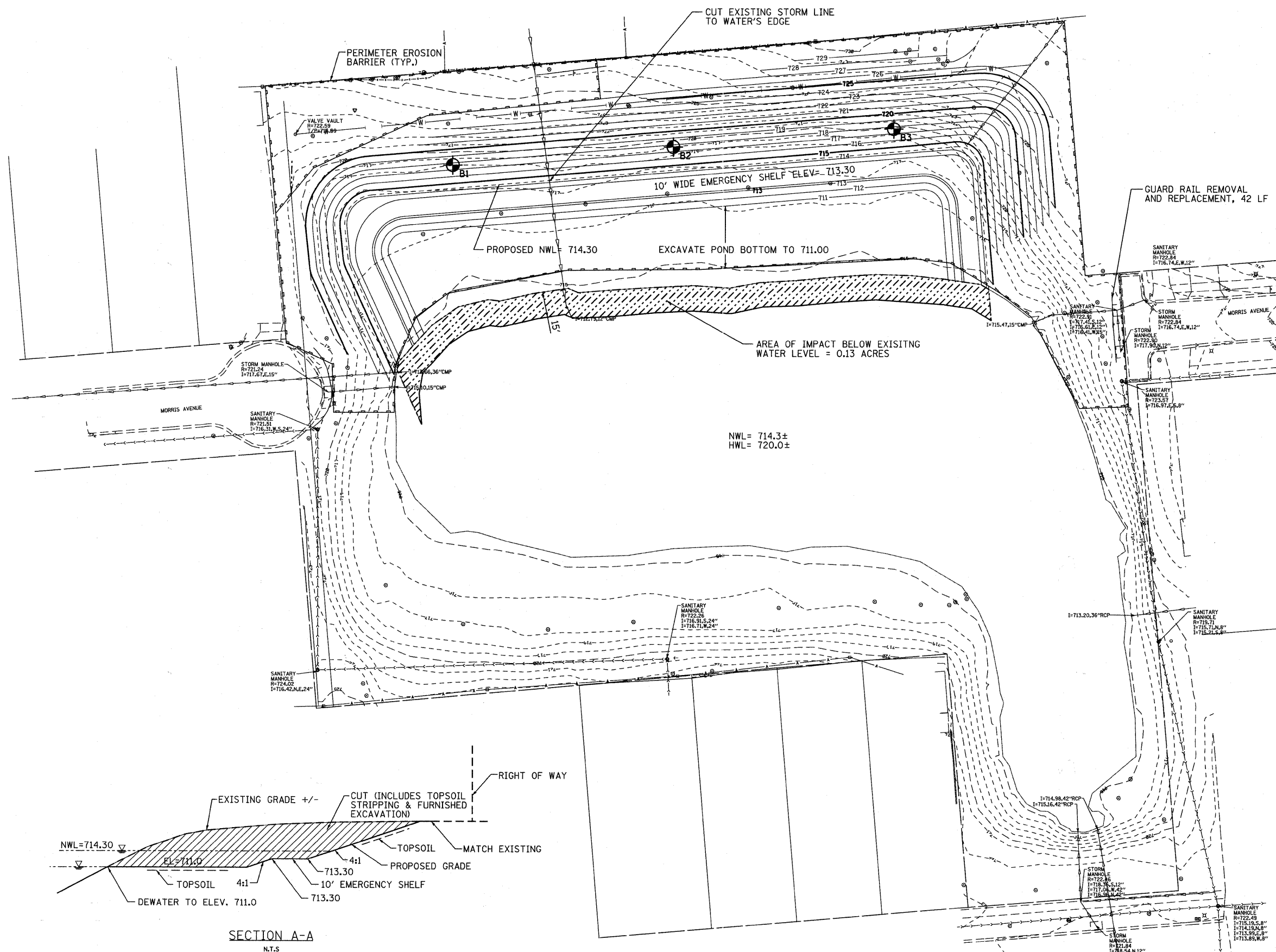

1" = 30'

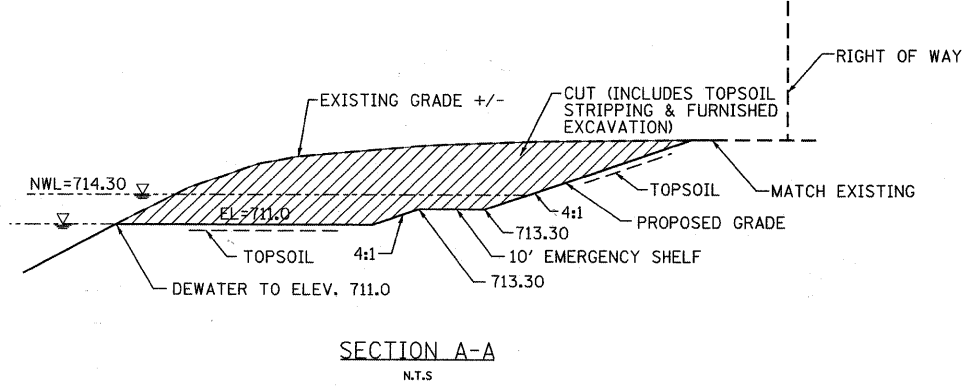

- GENERAL NOTES:
1. THIS POND IS AN APPROVED BORROW AREA. ALL EROSION AND SEDIMENT CONTROL MEASURES MUST BE INCORPORATED PRIOR TO BORROW EXCAVATION.
 2. ONLY BORROW EXCAVATION SHALL LEAVE SITE. ALL UNSUITABLE MATERIAL SHALL BE STOCK PILED AND RESPREAD AFTER BORROW EX COMPLETE.
 3. VOLUME OF BORROW EXCAVATION FROM THIS POND PER GRADING PLAN IS 1,600 CU YD. UNDERCUT MAY BE NECESSARY TO ACHIEVE THE VOLUME.
 4. SEE SOIL BORINGS SHEET FOR DEPTH TO SUITABLE MATERIAL.
- * SEQUENCE:
- A. STRIP AND STOCKPILE TOPSOIL.
 - B. STOCKPILE UNSUITABLE IF ENCOUNTERED.
 - C. REMOVE BORROW EXCAVATION.
 - D. GRADE SITE PER PLAN WITH TOPSOIL RESPREAD OVER SITE IN UNIFORM THICKNESS.
 - E. SEED AND SOD AS SHOWN ON PLAN.



SECTION A-A
N.T.S

FILE NAME = M:\785-004_Lombard - CIV - Bridges Phase II\CADD Sheets\07566004-Morris Avenue Grading.dgn

B Bollinger, Lach & Associates, Inc.
ITASCA, ILLINOIS

USER NAME = daly	DESIGNED - BD	REVISED -
PLOT SCALE = 30.0000' / IN.	DRAWN - DC	REVISED -
PLOT DATE = 7/22/2011	CHECKED - BD	REVISED -
	DATE -	REVISED -

STATE OF ILLINOIS
GREAT WESTERN TRAIL

MORRIS AVENUE POND BORROW AREA
GRADING PLAN

SCALE: 1"=30' SHEET NO. SHEETS STA. TO STA.

F.A. RTE.	SECTION	COUNTY	TOTAL SHEETS	SHEET NO.
	06-00151-00-BR	DuPAGE	201	37
CONTRACT NO. 63568				
ILLINOIS FED. AID PROJECT				