

Notes:  
 See sheet 11 of 37 for Sections B-B, C-C, D-D, E-E and F-F.  
 a(E) and a<sub>1</sub>(E) bar spacings measured along  $\mathcal{C}$  Rdwy.

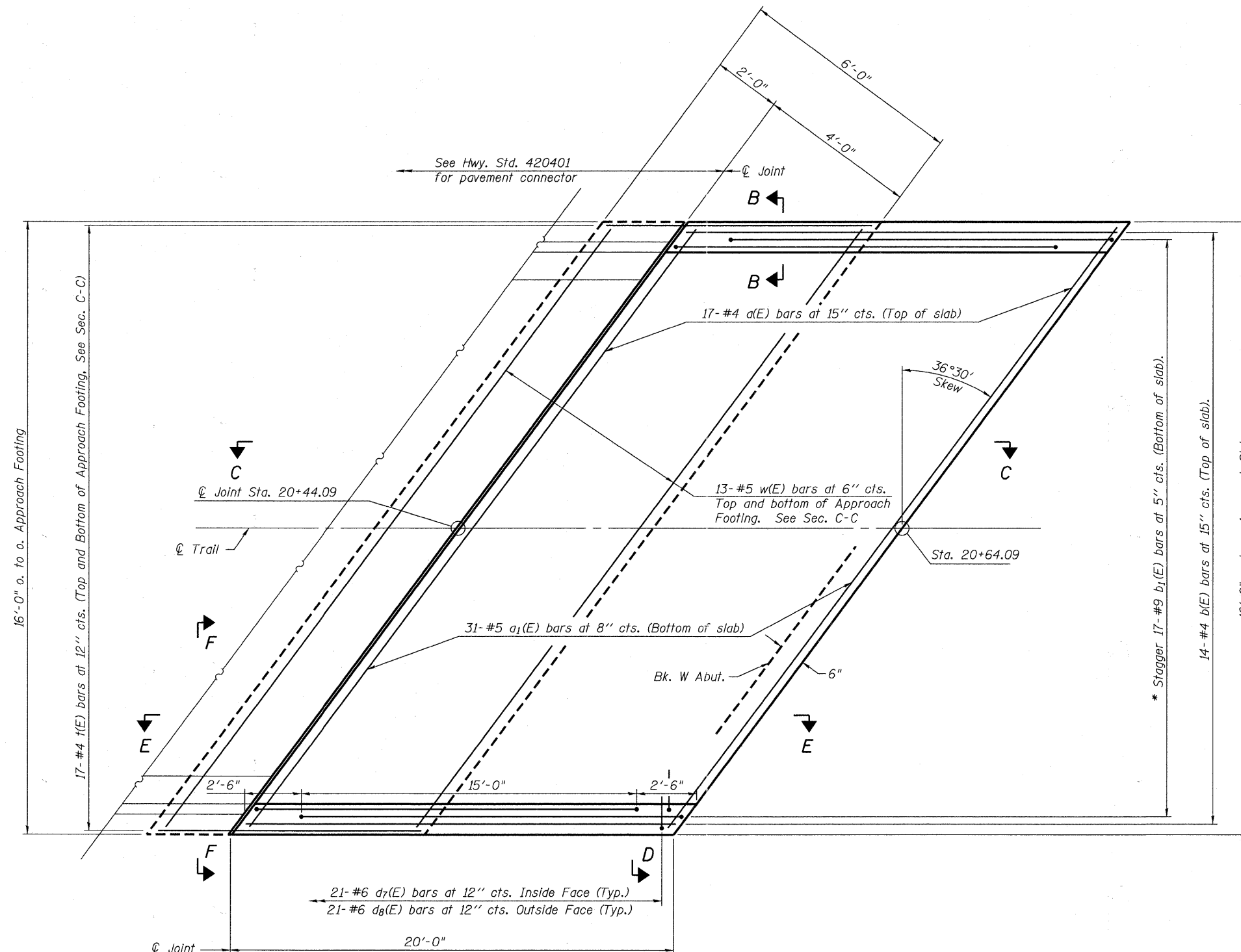

**WEST APPROACH PLAN**

\* Tilt #9 b<sub>1</sub>(E) bars as required to maintain clearance.

(Sheet 1 of 3)

FILE NAME = s:\756-004\lombard - gwt bridges phase 1\road sheets\structural\UPRR\0223122-003-WEST BRIDGE APPROACH SLAB.dgn



USER NAME = gonzalo	DESIGNED SRT	REVISED -
PLOT SCALE =	CHECKED JJI	REVISED -
PLOT DATE = 7/26/2011	DRAWN GM	REVISED -
	CHECKED JJI	REVISED -

**STATE OF ILLINOIS  
 GREAT WESTERN TRAIL  
 UNION PACIFIC RAILROAD**

**WEST BRIDGE APPROACH SLAB  
 STRUCTURE NO. 022-3122**  
 SHEET NO. 9 OF 37 SHEETS

F.A. RTE.	SECTION	COUNTY	TOTAL SHEETS	SHEET NO.
	06-00151-00-BR	DuPAGE	201	89
			CONTRACT NO. 63568	
ILLINOIS FED. AID PROJECT				