

**BILL OF MATERIAL - EAST - MSE WALLS**

Bar	No.	Size	Length	Shape
b <sub>10</sub> (E)	17	#5	30'-7"	—
b <sub>11</sub> (E)	17	#5	23'-5"	—
b <sub>12</sub> (E)	17	#5	22'-0"	—
b <sub>13</sub> (E)	17	#5	27'-5"	—
b <sub>14</sub> (E)	100	#5	8'-3"	—
b <sub>15</sub> (E)	100	#5	4'-8"	—
d <sub>10</sub> (E)	102	#4	2'-1"	—
d <sub>11</sub> (E)	102	#6	7'-3"	—
d <sub>12</sub> (E)	102	#4	3'-10"	—
d <sub>13</sub> (E)	24	#4	2'-0"	—
e <sub>10</sub> (E)	8	#5	30'-0"	—
e <sub>11</sub> (E)	16	#5	24'-0"	—
e <sub>12</sub> (E)	8	#5	27'-2"	—
Structure Excavation				Cu. Yd. 1630
Mechanically Stabilized Earth Retaining Wall				Sq. Ft. 7372
Anti-Graffiti Protection System				Sq. Ft. 6922
Aggregate Column Ground Improvement - Location 3				L. Sum. 1
Form Liner Textured Surface, Special				Sq. Ft. 6789
Permanent Steel Sheet Piling				Sq. Ft. 4455
Concrete Superstructure, Special				Cu. Yd. 7.9
Concrete Superstructure				Cu. Yd. 38.7
Reinforcement Bars, Epoxy Coated				Lbs. 5620
Protective Coat				Sq. Yd. 70
Parapet Railing				Foot 101.3

Note: Included in the contract unit price per square foot for Permanent Steel Sheet Piling shall be the necessary walers, concrete deadman, tie rods and associated connection hardware necessary for construction of anchored sheet pile wall. See Special Provision Permanent MSE Wall Steel Sheet Piling.

**ELEVATION (DEVELOPED)**  
(Looking @ F.F. of Wall)

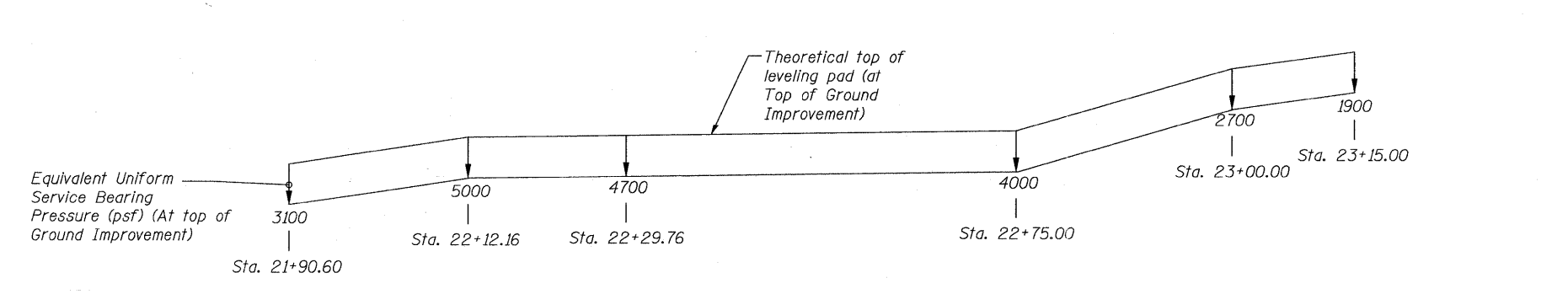

**EQUIVALENT UNIFORM SERVICE BEARING PRESSURE**

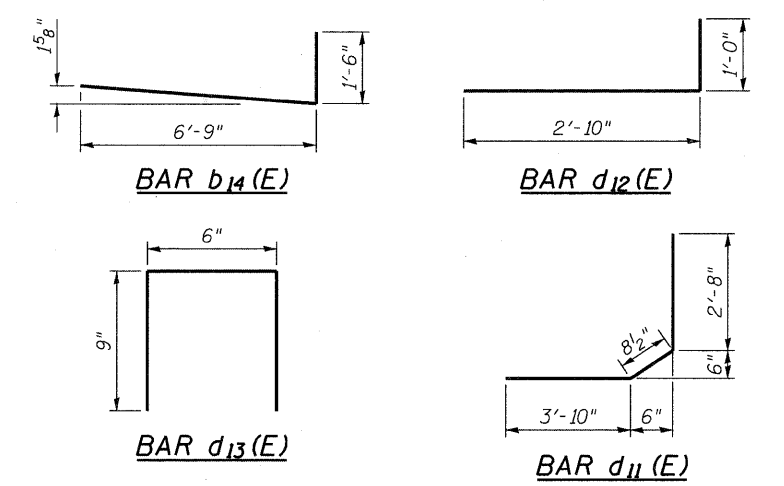

FILE NAME = w:\756-004\_lombard - gnt\_bridges phase 1\load sheets\structural\UPRR\022312-930-EAST ABUTMENT SOUTH MSE WALL ELEVATION.dgn

**Bollinger, Lach & Associates, Inc.**  
ITASCA, ILLINOIS

USER NAME = gonzalo	DESIGNED SRT	REVISED -
PLOT SCALE =	CHECKED JJI	REVISED -
PLOT DATE = 7/26/2011	DRAWN GM	REVISED -
	CHECKED JJI	REVISED -

**STATE OF ILLINOIS  
GREAT WESTERN TRAIL  
UNION PACIFIC RAILROAD**

**EAST ABUTMENT SOUTH MSE WALL ELEVATION  
STRUCTURE NUMBER 022-3122**

SHEET NO. 30 OF 37 SHEETS

F.A. RTE.	SECTION	COUNTY	TOTAL SHEETS	SHEET NO.
	06-00151-00-BR	DuPAGE	201	110
			CONTRACT NO. 63568	

ILLINOIS FED. AID PROJECT