

DEAD LOAD DEFLECTION DIAGRAM

DEAD LOAD DEFLECTION DIAGRAM

(Includes weight of concrete, excluding beams).

Note:

The above deflections are not to be used in the field if the engineer is working from the grade elevations adjusted for dead load deflections as shown below.

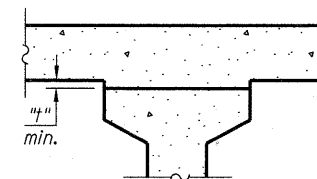

INTERIOR BEAMS

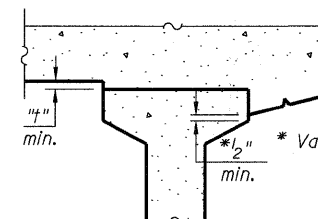

At Minimum Fillet

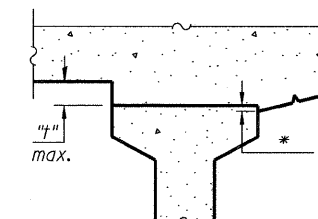

At Maximum Fillet

EXTERIOR BEAMS

To determine "t": After all precast prestressed beams have been erected, elevations of the top flanges of the beams shall be taken at intervals shown on the plans. These elevations subtracted from the "Theoretical Grade Elevations Adjusted for Dead Load Deflections" shown below, minus slab thickness, equals the fillet heights "t" above top flanges of beams.

FILLET HEIGHTS

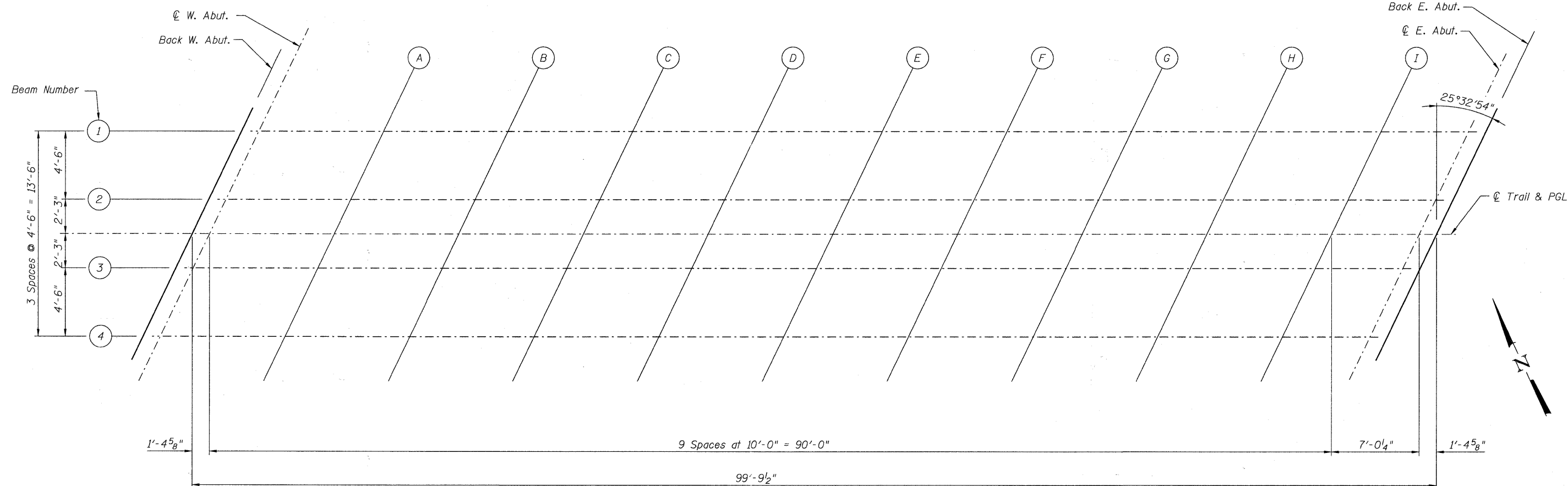

PLAN

FILE NAME = s:\756-004\lombard - gwt bridges phase 1\cadd sheets\structural\ST CHARLES\0223121-003-TOP OF SLAB ELEV.dgn

Bollinger, Lach & Associates, Inc.
ITASCA, ILLINOIS

USER NAME = gonzalo
PLOT SCALE =
PLOT DATE = 7/26/2011

DESIGNED SRT	CHECKED JJI
DRAWN GM	CHECKED JJI

REVISED -	REVISED -
REVISED -	REVISED -
REVISED -	REVISED -

**STATE OF ILLINOIS
GREAT WESTERN TRAIL
ST. CHARLES ROAD**

**TOP OF SLAB ELEVATIONS
STRUCTURE NO. 022-3121**
SHEET NO. 3 OF 29 SHEETS

F.A. RTE.	SECTION	COUNTY	TOTAL SHEETS	SHEET NO.
	06-00151-00-BR	DuPAGE	201	120
			CONTRACT NO. 63568	
ILLINOIS FED. AID PROJECT				