

INSIDE ELEVATION OF PARAPET

* Locate top row of longitudinal parapet reinforcement clear of rail post anchors, maintain minimum reinforcement clearance.

SUPERSTRUCTURE BILL OF MATERIAL

Bar	No.	Size	Length	Shape
a(E)	293	#5	15'-8"	—
a ₁ (E)	4	#5	17'-5"	—
b(E)	54	#5	35'-6"	—
b ₁ (E)	52	#5	27'-5"	—
d(E)	202	#4	3'-9"	↘
d ₁ (E)	202	#6	4'-9"	↘
d ₂ (E)	48	#4	2'-0"	□
e(E)	64	#4	19'-7"	—
e ₁ (E)	16	#4	19'-8"	—
m(E)	10	#6	17'-5"	—
m ₁ (E)	16	#6	8'-4"	—
m ₂ (E)	6	#6	2'-7"	—
s(E)	32	#5	6'-10"	↘
s ₁ (E)	22	#4	12'-3"	□
v(E)	34	#5	3'-10"	↘
Reinforcement Bars, Epoxy Coated		Lbs.	12,230	
Concrete Superstructure		Cu. Yd.	54.7	
Anti-Graffiti Protection System		Sq. Ft.	1,358	
Protective Coat		Sq. Yd.	156	
Form Liner Textured Surface, Special		Sq. Ft.	736	
Concrete Superstructure, Special		Cu. Yd.	15.6	

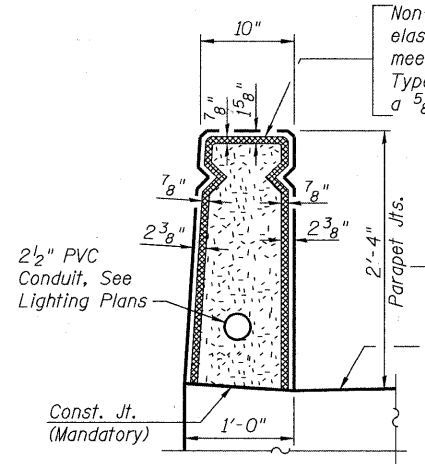

PARAPET JOINT DETAILS

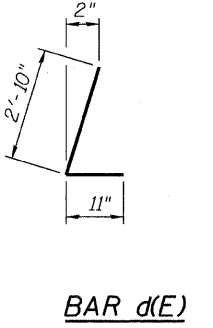
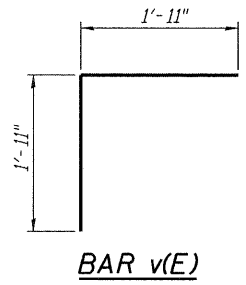
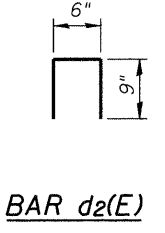
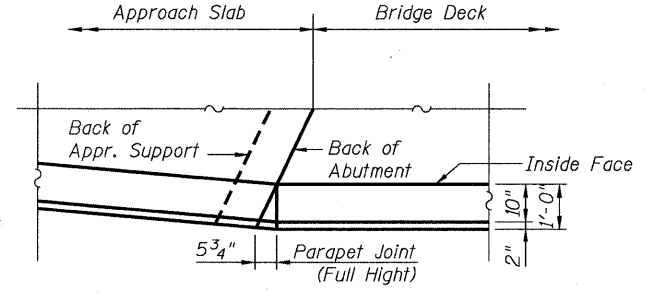
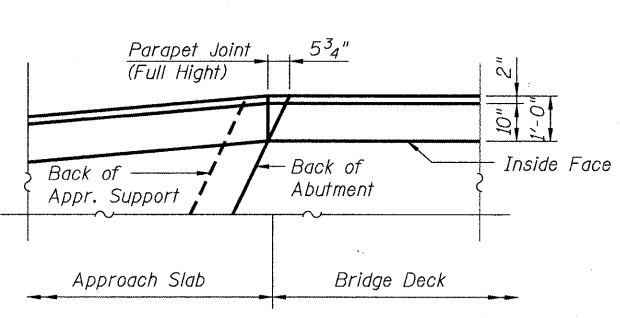
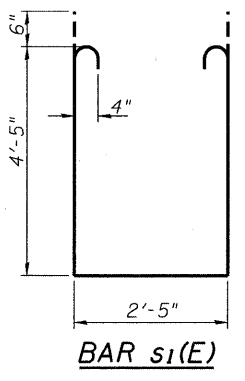
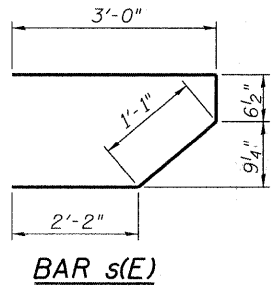
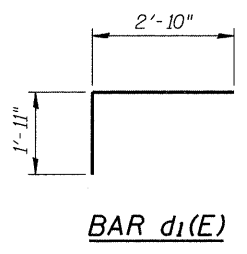
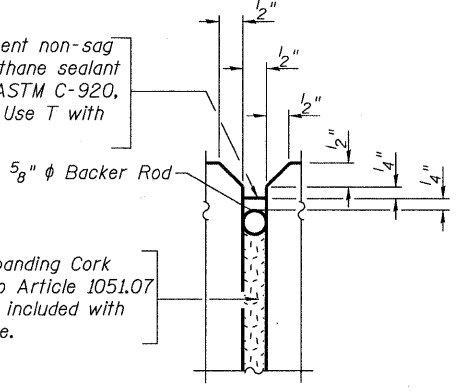

FILE NAME = s:\756-004.lombard - gwt_bridges_phase 11\cadd_sheets\structural\ST CHARLES\0223121-008-PARAPET ELEV.dgn

Bollinger, Lach & Associates, Inc.
ITASCA, ILLINOIS

USER NAME = gonzo
PLOT SCALE =
PLOT DATE = 7/26/2011

DESIGNED SRT
CHECKED JJI
DRAWN GM
CHECKED JJI

REVISED -
REVISED -
REVISED -
REVISED -

**STATE OF ILLINOIS
GREAT WESTERN TRAIL
ST. CHARLES ROAD**

**PARAPET ELEVATION AND SUPERSTRUCTURE DETAILS
STRUCTURE NO. 022-3121**

SHEET NO. 8 OF 29 SHEETS

F.A. RTE.	SECTION	COUNTY	TOTAL SHEETS	SHEET NO.
	06-00151-00-BR	DuPAGE	201	125
			CONTRACT NO. 63568	

ILLINOIS FED. AID PROJECT