

FILE NAME = h:\v756-2004_tombard - g*\bridges phase 11\cadd sheets\structural\ST CHARLES\0223121-010-EAST APPROACH SLAB PLAN.dgn

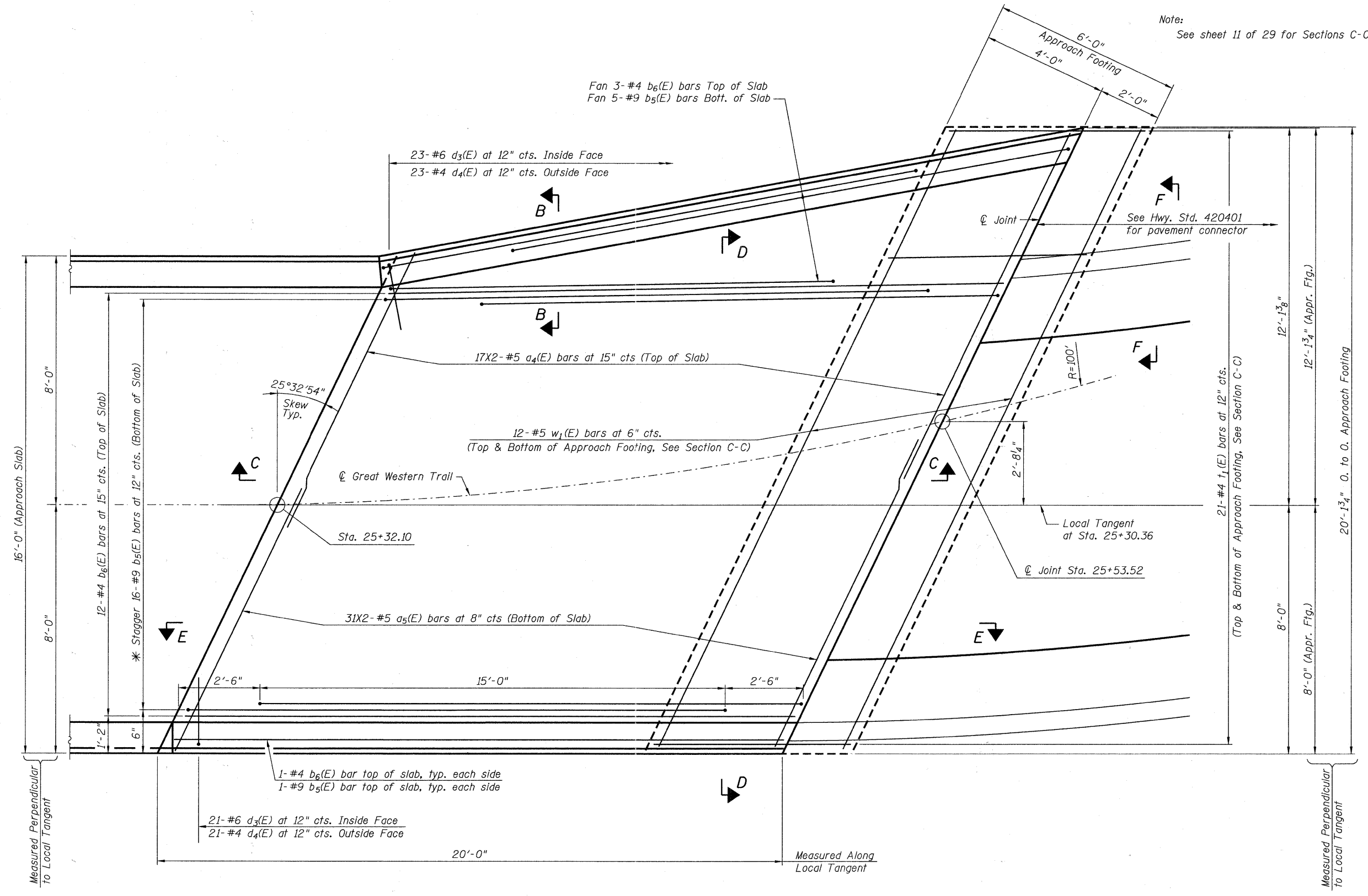

Note:
See sheet 11 of 29 for Sections C-C & D-D and View E-E.

EAST APPROACH PLAN

* Tilt #9 b5(E) bars required to maintain clearance.

Bollinger, Lach & Associates, Inc.
ITASCA, ILLINOIS

USER NAME = gonzo
PLOT SCALE =
PLOT DATE = 7/26/2011

DESIGNED SRT	CHECKED JJI	DRAWN GM	CHECKED JJI
--------------	-------------	----------	-------------

REVISED -	REVISED -	REVISED -	REVISED -
-----------	-----------	-----------	-----------

**STATE OF ILLINOIS
GREAT WESTERN TRAIL
ST. CHARLES ROAD**

**EAST APPROACH SLAB PLAN
STRUCTURE NO. 022-3121**
SHEET NO. 10 OF 29 SHEETS

F.A. RTE.	SECTION	COUNTY	TOTAL SHEETS	SHEET NO.
	06-00151-00-BR	DuPAGE	201	127
			CONTRACT NO. 63568	
ILLINOIS FED. AID PROJECT				